

# American Standard Linear Bearings Standard Type

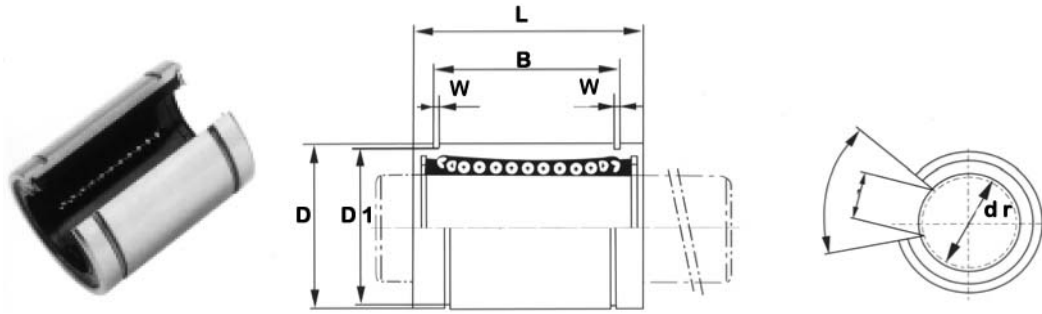

Part Number	No. of Ball Rows	Main Diameters											Basic Load Rating	
		Inscribed Circle Diameter		Outer Diameter		Length		Outer Locking Groove			Eccentricity (max)	Dynamic C (kgf)	Static Co (kgf)	
		dr	Tolerance	D	Tolerance	L	Tolerance	B	Tolerance	D1				W
LMB 04 UU	3	1/4	0	0.500	0	0.750	0	0.511	0	0.469	0.039	0.012	21	27
LMB 06 UU	4	3/8	0	0.625	0	0.875	0	0.639	0	0.588	0.039	0.012	23	32
LMB 08 UU	4	1/2	0	0.875	0	1.250	0	0.963	0	0.821	0.046	0.012	52	80
LMB 10 UU	4	5/8	0	1.125	0	1.500	0	1.104	0	1.059	0.056	0.012	79	120
LMB 12 UU	5	3/4	0	1.250	0	1.625	0	1.166	0	1.176	0.056	0.015	88	140
LMB 16 UU	5	1	0	1.563	0	2.250	0	1.755	0	1.469	0.068	0.015	100	160
LMB 20 UU	6	1 1/4	0	2.000	0	2.625	0	2.005	0	1.886	0.068	0.020	160	280
LMB 24 UU	6	1 1/2	0	2.375	0	3.000	0	2.412	0	2.239	0.086	0.020	220	410
LMB 32 UU	6	2	0	3.000	0	4.000	0	3.192	0	2.838	0.103	0.025	390	810

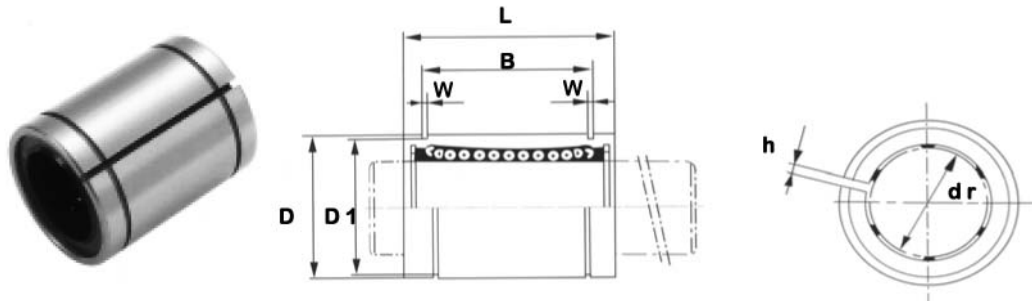

Part Number	No. of Ball Rows	Main Diameters											Basic Load Rating		
		Inscribed Circle Diameter		Outer Diameter		Length		Outer Locking Groove			Eccentricity (max)	Dynamic C (kgf)	Static Co (kgf)		
		dr	Tolerance	D	Tolerance	L	Tolerance	B	Tolerance	D1				W	h
LMB 04 UUAJ	3	1/4	0	0.500	0	0.750	0	0.511	0	0.469	0.039	1/25	0.012	21	27
LMB 06 UUAJ	4	3/8	0	0.625	0	0.875	0	0.639	0	0.588	0.039	1/25	0.012	23	32
LMB 08 UUAJ	4	1/2	0	0.875	0	1.250	0	0.963	0	0.821	0.046	3/50	0.012	52	80
LMB 10 UUAJ	4	5/8	0	1.125	0	1.500	0	1.104	0	1.059	0.056	3/50	0.012	79	120
LMB 12 UUAJ	5	3/4	0	1.250	0	1.625	0	1.166	0	1.176	0.056	3/50	0.015	88	140
LMB 16 UUAJ	5	1	0	1.563	0	2.250	0	1.755	0	1.469	0.068	3/50	0.015	100	160
LMB 20 UUAJ	6	1 1/4	0	2.000	0	2.625	0	2.005	0	1.886	0.068	1/10	0.020	160	280
LMB 24 UUAJ	6	1 1/2	0	2.375	0	3.000	0	2.412	0	2.239	0.086	3/25	0.020	220	410
LMB 32 UUAJ	6	2	0	3.000	0	4.000	0	3.192	0	2.838	0.103	3/25	0.025	390	810

# American Standard Linear Bearings Open Type

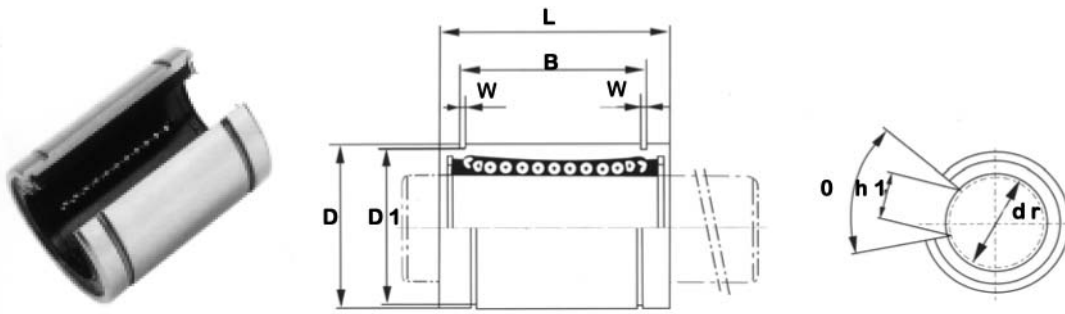

Part Number	No. of Ball Rows	Main Diameters												Basic Load Rating		
		Inscribed Circle Diameter		Outer Diameter		Length		Outer Locking Groove				Eccentricity (max)	Dynamic C (kgf)	Static Co (kgf)		
		dr	Tolerance	D	Tolerance	L	Tolerance	B	Tolerance	D1	W				h1	0
LMB 08 UUOP	3	1/2	0	0.875	0	1.250	0	0.963	0	0.821	0.046	0.340	80°	0.012	52	80
LMB 10 UUOP	3	5/8	0	1.125	0	1.500	0	1.104	0	1.059	0.056	0.375	80°	0.012	79	120
LMB 12 UUOP	4	3/4	0	1.250	0	1.625	0	1.166	0	1.176	0.056	0.438	60°	0.015	88	140
LMB 16 UUOP	4	1	0	1.563	0	2.250	0	1.755	0	1.469	0.068	0.563	50°	0.015	100	160
LMB 20 UUOP	5	1 1/4	0	2.000	0	2.625	0	2.005	0	1.886	0.068	0.625	50°	0.020	160	280
LMB 24 UUOP	5	1 1/2	0	2.375	0	3.000	0	2.412	0	2.239	0.086	0.750	50°	0.020	220	410
LMB 32 UUOP	5	2	0	3.000	0	4.000	0	3.192	0	2.838	0.103	1.000	50°	0.025	390	810