

# Inch Sleeve Bearing

## Oil Impregnated Bronze

ASTM: B-438-73 Gr 1 Type II  
SAE 841



Part No.	ID	OD	L	Part No.	ID	OD	L	Part No.	ID	OD	L	Part No.	ID	OD	L
<b>1/8 x 3/16 NOMINAL</b>				<b>5/32 x 1/4 NOMINAL</b>				<b>3/16 x 5/16 NOMINAL</b>				<b>1/4 x 3/8 NOMINAL</b>			
AA-101-8	.125	.190	5/32	AA-238	.1565	.2525	3/8	P-19-4	.1895	.3155	1/2	AA-304-7	.2505	.377	3/8
AA-101-2	.125	.190	1/4	AA-204-1	.159	.253	1/4	P-19-5	.1895	.3155	5/8	AA-304-24	.2505	.377	7/16
AA-101	.125	.190	3/8	AA-204	.159	.253	5/16	P-19-6	.1895	.3155	3/4	AA-304-2	.2505	.377	1/2
AA-101-1	.125	.190	1/2	<b>3/16 x 1/4 NOMINAL</b>				P-19-8	.1895	.3155	1	AA-304-5	.2505	.377	9/16
AA-110-1	.1265	.1895	1/8	AA-225-2	.1875	.252	1/4	SS-610-4	.190	.3145	1/4	AA-304-1	.2505	.377	5/8
AA-110-2	.1265	.1895	1/4	AA-225-1	.1875	.252	5/16	SS-610-6	.190	.3145	3/8	AA-304-22	.2505	.377	3/4
AA-110-4	.1265	.1895	5/16	AA-225-6	.1875	.252	3/8	SS-610-8	.190	.3145	1/2	AA-304-21	.2505	.377	7/8
SS-46-4	.127	.1895	1/4	AA-225-4	.1875	.252	1/2	SS-610-10	.190	.3145	5/8	AA-304-20	.2505	.377	1
SS-46-8	.127	.1895	1/2	AA-225-3	.1875	.252	5/8	SS-610-12	.190	.3145	3/4	AA-304-33	.2505	.377	1 1/8
P-12-2	.127	.1905	1/4	AA-226-1	.1885	.252	1/4	SS-610-16	.190	.3145	1	AA-304-11	.2505	.377	1 1/4
P-12-4	.127	.1905	1/2	AA-226-2	.1885	.252	3/8	<b>3/16 x 3/8 NOMINAL</b>				AA-307	.252	.377	1/4
<b>1/8 x 7/32 NOMINAL</b>				AA-226	.1885	.252	7/16	AA-346-1	.1885	.3775	1/4	AA-307-1	.252	.377	5/16
AA-223	.127	.222	1/4	AA-226-3	.1885	.252	1/2	AA-346-2	.1885	.3775	3/8	AA-307-9	.252	.377	3/8
AA-223-1	.127	.222	1/2	AA-226-4	.1885	.252	5/8	AA-346	.1885	.3775	1/2	AA-307-3	.252	.377	1/2
<b>1/8 x 1/4 NOMINAL</b>				B-34-2	.189	.252	1/4	P-20-2	.1895	.378	1/4	AA-307-10	.252	.377	5/8
B-24-1	.127	.252	1/8	B-34-3	.189	.252	3/8	P-20-3	.1895	.378	3/8	AA-307-11	.252	.377	3/4
B-24-2	.127	.252	1/4	B-34-4	.189	.252	1/2	P-20-4	.1895	.378	1/2	AA-307-12	.252	.377	1
B-24-3	.127	.252	3/8	B-34-5	.189	.252	5/8	P-20-5	.1895	.378	5/8	AA-30713	.252	.377	1 1/8
B-24-4	.127	.252	1/2	B-34-6	.189	.252	3/4	P-20-6	.1895	.378	3/4	B-46-2.5	.252	.377	5/16
SS-48-2	.127	.252	1/8	SS-68-4	.189	.252	1/4	SS-612-6	.190	.377	3/8	B-46-3	.252	.377	3/8
SS-48-4	.127	.252	1/4	SS-68-6	.189	.252	3/8	SS-612-8	.190	.377	1/2	B-46-4	.252	.377	1/2
SS-48-6	.127	.252	3/8	SS-68-8	.189	.252	1/2	SS-612-10	.190	.377	5/8	B-46-5	.252	.377	5/8
SS-48-8	.127	.252	1/2	SS-68-10	.189	.252	5/8	SS-612-12	.190	.377	3/4	B-46-6	.252	.377	3/4
P-13-1	.127	.253	1/8	SS-68-12	.189	.252	3/4	<b>7/32 x 5/16 NOMINAL</b>				B-46-7	.252	.377	7/8
P-13-2	.127	.253	1/4	P-18-2	.1895	.253	1/4	AA-318	.219	.3145	5/16	B-46-8	.252	.377	1
P-13-3	.127	.253	3/8	P-18-3	.1895	.253	3/8	AA-318-A	.219	.3145	3/8	B-46-10	.252	.377	1 1/4
P-13-4	.127	.253	1/2	P-18-4	.1895	.253	1/2	<b>7/32 x 7/16 NOMINAL</b>				SS-812-4	.252	.377	1/4
AA-224	.128	.253	1/4	P-18-5	.1895	.253	5/8	AA-410-2	.219	.440	1/2	SS-812-6	.252	.377	3/8
AA-224	.128	.253	3/8	P-18-6	.1895	.253	3/4	AA-410-3	.219	.440	3/4	SS-812-8	.252	.377	1/2
<b>1/8 x 5/16 NOMINAL</b>				<b>3/16 x 5/16 NOMINAL</b>				<b>1/4 x 5/16 NOMINAL</b>				SS-812-10	.252	.377	5/8
SS-410-4	.127	.3145	1/4	AA-309-9	.1885	.3145	3/16	AA397-1	.2505	.3145	1/4	SS-812-12	.252	.377	3/4
SS-410-6	.127	.3145	3/8	AA-309	.1885	.3145	1/4	AA-397	.2505	.3145	1/2	SS-812-14	.252	.377	7/8
SS-410-8	.127	.3145	1/2	AA-309-3	.1885	.3145	5/16	AA347-2	.2515	.3155	1/4	SS-812-16	.252	.377	1
B-25-1	.127	.315	1/8	AA-309-4	.1885	.3145	3/8	AA-347-3	.2515	.3155	3/8	SS-812-20	.252	.377	1 1/4
B-25-2	.127	.315	1/4	AA-309-8	.1885	.3145	7/16	SS-810-4	.252	.315	1/4	P-26-2	.252	.378	1/4
B-25-3	.127	.315	3/8	AA-309-14	.1885	.3145	1/2	SS-810-6	.252	.315	3/8	P-26-2.5	.252	.378	5/16
B-25-4	.127	.315	1/2	AA-309-7	.1885	.3145	5/8	SS-810-8	.252	.315	1/2	P-26-3	.252	.378	3/8
B-25-5	.127	.315	5/8	AA-309-5	.1885	.3145	3/4	SS-810-12	.252	.315	3/4	P-26-3.5	.252	.378	7/16
P-14-1	.127	.3155	1/8	B-35-2	.189	.314	1/4	P-25-2	.252	.3155	1/4	P-26-4	.252	.378	1/2
P-14-2	.127	.3155	1/4	B-35-3	.189	.314	3/8	P-25-3	.252	.3155	3/8	P-26-5	.252	.378	5/8
P-14-3	.127	.3155	3/8	B-35-4	.189	.314	1/2	P-25-4	.252	.3155	1/2	P-26-6	.252	.378	3/4
P-14-4	.127	.3155	1/2	B-35-5	.189	.314	5/8	P-25-5	.252	.3155	5/8	P-26-7	.252	.378	7/8
<b>1/8 x 3/8 NOMINAL</b>				B35-6	.189	.314	3/4	P-25-6	.252	.3155	3/4	P-26-8	.252	.378	1
AA-337-2	.127	.377	1/4	AA-331	.1895	.3145	3/16	AA-335-4	.253	.3155	1/2	P-26-9	.252	.378	1 1/8
AA-337-3	.127	.377	1/2	AA-331-2	.1895	.3145	1/4	AA-335-6	.253	.3155	5/8	P-26-10	.252	.378	1 1/4
<b>5/32 x 7/32 NOMINAL</b>				AA-331-3	.1895	.3145	3/8	AA-335-5	.253	.3155	3/4	AA-385-1	.253	.377	1/4
AA-211	.156	.220	1/4	P-19-1.5	.1895	.3145	3/16	<b>1/4 x 3/8 NOMINAL</b>				AA-385	.253	.377	1/2
AA-211-1	.156	.220	3/8	P-19-2	.1895	.3155	1/4	AA-304-35	.2505	.377	1/4	AA-385-2	.253	.377	3/4
				P-19-2.5	.1895	.3155	5/16	AA-304-9	.2505	.377	5/16	<b>1/4 x 7/16 NOMINAL</b>			
				P-19-3	.1895	.3155	3/8					AA-430	.251	.4395	3/8
												AA-430-1	.251	.4395	1/2

Tolerance: Tolerances may vary for some sizes due to different molds available at time of manufacture.

Note: Inquire for additional standard and non-standard sizes. Cast bronze and steel bushings also available by special request.

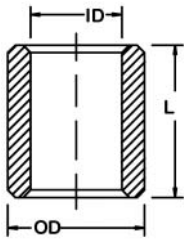

# Inch Sleeve Bearing

## Oil Impregnated Bronze

ASTM: B-438-73 Gr 1 Type II  
SAE 841



Part No.	ID	OD	L	Part No.	ID	OD	L	Part No.	ID	OD	L	Part No.	ID	OD	L
<b>1/4 x 7/16 NOMINAL</b>				<b>5/16 x 3/8 NOMINAL</b>				<b>5/16 x 7/16 NOMINAL</b>				<b>7/32 x 5/16 NOMINAL</b>			
AA-430-5	.251	.4395	5/8	AA-306-8	.3135	.377	5/8	SS-1014-4	.3145	.440	1/4	SS-1016-6	.3145	.503	3/8
AA-430-2	.251	.4395	3/4	AA-306-6	.3135	.377	3/4	SS-1014-6	.3145	.440	3/8	SS-1016-8	.3145	.503	1/2
AA-430-6	.251	.4395	7/8	B-56-3	.314	.377	3/8	SS-1014-8	.3145	.440	1/2	SS-1016-10	.3145	.503	5/8
AA-430-3	.251	.4395	1	B-56-4	.314	.377	1/2	SS1014-10	.3145	.440	5/8	SS-1016-12	.3145	.503	3/4
B-47-3	.252	.439	3/8	B-56-5	.314	.377	5/8	SS-1014-12	.3145	.440	3/4	SS-1016-14	.3145	.503	7/8
B-47-4	.252	.439	1/2	B-56-6	.314	.377	3/4	SS-1014-14	.3145	.440	7/8	SS-1016-16	.3145	.503	1
B-47-5	.252	.439	5/8	B-56-7	.314	.377	7/8	SS-1014-16	.3145	.440	1	SS-1016-20	.3145	.503	1 1/4
B-47-6	.252	.439	3/4	B-56-8	.314	.377	1	SS-1014-18	.3145	.440	1 1/8	SS-1016-24	.3145	.503	1 1/2
B-47-7	.252	.439	7/8	P-31-2	.3145	.378	1/4	SS-1014-20	.3145	.440	1 1/4	<b>3/8 x 7/16 NOMINAL</b>			
B-47-8	.252	.439	1	P-31-3	.3145	.378	3/8	P-32-2	.3145	.4405	1/4	AA-432-4	.3765	.440	1/4
SS-814-6	.252	.439	3/8	P-31-4	.3145	.378	1/2	P-32-2.5	.3145	.4405	5/16	AA-432-2	.3765	.440	3/8
SS-814-8	.252	.439	1/2	P-31-5	.3145	.378	5/8	P-32-3	.3145	.4405	3/8	AA-432-1	.3765	.440	1/2
SS-814-10	.252	.439	5/8	P-31-6	.3145	.378	3/4	P-32-4	.3145	.4405	1/2	AA-432-3	.3765	.440	3/4
SS-814-12	.252	.439	3/4	P-31-7	.3145	.378	7/8	P-32-5	.3145	.4405	5/8	SS-1214-8	.377	.440	1/2
SS-814-14	.252	.439	7/8	P-31-8	.3145	.378	1	P-32-6	.3145	.4405	3/4	SS-1214-10	.377	.440	5/8
SS-814-16	.252	.439	1	SS1012-4	.3145	.378	1/4	P-32-7	.3145	.4405	7/8	SS-1214-12	.377	.440	3/4
AA-412-10	.252	.4395	3/8	SS-1012-6	.3145	.378	3/8	P-32-8	.3145	.4405	1	SS-1214-16	.377	.440	1
AA-412-7	.252	.4395	1/2	SS-1012-8	.3145	.378	1/2	P-32-9	.3145	.4405	1 1/8	P-37-4	.377	.4405	1/2
AA-412-6	.252	.4395	5/8	SS-1012-10	.3145	.378	5/8	P-32-10	.3145	.4405	1 1/4	P-37-5	.377	.4405	5/8
AA-412-1	.252	.4395	3/4	SS-1012-12	.3145	.378	3/4	AA-417-7	.3155	.4395	1/4	P-37-6	.377	.4405	3/4
AA-412-8	.252	.4395	1	SS-1012-14	.3145	.378	7/8	AA-417	.3155	.4395	1/2	P-37-8	.377	.4405	1
P-27-3	.252	.4405	3/8	SS-1012-16	.3145	.378	1	AA-417-3	.3155	.4395	3/4	<b>3/8 x 1/2 NOMINAL</b>			
P-27-4	.252	.4405	1/2	<b>5/16 x 7/16 NOMINAL</b>				<b>7/32 x 5/16 NOMINAL</b>				<b>3/8 x 1/2 NOMINAL</b>			
P-27-5	.252	.4405	5/8	AA-403	.3115	.441	3/8	AA-520-8	.3125	.503	3/8	AA-521-4	.375	.503	1/4
P-27-6	.252	.4405	3/4	AA-403-2	.3115	.441	1/2	AA-520-3	.3125	.503	1/2	AA-521-9	.375	.503	3/8
P-27-7	.252	.4405	7/8	AA-407-1	.3125	.440	1/4	AA-520-4	.3125	.503	5/8	AA-521-8	.375	.503	7/16
P-27-8	.252	.4405	1	AA-407-10	.3125	.440	5/16	AA-520-1	.3125	.503	3/4	AA-521-1	.375	.503	1/2
<b>1/4 x 1/2 NOMINAL</b>				AA-407-7	.3125	.440	3/8	AA-520-2	.3125	.503	7/8	AA-521-10	.375	.503	5/8
AA-519-4	.252	.5015	5/16	AA-407-3	.3125	.440	1/2	AA-520-5	.3125	.503	1	AA-521	.375	.503	3/4
AA-519-1	.252	.5015	1/2	AA-407-2	.3125	.440	5/8	B-58-3	.314	.502	3/8	AA-521-2	.375	.503	7/8
AA-519-2	.252	.5015	3/4	AA-407-4	.3125	.440	3/4	B-58-4	.314	.502	1/2	AA-521-11	.375	.503	1
AA-519-3	.252	.5015	1	AA-401-17	.3135	.4395	1/4	B-58-5	.314	.502	5/8	AA-521-12	.375	.503	1 1/4
B-48-3	.252	.502	3/8	AA-401-25	.3135	.4395	5/16	B-58-6	.314	.502	3/4	AA-507-12	.3765	.503	3/16
B-48-4	.252	.502	1/2	AA-401-2	.3135	.4395	3/8	B-58-7	.314	.502	7/8	AA-507-19	.3765	.503	1/4
B-48-5	.252	.502	5/8	AA-401-20	.3135	.4395	7/16	B-58-8	.314	.502	1	AA-507-13	.3765	.503	5/16
B-48-6	.252	.502	3/4	AA-401-3	.3135	.4395	1/2	B-58-10	.314	.502	1 1/4	AA-507-11	.3765	.503	3/8
B-48-7	.252	.502	7/8	AA-401-21	.3135	.4395	5/8	B-58-12	.314	.502	1 1/2	AA-507-4	.3765	.503	7/16
B-48-8	.252	.502	1	AA-401-11	.3135	.4395	11/16	B-58-14	.314	.502	1 3/4	AA-507-10	.3765	.503	1/2
B-48-10	.252	.502	1 1/4	AA-401-5	.3135	.4395	3/4	AA-506-16	.314	.503	1/4	AA-507-5	.3765	.503	5/8
P-28-2.5	.252	.503	5/16	AA-401-12	.3135	.4395	7/8	AA-506-2	.314	.503	3/8	AA-507-2	.3765	.503	3/4
P-28-4	.252	.503	1/2	AA-401-1	.3135	.4395	1	AA-506-7	.314	.503	1/2	AA-507-3	.3765	.503	7/8
P-26-6	.252	.503	3/4	AA-401	.3135	.4395	1 1/8	AA-506-1	.314	.503	9/16	AA-507-23	.3765	.503	1
P-28-8	.252	.503	1	AA-401-6	.3135	.4395	1 1/4	AA-506-3	.314	.503	5/8	AA-507-17	.3765	.503	1 1/8
P-28-10	.252	.503	1 1/4	AA-401-8	.3135	.4395	1 3/8	AA-506-8	.314	.503	3/4	B-68-3	.377	.502	3/8
SS816-8	.252	.503	1/2	B-57-2	.314	.439	1/4	AA-506-9	.314	.503	1	B-68-4	.377	.502	1/2
SS-816-12	.252	.503	3/4	B-57-3	.314	.439	3/8	P-33-3	.3145	.502	3/8	B-68-5	.377	.502	5/8
SS-816-16	.252	.503	1	B-57-4	.314	.439	1/2	P-33-4	.3145	.503	1/2	B-68-6	.377	.502	3/4
SS-816-20	.252	.503	1 1/4	B-57-5	.314	.439	5/8	P-33-5	.3145	.503	5/8	B-68-7	.377	.502	7/8
<b>5/16 x 3/8 NOMINAL</b>				B-57-6	.314	.439	3/4	P-33-6	.3145	.503	3/4	B-68-8	.377	.502	1
AA-306-11	.377	.377	1/4	B-57-7	.314	.439	7/8	P-33-7	.3145	.503	7/8	B-68-10	.377	.502	1 1/4
AA-306-1	.377	.377	5/16	B-57-8	.314	.439	1	P-33-8	.3145	.503	1	P-38-1.5	.377	.503	3/16
AA-306-3	.377	.377	3/8	B-57-10	.314	.439	1 1/4	P-33-10	.3145	.503	1 1/4	P-38-2	.377	.503	1/4
AA-306-7	.377	.377	1/2	B-57-11	.314	.439	1 3/8	P-33-12	.3145	.503	1 1/2	P-38-2.5	.377	.503	5/16

Tolerance: Tolerances may vary for some sizes due to different molds available at time of manufacture.

Note: Inquire for additional standard and non-standard sizes. Cast bronze and steel bushings also available by special request.

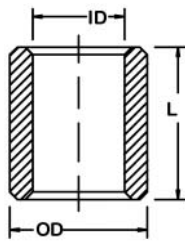

# Inch Sleeve Bearing

## Oil Impregnated Bronze

ASTM: B-438-73 Gr 1 Type II  
SAE 841



Part No.	ID	OD	L	Part No.	ID	OD	L	Part No.	ID	OD	L	Part No.	ID	OD	L
<b>3/8 x 1/2 NOMINAL</b>				<b>3/8 x 5/8 NOMINAL</b>				<b>7/16 x 9/16 NOMINAL</b>				<b>7/16 x 5/8 NOMINAL</b>			
P-38-3.5	.377	.503	7/16	AA-630-16	.376	.627	7/16	B-79-3	.439	.5645	3/8	SS-1420-6	.440	.628	3/8
P-38-4	.377	.503	1/2	AA-630-11	.376	.627	1/2	B-79-4	.439	.5645	1/2	SS-1420-8	.440	.628	1/2
P-38-5	.377	.503	5/8	AA-630-6	.376	.627	5/8	B-79-5	.439	.5645	5/8	SS-1420-10	.440	.628	5/8
P-38-6	.377	.503	3/4	AA-630-12	.376	.627	3/4	B-79-6	.439	.5645	3/4	SS-1420-12	.440	.628	3/4
P-38-7	.377	.503	7/8	AA-630	.376	.627	7/8	B-79-7	.439	.5645	7/8	SS-1420-14	.440	.628	7/8
P-38-8	.377	.503	1	AA-630-7	.376	.627	1	B-79-8	.439	.5645	1	SS-1420-16	.440	.628	1
P-38-9	.377	.503	1 1/8	AA-630-1	.376	.627	1 1/8	B-79-10	.439	.5645	1 1/4	SS-1420-20	.440	.628	1 1/4
P-38-10	.377	.503	1 1/4	AA-630-2	.376	.627	1 1/4	AA-515-1	.439	.565	5/16	SS-1420-24	.440	.628	1 1/2
AA502-5	.378	.5025	1/4	B-610-3	.377	.627	3/8	AA-515-21	.439	.565	3/8	<b>7/16 x 11/16 NOMINAL</b>			
AA-502	.378	.5025	1/2	B-610-4	.377	.627	1/2	AA-515-2	.439	.565	1/2	B-711-4	.439	.690	1/2
AA-502-3	.378	.5025	5/8	B-610-5	.377	.627	5/8	AA-515-3	.439	.565	5/8	B-711-8	.439	.690	1
AA-502-1	.378	.5025	3/4	B-610-6	.377	.627	3/4	AA-515	.439	.565	3/4	B-711-12	.439	.690	1 1/2
AA-502-2	.378	.5025	1	B-610-7	.377	.627	7/8	AA-515-12	.439	.565	13/16	P-45-4	.4395	.6905	1/2
SS-1216-4	.378	.503	1/4	B-610-8	.377	.627	1	AA-515-6	.439	.565	15/16	P-45-8	.4395	.6905	1
SS-1216-6	.378	.503	3/8	B-610-10	.377	.627	1 1/4	AA-515-8	.439	.565	1	P-45-12	.4395	.6905	1 1/2
SS-1216-8	.378	.503	1/2	P-40-3	.377	.628	3/8	P-43-3	.4395	.5655	3/8	P-45-16	.4395	.6905	1 1/2
SS-1216-10	.378	.503	5/8	P-40-4	.377	.628	1/2	P-43-4	.4395	.5655	1/2	SS-1422-8	.4395	.6905	1/2
SS-1216-12	.378	.503	3/4	P-40-5	.377	.628	5/8	P-43-5	.4395	.5655	5/8	SS-1422-16	.4395	.6905	1
SS-1216-14	.378	.503	7/8	P-40-6	.377	.628	3/4	P-43-6	.4395	.5655	3/4	SS-1422-24	.4395	.6905	1 1/2
SS-1216-16	.378	.503	1	P-40-7	.377	.628	7/8	P-43-7	.4395	.5655	7/8	<b>1/2 x 5/8 NOMINAL</b>			
SS-1216-18	.378	.503	1 1/8	P-40-8	.377	.628	1	P-43-8	.4395	.5655	1	AA-628-21	.5015	.628	5/16
SS-1216-20	.378	.503	1 1/4	P-40-10	.377	.628	1 1/4	P-43-10	.4395	.5655	1 1/4	AA-628-27	.5015	.628	3/8
<b>3/8 x 9/16 NOMINAL</b>				SS-1220-6	.378	.628	3/8	SS-1418-6	.440	.565	3/8	AA-628-8	.5015	.628	7/16
AA-516-5	.3765	.5655	3/8	SS-1220-8	.378	.628	1/2	SS-1418-8	.440	.565	1/2	AA-628-10	.5015	.628	1/2
AA-516-6	.3765	.5655	1/2	SS-1220-10	.378	.628	5/8	SS-1418-10	.440	.565	5/8	AA-628-13	.5015	.628	9/16
AA-516-3	.3765	.5655	9/16	SS-1220-12	.378	.628	3/4	SS-1418-12	.440	.565	3/4	AA-628-25	.5015	.628	5/8
AA-516	.3765	.5655	11/16	SS-1220-14	.378	.628	7/8	SS-1418-14	.440	.565	7/8	AA-628-12	.5015	.628	11/16
AA-516-10	.3765	.5655	3/4	SS-1220-16	.378	.628	1	SS-1418-16	.440	.565	1	AA-628-6	.5015	.628	3/4
AA-516-8	.3765	.5655	1	SS-1220-20	.378	.628	1 1/4	SS-1418-20	.440	.565	1 1/4	AA-628-20	.5015	.628	7/8
AA-516-2	.3765	.5655	1 1/4	SS-1220-24	.378	.628	1 1/2	<b>7/16 x 5/8 NOMINAL</b>				AA-628	.5015	.628	1
B-69-3	.377	.5645	3/8	<b>3/8 x 11/16 NOMINAL</b>				AA-627-5	.439	.627	3/8	AA-628-11	.5015	.628	1 1/4
B-69-4	.377	.5645	1/2	AA-615	.3765	.689	3/4	AA-627-13	.439	.627	7/16	AA-628-5	.5015	.628	1 1/2
B-69-5	.377	.5645	5/8	AA-615-2	.3765	.689	1 1/2	AA-627-8	.439	.627	1/2	B-810-4	.502	.628	1/2
B-69-6	.377	.5645	3/4	<b>3/8 x 3/4 NOMINAL</b>				AA-627-3	.439	.627	5/8	B-810-5	.502	.628	5/8
B-69-7	.377	.5645	7/8	AA-707-2	.377	.753	1/2	AA-627	.439	.627	3/4	B-810-6	.502	.628	3/4
B-69-8	.377	.5645	1	AA-707-3	.377	.753	3/4	AA-627-4	.439	.627	1	B-810-7	.502	.628	7/8
B-69-10	.377	.5645	1 1/4	AA-707	.377	.753	1	AA-627-1	.439	.627	1 1/4	B-810-8	.502	.628	1
P-39-3	.377	.5655	3/8	AA-707-4	.377	.753	1 1/4	AA-627-7	.439	.627	1 1/2	B-810-9	.502	.628	1 1/8
P-39-4	.377	.5655	1/2	B-612-3	.377	.753	3/8	B-710-3	.439	.628	3/8	B-810-10	.502	.628	1 1/4
P-39-5	.377	.5655	5/8	B-612-4	.377	.753	1/2	B-710-4	.439	.628	1/2	B-810-12	.502	.628	1 1/2
P-39-6	.377	.5655	3/4	B-612-6	.377	.753	3/4	B-710-5	.439	.628	5/8	P-50-2.5	.502	.628	5/16
P-39-7	.377	.5655	7/8	B-612-6	.377	.753	3/4	B-710-6	.439	.628	3/4	P-50-3	.502	.628	3/8
P-39-8	.377	.5655	1	B-612-8	.377	.753	1	B-710-7	.439	.628	7/8	P-50-3.5	.502	.628	7/16
P-39-10	.377	.5655	1 1/4	B-612-10	.377	.753	1 1/4	B-710-8	.439	.628	1	P-50-4	.502	.628	1/2
SS-1218-6	.378	.565	3/8	P-41-3	.377	.753	3/8	B-710-10	.439	.628	1 1/4	P-50-4.5	.502	.628	9/16
SS-1218-8	.378	.565	1/2	P-41-4	.377	.753	1/2	P-44-3	.4395	.628	3/8	P-50-5	.502	.628	5/8
SS-1218-10	.378	.565	5/8	P-41-6	.377	.753	3/4	P-44-4	.4395	.628	1/2	P-50-5.5	.502	.628	11/16
SS-1218-12	.378	.565	3/4	P-41-8	.377	.753	1	P-44-5	.4395	.628	5/8	P-50-6	.502	.628	3/4
SS-1218-14	.378	.565	7/8	P-41-10	.377	.753	1 1/4	P-44-6	.4395	.628	3/4	P-50-7	.502	.628	7/8
SS-1218-16	.378	.565	1	SS-1224-6	.378	.753	3/8	P-44-7	.4395	.628	7/8	P-50-8	.502	.628	1
SS-1218-20	.378	.565	1 1/4	SS-1224-8	.378	.753	1/2	P-44-8	.4395	.628	1	P-50-9	.502	.628	1 1/8
<b>3/8 x 9/16 NOMINAL</b>				SS-1224-12	.378	.753	3/4	P-44-10	.4395	.628	1 1/4	P-50-10	.502	.628	1 1/4
AA-630-8	.376	.627	3/8	SS-1224-16	.378	.753	1	P-44-12	.4395	.628	1 1/2	P-50-12	.502	.628	1 1/2
				SS-1224-20	.378	.753	1 1/4								

Tolerance: Tolerances may vary for some sizes due to different molds available at time of manufacture.

Note: Inquire for additional standard and non-standard sizes. Cast bronze and steel bushings also available by special request.

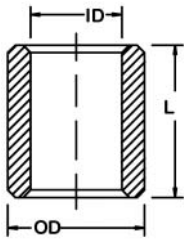

# Inch Sleeve Bearing

## Oil Impregnated Bronze

ASTM: B-438-73 Gr 1 Type II  
SAE 841



Part No.	ID	OD	L	Part No.	ID	OD	L	Part No.	ID	OD	L	Part No.	ID	OD	L
<b>1/2 x 5/8 NOMINAL</b>				<b>1/2 x 11/16 NOMINAL</b>				<b>1/2 x 3/4 NOMINAL</b>				<b>1/2 x 1 NOMINAL</b>			
SS-1620-6	.502	.628	3/8	SS-1622-24	.503	.690	1 1/2	SS-1624-14	.503	.753	7/8	P-55-8	.502	1.004	1
SS-1620-8	.502	.628	1/2	AA-618-16	.504	.690	1/4	SS-1624-16	.503	.753	1	P-55-12	.502	1.004	1 1/2
SS-1620-10	.502	.628	5/8	AA-618-1	.504	.690	1/2	SS-1624-18	.503	.753	1 1/8	P-55-16	.502	1.004	2
SS-1620-12	.502	.628	3/4	AA-618-13	.504	.690	9/16	SS-1624-20	.503	.753	1 1/4	SS-1632-12	.503	1.004	3/4
SS-1620-14	.502	.628	7/8	AA-618-12	.504	.690	5/8	SS-1624-24	.503	.753	1 1/2	SS-1632-16	.503	1.004	1
SS-1620-16	.502	.628	1	AA-618-11	.504	.690	3/4	SS-1624-28	.503	.753	1 3/4	SS-1632-24	.503	1.004	1 1/2
SS-1620-18	.502	.628	1 1/8	AA-618-8	.504	.690	7/8	SS-1624-32	.503	.753	2	SS-1632-32	.503	1.004	2
SS-1620-20	.502	.628	1 1/4	AA-618-6	.504	.690	1	<b>1/2 x 13/16 NOMINAL</b>				<b>9/16 x 11/16 NOMINAL</b>			
SS-1620-24	.502	.628	1 1/2	AA-618-2	.504	.690	1 1/8	AA-886-3	.501	.815	3/4	AA-620-3	.5635	.691	7/16
AA-607-1	.5025	.629	1/2	<b>1/2 x 3/4 NOMINAL</b>				AA-886-1	.501	.815	1	AA-620-7	.5635	.691	1/2
AA-607-2	.5025	.629	5/8	AA-742-1	.5005	.752	1/2	AA-886-4	.501	.815	1 1/2	AA-620-8	.5635	.691	5/8
AA-607-5	.5025	.629	3/4	AA-742-2	.5005	.752	3/4	B-813-4	.502	.815	1/2	AA-620-1	.5635	.691	3/4
AA-607-3	.5025	.629	1	AA-742-4	.5005	.752	1 1/8	B-813-6	.502	.815	3/4	AA-620	.5635	.691	1
AA-607-6	.5025	.629	1 1/4	AA-742-3	.5005	.752	1 1/4	B-813-8	.502	.815	1	AA-620-5	.5635	.691	1 1/4
AA-634-4	.5025	.6275	1/2	AA-742-3	.5005	.752	1 1/4	B-813-12	.502	.815	1 1/2	P-56-4	.5645	.6905	1/2
AA-634-5	.5025	.6275	1	AA-753	.5015	.752	1/2	P-53-4	.502	.8165	1/2	P-56-5	.5645	.6905	5/8
<b>1/2 x 11/16 NOMINAL</b>				AA-7531	.5015	.752	9/16	P-53-6	.502	.8165	3/4	P-56-6	.5645	.6905	3/4
AA-650-4	.5015	.690	3/8	AA-753-5	.5015	.752	3/4	P-53-8	.502	.8165	1	P-56-8	.5645	.6905	1
AA-650-1	.5015	.690	1/2	AA-753-2	.5015	.752	1	P-53-12	.502	.8165	1 1/2	P-56-10	.5645	.6905	1 1/4
AA-650-6	.5015	.690	9/16	AA-753-4	.5015	.752	1 1/2	SS1626-8	.503	.815	1/2	P-56-12	.5645	.6905	1 1/2
AA-650-9	.5015	.690	5/8	B-812-4	.502	.753	1/2	SS-1626-12	.503	.815	3/4	SS-1822-8	.565	.690	1/2
AA-650	.5015	.690	3/4	B-812-5	.502	.753	1/2	SS-1626-16	.503	.815	1	SS-1822-12	.565	.690	3/4
AA-650-7	.5015	.690	7/8	B-812-6	.502	.753	3/4	SS-1626-24	.503	.815	1 1/2	SS-1822-16	.565	.690	1
AA-650-2	.5015	.690	1	B-812-7	.502	.753	7/8	<b>1/2 x 7/8 NOMINAL</b>				SS-1822-20	.565	.690	1 1/4
AA-650-5	.5015	.690	1 1/8	B-812-8	.502	.753	1	B-814-4	.502	.878	1/2	SS-1822-24	.565	.690	1 1/2
AA-650-12	.5015	.690	1 1/4	B-812-8	.502	.753	1	B-814-4	.502	.878	5/8	B-911-4	.565	.691	1/2
AA-650-3	.5015	.690	1 1/2	B-812-9	.502	.753	1 1/8	B-814-6	.502	.878	3/4	B-911-6	.565	.691	3/4
B-811-4	.502	.690	1/2	B-812-10	.502	.753	1 1/4	B-814-6	.502	.878	3/4	B-911-8	.565	.691	1
B-811-5	.502	.690	5/8	B-812-12	.502	.753	1 1/2	B-814-7	.502	.878	7/8	B-911-12	.565	.691	1 1/2
B-811-6	.502	.690	3/4	B-812-14	.502	.753	1 3/4	B-814-8	.502	.878	1	AA-658-5	.568	.689	1 1/8
B-811-7	.502	.690	7/8	B-812-16	.502	.753	2	B-814-10	.502	.878	1 1/4	AA-658-1	.568	.689	1 1/2
B-811-8	.502	.690	1	P-52-3	.502	.753	3/8	B-814-12	.502	.878	1 1/2	AA-658	.568	.689	2 3/8
B-811-9	.502	.690	1 1/8	P-52-4	.502	.753	1/2	P-54-4	.502	.879	1/2	<b>9/16 x 3/4 NOMINAL</b>			
B-811-10	.502	.690	1 1/4	P-52-5	.502	.753	5/8	P-54-5	.502	.879	5/8	AA-711-6	.5635	.7535	5/8
B-811-12	.502	.690	1 1/2	P-52-6	.502	.753	3/4	P-54-6	.502	.879	3/4	AA-711-1	.5635	.7535	3/4
P-51-3	.502	.6905	3/8	P-52-7	.502	.753	7/8	P-54-7	.502	.879	7/8	AA-711-3	.5635	.7535	1
P-51-4	.502	.6905	1/2	P-52-8	.502	.753	1	P-54-8	.502	.879	1	AA-711-5	.5635	.7535	1 1/4
P-51-5	.502	.6905	5/8	P-52-9	.502	.753	1 1/8	P-54-10	.502	.879	1 1/4	AA-711-1	.5635	.7535	1 3/8
P-51-6	.502	.6905	3/4	P-52-10	.502	.753	1 1/4	P-54-12	.502	.879	1 1/2	AA-711-2	.5635	.7535	1 1/2
P-51-7	.502	.6905	7/8	P-52-12	.502	.753	1 1/2	SS-1628-8	.503	.878	1/2	P-57-4	.5645	.753	1/2
P-51-8	.502	.6905	1	P-52-14	.502	.753	1 3/4	SS-1628-10	.503	.878	5/8	P-57-6	.5645	.753	3/4
P-51-9	.502	.6905	1 1/8	P-52-16	.502	.753	2	SS-1628-12	.503	.878	3/4	P-57-8	.5645	.753	1
P-51-10	.502	.6905	1 1/4	AA-744-5	.5025	.753	1/2	SS-1628-14	.503	.878	7/8	P-57-10	.5645	.753	1 1/4
P-51-12	.502	.6905	1 1/2	AA-744-9	.5025	.753	5/8	SS-1628-16	.503	.878	1	P-57-12	.5645	.753	1 1/2
AA-631-13	.5025	.689	3/8	AA-744-4	.5025	.753	3/4	SS-1628-24	.503	.878	1 1/2	B-912-4	.565	.753	1/2
AA-631	.5025	.689	3/4	AA-744-10	.5025	.753	7/8	AA-842-7	.503	.879	1/2	B-912-6	.565	.753	3/4
AA-631-1	.5025	.689	1 1/4	AA-744-3	.5025	.753	1	AA-842-4	.503	.879	3/4	B-912-8	.565	.753	1
SS-1622-8	.503	.690	1/2	AA-744	.5025	.753	1 1/4	AA-842-3	.503	.879	1	B-912-12	.565	.753	1 1/2
SS-1622-10	.503	.690	5/8	AA-744-1	.5025	.753	1 1/2	AA-842-2	.503	.879	1 1/4	SS-1824-8	.565	.753	1/2
SS-1622-12	.503	.690	3/4	AA-744-2	.5025	.753	1 3/4	AA-842	.503	.879	1 1/2	SS-1824-12	.565	.753	3/4
SS-1622-14	.503	.690	7/8	SS-1624-6	.503	.753	3/8	<b>1/2 x 1 NOMINAL</b>				SS-1824-16	.565	.753	1
SS-1622-16	.503	.690	1	SS-1624-8	.503	.753	1/2	P-55-6	.502	1.004	3/4	SS-1824-20	.565	.753	1 1/4
SS-1622-18	.503	.690	1 1/8	SS-1624-10	.503	.753	5/8					SS-1824-24	.565	.753	1 1/2
SS-1622-20	.503	.690	1 1/4	SS-1624-12	.503	.753	3/4								

Tolerance: Tolerances may vary for some sizes due to different molds available at time of manufacture.

Note: Inquire for additional standard and non-standard sizes. Cast bronze and steel bushings also available by special request.

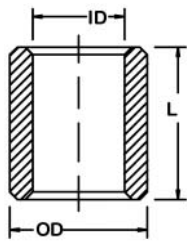

# Inch Sleeve Bearing

## Oil Impregnated Bronze

ASTM: B-438-73 Gr 1 Type II  
SAE 841



Part No.	ID	OD	L	Part No.	ID	OD	L	Part No.	ID	OD	L	Part No.	ID	OD	L
<b>9/16 x 3/4 NOMINAL</b>				<b>5/8 x 3/4 NOMINAL</b>				<b>5/8 x 13/16 NOMINAL</b>				<b>5/8 x 15/16 NOMINAL</b>			
AA-709-7	.566	.753	1/2	P-62-10	.627	.753	1 1/4	SS-2026-16	.628	.815	1	P-65-5	.627	.9415	5/8
AA-709-8	.566	.753	3/4	P-62-12	.627	.753	1 1/2	SS-2026-20	.628	.815	1 1/4	P-65-6	.627	.9415	3/4
AA-709	.566	.753	1	B-1012-4	.628	.753	1/2	SS-2026-24	.628	.815	1 1/2	P-65-8	.627	.9415	1
AA-709-5	.566	.753	1 1/4	B-1012-5	.628	.753	5/8	SS-2026-28	.628	.815	1 3/4	AA-946	.628	.940	5/8
AA-709-6	.566	.753	1 1/2	B-1012-6	.628	.753	3/4	AA-814-3	.628	.8155	5/8	AA-946-2	.628	.940	3/4
<b>9/16 x 13/16 NOMINAL</b>				<b>5/8 x 13/16 NOMINAL</b>				<b>5/8 x 7/8 NOMINAL</b>				<b>5/8 x 1 NOMINAL</b>			
AA-807-3	.563	.815	3/4	B-1012-7	.628	.753	7/8	AA-880-4	.625	.877	1/2	B-1016-4	.627	1.003	1/2
AA-807-2	.563	.815	1	B-1012-8	.628	.753	1	AA-880-2	.625	.877	3/4	B-1016-5	.627	1.003	5/8
AA-807-4	.563	.815	1 1/4	B-1012-9	.628	.753	1 1/8	AA-880-1	.625	.877	1	B-1016-6	.627	1.003	3/4
P-58-4	.5645	.8165	1/2	B-1012-10	.628	.753	1 1/4	AA-880	.625	.877	1 1/2	B-1016-7	.627	1.003	7/8
P-58-6	.5645	.8165	3/4	B-1012-11	.628	.753	1 1/2	AA-832-11	.627	.878	1/2	B-1016-8	.627	1.003	1
P-58-8	.5645	.8165	1	SS-2024-8	.628	.753	1/2	AA-832-12	.627	.878	5/8	B-1016-10	.627	1.003	1 1/4
P-58-10	.5645	.8165	1 1/4	SS-2024-10	.628	.753	5/8	AA-832-6	.627	.878	3/4	B-1016-12	.627	1.003	1 1/2
P-58-12	.5645	.8165	1 1/2	SS-2024-12	.628	.753	3/4	AA-832-8	.627	.878	7/8	B-1016-14	.627	1.003	1 3/4
B-913-4	.565	.815	1/2	SS-2024-14	.628	.753	7/8	AA-832-1	.627	.878	1	B-1016-16	.627	1.003	2
B-913-6	.565	.815	3/4	SS-2024-16	.628	.753	1	AA-832-13	.627	.878	1 1/8	P-66-4	.627	1.004	1/2
B-913-8	.565	.815	1	SS-2024-18	.628	.753	1 1/8	AA-832-4	.627	.878	1 1/4	P-66-5	.627	1.004	5/8
B-913-10	.565	.815	1 1/4	SS-2024-20	.628	.753	1 1/4	AA-832-5	.627	.878	1 1/2	P-66-6	.627	1.004	3/4
B-913-12	.565	.815	1 1/2	SS-2024-24	.628	.753	1 1/2	AA-832-9	.627	.878	1 5/8	P-66-7	.627	1.004	7/8
SS-1826-8	.565	.815	1/2	<b>5/8 x 13/16 NOMINAL</b>				AA-832-18	.627	.878	2	P-66-8	.627	1.004	1
SS-1826-12	.565	.815	3/4	AA-810-4	.625	.815	1/2	B-1014-5	.627	.878	5/8	P-66-10	.627	1.004	1 1/4
SS-1826-16	.565	.815	1	AA-810-2	.625	.815	5/8	B-1014-6	.627	.878	3/4	P-66-12	.627	1.004	1 1/2
SS-1826-20	.565	.815	1 1/4	AA-810-10	.625	.815	3/4	B-1014-7	.627	.878	7/8	P-66-14	.627	1.004	1 3/4
SS-1826-24	.565	.815	1 1/2	AA-810-1	.625	.815	7/8	B-1014-8	.627	.878	1	P-66-16	.627	1.004	2
<b>9/16 x 7/8 NOMINAL</b>				AA-810-7	.625	.815	1	B-1014-10	.627	.878	1 1/4	SS-2032-8	.628	1.003	1/2
AA-863-3	.567	.877	1	AA-810-11	.625	.815	1 1/4	B-1014-12	.627	.878	1 1/2	SS-2032-10	.628	1.003	5/8
AA-863	.567	.877	1 3/8	AA-810	.625	.815	1 3/8	B-1014-14	.627	.878	1 3/4	SS-2032-12	.628	1.003	3/4
<b>5/8 x 3/4 NOMINAL</b>				AA-810-12	.625	.815	1 1/2	B-1014-16	.627	.878	2	SS-2032-14	.628	1.003	7/8
AA-724-8	.626	.753	1/2	AA-811-7	.627	.815	3/4	P-64-4	.627	.879	1/2	SS-2032-16	.628	1.003	1
AA-724-2	.626	.753	7/8	AA-811-6	.627	.815	1	P-64-5	.627	.879	5/8	SS-2032-20	.628	1.003	1 1/4
AA-724-3	.626	.753	1	AA-811-2	.627	.815	1 1/4	P-64-6	.627	.879	3/4	SS-2032-24	.628	1.003	1 1/2
AA-724	.626	.753	1 1/8	AA-811-5	.627	.815	1 3/8	P-64-7	.627	.879	7/8	SS-2032-28	.628	1.003	1 3/4
AA-724-5	.626	.753	1 1/4	AA-811-3	.627	.815	1 1/2	P-64-8	.627	.879	1	SS-2032-32	.628	1.003	2
AA-741	.627	.752	1/2	AA-811-1	.627	.815	1 3/4	P-64-9	.627	.879	1 1/8	AA-1011-12	.628	1.0035	3/4
AA-741-1	.627	.752	5/8	AA-811	.627	.815	2	P-64-10	.627	.879	1 1/4	AA-1011-5	.628	1.0035	7/8
AA-741-4	.627	.752	3/4	B-1013-4	.627	.815	1/2	P-64-12	.627	.879	1 1/2	AA-1011-3	.628	1.0035	1
AA-710-13	.627	.753	3/8	B-1013-5	.627	.815	5/8	P-64-14	.627	.879	1 3/4	AA-1011-4	.628	1.0035	1 1/8
AA-710-27	.627	.753	1/2	B-1013-6	.627	.815	3/4	P-64-16	.627	.879	2	AA-1011-1	.628	1.0035	1 1/4
AA-710-19	.627	.753	5/8	B-1013-7	.627	.815	7/8	SS-2028-8	.628	.878	1/2	AA-1011-13	.628	1.0035	1 3/8
AA-710-6	.627	.753	3/4	B-1013-8	.627	.815	1	SS-2028-10	.628	.878	5/8	AA-1011	.628	1.0035	1 1/2
AA-710-16	.627	.753	7/8	B-1013-10	.627	.815	1 1/4	SS-2028-12	.628	.878	3/4	<b>11/16 x 13/16 NOMINAL</b>			
AA-710-3	.627	.753	1	B-1013-12	.627	.815	1 1/2	SS-2028-14	.628	.878	7/8	AA-812-1	.6885	.815	1
AA-710-8	.627	.753	1 1/8	B-1013-14	.627	.815	2	SS-2028-16	.628	.878	1	AA-812	.6885	.815	1 1/4
AA-710-5	.627	.753	1 1/4	P-63-4	.627	.8165	1/2	SS-2028-18	.628	.878	1 1/8				
AA-710-4	.627	.753	1 1/2	P-63-5	.627	.8165	5/8	SS-2028-20	.628	.878	1 1/4				
P-62-3	.627	.753	3/8	P-63-6	.627	.8165	3/4	SS-2028-24	.628	.878	1 1/2				
P-62-4	.627	.753	1/2	P-63-7	.627	.8165	7/8	SS-2028-28	.628	.878	1 3/4				
P-62-5	.627	.753	5/8	P-63-8	.627	.8165	1	SS-2028-32	.628	.878	2				
P-62-6	.627	.753	3/4	P-63-10	.627	.8165	1 1/4								
P-62-7	.627	.753	7/8	P-63-12	.627	.8165	1 1/2								
P-62-8	.627	.753	1	P-63-14	.627	.8165	1 3/4								
P-62-9	.627	.753	1 1/8	SS-2026-8	.628	.815	1/2								
				SS-2026-10	.628	.815	5/8								
				SS-2026-12	.628	.815	3/4								
				SS-2026-14	.628	.815	7/8								

Tolerance: Tolerances may vary for some sizes due to different molds available at time of manufacture.

Note: Inquire for additional standard and non-standard sizes. Cast bronze and steel bushings also available by special request.

















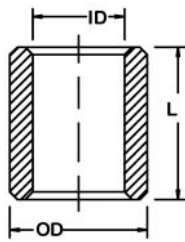

# Inch Sleeve Bearing

## Oil Impregnated Bronze

ASTM: B-438-73 Gr 1 Type II  
SAE 841



Part No.	ID	OD	L	Part No.	ID	OD	L
<b>2-3/4 x 3-1/4 NOMINAL</b>				<b>3-1/2 x 4 NOMINAL</b>			
SS-88104-32	2.754	3.255	2	AA-4000-3	3.5035	4.004	2
SS-88104-48	2.754	3.255	3	AA-4000-5	3.5035	4.004	3
SS-88104-64	2.754	3.255	4	AA-4000-6	3.5035	4.004	3 1/2
B-4452-16	2.755	3.255	2	AA-4000	3.5035	4.004	4
B-4452-25	2.755	3.255	3	SS-112128-48	3.505	4.006	3
B-4452-32	2.755	3.255	4	SS-112128-56	3.505	4.006	3 1/2
P-275-16	2.755	3.257	2	SS-112128-64	3.505	4.006	4
P-275-24	2.755	3.257	3	P-350-16	3.507	4.008	2
P-275-32	2.755	3.257	4	P-350-24	3.507	4.008	3
<b>2-15/16 x 3-5/16 NOMINAL</b>				P-350-28	3.507	4.008	3 1/2
SS-94106-48	2.940	3.315	3	P-350-32	3.507	4.008	4
AA-3301-3	2.940	3.315	3	<b>4 x 4-1/2 NOMINAL</b>			
<b>3 x 3-1/4 NOMINAL</b>				AA-4500	4.0035	4.504	4
AA-3200-5	3.002	3.255	1 1/4	AA-4500-2	4.0035	4.504	6
AA-3200	3.002	3.255	2	AA-128144-64	4.0035	4.504	4
AA-3200-2	3.002	3.255	3	AA-1281144-96	4.0035	4.504	6
SS-96104-32	3.005	3.255	2	P-400-32	4.008	4.509	4
SS-96104-48	3.005	3.255	3	<b>4 x 4-5/8 NOMINAL</b>			
P-300-16	3.006	3.257	2	AA-4600-5	4.003	4.628	4
P-300-24	3.006	3.257	3	SS-128148-64	4.003	4.628	4
<b>3 x 3-1/2 NOMINAL</b>				<b>4-1/2 x 5-1/4 NOMINAL</b>			
AA-3502-7	3.004	3.505	2 1/2	AA-5201	4.504	5.2545	5
AA-3502-8	3.004	3.505	3	SS-144168-80	4.504	5.2545	5
AA-3502-3	3.004	3.505	4	<b>5 x 5-3/4 NOMINAL</b>			
B-4856-16	3.004	3.505	2	AA-5700-1	5.004	5.788	2
B-4856-24	3.004	3.505	3	SS-160184-32	5.004	5.788	2
B-4856-32	3.004	3.505	4				
SS-96112-32	3.005	3.505	2				
SS-96112-40	3.005	3.505	2 1/2				
SS-96112-48	3.005	3.505	3				
SS-96112-64	3.005	3.505	4				
P-301-16	3.006	3.507	2				
P-301-20	3.006	3.507	2 1/2				
P-301-24	3.006	3.507	3				
P-301-32	3.006	3.507	4				
<b>3-1/4 x 3-5/8 NOMINAL</b>							
AA-3600-5	3.253	3.628	4				
SS-104116-64	3.253	3.628	4				

Tolerance: Tolerances may vary for some sizes due to different molds available at time of manufacture.

Note: Inquire for additional standard and non-standard sizes. Cast bronze and steel bushings also available by special request.

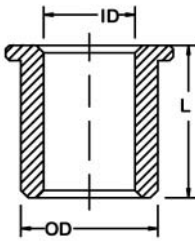

# Inch Flange Bearings

Oil Impregnated Bronze  
ASTM: B-438-73 Gr 1 Type II  
SAE 841



Part No.	ID	OD	L	Flange OD	Flange Thickness	Part No.	ID	OD	L	Flange OD	Flange Thickness
<b>1/8 x 1/4 NOMINAL</b>						<b>1/4 x 3/8 NOMINAL</b>					
FF-207-2	.126	.252	1/4	5/16	1/16	FF-312	.252	.3775	1/4	15/32	1/16
FF-207-3	.126	.252	3/8	5/16	1/16	FF-312-1	.252	.3775	3/8	15/32	1/16
<b>1/8 x 5/16 NOMINAL</b>						<b>1/4 x 1/2 NOMINAL</b>					
FB-25-2	.127	.315	1/4	3/8	3/64	FF-312-2	.252	.3775	1/2	15/32	1/16
FB-25-3	.127	.315	3/8	3/8	3/64	FL-26-1.5	.252	.378	3/16	1/2	1/16
<b>3/16 x 5/16 NOMINAL</b>						<b>1/4 x 7/16 NOMINAL</b>					
F-313-1	.187	.313	1/4	3/8	1/16	FF-435-1	.251	.4395	1/2	1/2	1/16
FF-313-2	.187	.313	3/8	3/8	1/16	<b>1/4 x 1/2 NOMINAL</b>					
FB-35-1	.189	.3145	1/8	3/8	3/64	FF-565-2	.252	.503	5/8	5/8	1/16
FB-35-2	.189	.3145	1/4	3/8	3/64	FF-565-3	.252	.503	3/4	5/8	1/16
FB-35-3	.189	.3145	3/8	3/8	3/64	SF-816-10	.252	.503	5/8	5/8	1/16
FF-303-1	.1895	.314	3/16	7/16	1/16	SF-816-12	.252	.503	3/4	5/8	1/16
FF-303-3	.1895	.314	1/4	7/16	1/16	<b>5/16 x 3/8 NOMINAL</b>					
FF-303-2	.1895	.314	5/16	7/16	1/16	FB-56-3	.314	.377	3/8	1/2	3/64
FF-303	.1895	.314	3/8	7/16	1/16	<b>5/16 x 7/16 NOMINAL</b>					
FF-303-4	.1895	.314	1/2	7/16	1/16	FF-411-1	.3125	.440	3/8	9/16	1/16
SF-610-3	.1895	.314	3/16	7/16	1/16	FF-411-2	.3125	.440	1/2	9/16	1/16
SF-610-4	.1895	.314	1/4	7/16	1/16	FF-411-4	.3125	.440	7/8	9/16	1/16
SF-610-5	.1895	.314	5/16	7/16	1/16	FB-57-3	.314	.440	3/8	5/8	3/32
SF-610-6	.1895	.314	3/8	7/16	1/16	FB-57-4	.314	.439	1/2	5/8	3/32
SF-610-8	.1895	.314	1/2	7/16	1/16	FB-57-5	.314	.439	5/8	5/8	3/32
FL-19-1.5	.1895	.3155	3/16	7/16	1/16	FB-57-6	.314	.439	3/4	5/8	3/32
FL-19-2	.1895	.3155	1/4	7/16	1/16	FB-57-7	.314	.439	7/8	5/8	3/32
FL-19-2.5	.1895	.3155	5/16	7/16	1/16	FB-57-8	.314	.439	1	5/8	3/32
FL-19-3	.1895	.3155	3/8	7/16	1/16	FL-32-3	.3145	.4405	3/8	9/16	1/16
FL-19-4	.1895	.3155	1/2	7/16	1/16	FL-32-4	.3145	.4405	1/2	9/16	1/16
<b>3/16 x 3/8 NOMINAL</b>						<b>5/16 x 1/2 NOMINAL</b>					
FF-307	.1895	.3765	3/8	7/16	1/16	FF-501-2	.3135	.502	3/8	9/16	1/16
FF-307-2	.1895	.3765	1/2	7/16	1/16	FB-58-3	.314	.502	3/8	11/16	1/16
<b>1/4 x 3/8 NOMINAL</b>						<b>3/8 x 1/2 NOMINAL</b>					
FF-310	.250	.381	3/16	1/2	1/16	FB-58-4	.314	.502	1/2	11/16	1/16
FF-310-3	.250	.381	1/4	1/2	1/16	FB-58-5	.314	.502	5/8	11/16	1/16
FF-310-4	.250	.381	5/16	1/2	1/16	FL-33-3	.3145	.503	3/8	11/16	1/16
FF-310-1	.250	.381	3/8	1/2	1/16	SF-1016-6	.3145	.503	3/8	11/16	1/16
FF-310-5	.250	.381	7/16	1/2	1/16	<b>5/16 x 1/2 NOMINAL</b>					
FF-310-2	.250	.381	1/2	1/2	1/16	FF-520-15	.3765	.502	1/4	5/8	1/16
FF-310-7	.250	.381	9/16	1/2	1/16	FF-520-9	.3765	.502	5/16	5/8	1/16
FF-310-10	.250	.381	11/16	1/2	1/16	FF-520-10	.3765	.502	3/8	5/8	1/16
SF-812-3	.252	.377	3/16	15/32	1/16	FF-520-5	.3765	.502	1/2	5/8	1/16
SF-812-4	.252	.377	1/4	15/32	1/16	<b>5/16 x 1/2 NOMINAL</b>					
SF-812-5	.252	.377	5/16	15/32	1/16	<b>3/8 x 1/2 NOMINAL</b>					
SF-812-6	.252	.377	3/8	15/32	1/16	<b>5/16 x 1/2 NOMINAL</b>					
SF-812-7	.252	.377	7/16	15/32	1/16	<b>3/8 x 1/2 NOMINAL</b>					
SF-812-8	.252	.377	1/2	15/32	1/16	<b>5/16 x 1/2 NOMINAL</b>					
SF-812-10	.252	.377	5/8	15/32	1/16	<b>3/8 x 1/2 NOMINAL</b>					
SF-812-12	.252	.377	3/4	15/32	1/16	<b>5/16 x 1/2 NOMINAL</b>					
FB-46-2	.252	.377	1/4	1/2	3/64	<b>3/8 x 1/2 NOMINAL</b>					
FB-46-3	.252	.377	3/8	1/2	3/64	<b>5/16 x 1/2 NOMINAL</b>					
FB-46-4	.252	.377	1/2	1/2	3/64	<b>3/8 x 1/2 NOMINAL</b>					
FB-46-5	.252	.377	5/8	1/2	3/64	<b>5/16 x 1/2 NOMINAL</b>					
FB-46-6	.252	.377	3/4	1/2	3/64	<b>3/8 x 1/2 NOMINAL</b>					
FF-300	.252	.3775	3/8	15/32	3/64	<b>5/16 x 1/2 NOMINAL</b>					

Tolerance: Tolerances may vary for some sizes due to different molds available at time of manufacture.

Note: Inquire for additional standard and non-standard sizes. Cast bronze and steel bushings also available by special request.



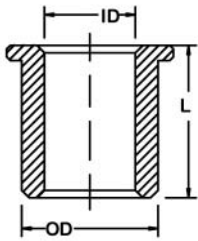

# Inch Flange Bearings

Oil Impregnated Bronze  
ASTM: B-438-73 Gr 1 Type II  
SAE 841



Part No.	ID	OD	L	Flange OD	Flange Thickness	Part No.	ID	OD	L	Flange OD	Flange Thickness
<b>3/8 x 1/2 NOMINAL</b>						<b>7/16 x 9/16 NOMINAL</b>					
FF-5212-2	.3765	.503	1/2	5/8	3/32	FF-504-3	.439	.565	1/2	11/16	1/16
FF-512-3	.3765	.503	5/8	5/8	3/32	FF-504	.439	.565	5/8	11/16	1/16
SF-1216-4	.377	.502	1/4	5/8	1/16	FF-504-1	.439	.565	3/4	11/16	1/16
SF-1216-5	.377	.502	5/16	5/8	1/16	SF-1418-8	.439	.565	1/2	11/16	1/16
SF-1216-6	.377	.502	3/8	5/8	1/16	SF-1418-10	.439	.565	5/8	11/16	1/16
SF-1216-8	.377	.502	1/2	5/8	1/16	SF-1418-12	.439	.565	3/4	11/16	1/16
SF-1216-10	.377	.502	5/8	5/8	1/16	FL-43-4	.4395	.5655	1/2	11/16	1/16
SF-1216-12	.377	.502	3/4	5/8	1/16	FL-43-6	.4395	.5655	3/4	11/16	1/16
SF-1216-16	.377	.502	1	5/8	1/16	<b>7/16 x 5/8 NOMINAL</b>					
FB-68-3	.377	.502	3/8	11/16	3/32	FF-608-3	.4385	.627	3/4	7/8	1/8
FB-68-3-1/4	.377	.502	13/32	11/16	3/32	FF-608	.4385	.627	1 1/4	7/8	1/8
FB-68-4	.377	.502	1/2	11/16	1/16	FB-710-5	.439	.628	5/8	7/8	1/8
FB-68-5	.377	.502	5/8	11/16	1/16	FB-710-6	.439	.628	3/4	7/8	1/8
FB-68-6	.377	.502	3/4	11/16	1/16	FB-710-10	.439	.628	1 1/4	7/8	1/8
FB-68-7	.377	.502	7/8	11/16	1/16	SF-1420-10	.439	.628	5/8	7/8	1/8
FB-68-8	.377	.502	1	11/16	1/16	SF-1420-12	.439	.628	3/4	7/8	1/8
FB-68-10	.377	.502	1 1/4	11/16	1/16	SF-1420-16	.439	.628	1	7/8	1/8
FL-38-2	.377	.503	1/4	11/16	1/16	SF-1420-20	.439	.628	1 1/4	7/8	1/8
FL-38-3	.377	.503	3/8	11/16	1/16	FL-44-6	.4395	.628	3/4	7/8	1/8
FL-38-4	.377	.503	1/2	11/16	1/16	FL-44-10	.4395	.628	1 1/4	7/8	1/8
FL-38-6	.377	.503	3/4	11/16	1/16	<b>1/2 x 5/8 NOMINAL</b>					
FL-38-8	.377	.503	1	11/16	1/16	FF-636-2	.502	.627	5/16	3/4	3/32
FF-519-2	.378	.503	1/2	3/4	3/32	FF-636-2	.502	.627	3/8	3/4	3/32
<b>3/8 x 9/16 NOMINAL</b>						FF-620-9	.502	.627	3/16	7/8	1/16
FF-503-6	.376	.564	1/2	3/4	1/16	FF-620-1	.502	.627	1/2	7/8	1/16
FF-503-4	.376	.564	11/16	3/4	1/16	FF-620-5	.502	.627	9/16	7/8	1/16
FF-503	.376	.564	13/16	3/4	1/16	FF-620-7	.502	.627	5/8	7/8	1/16
FB-69-4	.377	.5645	1/2	3/4	1/8	FF-620	.502	.627	11/16	7/8	1/16
FB-69-6	.377	.5645	3/4	3/4	1/8	FF-620-2	.502	.627	3/4	7/8	1/16
FB-69-10	.377	.5645	1 1/4	3/4	1/8	FF-620-6	.502	.627	15/16	7/8	1/16
FL-39-4	.377	.5655	1/2	11/16	1/16	FF-620-3	.502	.627	1	7/8	1/16
FL-39-6	.377	.5655	3/4	11/16	1/16	FF-620-4	.502	.627	1 1/8	7/8	1/16
SF-1218-8	.377	.5655	1/2	11/16	1/16	SF-1620-4	.502	.627	1/4	7/8	1/16
<b>3/8 x 5/8 NOMINAL</b>						SF-1620-6	.502	.627	3/8	7/8	1/16
FF-607-2	.376	.627	1/2	7/8	1/16	SF-1620-8	.502	.627	1/2	7/8	1/16
FF-607-3	.376	.627	3/4	7/8	1/16	SF-1620-9	.502	.627	9/16	7/8	1/16
FF-607-1	.376	.627	1 1/4	7/8	1/16	SF-1620-10	.502	.627	5/8	7/8	1/16
SF-1220-8	.377	.627	1/2	7/8	1/16	SF-1620-11	.502	.627	11/16	7/8	1/16
SF-1220-12	.377	.627	3/4	7/8	1/16	SF-1620-12	.502	.627	3/4	7/8	1/16
SF-1220-16	.377	.627	1	7/8	1/16	SF-1620-16	.502	.627	1	7/8	1/16
SF-1220-20	.377	.627	1 1/4	7/8	1/16	SF-1620-20	.502	.627	1 1/4	7/8	1/16
FB-610-3	.377	.627	3/8	7/8	1/8	SF-1620-24	.502	.627	1 1/2	7/8	1/16
FB-610-4	.377	.627	1/2	7/8	1/8	FF-600-5	.502	.627	1/2	31/32	3/32
FB-610-5	.377	.627	5/8	7/8	1/8	FF-600-2	.502	.627	1	31/32	3/32
FB-610-6	.377	.627	3/4	7/8	1/8	FF-600	.502	.627	1 3/4	31/32	3/32
FB-610-8	.377	.627	1	7/8	1/8	FB-810-4	.502	.628	1/2	7/8	1/8
FB-610-10	.377	.627	1 1/4	7/8	1/8	FB-810-5	.502	.628	5/8	7/8	1/8
FL-40-4	.377	.628	1/2	7/8	1/16	FB-810-6	.502	.628	3/4	7/8	1/8
FL-40-6	.377	.628	3/4	7/8	1/16	FB-810-7	.502	.628	7/8	7/8	1/8
FL-40-8	.377	.628	1	7/8	1/16	FB-810-8	.502	.628	1	7/8	1/8
FL-40-10	.377	.628	1 1/4	7/8	1/16	FB-810-10	.502	.628	1 1/4	7/8	1/8
<b>3/8 x 3/4 NOMINAL</b>						FB-810-12	.502	.628	1 1/2	7/8	1/8
FN-612-4	.377	.753	1/2	7/8	1/8	FB-810-14	.502	.628	1 3/4	7/8	1/8

Tolerance: Tolerances may vary for some sizes due to different molds available at time of manufacture.

Note: Inquire for additional standard and non-standard sizes. Cast bronze and steel bushings also available by special request.

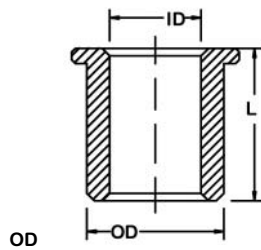

# Inch Flange Bearings

Oil Impregnated Bronze  
ASTM: B-438-73 Gr 1 Type II  
SAE 841



Part No.	ID	OD	L	Flange OD	Flange Thickness	Part No.	ID	OD	L	Flange OD	Flange Thickness
<b>1/2 x 5/8 NOMINAL</b>						<b>9/16 x 3/4 NOMINAL</b>					
FL-50-2.5	.502	.628	5/16	7/8	1/8	FB-912-4	.565	.753	1/2	1	1/8
FL-50-3	.502	.628	3/8	7/8	1/8	FB-912-6	.565	.753	3/4	1	1/8
FL-50-4	.502	.628	1/2	7/8	1/8	FB-912-8	.565	.753	1	1	1/8
FL-50-5	.502	.628	5/8	7/8	1/8	<b>5/8 x 3/4 NOMINAL</b>					
FL-50-6	.502	.628	3/4	7/8	1/8	FB-1012-4	.626	.753	1/2	1	1/8
FL-50-8	.502	.628	1	7/8	1/8	FB-1012-5	.626	.753	5/8	1	1/8
FL-50-10	.502	.628	1 1/4	7/8	1/8	FB-1012-6	.626	.753	3/4	1	1/8
FL-50-12	.502	.628	1 1/2	7/8	1/8	FB-1012-8	.626	.753	1	1	1/8
<b>1/2 x 11/16 NOMINAL</b>						FB-1012-10	.626	.753	1 1/4	1	1/8
FB-811-4	.502	.690	1/2	15/16	1/8	FF-703-3	.6265	.7525	5/8	1	3/32
FB-811-5	.502	.690	5/8	15/16	1/8	FF-703-7	.6265	.7525	3/4	1	3/32
FB-811-6	.502	.690	3/4	15/16	1/8	FF-703-1	.6265	.7525	1	1	3/32
FL-51-2.5	.502	.6905	5/16	7/8	1/8	FF-703	.6265	.7525	1 1/8	1	3/32
FL-51-4	.502	.6905	1/2	7/8	1/8	FF-703-6	.6265	.7525	1 1/4	1	3/32
FL-51-6	.502	.6905	3/4	7/8	1/8	SF-2024-8	.627	.753	1/2	1	3/32
SF-1622-5	.502	.6905	5/16	7/8	1/8	SF-2024-10	.627	.753	5/8	1	3/32
SF-1622-8	.502	.6905	1/2	7/8	1/8	SF-2024-12	.627	.753	3/4	1	3/32
SF-1622-12	.502	.6905	3/4	7/8	1/8	SF-2024-16	.627	.753	1	1	3/32
SF-1622-14	.502	.6905	7/8	7/8	1/8	SF-2024-18	.627	.753	1 1/8	1	3/32
FF-609-1	.502	.691	5/16	13/16	1/16	SF-2024-20	.627	.753	1 1/4	1	3/32
FF-609-3	.502	.691	1/2	13/16	1/16	SF-2024-24	.627	.753	1 1/2	1	3/32
FF-609-4	.502	.691	3/4	13/16	1/16	FL-62-5	.627	.753	5/8	1	1/8
FF-609	.502	.691	13/16	13/16	1/16	FL-62-6	.627	.753	3/4	1	1/8
FF-604-2	.502	.691	1/2	31/32	3/32	FL-62-8	.627	.753	1	1	1/8
FF-604-1	.502	.691	3/4	31/32	3/32	FL-62-9	.627	.753	1 1/8	1	1/8
FF-604	.502	.691	13/16	31/32	3/32	FF-718-1	.6275	.7525	1/2	7/8	1/16
<b>1/2 x 3/4 NOMINAL</b>						FF-718-3	.6275	.7525	1	7/8	1/16
FF-707-5	.502	.753	1/2	15/16	1/8	FF-718-6	.6275	.7525	1 1/8	7/8	1/16
FF-707-2	.502	.753	3/4	15/16	1/8	<b>5/8 x 13/16 NOMINAL</b>					
FF-707-3	.502	.753	1	15/16	1/8	FF-823-3	.625	.815	1	1	1/8
SF-1624-6	.502	.753	3/8	15/16	1/8	FF-823	.625	.815	1 1/4	1	1/8
SF-1624-8	.502	.753	1/2	15/16	1/8	FF-842-1	.626	.815	1/2	1	1/8
SF-1624-10	.502	.753	5/8	15/16	1/8	FF-842-2	.626	.815	3/4	1	1/8
SF-1624-12	.502	.753	3/4	15/16	1/8	FF-842-3	.626	.815	1	1	1/8
SF-1624-16	.502	.753	1	15/16	1/8	FB-1013-5	.627	.815	5/8	1 1/16	5/32
SF-1624-20	.502	.753	1 1/4	15/16	1/8	FB-1013-6	.627	.815	3/4	1 1/16	5/32
SF-1624-24	.502	.753	1 1/2	15/16	1/8	FB-1013-8	.627	.815	1	1 1/16	5/32
FB-812-4	.502	.753	1/2	1	1/8	FB-1013-10	.627	.815	1 1/4	1 1/16	5/32
FB-812-5	.502	.753	5/8	1	1/8	FB-1013-11.5	.627	.815	1 7/16	1 1/16	5/32
FB-812-6	.502	.753	3/4	1	1/8	FB-1013-12	.627	.815	1 1/2	1 1/16	5/32
FB-812-7	.502	.753	7/8	1	1/8	FB-1013-16	.627	.815	2	1 1/16	5/32
FB-812-8	.502	.753	1	1	1/8	FL-63-6	.627	.8165	3/4	1	1/8
FB-812-10	.502	.753	1 1/4	1	1/8	FL-63-8	.627	.8165	1	1	1/8
FB-812-12	.502	.753	1 1/2	1	1/8	FL-63-10	.627	.8165	1 1/4	1	1/8
FL-52-4	.502	.753	1/2	1	1/8	FL-63-12	.627	.8165	1 1/2	1	1/8
FL-52-5	.502	.753	5/8	1	1/8	SF-2026-12	.628	.815	3/4	1	1/8
FL-52-6	.502	.753	3/4	1	1/8	SF-2026-16	.628	.815	1	1	1/8
FL-52-8	.502	.753	1	1	1/8	SF-2026-20	.628	.815	1 1/4	1	1/8
FL-52-10	.502	.753	1 1/4	1	1/8	SF-2026-24	.628	.815	1 1/2	1	1/8
FF-710	.503	.753	3/4	15/16	1/8	FF-806-1	.628	.816	3/4	1 1/4	1/8
FF-723-5	.503	.753	3/8	1	1/8	FF-806	.628	.816	1 7/16	1 1/4	1/8
FF-723-1	.503	.753	1/2	1	1/8	FF-805-2	.6295	.8155	1/2	1	1/8
FF-723	.503	.753	5/8	1	1/8	FF-805	.6295	.8155	3/4	1	1/8
						FF-805-3	.6295	.8155	1	1	1/8

Tolerance: Tolerances may vary for some sizes due to different molds available at time of manufacture.

Note: Inquire for additional standard and non-standard sizes. Cast bronze and steel bushings also available by special request.



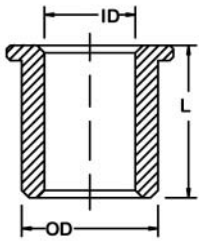

# Inch Flange Bearings

Oil Impregnated Bronze  
 ASTM: B-438-73 Gr 1 Type II  
 SAE 841



Part No.	ID	OD	L	Flange OD	Flange Thickness	Part No.	ID	OD	L	Flange OD	Flange Thickness
<b>5/8 x 7/8 NOMINAL</b>						<b>3/4 x 15/16 NOMINAL</b>					
FF-843-4	.627	.877	5/8	1	1/8	SF-2430-20	.753	.940	1 1/4	1 1/4	1/8
FF-843	.627	.877	3/4	1	1/8	SF-2830-24	.753	.940	1 1/2	1 1/4	1/8
FF-843-2	.627	.877	1	1	1/8	FF-905	.753	.9405	1 1/8	1 1/4	1/8
FF-843-3	.627	.877	1 1/4	1	1/8	<b>3/4 x 1 NOMINAL</b>					
FB-1014-5	.627	.878	5/8	1 1/8	5/32	FF-1011-2	.7505	1.002	1/2	1 7/16	1/8
FB-1014-6	.627	.878	3/4	1 1/8	5/32	FF-1011	.7505	1.002	5/8	1 7/16	1/8
FB-1014-8	.627	.878	1	1 1/8	5/32	FF-1011-4	.7505	1.002	1	1 7/16	1/8
FB-1014-14	.627	.878	1 3/4	1 1/8	5/32	FF-1011-1	.7505	1.002	1 1/8	1 7/16	1/8
FL-64-4	.627	.879	1/2	1 1/8	1/8	FF-1013-2	.751	1.002	3/4	1 1/2	1/8
FL-64-5	.627	.879	5/8	1 1/8	1/8	FF-1013	.751	1.002	1	1 1/2	1/8
FL-64-6	.627	.879	3/4	1 1/8	1/8	FF-1013-3	.751	1.002	1 1/4	1 1/2	1/8
FL-64-8	.627	.879	1	1 1/8	1/8	FF-1013-4	.751	1.002	1 1/2	1 1/2	1/8
FL-64-10	.627	.879	1 1/4	1 1/8	1/8	SF-2028-10	.628	.878	5/8	1	1/8
SF-2028-10	.628	.878	5/8	1	1/8	SF-2028-12	.628	.878	3/4	1	1/8
SF-2028-12	.628	.878	3/4	1	1/8	SF-2028-16	.628	.878	1	1	1/8
SF-2028-16	.628	.878	1	1	1/8	SF-2028-20	.628	.878	1 1/4	1	1/8
SF-2028-20	.628	.878	1 1/4	1	1/8	SF-2028-24	.628	.878	1 1/2	1	1/8
SF-2028-24	.628	.878	1 1/2	1	1/8	<b>5/8 x 1 NOMINAL</b>					
<b>5/8 x 1 NOMINAL</b>						FB-1016-6	.627	1.003	3/4	1 1/4	5/32
FB-1016-6	.627	1.003	3/4	1 1/4	5/32	FB-1016-8	.627	1.003	1	1 1/4	5/32
FB-1016-8	.627	1.003	1	1 1/4	5/32	SF-2032-16	.627	1.003	1	1 1/4	3/16
SF-2032-16	.627	1.003	1	1 1/4	3/16	FL-66-8	.627	1.004	1	1 1/4	3/16
FL-66-8	.627	1.004	1	1 1/4	3/16	<b>3/4 x 7/8 NOMINAL</b>					
<b>3/4 x 7/8 NOMINAL</b>						FF-383-1	.751	.877	1/2	1	1/16
FF-383-1	.751	.877	1/2	1	1/16	FF-838-3	.751	.877	1	1	1/16
FF-838-3	.751	.877	1	1	1/16	FB-1214-6	.752	.878	3/4	1 1/8	5/32
FB-1214-6	.752	.878	3/4	1 1/8	5/32	FB-1214-8	.752	.878	1	1 1/8	5/32
FB-1214-8	.752	.878	1	1 1/8	5/32	FB-1214-10	.752	.878	1 1/4	1 1/8	5/32
FB-1214-10	.752	.878	1 1/4	1 1/8	5/32	F-75-4	.752	.879	1/2	1 1/8	1/8
F-75-4	.752	.879	1/2	1 1/8	1/8	FL-75-5	.752	.879	3/4	1 1/8	1/8
FL-75-5	.752	.879	3/4	1 1/8	1/8	SF-2428-8	.753	.878	1/2	1 1/8	1/8
SF-2428-8	.753	.878	1/2	1 1/8	1/8	SF-2428-12	.753	.878	3/4	1 1/8	1/8
SF-2428-12	.753	.878	3/4	1 1/8	1/8	SF-2428-16	.753	.878	1	1 1/8	1/8
SF-2428-16	.753	.878	1	1 1/8	1/8	SF-2428-24	.753	.878	1 1/2	1 1/8	1/8
SF-2428-24	.753	.878	1 1/2	1 1/8	1/8	<b>3/4 x 15/16 NOMINAL</b>					
<b>3/4 x 15/16 NOMINAL</b>						FF-911-3	.7505	.941	3/4	1 1/8	3/32
FF-911-3	.7505	.941	3/4	1 1/8	3/32	FF-911-4	.7505	.941	1	1 1/8	3/32
FF-911-4	.7505	.941	1	1 1/8	3/32	FB-1215-8	.752	.940	1	1 3/16	5/32
FB-1215-8	.752	.940	1	1 3/16	5/32	FB-1215-10	.752	.940	1 1/4	1 3/16	5/32
FB-1215-10	.752	.940	1 1/4	1 3/16	5/32	FB-1215-12	.752	.940	1 1/2	1 3/16	5/32
FB-1215-12	.752	.940	1 1/2	1 3/16	5/32	FL-76-4.5	.752	.9415	9/16	1 1/4	1/8
FL-76-4.5	.752	.9415	9/16	1 1/4	1/8	FL-76-6	.752	.9415	3/4	1 1/4	1/8
FL-76-6	.752	.9415	3/4	1 1/4	1/8	FL-76-8	.752	.9415	1	1 1/4	1/8
FL-76-8	.752	.9415	1	1 1/4	1/8	FL-76-9	.752	.9415	1 1/8	1 1/4	1/8
FL-76-9	.752	.9415	1 1/8	1 1/4	1/8	FL-76-10	.752	.9415	1 1/4	1 1/4	1/8
FL-76-10	.752	.9415	1 1/4	1 1/4	1/8	FL-76-12	.752	.9415	1 1/2	1 1/4	1/8
FL-76-12	.752	.9415	1 1/2	1 1/4	1/8	FF-901-4	.753	.938	9/16	1 5/16	1/8
FF-901-4	.753	.938	9/16	1 5/16	1/8	FF-901-6	.753	.938	3/4	1 5/16	1/8
FF-901-6	.753	.938	3/4	1 5/16	1/8	FF-901-8	.753	.938	1 1/4	1 5/16	1/8
FF-901-8	.753	.938	1 1/4	1 5/16	1/8	FF-901	.753	.938	1 9/16	1 5/16	1/8
FF-901	.753	.938	1 9/16	1 5/16	1/8	SF-2430-12	.753	.940	3/4	1 1/4	1/8
SF-2430-12	.753	.940	3/4	1 1/4	1/8	SF-2430-16	.753	.940	1	1 1/4	1/8
SF-2430-16	.753	.940	1	1 1/4	1/8	SF-2430-18	.753	.940	1 1/8	1 1/4	1/8
SF-2430-18	.753	.940	1 1/8	1 1/4	1/8	<b>3/4 x 1-1/16 NOMINAL</b>					
<b>3/4 x 1-1/16 NOMINAL</b>						FF-1010	.752	1.0655	1 3/16	1 3/16	1/8
<b>7/8 x 1 NOMINAL</b>						<b>7/8 x 1 NOMINAL</b>					
<b>7/8 x 1 NOMINAL</b>						FF-1001-2	.8765	1.003	5/8	1 1/4	1/8
FF-1001-2	.8765	1.003	5/8	1 1/4	1/8	FF-1001-1	.8765	1.003	3/4	1 1/4	1/8
FF-1001-1	.8765	1.003	3/4	1 1/4	1/8	FF-1001	.8765	1.003	1	1 1/4	1/8
FF-1001	.8765	1.003	1	1 1/4	1/8	SF-2832-8	.877	1.003	1/2	1 1/4	1/8
SF-2832-8	.877	1.003	1/2	1 1/4	1/8	SF-2832-12	.877	1.003	3/4	1 1/4	1/8
SF-2832-12	.877	1.003	3/4	1 1/4	1/8	SF-2832-16	.877	1.003	1	1 1/4	1/8
SF-2832-16	.877	1.003	1	1 1/4	1/8	SF-2832-20	.877	1.003	1 1/4	1 1/4	1/8
SF-2832-20	.877	1.003	1 1/4	1 1/4	1/8	SF-2832-24	.877	1.003	1 1/2	1 1/4	1/8
SF-2832-24	.877	1.003	1 1/2	1 1/4	1/8	FB-1416-6	.877	1.003	3/4	1 1/4	5/32
FB-1416-6	.877	1.003	3/4	1 1/4	5/32	FB-1416-8	.877	1.003	1	1 1/4	5/32
FB-1416-8	.877	1.003	1	1 1/4	5/32	FB-1416-10	.877	1.003	1 1/4	1 1/4	5/32
FB-1416-10	.877	1.003	1 1/4	1 1/4	5/32	FL-87-4	.877	1.004	1/2	1 1/4	3/16
FL-87-4	.877	1.004	1/2	1 1/4	3/16	FL-87-6	.877	1.004	3/4	1 1/4	3/16
FL-87-6	.877	1.004	3/4	1 1/4	3/16	FL-87-8	.877	1.004	1	1 1/4	3/16
FL-87-8	.877	1.004	1	1 1/4	3/16						

Tolerance: Tolerances may vary for some sizes due to different molds available at time of manufacture.

Note: Inquire for additional standard and non-standard sizes. Cast bronze and steel bushings also available by special request.

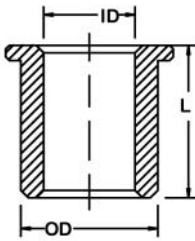

# Inch Flange Bearings

Oil Impregnated Bronze  
ASTM: B-438-73 Gr 1 Type II  
SAE 841



Part No.	ID	OD	L	Flange OD	Flange Thickness	Part No.	ID	OD	L	Flange OD	Flange Thickness
<b>7/8 x 1-1/8 NOMINAL</b>						<b>1 x 1-3/8 NOMINAL</b>					
FB-1418-8	.877	1.128	1	1 3/8	5/32	SF-3244-12	1.003	1.378	3/4	1 5/8	3/16
FB-1418-10	.877	1.128	1 1/4	1 3/8	5/32	SF-3244-16	1.003	1.378	1	1 5/8	3/16
FB-1418-12	.877	1.128	1 1/2	1 3/8	5/32	SF-3244-24	1.003	1.378	1 1/2	1 5/8	3/16
FF-1102-6	.877	1.128	5/8	1 1/2	1/8	SF-3244-28	1.003	1.378	1 3/4	1 5/8	3/16
FF-1102-2	.877	1.128	1	1 1/2	1/8	SF-3244-32	1.003	1.378	2	1 5/8	3/16
FF-1102-3	.877	1.128	1 1/4	1 1/2	1/8	FL-104-6	1.003	1.379	3/4	1 5/8	3/16
FF-1102	.877	1.128	1 3/4	1 1/2	1/8	FL-104-8	1.003	1.379	1	1 5/8	3/16
FL-89-6	.877	1.129	3/4	1 1/2	1/8	FL-104-12	1.003	1.379	1 1/2	1 5/8	3/16
FL-89-8	.877	1.129	1	1 1/2	1/8	FL-104-14	1.003	1.379	1 3/4	1 5/8	3/16
FL-89-10	.877	1.129	1 1/4	1 1/2	1/8	FL-104-16	1.003	1.379	2	1 5/8	3/16
FL-89-12	.877	1.129	1 1/2	1 1/2	1/8	<b>1-1/8 x 1-3/8 NOMINAL</b>					
FL-89-14	.877	1.129	1 3/4	1 1/2	1/8	FF-1314-1	1.127	1.377	3/4	1 3/4	1/8
SF-2836-10	.878	1.128	5/8	1 1/2	1/8	FF-1314-2	1.127	1.377	1	1 3/4	1/8
SF-2836-12	.878	1.128	3/4	1 1/2	1/8	FF-1314-3	1.127	1.377	1 1/4	1 3/4	1/8
SF-2836-16	.878	1.128	1	1 1/2	1/8	SF-3644-12	1.127	1.377	3/4	1 3/4	1/8
SF-2836-20	.878	1.128	1 1/4	1 1/2	1/8	SF-3644-16	1.127	1.377	1	1 3/4	1/8
SF-2836-24	.878	1.128	1 1/2	1 1/2	1/8	SF-3644-20	1.127	1.377	1 1/4	1 3/4	1/8
SF-2836-28	.878	1.128	1 3/4	1 1/2	1/8	<b>1-1/4 x 1-1/2 NOMINAL</b>					
<b>1 x 1-1/4 NOMINAL</b>						FF-1505-5	1.2515	1.503	1/2	1 11/16	1/8
FF-1213-1	1.001	1.252	3/4	1 1/2	1/8	FF-1505	1.2515	1.503	1 1/4	1 11/16	1/8
FF-1213-4	1.001	1.252	1 1/2	1 1/2	1/8	SF-4048-8	1.252	1.503	1/2	1 11/16	1/8
FF-1202-4	1.001	1.253	3/4	1 7/8	1/8	SF-4048-12	1.252	1.503	3/4	1 11/16	1/8
FF-1202-3	1.001	1.253	1	1 7/8	1/8	SF-4048-16	1.252	1.503	1	1 11/16	1/8
FF-1202	1.001	1.253	1 1/4	1 7/8	1/8	SF-4048-20	1.252	1.503	1 1/4	1 11/16	1/8
FF-1207-5	1.002	1.252	3/4	1 5/8	1/8	SF-4048-24	1.252	1.503	1 1/2	1 11/16	1/8
FF-1207-7	1.002	1.252	1 1/4	1 5/8	1/8	SF-4048-28	1.252	1.503	1 3/4	1 11/16	1/8
FF-1207-3	1.002	1.252	1 1/2	1 5/8	1/8	FB-2024-8	1.252	1.503	1	1 3/4	3/16
FF-1207	1.002	1.1252	1 3/4	1 5/8	1/8	FB-2024-10	1.252	1.503	1 1/4	1 3/4	3/16
FB-1620-6	1.002	1.253	3/4	1 1/2	3/16	FB-2024-12	1.252	1.503	1 1/2	1 3/4	3/16
FB-1620-8	1.002	1.253	1	1 1/2	3/16	FF-1506-4	1.252	1.503	1 1/2	2	3/32
FB-1620-10	1.002	1.253	1 1/4	1 1/2	3/16	FF-1506-5	1.252	1.503	1 3/4	2	3/32
FB-1620-12	1.002	1.253	1 1/2	1 1/2	3/16	FL-125-8	1.2535	1.504	1	1 3/4	3/16
FB-1620-16	1.002	1.253	2	1 1/2	3/16	FL-125-10	1.2535	1.504	1 1/4	1 3/4	3/16
SF-3240-12	1.003	1.253	3/4	1 5/8	3/16	FL-125-12	1.2535	1.504	1 1/2	1 3/4	3/16
SF-3240-16	1.003	1.253	1	1 5/8	1/8	FL-125-14	1.2535	1.504	1 3/4	1 3/4	3/16
SF-3240-20	1.003	1.253	1 1/4	1 5/8	1/8	<b>1-3/8 x 1-5/8 NOMINAL</b>					
SF-3240-24	1.003	1.253	1 1/2	1 5/8	1/8	FF-1618	1.377	1.628	3/4	2	1/8
SF-3240-28	1.003	1.253	1 3/4	1 5/8	1/8	FF-1618-1	1.377	1.628	1	2	1/8
SF-3240-32	1.003	1.253	2	1 5/8	1/8	SF-4452-12	1.377	1.628	3/4	2	1/8
FL-102-6	1.003	1.254	3/4	1 1/2	1/8	SF-4452-16	1.377	1.628	1	2	1/8
FL-102-8	1.003	1.254	1	1 1/2	1/8	<b>1-1/2 x 1-3/4 NOMINAL</b>					
FL-102-10	1.003	1.254	1 1/4	1 1/2	1/8	FF-1704-4	1.503	1.752	1 1/2	2	3/32
FL-102-12	1.003	1.254	1 1/2	1 1/2	1/8	SF-4846-24	1.503	1.752	1 1/2	2	3/32
<b>1 x 1-5/16 NOMINAL</b>						FB-2428-12	1.503	1.754	1 1/2	2 1/16	3/16
FF-1302	1.001	1.316	1 1/4	1 3/4	7/32	FL-150-12	1.504	1.755	1 1/2	2	3/16
FF-1302-3	1.001	1.316	1 1/2	1 3/4	7/32	<b>1-5/8 x 2 NOMINAL</b>					
FF-1301	1.0015	1.3155	1 1/2	1 7/8	1/8	FF-2000	1.6265	2.004	2	2 1/4	3/16
<b>1 x 1-3/8 NOMINAL</b>						SF-5264-32	1.6265	2.004	2	2 1/4	3/16
FF-1304	1.000	1.3785	1 3/4	1 3/4	3/16	FL-163-16	1.629	2.005	2	2 1/4	3/16
FF-1304-1	1.000	1.3785	2	1 3/4	3/16						
FB-1622-8	1.002	1.378	1	1 5/8	3/16						
FB-1622-12	1.002	1.378	1 1/2	1 5/8	3/16						
FB-1622-14	1.002	1.378	1 3/4	1 5/8	3/16						

Tolerance: Tolerances may vary for some sizes due to different molds available at time of manufacture.

Note: Inquire for additional standard and non-standard sizes. Cast bronze and steel bushings also available by special request.



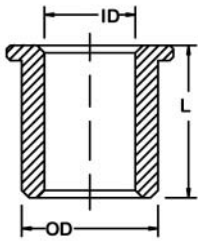

# Inch Flange Bearings

Oil Impregnated Bronze  
 ASTM: B-438-73 Gr 1 Type II  
 SAE 841



Part No.	ID	OD	L	Flange OD	Flange Thickness
<b>1-3/4 x 2-1/4 NOMINAL</b>					
FF-2204-3	1.753	2.254	2 1/2	3	1/4
SF-5672-40	1.753	2.254	2 1/2	3	1/4
FL-177-20	1.754	2.255	2 1/2	3	1/4
<b>2 x 2-1/4 NOMINAL</b>					
FF-2203-2	2.003	2.254	3/4	2 1/2	1/8
FF-2203-3	2.003	2.254	1	2 1/2	1/8
FF-2203-4	2.003	2.254	1 1/4	2 1/2	1/8
SF-6472-12	2.003	2.254	3/4	2 1/2	1/8
SF-6472-16	2.003	2.254	1	2 1/2	1/8
SF-6472-20	2.003	2.254	1 1/4	2 1/2	1/8
SF-6472-32	2.003	2.254	2	2 1/2	1/8
FL-200-16	2.004	2.255	2	2 1/2	1/8
<b>2 x 2-1/2 NOMINAL</b>					
FF-2501	2.002	2.501	2 3/8	3	3/8
SF-6480-38	2.002	2.501	2 3/8	3	3/8
<b>2-3/4 x 3-1/4 NOMINAL</b>					
FF-3200-4	2.752	3.250	1 1/2	4 1/2	3/16
SF-88104-24	2.752	3.255	1 1/2	4	3/16
<b>3 x 3-1/2 NOMINAL</b>					
FF-3500	3.002	3.502	2 3/8	4	3/8
SF-96112-38	3.002	3.502	2 3/8	4	3/8

Tolerance: Tolerances may vary for some sizes due to different molds available at time of manufacture.

Note: Inquire for additional standard and non-standard sizes. Cast bronze and steel bushings also available by special request.

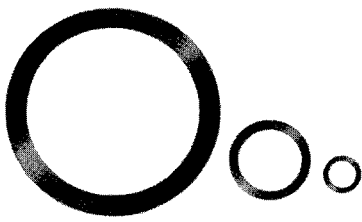

# Inch Thrust Washer

## Oil Impregnated Bronze

ASTM: B-438-73 Gr 1 Type II  
SAE 841

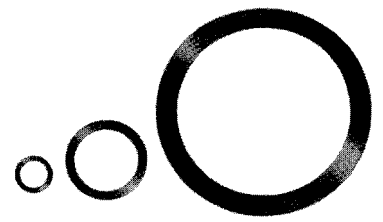

Part No.	ID	OD	L	Part No.	ID	OD	L	Part No.	ID	OD	L	Part No.	ID	OD	L
<b>1/4 x 7/16 NOMINAL</b>				<b>1/2 x 1 NOMINAL</b>				<b>21/32 x 1-1/2 NOMINAL</b>				<b>1 x 1-1/2 NOMINAL</b>			
TT-400	.255	.4375	1/16	TW-51	.502	1.004	1/16	ST-2148-2	.656	1.500	1/16	ST-3248-2	1.003	1.500	1/16
ST-814-2	.255	.4375	1/16	TW-51.5	.502	1.004	3/32	ST-2148-4	.656	1.500	1/8	ST-3248-4	1.003	1.500	1/8
<b>1/4 x 1/2 NOMINAL</b>				<b>9/16 x 1-1/4 NOMINAL</b>				<b>3/4 x 1-3/8 NOMINAL</b>				<b>1 x 1-5/8 NOMINAL</b>			
TT-504	.255	.500	1/16	TW-52	.502	1.004	1/8	TB-1220	.7515	1.250	1/8	TW-100.5	1.003	1.630	1/16
ST-816-2	.255	.500	1/16	TT-1001	.510	1.000	1/16	TW-75	.752	1.254	1/16	TW-101.5	1.003	1.630	1/8
<b>1/4 x 5/8 NOMINAL</b>				<b>5/8 x 1 NOMINAL</b>				<b>3/4 x 1-9/16 NOMINAL</b>				<b>1 x 1-3/4 NOMINAL</b>			
TT-25	.252	.628	1/16	TT-1001-2	.510	1.000	3/32	TW-77	.752	1.379	1/8	TT-1603-3	1.0155	1.625	1/16
TT-601	.255	.625	1/16	TT-1001-1	.510	1.000	1/8	TT-1303-1	.753	1.375	1/16	TT-1603	1.0155	1.625	1/8
TB-410	.255	.625	1/16	TB-816	.510	1.000	1/16	TT-1303-2	.753	1.375	1/8	TT-1603-4	1.0155	1.625	1/4
ST-820-2	.255	.625	1/16	ST-1632-2	.510	1.000	1/16	TT-1303-4	.753	1.375	1/4	ST-3252-2	1.0155	1.625	1/16
<b>5/16 x 5/8 NOMINAL</b>				<b>5/8 x 1-3/16 NOMINAL</b>				<b>3/4 x 1-3/4 NOMINAL</b>				<b>1 x 2 NOMINAL</b>			
TT-602	.3145	.625	1/16	TW-55	.5645	1.254	1/16	TW-79	.752	1.755	1/8	TW-102	1.003	2.005	1/8
ST-1020-2	.3145	.625	1/16	TW-56	.5645	1.254	1/8	TT-1701	.765	1.750	1/8	TW-103	1.003	2.005	3/16
<b>5/16 x 3/4 NOMINAL</b>				<b>7/8 x 1-1/2 NOMINAL</b>				<b>7/8 x 2 NOMINAL</b>				<b>1-1/16 x 2-3/8 NOMINAL</b>			
TT-31	.3145	.753	1/16	TT-1200-1	.565	1.250	1/16	TB-1424	.890	1.500	1/8	TT-2800	1.0155	2.875	1/8
TT-709-1	.315	.750	1/16	TT-1200	.565	1.250	1/8	TT-1503-2	.8905	1.500	1/16	ST-3292-4	1.0155	2.875	1/8
TB-512	.315	.750	1/16	TB-920	.565	1.250	1/8	TT-1503	.8905	1.500	1/8	<b>1-1/8 x 1-7/8 NOMINAL</b>			
ST-1024-2	.315	.750	1/16	ST-1840-2	.565	1.250	1/16	ST-2848-2	.8905	1.500	1/16	TT-1800-1	1.140	1.875	1/8
<b>3/8 x 5/8 NOMINAL</b>				<b>5/8 x 1-1/4 NOMINAL</b>				<b>7/8 x 2-1/8 NOMINAL</b>				<b>1-1/4 x 1-11/16 NOMINAL</b>			
TT-604	.385	.625	1/16	TT-1002-1	.628	1.000	1/16	TB-1434	.890	2.125	1/8	TT-1602	1.253	1.690	1/8
ST-1220-2	.385	.625	1/16	TT-1002	.628	1.000	1/8	TT-2101-1	.8905	2.125	1/8	ST-4054-4	1.253	1.690	1/8
<b>3/8 x 3/4 NOMINAL</b>				<b>5/8 x 1-1/2 NOMINAL</b>				<b>ST-2868-4</b>				<b>TW-125</b>			
TW-37	.377	.753	1/16	TB-1019	.627	1.187	3/32	ST-2868-4	.8905	2.125	1/8	TT-1602	1.253	1.690	1/8
TW-38	.377	.753	1/8	TT-1102-1	.627	1.1875	1/16					ST-4054-4	1.253	1.690	1/8
TT-710-1	.3775	.750	1/16	TT-1102	.627	1.1875	3/32					TW-125	1.2535	1.6925	1/8
TT-710-2	.3775	.750	1/8	TT-1102-2	.627	1.1875	1/8								
ST-1224-1	.380	.750	1/32	TW-63.5	.627	1.1915	1/16								
ST-1224-4	.380	.750	1/8	TW-64	.627	1.1915	3/32								
ST-1224-2	.380	.750	1/16	TW-64.5	.627	1.1915	1/8								
TT-703	.390	.750	1/32	ST-2038-2	.628	1.1875	1/16								
TB-612	.390	.750	1/32	ST-2038-3	.628	1.1875	3/32								
<b>7/16 x 3/4 NOMINAL</b>				<b>5/8 x 1-1/2 NOMINAL</b>											
TT-705-1	.4385	.750	1/16	ST-2038-4	.628	1.1875	1/8								
TB-712	.439	.750	1/16												
TW-43	.4395	.753	1/16												
ST-1424-2	.440	.750	1/16												
ST-1424-4	.440	.750	1/8												
<b>1/2 x 3/4 NOMINAL</b>															
TW-50	.502	.753	1/16												
ST-1624-2	.505	.750	1/16												
TT-706	.507	.750	1/16												
TB-812	.507	.750	1/16												
<b>1/2 x 7/8 NOMINAL</b>															
TT-801	.502	.875	1/16												
TB-814	.502	.875	1/16												
ST-1628-6	.502	.875	1/16												

Tolerance: Tolerances may vary for some sizes due to different molds available at time of manufacture.

Note: Inquire for additional standard and non-standard sizes. Cast bronze and steel bushings also available by special request.

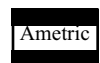

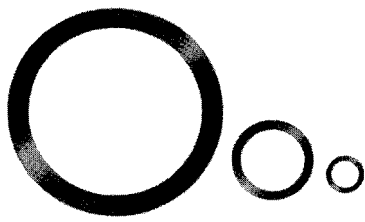

# Inch Thrust Washer

## Oil Impregnated Bronze

ASTM: B-438-73 Gr 1 Type II  
SAE 841

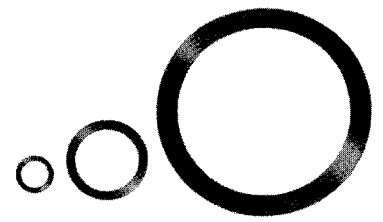

Part No.	ID	OD	L	Part No.	ID	OD	L
<b>1-1/4 x 1-3/4 NOMINAL</b>				<b>1-3/4 x 2-7/16 NOMINAL</b>			
TB-2028	1.253	1.750	1/8	TT-2400-1	1.755	2.440	1/8
<b>1-1/4 x 2 NOMINAL</b>				ST-5678-4	1.755	2.440	1/8
TW-126.5	1.2535	2.005	1/16	<b>1-3/4 x 2-5/8 NOMINAL</b>			
TW-126	1.2535	2.005	1/8	TW-175	1.754	2.631	1/8
TT-2006	1.265	2.000	1/16	TT-2601	1.765	2.626	1/8
TT-2006-1	1.265	2.000	1/8	ST-5684-4	1.765	2.626	1/8
ST-4064-2	1.265	2.000	1/16	<b>1-15/16 x 2-5/8 NOMINAL</b>			
ST-4064-4	1.265	2.000	1/8	TT-2600	1.953	2.625	1/8
<b>1-1/4 x 2-3/8 NOMINAL</b>				ST-6284-4	1.953	2.625	1/8
TT-2304-1	1.265	2.375	1/16	<b>2 x 3 NOMINAL</b>			
TT-2304-2	1.265	2.375	1/8	TW-200	2.004	3.006	1/8
ST-4076-2	1.265	2.375	1/16	TW-201	2.004	3.006	1/4
ST-4076-4	1.265	2.375	1/8	TT-3001-3	2.010	3.000	1/8
<b>1-1/4 x 3-5/16 NOMINAL</b>				TT-3001	2.010	3.000	3/16
TT-3301	1.255	3.312	1/16	TT-3001-1	2.010	3.000	1/4
TT-3301-1	1.255	3.312	1/8	ST-6496-4	2.011	3.000	1/8
ST-40106-2	1.255	3.312	1/16	ST-6496-6	2.011	3.000	3/16
ST-40106-4	1.255	3.312	1/8	ST-6496-8	2.011	3.000	1/4
<b>1-3/8 x 1-15/16 NOMINAL</b>				<b>2 x 3-5/8 NOMINAL</b>			
TT-1900	1.379	1.940	1/8	TT-3600	2.031	3.625	3/16
ST-4462-4	1.379	1.940	1/8	ST-64116-6	2.031	3.625	3/16
<b>1-1/2 x 2 NOMINAL</b>				<b>2-1/16 x 4 NOMINAL</b>			
TT-2008	1.503	2.000	1/8	TT-4002-1	2.062	4.000	1/8
ST-4864-4	1.503	2.000	1/8	TT-4002	2.062	4.000	1/4
<b>1-1/2 x 2-1/2 NOMINAL</b>				ST-66128-4	2.062	4.000	1/8
TW-150	1.504	2.505	1/8	ST-66128-8	2.062	4.000	1/4
ST-4880-4	1.505	2.505	1/8	<b>2-1/2 x 3-1/4 NOMINAL</b>			
<b>1-1/2 x 3-1/2 NOMINAL</b>				TT-3200	2.502	3.250	1/8
TW-151	1.504	3.507	3/16	ST-80104-14	2.502	3.250	1/8
TT-3500-1	1.510	3.500	3/16	<b>2-3/4 x 3-7/8 NOMINAL</b>			
TB-2456	1.510	3.500	3/16	TT-3800	2.766	3.875	1/4
ST-48112-6	1.510	3.500	3/16	ST-88124-8	2.766	3.875	1/4
<b>1-9/16 x 2-7/16 NOMINAL</b>							
TT-2402	1.578	2.4375	1/8				
ST-5078-4	1.578	2.4375	1/8				

Tolerance: Tolerances may vary for some sizes due to different molds available at time of manufacture.

Note: Inquire for additional standard and non-standard sizes. Cast bronze and steel bushings also available by special request.

# Inch Bar Stock

## Oil Impregnated Bronze

ASTM: B-438-73 Gr 1 Type II  
SAE 841

### Cored Bar Stock

### Solid Bar Stock

Part No.	ID	OD	L	Part No.	ID	OD	L	Part No.	ID	OD	L
<b>CORED BAR STOCK</b>				<b>CORED BAR STOCK</b>				<b>SOLID BAR STOCK</b>			
CC-1000-2	1/2	1	6 1/2	CC-4202	1 3/4	4 1/4	6 1/2	BB-200	-	1/4	6 1/2
CC-1103	1/2	1 1/8	6 1/2	CC-4502	1 3/4	4 1/2	6 1/2	BB-302	-	3/8	6 1/2
CC-1203	1/2	1 1/4	6 1/2	CC-2700-1	2	2 3/4	6 1/2	BB-500	-	1/2	6 1/2
CC-1502	1/2	1 1/2	6 1/2	CC-3000	2	3	6 1/2	BB-600-1	-	5/8	6 1/2
CC-2005	1/2	2	6 1/2	CC-3201-2	2	3 1/4	6 1/2	BB-700-1	-	3/4	6 1/2
CC-1001	5/8	1	6 1/2	CC-4003	2	4	6 1/2	BB-800-1	-	7/8	6 1/2
CC-1101-1	5/8	1 1/8	6 1/2	CC-4501	2	4 1/2	6 1/2	BB-1000-2	-	1	6 1/2
CC-1200-1	5/8	1 1/4	6 1/2	CC-5000	2	5	6 1/2	BB-1100	-	1 1/8	6 1/2
CC-1302	5/8	1 3/8	6 1/2	CC-5500	2	5 1/2	6 1/2	BB-1200-1	-	1 1/4	6 1/2
CC-1503	5/8	1 1/2	6 1/2	CC-3006	2 1/4	3	6 1/2	BB-1300	-	1 3/8	6 1/2
CC-1703	5/8	1 3/4	6 1/2	CC-3202-1	2 1/4	3 1/4	6 1/2	BB-1500-2	-	1 1/2	6 1/2
CC-2006	5/8	2	6 1/2	CC-3500-1	2 1/4	3 1/2	6 1/2	BB-1600	-	1 5/8	6 1/2
CC-1201-1	3/4	1 1/4	6 1/2	CC-3703	2 1/4	3 3/4	6 1/2	BB-1700-1	-	1 3/4	6 1/2
CC-1500-1	3/4	1 1/2	6 1/2	CC-4008	2 1/4	4	6 1/2	BB-2000-1	-	2	6 1/2
CC-1702	3/4	1 3/4	6 1/2	CC-4503	2 1/4	4 1/2	6 1/2	BB-2200	-	2 1/4	6 1/2
CC-2001	3/4	2	6 1/2	CC-3007	2 3/8	3	6 1/2	BB-2500-1	-	2 1/2	6 1/2
CC-2206	3/4	2 1/4	6 1/2	CC-3507	2 3/8	3 1/2	6 1/2	BB-2700-1	-	2 3/4	6 1/2
CC-2504	3/4	2 1/2	6 1/2	CC-4009	2 3/8	4	6 1/2	BB-3000-1	-	3	6 1/2
CC-2704	3/4	2 3/4	6 1/2	CC-4504	2 3/8	4 1/2	6 1/2	BB-3200-2	-	3 1/4	6 1/2
CC-1301	7/8	1 3/8	6 1/2	CC-3501	2 1/2	3 1/2	6 1/2	BB-3500-1	-	3 1/2	6 1/2
CC-1504	7/8	1 1/2	6 1/2	CC-3702	2 1/2	3 3/4	6 1/2	BB-4000-1	-	4	6 1/2
CC-2007	7/8	2	6 1/2	CC-4010	2 1/2	4	6 1/2	BB-4500	-	4 1/2	6 1/2
CC-2207	7/8	2 1/4	6 1/2	CC-4203	2 1/2	4 1/4	6 1/2	BB-5000	-	5	6 1/2
CC-1501	1	1 1/2	6 1/2	CC-4505	2 1/2	4 1/2	6 1/2	BB-5500	-	5 1/2	6 1/2
CC-1600-1	1	1 5/8	6 1/2	CC-5001	2 1/2	5	6 1/2	BB-6000	-	6	6 1/2
CC-1700-2	1	1 3/4	6 1/2	CC-3700-1	2 3/4	3 3/4	6 1/2	BB-7000	-	7	6 1/2
CC-2002	1	2	6 1/2	CC-3701-1	3	3 3/4	6 1/2	BB-8000	-	8	6 1/2
CC-2202-2	1	2 1/4	6 1/2	CC-4001	3	4	6 1/2				
CC-2501	1	2 1/2	6 1/2	CC-4506	3	4 1/2	6 1/2				
CC-3001	1	3	6 1/2	CC-5002	3	5	6 1/2				
CC-3504	1	3 1/2	6 1/2	CC-6000	3	6	6 1/2				
CC-4004	1	4	6 1/2	CC-4200-1	3 1/4	4 1/4	6 1/2				
CC-2102	1 1/8	2 1/8	6 1/2	CC-4700-2	3 1/2	4 3/4	6 1/2				
CC-1701-3	1 1/4	1 3/4	6 1/2	CC-5003	3 1/2	5	6 1/2				
CC-2000-1	1 1/4	2	6 1/2	CC-6002	3 1/2	6	6 1/2				
CC-2203	1 1/4	2 1/4	6 1/2	CC-5004	3 3/4	5	6 1/2				
CC-2502	1 1/4	2 1/2	6 1/2	CC-5501	4	5 1/2	6 1/2				
CC-3003	1 1/4	3	6 1/2	CC-6001	4	6	6 1/2				
CC-3505	1 1/4	3 1/2	6 1/2	CC-7001	4	7	6 1/2				
CC-4005	1 1/4	4	6 1/2	CC-8000	4	8	6 1/2				
CC-2003	1 3/8	2	6 1/2	CC-6003	4 1/2	6	6 1/2				
CC-2702	1 3/8	2 3/4	6 1/2	CC-7000	5	7	6 1/2				
CC-2004	1 1/2	2	6 1/2	CC-8001	6	8	6 1/2				
CC-2200-1	1 1/2	2 1/4	6 1/2	CC-10301	7 3/4	10 3/8	6 1/8†				
CC-2503	1 1/2	2 1/2	6 1/2								
CC-2701	1 1/2	2 3/4	6 1/2								
CC-3002	1 1/2	3	6 1/2								
CC-3502	1 1/2	3 1/2	6 1/2								
CC-4007	1 1/2	4	6 1/2								
CC-2201-3	1 3/4	2 1/4	6 1/2								
CC-2500-1	1 3/4	2 1/2	6 1/2								
CC-2604	1 3/4	2 5/8	6 1/2								
CC-2703	1 3/4	2 3/4	6 1/2								
CC-3005	1 3/4	3	6 1/2								
CC-3503	1 3/4	3 1/2	6 1/2								

Tolerance: Tolerances may vary for some sizes due to different molds available at time of manufacture.

Note: Inquire for additional standard and non-standard sizes. Cast bronze and steel bushings also available by special request.









# Inch Cast Bronze Sleeve Bearing

ASTM: B-144-52-3B

SAE 660

Part No.	ID	OD	L	Part No.	ID	OD	L	Part No.	ID	OD	L	Part No.	ID	OD	L
CB-2024-32	1/4	1 1/2	4	CB-2130-36	1 5/16	1 7/8	4 1/2	CB-2428-08	1 1/2	1 3/4	1	CB-2731-24	1 11/16	1 15/16	3
CB-2024-34	1/4	1 1/2	4 1/4	CB-2224-14	1 3/8	1 1/2	1 3/4	CB-2428-10	1 1/2	1 3/4	1 1/4	CB-2731-28	1 11/16	1 15/16	3 1/2
CB-2024-36	1/4	1 1/2	4 1/2	CB-2224-16	1 3/8	1 1/2	2	CB-2428-12	1 1/2	1 3/4	1 1/2	CB-2732-28	1 11/16	2	3 1/2
CB-2024-40	1/4	1 1/2	5	CB-2224-20	1 3/8	1 1/2	2 1/2	CB-2428-14	1 1/2	1 3/4	1 3/4	CB-2732-36	1 11/16	2	4 1/2
CB-2024-44	1/4	1 1/2	5 1/2	CB-2226-10	1 3/8	1 5/8	1 1/4	CB-2428-16	1 1/2	1 3/4	2	CB-2733-24	1 11/16	2 1/16	3
CB-2025-16	1/4	1 9/16	2	CB-2226-12	1 3/8	1 5/8	1 1/2	CB-2428-18	1 1/2	1 3/4	2 1/4	CB-2733-28	1 11/16	2 1/16	3 1/2
CB-2025-20	1/4	1 9/16	2 1/2	CB-2226-16	1 3/8	1 5/8	2	CB-2428-20	1 1/2	1 3/4	2 1/2	CB-2733-32	1 11/16	2 1/16	4
CB-2025-24	1/4	1 9/16	3	CB-2226-24	1 3/8	1 5/8	3	CB-2428-24	1 1/2	1 3/4	3	CB-2733-36	1 11/16	2 1/16	4 1/2
CB-2025-28	1/4	1 9/16	3 1/2	CB-2226-26	1 3/8	1 5/8	3 1/4	CB-2428-28	1 1/2	1 3/4	3 1/2	CB-2733-40	1 11/16	2 1/16	5
CB-2025-30	1/4	1 9/16	3 3/4	CB-2226-28	1 3/8	1 5/8	3 1/2	CB-2428-32	1 1/2	1 3/4	4	CB-2733-44	1 11/16	2 1/16	5 1/2
CB-2026-14	1/4	1 5/8	1 3/4	CB-2226-32	1 3/8	1 5/8	4	CB-2428-36	1 1/2	1 3/4	4 1/2	CB-2735-16	1 11/16	2 3/16	2
CB-2026-16	1/4	1 5/8	2	CB-2226-36	1 3/8	1 5/8	4 1/2	CB-2428-40	1 1/2	1 3/4	5	CB-2735-20	1 11/16	2 3/16	2 1/2
CB-2026-20	1/4	1 5/8	2 1/2	CB-2227-28	1 3/8	1 11/16	3 1/2	CB-2428-44	1 1/2	1 3/4	5 1/2	CB-2735-24	1 11/16	2 3/16	3
CB-2026-24	1/4	1 5/8	3	CB-2228-16	1 3/8	1 3/4	2	CB-2429-24	1 1/2	1 13/16	3	CB-2735-28	1 11/16	2 3/16	3 1/2
CB-2026-26	1/4	1 5/8	3 1/4	CB-2228-18	1 3/8	1 3/4	2 1/4	CB-2430-12	1 1/2	1 7/8	1 1/2	CB-2735-32	1 11/16	2 3/16	4
CB-2026-28	1/4	1 5/8	3 1/2	CB-2228-20	1 3/8	1 3/4	2 1/2	CB-2430-16	1 1/2	1 7/8	2	CB-2735-36	1 11/16	2 3/16	4 1/2
CB-2026-32	1/4	1 5/8	4	CB-2228-24	1 3/8	1 3/4	3	CB-2430-20	1 1/2	1 7/8	2 1/2	CB-2735-44	1 11/16	2 3/16	5 1/2
CB-2026-36	1/4	1 5/8	4 1/2	CB-2228-28	1 3/8	1 3/4	3 1/2	CB-2430-22	1 1/2	1 7/8	2 3/4	CB-2736-24	1 11/16	2 1/4	3
CB-2026-38	1/4	1 5/8	4 3/4	CB-2228-32	1 3/8	1 3/4	4	CB-2430-24	1 1/2	1 7/8	3	CB-2736-36	1 11/16	2 1/4	4 1/2
CB-2027-16	1/4	1 11/16	2	CB-2230-24	1 3/8	1 7/8	3	CB-2430-28	1 1/2	1 7/8	3 1/2	CB-2832-12	1 3/4	2	1 1/2
CB-2027-20	1/4	1 11/16	2 1/2	CB-2230-28	1 3/8	1 7/8	3 1/2	CB-2430-32	1 1/2	1 7/8	4	CB-2832-16	1 3/4	2	2
CB-2027-26	1/4	1 11/16	3 1/4	CB-2230-32	1 3/8	1 7/8	4	CB-2430-36	1 1/2	1 7/8	4 1/2	CB-2832-18	1 3/4	2	2 1/4
CB-2027-28	1/4	1 11/16	3 1/2	CB-2230-36	1 3/8	1 7/8	4 1/2	CB-2430-40	1 1/2	1 7/8	5	CB-2832-20	1 3/4	2	2 1/2
CB-2028-10	1/4	1 3/4	1 1/4	CB-2232-24	1 3/8	2	3	CB-2430-44	1 1/2	1 7/8	5 1/2	CB-2832-24	1 3/4	2	3
CB-2028-14	1/4	1 3/4	1 3/4	CB-2232-32	1 3/8	2	4	CB-2432-16	1 1/2	2	2	CB-2832-32	1 3/4	2	4
CB-2028-16	1/4	1 3/4	2	CB-2234-52	1 3/8	2 1/8	6 1/2	CB-2432-20	1 1/2	2	2 1/2	CB-2832-36	1 3/4	2	4 1/2
CB-2028-18	1/4	1 3/4	2 1/4	CB-2326-14	1 7/16	1 5/8	1 3/4	CB-2432-24	1 1/2	2	3	CB-2832-42	1 3/4	2	5 1/4
CB-2028-20	1/4	1 3/4	2 1/2	CB-2326-22	1 7/16	1 5/8	2 3/4	CB-2432-28	1 1/2	2	3 1/2	CB-2833-28	1 3/4	2	3 1/2
CB-2028-22	1/4	1 3/4	2 3/4	CB-2326-24	1 7/16	1 5/8	3	CB-2432-32	1 1/2	2	4	CB-2834-20	1 3/4	2 1/16	2 1/2
CB-2028-24	1/4	1 3/4	3	CB-2327-20	1 7/16	1 11/16	2 1/2	CB-2432-36	1 1/2	2	4 1/2	CB-2834-22	1 3/4	2 1/8	2 3/4
CB-2028-28	1/4	1 3/4	3 1/2	CB-2327-24	1 7/16	1 11/16	3	CB-2432-40	1 1/2	2	5	CB-2834-26	1 3/4	2 1/8	3 1/4
CB-2028-30	1/4	1 3/4	3 3/4	CB-2327-28	1 7/16	1 11/16	3 1/2	CB-2434-24	1 1/2	2 1/8	3	CB-2834-28	1 3/4	2 1/8	3 1/2
CB-2028-32	1/4	1 3/4	4	CB-2327-32	1 7/16	1 11/16	4	CB-2434-32	1 1/2	2 1/8	4	CB-2834-32	1 3/4	2 1/8	4
CB-2028-40	1/4	1 3/4	5	CB-2327-34	1 7/16	1 11/16	4 1/4	CB-2436-24	1 1/2	2 1/4	3	CB-2834-34	1 3/4	2 1/8	4 1/4
CB-2030-16	1/4	1 7/8	2	CB-2328-18	1 7/16	1 3/4	2 1/4	CB-2436-32	1 1/2	2 1/4	4	CB-2834-40	1 3/4	2 1/8	5
CB-2030-20	1/4	1 7/8	2 1/2	CB-2328-24	1 7/16	1 3/4	3	CB-2436-40	1 1/2	2 1/4	5	CB-2834-44	1 3/4	2 1/8	5 1/2
CB-2030-24	1/4	1 7/8	3	CB-2328-32	1 7/16	1 3/4	4	CB-2436-52	1 1/2	2 1/4	6 1/2	CB-2836-14	1 3/4	2 1/4	1 3/4
CB-2030-32	1/4	1 7/8	4	CB-2329-24	1 7/16	1 13/16	3	CB-2529-24	1 9/16	1 13/16	3	CB-2836-16	1 3/4	2 1/4	2
CB-2032-24	1/4	2	3	CB-2329-26	1 7/16	1 13/16	3 1/4	CB-2529-28	1 9/16	1 13/16	3 1/2	CB-2836-20	1 3/4	2 1/4	2 1/2
CB-2032-32	1/4	2	4	CB-2329-28	1 7/16	1 13/16	3 1/2	CB-2529-32	1 9/16	1 13/16	4	CB-2836-24	1 3/4	2 1/4	3
CB-2032-52	1/4	2	6 1/2	CB-2329-32	1 7/16	1 13/16	4	CB-2531-28	1 9/16	1 15/16	3 1/2	CB-2836-28	1 3/4	2 1/4	3 1/2
CB-2124-14	1 5/16	1 1/2	1 3/4	CB-2329-34	1 7/16	1 13/16	4 1/4	CB-2531-36	1 9/16	1 15/16	4 1/2	CB-2836-32	1 3/4	2 1/4	4
CB-2124-24	1 5/16	1 1/2	3	CB-2329-40	1 7/16	1 13/16	5	CB-2630-18	1 5/8	1 7/8	2 1/4	CB-2836-34	1 3/4	2 1/4	4 1/4
CB-2125-24	1 5/16	1 9/16	3	CB-2330-24	1 7/16	1 7/8	3	CB-2630-24	1 5/8	1 7/8	3	CB-2836-40	1 3/4	2 1/4	5
CB-2125-28	1 5/16	1 9/16	3 1/2	CB-2330-32	1 7/16	1 7/8	4	CB-2630-30	1 5/8	1 7/8	3 3/4	CB-2838-28	1 3/4	2 3/8	3 1/2
CB-2125-32	1 5/16	1 9/16	4	CB-2330-36	1 7/16	1 7/8	4 1/2	CB-2632-14	1 5/8	2	1 3/4	CB-2838-36	1 3/4	2 3/8	4 1/2
CB-2126-16	1 5/16	1 5/8	2	CB-2330-40	1 7/16	1 7/8	5	CB-2632-20	1 5/8	2	2 1/2	CB-2838-40	1 3/4	2 3/8	5
CB-2126-20	1 5/16	1 5/8	2 1/2	CB-2331-16	1 7/16	1 15/16	2	CB-2632-24	1 5/8	2	3	CB-2840-52	1 3/4	2 1/2	6 1/2
CB-2126-24	1 5/16	1 5/8	3	CB-2331-24	1 7/16	1 15/16	3	CB-2632-28	1 5/8	2	3 1/2	CB-2935-52	1 13/16	2 3/16	4
CB-2126-32	1 5/16	1 5/8	4	CB-2331-28	1 7/16	1 15/16	3 1/2	CB-2632-32	1 5/8	2	4	CB-2935-42	1 13/16	2 3/16	5 1/4
CB-2126-38	1 5/16	1 5/8	4 3/4	CB-2331-32	1 7/16	1 15/16	4	CB-2632-36	1 5/8	2	4 1/2	CB-2937-32	1 13/16	2 5/16	4
CB-2127-20	1 5/16	1 11/16	2 1/2	CB-2331-36	1 7/16	1 15/16	4 1/2	CB-2632-40	1 5/8	2	5	CB-2937-40	1 13/16	2 5/16	5
CB-2127-24	1 5/16	1 11/16	3	CB-2331-40	1 7/16	1 15/16	5	CB-2632-44	1 5/8	2	5 1/2	CB-3034-20	1 7/8	2 1/8	2 1/2
CB-2127-32	1 5/16	1 11/16	4	CB-2331-44	1 7/16	1 15/16	5 1/2	CB-2634-24	1 5/8	2 1/8	3	CB-3034-24	1 7/8	2 1/8	3
CB-2129-24	1 5/16	1 13/16	3	CB-2332-32	1 7/16	2	4	CB-2634-32	1 5/8	2 1/8	4	CB-3034-32	1 7/8	2 1/8	4
CB-2129-32	1 5/16	1 13/16	4	CB-2426-16	1 1/2	1 5/8	2	CB-2634-36	1 5/8	2 1/8	4 1/2	CB-3036-24	1 7/8	2 1/4	3
CB-2130-28	1 5/16	1 7/8	3 1/2	CB-2427-22	1 1/2	1 11/16	2 3/4	CB-2634-40	1 5/8	2 1/8	5	CB-3036-26	1 7/8	2 1/4	3 1/4

Tolerance: Tolerances may vary for some sizes due to different molds available at time of manufacture.

Note: Inquire for additional standard and non-standard sizes. Cast bronze and steel bushings also available by special request.

# Inch Cast Bronze Sleeve Bearing

ASTM: B-144-52-3B

SAE 660

Part No.	ID	OD	L	Part No.	ID	OD	L	Part No.	ID	OD	L	Part No.	ID	OD	L
CB-3036-32	1 7/8	2 1/4	4	CB-3543-32	2 13/16	2 11/16	4	CB-4052-48	2 1/2	3 1/4	6	CB-5668-36	3 1/2	4 1/4	4 1/2
CB-3036-40	1 7/8	2 1/4	5	CB-3543-36	2 13/16	2 11/16	4 1/2	CB-4052-58	2 1/2	3 1/4	7 1/4	CB-5668-56	3 1/2	4 1/4	7
CB-3038-24	1 7/8	2 3/8	3	CB-3543-40	2 13/16	2 11/16	5	CB-4056-52	2 1/2	3 1/2	6 1/2	CB-5668-78	3 1/2	4 1/4	9 3/4
CB-3038-32	1 7/8	2 3/8	4	CB-3544-36	2 13/16	2 3/4	4 1/2	CB-4248-24	2 5/8	3	3	CB-6068-40	3 3/4	4 1/4	5
CB-3038-42	1 7/8	2 3/8	5 1/4	CB-3544-42	2 13/16	2 3/4	5 1/4	CB-4248-32	2 5/8	3	4	CB-6068-56	3 3/4	4 1/4	7
CB-3135-16	1 15/16	2 3/16	2	CB-3544-48	2 13/16	2 3/4	6	CB-4248-40	2 5/8	3	5	CB-6072-52	3 3/4	4 1/2	6 1/2
CB-3135-24	1 15/16	2 3/16	3	CB-3546-36	2 13/16	2 7/8	4 1/2	CB-4250-40	2 5/8	3 1/8	5	CB-6472-32	4	4 1/2	4
CB-3135-32	1 15/16	2 3/16	4	CB-3640-24	2 1/4	2 1/2	3	CB-4250-48	2 5/8	3 1/8	6	CB-6472-48	4	4 1/2	6
CB-3136-24	1 15/16	2 1/4	3	CB-3640-28	2 1/4	2 1/2	3 1/2	CB-4250-58	2 5/8	3 1/8	7 1/4	CB-6472-56	4	4 1/2	7
CB-3136-36	1 15/16	2 1/4	4 1/2	CB-3640-32	2 1/4	2 1/2	4	CB-4252-56	2 5/8	3 1/4	7	CB-6476-40	4	4 3/4	5
CB-3137-28	1 15/16	2 5/16	3 1/2	CB-3642-24	2 1/4	2 5/8	3	CB-4254-52	2 5/8	3 3/8	6 1/2	CB-6476-48	4	4 3/4	6
CB-3137-32	1 15/16	2 5/16	4	CB-3642-32	2 1/4	2 5/8	4	CB-4351-32	2 11/16	3 1/16	4	CB-6476-56	4	4 3/4	7
CB-3137-40	1 15/16	2 5/16	5	CB-3642-40	2 1/4	2 5/8	5	CB-4351-40	2 11/16	3 1/16	5	CB-6480-40	4	5	5
CB-3137-44	1 15/16	2 5/16	5 1/2	CB-3643-38	2 1/4	2 11/16	4 3/4	CB-4351-50	2 11/16	3 1/16	6 1/4	CB-6480-48	4	5	6
CB-3137-50	1 15/16	5 5/16	6 1/4	CB-3644-24	2 1/4	2 3/4	3	CB-4450-32	2 3/4	3 1/8	4	CB-6480-56	4	5	7
CB-3138-24	1 15/16	2 3/8	3	CB-3644-28	2 1/4	2 3/4	3 1/2	CB-4450-40	2 3/4	3 1/8	5	CB-6876-40	4 1/4	4 3/4	5
CB-3138-32	1 15/16	2 3/8	4	CB-3644-32	2 1/4	2 3/4	4	CB-4450-48	2 3/4	3 1/8	6	CB-6876-48	4 1/4	4 3/4	6
CB-3138-44	1 15/16	2 3/8	5 1/2	CB-3644-36	2 1/4	2 3/4	4 1/2	CB-4452-32	2 3/4	3 1/4	4	CB-6876-56	4 1/4	4 3/4	7
CB-3139-24	1 15/16	2 7/16	3	CB-3644-40	2 1/4	2 3/4	5	CB-4452-40	2 3/4	3 1/4	5	CB-6880-40	4 1/4	5	5
CB-3139-32	1 15/16	2 7/16	4	CB-3644-48	2 1/4	2 3/4	6	CB-4452-48	2 3/4	3 1/4	6	CB-6880-48	4 1/4	5	6
CB-3139-40	1 15/16	2 7/16	5	CB-3644-52	2 1/4	2 3/4	6 1/2	CB-4452-56	2 3/4	3 1/4	7	CB-6880-56	4 1/4	5	7
CB-3139-44	1 15/16	2 7/16	5 1/2	CB-3648-28	2 1/4	3	3 1/2	CB-4454-32	2 3/4	3 3/8	4	CB-7280-48	4 1/2	5	6
CB-3140-24	1 15/16	2 1/2	3	CB-3648-40	2 1/4	3	5	CB-4454-52	2 3/4	3 3/8	6 1/2	CB-7280-56	4 1/2	5	7
CB-3140-40	1 15/16	2 1/2	5	CB-3650-52	2 1/4	3 1/8	6 1/2	CB-4456-52	2 3/4	3 1/2	6 1/2	CB-7280-64	4 1/2	5	8
CB-3236-16	2	2 1/4	2	CB-3844-32	2 3/8	2 3/4	4	CB-4654-32	2 7/8	3 3/8	4	CB-7288-48	4 1/2	5 1/2	6
CB-3236-20	2	2 1/4	2 1/2	CB-3844-40	2 3/8	2 3/4	5	CB-4654-48	2 7/8	3 3/8	6	CB-7288-56	4 1/2	5 1/2	7
CB-3236-40	2	2 1/4	3	CB-3844-48	2 3/8	2 3/4	6	CB-4654-64	2 7/8	3 3/8	8	CB-7288-64	4 1/2	5 1/2	8
CB-3236-28	2	2 1/4	3 1/2	CB-3846-32	2 3/8	2 7/8	4	CB-4656-36	2 7/8	3 1/2	4 1/2	CB-8088-48	5	5 1/2	6
CB-3236-30	2	2 1/4	3 3/4	CB-3846-40	2 3/8	2 7/8	5	CB-4656-54	2 7/8	3 1/2	6 3/4	CB-8088-56	5	5 1/2	7
CB-3236-32	2	2 1/4	4	CB-3846-48	2 3/8	2 7/8	6	CB-4755-28	2 15/16	3 7/16	3 1/2	CB-8088-64	5	5 1/2	8
CB-3236-36	2	2 1/4	4 1/2	CB-3944-32	2 7/16	2 3/4	4	CB-4755-40	2 15/16	3 7/16	5	CB-8096-56	5	6	7
CB-3236-40	2	2 1/4	5	CB-3944-40	2 7/16	2 3/4	5	CB-4755-52	2 15/16	3 7/16	6 1/2	CB-8096-64	5	6	8
CB-3238-20	2	2 3/8	2 1/2	CB-3946-24	2 7/16	2 7/8	3	CB-4760-56	2 15/16	3 3/4	7	CB-8096-72	5	6	9
CB-3238-24	2	2 3/8	3	CB-3946-40	2 7/16	2 7/8	5	CB-4854-36	3	3 3/8	4 1/2				
CB-3238-28	2	2 3/8	3 1/2	CB-3947-32	2 7/16	2 15/16	4	CB-4854-64	3	3 3/8	8				
CB-3238-32	2	2 3/8	4	CB-3947-40	2 7/16	2 15/16	5	CB-4856-24	3	3 1/2	3				
CB-3238-36	2	2 3/8	4 1/2	CB-3947-50	2 7/16	2 15/16	6 1/4	CB-4856-32	3	3 1/2	4				
CB-3240-16	2	2 1/2	2	CB-3948-30	2 7/16	3	3 3/4	CB-4856-36	3	3 1/2	4 1/2				
CB-3240-20	2	2 1/2	2 1/2	CB-3948-40	2 7/16	3	5	CB-4856-44	3	3 1/2	5 1/2				
CB-3240-24	2	2 1/2	3	CB-3948-50	2 7/16	3	6 1/4	CB-4856-48	3	3 1/2	6				
CB-3240-28	2	2 1/2	3 1/2	CB-4044-24	2 1/2	2 3/4	3	CB-4856-72	3	3 1/2	9				
CB-3240-32	2	2 1/2	4	CB-4044-32	2 1/2	2 3/4	4	CB-4858-40	3	3 5/8	5				
CB-3240-36	2	2 1/2	4 1/2	CB-4044-40	2 1/2	2 3/4	5	CB-4858-52	3	3 5/8	6 1/2				
CB-3240-40	2	2 1/2	5	CB-4046-26	2 1/2	2 7/8	3 1/4	CB-4858-64	3	3 5/8	8				
CB-3240-44	2	2 1/2	5 1/2	CB-4046-36	2 1/2	2 7/8	4 1/2	CB-4860-50	3	3 3/4	6 1/4				
CB-3240-48	2	2 1/2	6	CB-4048-24	2 1/2	3	3	CB-4864-52	3	4	6 1/2				
CB-3242-32	2	2 5/8	4	CB-4048-30	2 1/2	3	3 3/4	CB-5256-32	3 1/4	3 1/2	4				
CB-3244-48	2	2 3/4	6	CB-4048-32	2 1/2	3	4	CB-5260-40	3 1/4	3 3/4	5				
CB-3244-52	2	2 3/4	6 1/2	CB-4048-40	2 1/2	3	5	CB-5260-48	3 1/4	3 3/4	6				
CB-3440-24	2 1/8	2 1/2	3	CB-4048-48	2 1/2	3	6	CB-5260-72	3 1/4	3 3/4	9				
CB-3440-32	2 1/8	2 1/2	4	CB-4048-56	2 1/2	3	7	CB-5563-36	3 7/16	3 15/16	4 1/2				
CB-3442-32	2 1/8	2 5/8	4	CB-4050-28	2 1/2	3 1/8	3 1/2	CB-5563-52	3 7/16	3 15/16	6 1/2				
CB-3442-40	2 1/8	2 5/8	5	CB-4050-32	2 1/2	3 1/8	4	CB-5664-32	3 1/2	4	4				
CB-3442-48	2 1/8	2 5/8	6	CB-4050-36	2 1/2	3 1/8	4 1/2	CB-5664-44	3 1/2	4	5 1/2				
CB-3542-32	2 13/16	2 5/8	4	CB-4050-54	2 1/2	3 1/8	6 3/4	CB-5664-48	3 1/2	4	6				
CB-3542-40	2 13/16	2 5/8	5	CB-4052-32	2 1/2	3 1/4	4	CB-5664-56	3 1/2	4	7				
CB-3543-28	2 13/16	2 11/16	3 1/2	CB-4052-40	2 1/2	3 1/4	5	CB-5666-48	3 1/2	4 1/8	6				

Tolerance: Tolerances may vary for some sizes due to different molds available at time of manufacture.

Note: Inquire for additional standard and non-standard sizes. Cast bronze and steel bushings also available by special request.

