

# All Metric Steel Sprockets

## DIN 8187/ ISO R 606

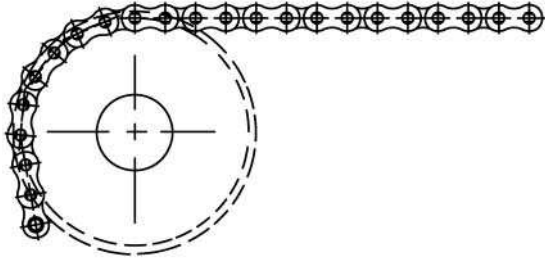

### NO. 02 TYPE A & B

CHAIN WIDTH: 5 x 2.5 mm  
 PITCH: 5 mm  
 ROLLER WIDTH: 2.5 mm  
 ROLLER DIA.: 3.2 mm  
 SPKT. WIDTH:  
     SINGLE B1 2.3 mm

All dimensions in mm (to international metric norms)

Teeth Z	Outside Dia. de	Min. Bore d1 ±1 mm	Hub Dia. dn	Total Width A	Teeth Z	Outside Dia. de	Min. Bore d1 ±1 mm
8	14.8	4	7	10	41	67.1	8
9	16.4	4-5	8	10	42	68.7	8
10	17.9	4-5	9	10	43	70.2	8
					44	71.8	8
					45	73.4	8
11	19.5	5-6	11	10			
12	21.1	5-6	12	10			
13	22.6	5-6	14	10	46	75.0	8
14	24.2	5-6	15	10	47	76.6	8
15	25.8	5-6	16	10	48	78.2	8
					49	79.8	8
					50	81.4	8
16	27.4	6-8	18	13			
17	29.0	6-8	18	13			
18	30.5	6-8	18	13	51	83.0	10
19	32.1	6-8	18	13	52	84.6	10
20	33.7	6-8	18	13	53	86.2	10
					54	87.7	10
					55	89.3	10
21	35.3	8	20	13			
22	36.9	8	20	13			
23	38.5	8	20	13	56	90.9	10
24	40.1	8	20	13	57	92.6	10
25	41.6	8	20	13	58	94.1	10
					59	95.7	10
					60	97.3	10
26	43.2	8	25	15			
27	44.8	8	25	15			
28	46.4	8	25	15	62	100.5	12
29	48.0	8	25	15	64	103.7	12
30	49.6	8	25	15	65	105.2	12
					66	106.8	12
					68	110.0	12
31	51.2	8	30	15			
32	52.8	8	30	15			
33	54.4	8	30	15	70	113.2	12
34	55.9	8	30	15	72	116.4	12
35	57.5	8	30	15	75	121.2	12
					76	122.7	12
					78	125.9	12
36	59.1	8	30	15			
37	60.7	8	30	15			
38	62.3	8	30	15	80	129.1	12
39	63.9	8	30	15	85	137.1	14
40	65.5	8	30	15	90	145.0	14
					95	153.0	14
					100	160.9	14
					110	176.8	14
					114	183.2	14
					120	192.8	14
					125	200.7	14

For plate sprockets with 51  
teeth or more H = 4 mm

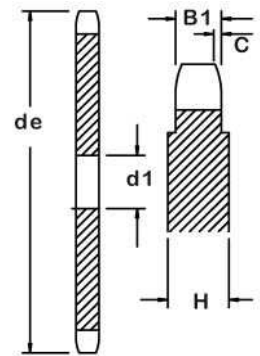

### 02A

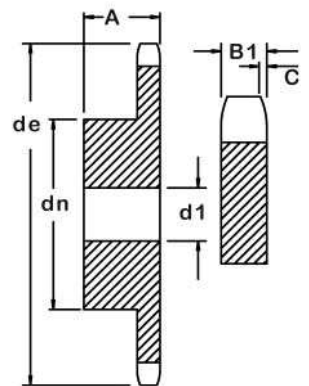

### 02B

Special Sprockets Quoted Upon Request.

# All Metric Steel Sprockets

## DIN 8187/ ISO R 606

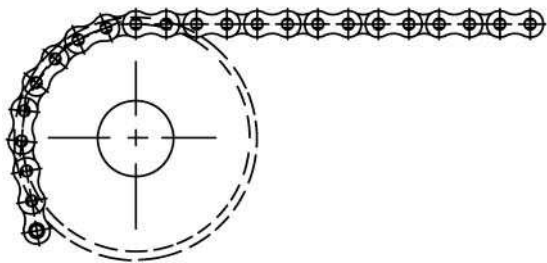

### NO. 12 TYPE A & B

CHAIN WIDTH: 6 x 2.8  
 PITCH: 6 mm  
 ROLLER WIDTH: 2.8 mm  
 ROLLER DIA.: 4 mm  
 SPKT. WIDTH: 4 mm  
 SINGLE B1 2.5 mm

All dimensions in mm (to international metric norms)

Teeth Z	Outside Dia. de	Min. Bore d1 ±1 mm	Hub Dia. dn	Total Width A	Teeth Z	Outside Dia. de	Min. Bore d1 ±1 mm
8	18.1	5	9.8	10	41	80.9	10-12
9	20.0	5	11.5	10	42	82.8	10-12
10	21.9	6	13	10	43	84.8	10-12
					44	86.7	10-12
					45	88.6	10-12
11	23.8	6	14	10	46	90.5	10-12
12	25.8	6	16	10	47	92.4	10-12
13	27.5	6-8	18	10	48	94.3	10-12
14	29.4	6-8	20	10	49	96.2	10-12
15	31.3	6-8	20	10	50	98.1	10-12
16	33.2	8	20	13	51	100.0	12
17	35.1	8	20	13	52	101.9	12
18	37.0	8	20	13	53	103.9	12
19	38.9	8	20	13	54	105.8	12
20	40.8	8	20	13	55	107.8	12
21	42.7	8	25	13	56	109.7	12
22	44.6	8	25	13	57	111.6	12
23	46.5	8	25	13	58	113.5	12
24	48.4	8	25	13	59	115.4	12
25	50.3	8	25	13	60	117.3	12
26	52.2	8-10	30	15	62	121.1	14-16
27	54.1	8-10	30	15	64	124.9	14-16
28	56.0	8-10	30	15	65	126.8	14-16
29	58.0	8-10	30	15	66	128.8	14-16
30	59.9	8-10	30	15	68	132.6	14-16
31	61.8	8-10	30	15	70	136.4	14-16
32	63.8	8-10	30	15	72	140.8	16
33	65.7	8-10	30	15	75	145.9	16
34	67.6	8-10	30	15	76	147.9	16
35	69.5	8-10	30	15	78	151.6	16
36	71.4	8-10	30	15	80	155.6	16
37	73.3	8-10	30	15	85	165.0	16
38	75.2	8-10	30	15	90	174.5	16
39	77.1	8-10	30	15	95	184.3	16
40	79.0	8-10	30	15	100	193.7	16
45	88.6	10-12	40-62	16-18	110	212.6	16
50	98.1	12	50-62	18-20	114	220.2	16
57	111.6	12	50-62	18-20	120	231.7	16
76	147.9	12-16	60	20	125	241.2	16

For plate sprockets with 51 teeth  
or more H = 4 mm

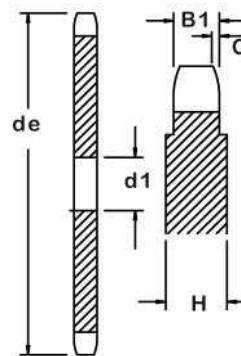

12A

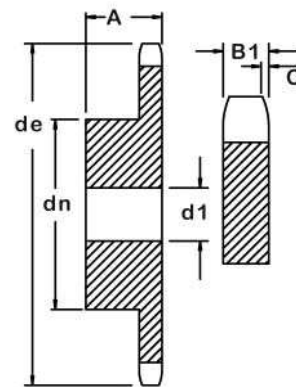

12B

Special Sprockets Quoted Upon Request.

# All Metric Steel Sprockets

## DIN 8187/ ISO R 606

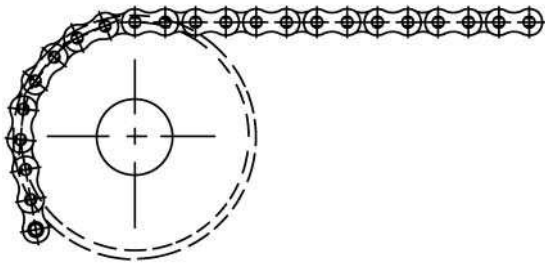

### NO. 22 TYPE A

CHAIN WIDTH:	8 x 1/8
PITCH:	8 mm
ROLLER WIDTH:	3 mm
ROLLER DIA.:	5 mm
SPKT. WIDTH:	
SINGLE B1	2.7 mm
DOUBLE B2	8.3 mm

All dimensions in mm (to international metric norms)

Teeth Z	Outside Dia. de	Min. Bore d1 ±1 mm		Teeth Z	Outside Dia. de	Min. Bore d1 ±1 mm	
		22	2022			22	2022
8	23.5	6	6-8	46	121.0	12	14-16
9	26.0	6	6-8	47	123.5	12	14-16
10	28.5	8	8	48	126.0	12	14-16
				49	128.5	12	14-16
				50	131.0	12	14-16
11	31.0	8	8				
12	33.5	8	8	51	133.5	14-16	16
13	37.0	8	8	52	136.0	14-16	16
14	39.5	8	8	53	139.0	14-16	16
15	42.0	8	8	54	141.5	14-16	16
				55	144.0	14-16	16
16	45.0	8	10				
17	47.0	8	10	56	146.5	14-16	16
18	50.0	8	10	57	149.0	14-16	16
19	52.5	8	10	58	151.5	14-16	16
20	55.0	8	10	59	154.0	14-16	16
				60	156.5	14-16	16
21	57.5	8-10	10				
22	60.0	8-10	10	61	159.0	16	20
23	62.5	8-10	10	62	161.0	16	20
24	65.0	8-10	10	63	164.0	16	20
25	67.5	8-10	10	64	167.0	16	20
				65	169.5	16	20
26	70.0	10	12				
27	72.5	10	12	66	172.0	16	20
28	75.0	10	12	67	174.5	16	20
29	77.5	10	12	68	177.0	16	20
30	80.5	10	12	69	179.5	16	20
				70	182.0	16	20
31	83.0	10	12				
32	85.5	10	12	72	187.0	20	20
33	88.0	10	12	75	195.0	20	20
34	90.5	10	12	76	197.0	20	20
35	93.0	10	12	78	200.1	20	20
				80	207.5	20	20
36	95.5	10	12				
37	98.0	10-12	12	85	219.9	20	20
38	100.5	10-12	12	90	232.6	20	20
39	103.0	10-12	12	95	245.5	20	20
40	105.5	10-12	12	100	259.0	20	20
				110	283.7	20	20
41	108.0	12	14-16				
42	111.0	12	14-16	114	294.5	20	20
43	113.5	12	14-16	120	310.0	20	20
44	116.0	12	14-16	125	322.5	20	20
45	118.5	12	14-16				

For plate sprockets with 46 teeth or more H = 4 mm

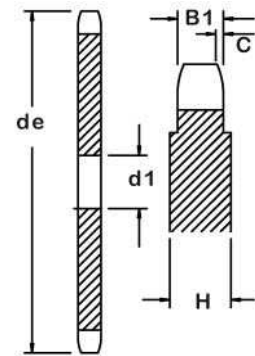

**22A**

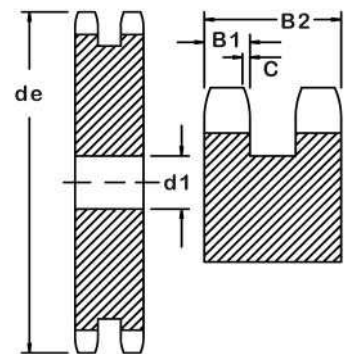

**2022A**

Special Sprockets Quoted Upon Request.

# All Metric Steel Sprockets

## DIN 8187/ ISO R 606

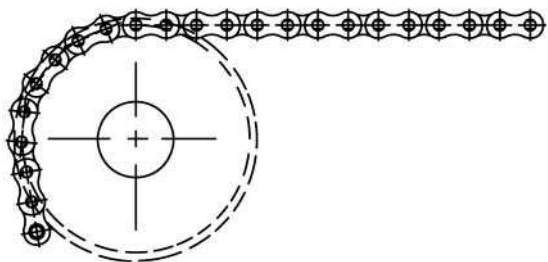

### NO. 22 TYPE B

CHAIN WIDTH:	8 x 1/8
PITCH:	8 mm
ROLLER WIDTH:	3 mm
ROLLER DIA.:	5 mm
SPKT. WIDTH:	
SINGLE B1	2.7 mm
DOUBLE B2	8.3 mm

All dimensions in mm (to international metric norms)

Teeth Z	Outside Dia. de	Pitch Dia. dp	Hub Diameter dn		Min. Bore d1 ±1 mm		Total Width A	
			22	2022	22	2022	22	2022
8	23.5	20.90	13	12	6	6-8	12	18
9	26.0	23.39	15	15	6	6-8	12	18
10	28.5	25.89	17	17	6-8	8	12	18
11	31.0	28.39	18	19	7-8	8-10	13	18
12	33.5	30.91	20	21	7-8	8-10	13	18
13	37.0	33.42	23	24	7-8	8-10	13	18
14	39.5	35.95	25	26	7-8	8-10	13	18
15	42.0	38.48	28	29	7-8	8-10	13	18
16	45.0	41.01	30	32	8	10	14	20
17	47.5	43.53	30	34	8	10	14	20
18	50.0	46.07	30	37	8	10	14	20
19	52.5	48.61	30	39	8	10	14	20
20	55.0	51.14	30	40	8	10	14	20
21	57.5	53.68	35	40-45	8	10-12	14	20
22	60.0	56.21	35	40-45	8	10-12	14	20
23	62.5	58.75	35	40-45	8	10-12	14	20
24	65.0	61.29	35	40-45	8	10-12	14	20
25	67.5	63.83	35	40-45	8	10-12	14	20
26	70.0	66.37	40	50	10	12	16	22
27	72.5	68.91	40	50	10	12	16	22
28	75.0	71.45	40	50	10	12	16	22
29	77.5	73.99	40	50	10	12	16	22
30	80.5	76.53	40	50	10	12	16	22
31	83.0	79.08	40	60	10-12	12	16	22
32	85.5	81.61	40	60	10-12	12	16	22
33	88.0	84.16	40	60	10-12	12	16	22
34	90.5	86.70	40	60	10-12	12	16	22
35	93.0	89.25	40	60	10-12	12	16	22
36	95.5	91.79	40	60	10-12	12	16	22
37	98.0	94.33	40	60	10-12	12	16	22
38	100.5	96.88	40	60	10-12	12	16	22
39	103.0	99.42	40	60	10-12	12	16	22
40	105.5	101.97	40	60	10-12	12	16	22
45	118.0	114.69	60		12		20	
50	130.7	127.41	60		12		20	
57	148.6	145.22	80		14		20	
76	197.7	193.59	80		20		25	

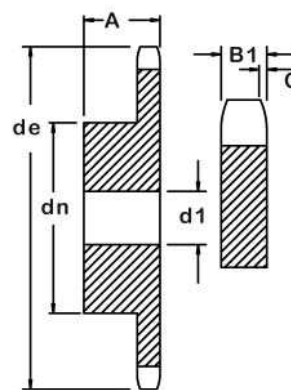

### 22B

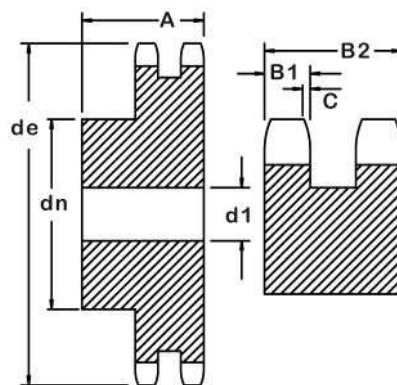

### 2022B

Special Sprockets Quoted Upon Request.

# All Metric Steel Sprockets

## DIN 8187/ ISO R 606

### NO. 32 TYPE A

CHAIN WIDTH: 3/8 x 7/32  
 PITCH: 9.525 mm  
 ROLLER WIDTH: 5.72 mm  
 ROLLER DIA.: 6.35 mm  
 SPKT. WIDTH:  
     SINGLE B1 5.25 mm  
     DOUBLE B2 15.5 mm  
     TRIPLE B3 25.75 mm

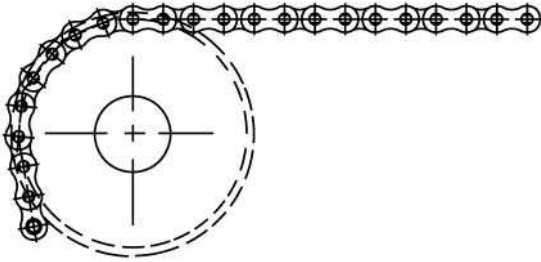

All dimensions in mm (to international metric norms)

Teeth Z	Outside Dia. de	Min. Bore d1 ±1 mm			Teeth Z	Outside Dia. de	Min. Bore d1 ±1 mm		
		32	2032	3032			32	2032	3032
8	28.0	6	8	8	46	144.0	16	20	20
9	31.0	8	8	8	47	147.0	16	20	20
10	34.0	8	8	10	48	150.0	16	20	20
					49	153.0	16	20	20
11	37.0	8	10	12	50	156.0	16	20	20
12	40.0	8	10	12					
13	44.0	8	10	12	51	159.0	16	20	20
14	47.0	8	10	12	52	162.0	16	20	20
15	50.0	8	10	12	53	165.0	16	20	20
					54	168.0	16	20	20
16	53.0	10	12	12	55	171.0	16	20	20
17	56.0	10	12	12					
18	59.0	10	12	12	56	174.0	16	20	25
19	62.0	10	12	12	57	177.0	16	20	25
20	65.0	10	12	12	58	180.0	16	20	25
					59	183.0	16	20	25
21	68.0	10	12	16	60	186.0	16	20	25
22	71.0	10	12	16					
23	74.0	10	12	16	61	189.0	20	20	25
24	77.0	10	12	16	62	192.0	20	25	25
25	80.0	10	12	16	63	195.5	20	25	25
					64	198.5	20	25	25
26	83.0	10	16	16	65	201.0	20	25	25
27	86.0	10	16	16					
28	89.5	10	16	16	66	204.5	20	25	25
29	92.5	10	16	16	67	207.5	20	25	25
30	95.5	10	16	16	68	210.5	20	25	25
					69	213.5	20	25	25
31	98.5	12	16	16	70	216.5	20	25	25
32	101.5	12	16	16					
33	104.5	12	16	16	72	222.5	20	25	25
34	107.5	12	16	16	75	231.5	20	25	25
35	110.5	12	16	16	76	234.5	20	25	25
					80	247.0	20	25	25
36	113.5	12	16	20	85	262.4	25	25	25
37	116.5	12	16	20					
38	119.5	12	16	20	90	277.5	25	25	25
39	122.5	12	16	20	95	292.5	25	25	25
40	125.5	12	16	20	100	308.0	25	25	25
					114	349.0	25	25	25
41	128.5	16	20	20	120	368.5	25	25	25
42	131.5	16	20	20					
43	134.5	16	20	20	125	384.5	25	25	25
44	137.5	16	20	20					
45	141.0	16	20	20					

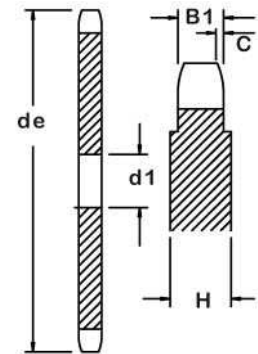

32A

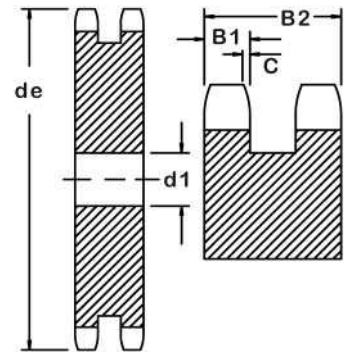

2032A

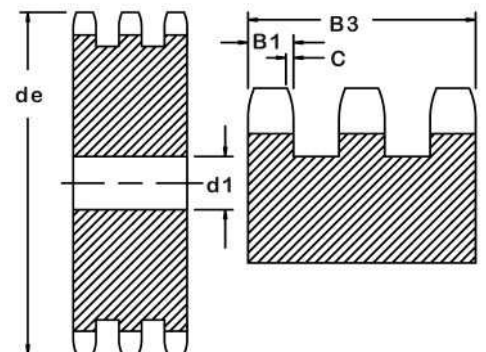

3032A

# All Metric Steel Sprockets

## DIN 8187/ ISO R 606

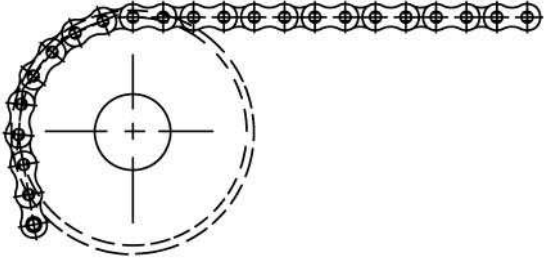

### NO. 32 TYPE B

CHAIN WIDTH:	3/8 x 7/32
PITCH:	9.525 mm
ROLLER WIDTH:	5.72 mm
ROLLER DIA.:	6.35 mm
SPKT. WIDTH:	
SINGLE B1	5.25 mm
DOUBLE B2	15.5 mm
TRIPLE B3	25.75 mm

All dimensions in mm (to international metric norms)

Teeth Z	Out- side Dia.	Pitch Dia. dp	Hub Diameter dn			Min. Bore d1 ±1 mm			Total Width A		
			32	2032	3032	32	2032	3032	32	2032	3032
8	28.0	24.89	15	15	15	8	8	8	20	25	32
9	31.0	27.85	18	18	18	8	8	8	20	25	32
10	34.0	30.82	20	20	20	8	8	10	20	25	32
11	37.0	33.80	22	22	22	8	10	12	25	30	35
12	40.0	36.80	25	25	25	8	10	12	25	30	35
13	44.0	39.79	28	28	28	8	10	12	25	30	35
14	47.0	42.80	31	31	31	8	10	12	25	30	35
15	50.0	45.81	34	34	34	8	10	12	25	30	35
16	53.0	48.82	37	37	37	10	12	12	28	30	35
17	56.0	51.83	40	40	40	10	12	12	28	30	35
18	59.0	54.85	43	43	43	10	12	12	28	30	35
19	62.0	57.87	45	46	46	10	12	12	28	30	35
20	65.0	60.89	46	49	49	10	12	12	28	30	35
21	68.0	63.91	48	52	52	12	16	16	28	30	40
22	71.0	66.93	50	55	55	12	16	16	28	30	40
23	74.0	69.95	52	58	58	12	16	16	28	30	40
24	77.0	72.97	54	61	61	12	16	16	28	30	40
25	80.0	76.00	57	64	64	12	16	16	28	30	40
26	83.0	79.02	60	67	67	12	16	16	28	30	40
27	86.0	82.05	60	70	70	12	16	16	28	30	40
28	89.5	85.07	60	73	73	12	16	16	28	30	40
29	92.5	88.09	60	76	76	12	16	16	28	30	40
30	95.5	91.12	60	79	79	12	16	16	28	30	40
31	98.5	94.15	65	80	80	14	16	16	30	30	40
32	101.5	97.17	65	80	80	14	16	16	30	30	40
33	104.5	100.20	65	80	80	14	16	16	30	30	40
34	107.5	103.23	65	80	85	14	16	16	30	30	40
35	110.5	106.26	65	80	85	14	16	16	30	30	40
36	113.5	109.29	70	90	90	16	16	16	30	30	40
37	116.5	112.32	70	90	90	16	16	16	30	30	40
38	119.5	115.35	70	90	95	16	16	16	30	30	40
39	122.5	118.37	70	90	95	16	16	16	30	30	40
40	125.5	121.40	70	90	100	16	16	16	30	30	40

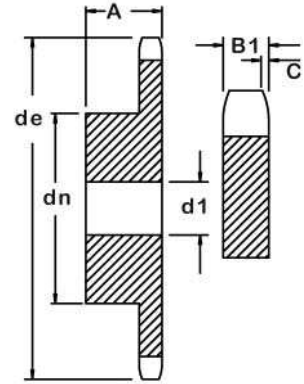

**32B**

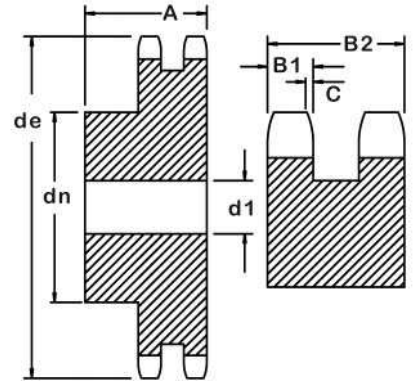

**2032B**

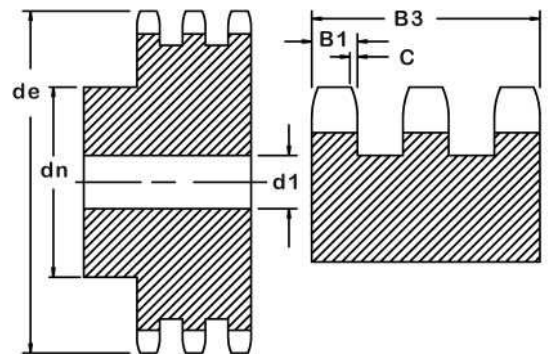

**3032B**

Special Sprockets Quoted Upon Request.

# All Metric Steel Sprockets

DIN 8187/ ISO R 606

## NO. 42 TYPE A

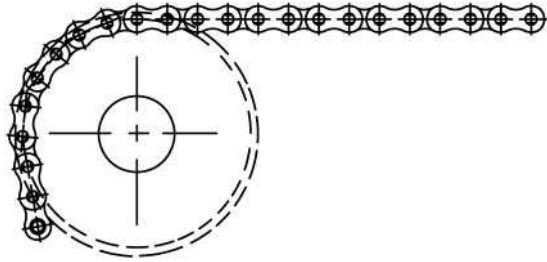

CHAIN WIDTH: 1/2 x 5/16  
 PITCH: 12.7 mm  
 ROLLER WIDTH: 7.75 mm  
 ROLLER DIA.: 8.51 mm  
 SPKT. WIDTH:  
 SINGLE B1 7 mm  
 DOUBLE B2 21 mm  
 TRIPLE B3 35 mm

All dimensions in mm (to international metric norms)

Teeth Z	Outside Dia. de	Min. Bore d1 ±1 mm			Teeth Z	Outside Dia. de	Min. Bore d1 ±1 mm		
		42	2042	3042			42	2042	3042
8	37.0	8	10	10	46	191.5	20	20	25
9	41.0	8	10	10	47	195.5	20	20	25
10	45.0	8	10	10	48	199.5	20	20	25
					49	203.5	20	20	25
					50	207.5	20	20	25
11	49.0	10	10	12	51	211.5	20	25	25
12	53.0	10	10	12	52	216.0	20	25	25
13	58.5	10	10	12	53	220.0	20	25	25
14	62.5	10	10	12	54	224.0	20	25	25
15	66.5	10	10	12	55	228.0	20	25	25
16	70.5	10	12	16	56	232.0	20	25	25
17	74.5	10	12	16	57	236.0	20	25	25
18	78.5	10	12	16	58	240.0	20	25	25
19	82.5	10	12	16	59	244.0	20	25	25
20	86.5	10	12	16	60	248.0	20	25	25
21	90.5	12	16	16	61	252.0	25	25	25
22	94.5	12	16	16	62	256.0	25	25	25
23	98.5	12	16	16	63	260.0	25	25	25
24	102.5	12	16	16	64	264.5	25	25	25
25	107.0	12	16	16	65	268.5	25	25	25
26	111.0	16	16	16	66	272.5	25	25	25
27	115.0	16	16	16	68	280.5	25	25	25
28	119.0	16	16	16	70	288.5	25	25	25
29	123.0	16	16	16	72	296.5	25	25	25
30	127.0	16	16	16	75	308.5	25	25	25
31	131.0	16	16	20	76	313.0	25	25	25
32	135.0	16	16	20	78	321.0	25	25	25
33	139.0	16	16	20	80	329.0	25	25	25
34	143.0	16	16	20	85	349.0	25	25	25
35	147.0	16	16	20	90	369.5	25	25	25
36	151.0	16	20	20	95	389.5	25	25	25
37	155.0	16	20	20	96	393.5	25	25	25
38	159.0	16	20	20	100	410.0	25	25	25
39	163.5	16	20	20	114	466.0	25	25	25
40	167.5	16	20	20	125	511.0	25	25	25
41	171.5	20	20	25					
42	175.5	20	20	25					
43	179.5	20	20	25					
44	183.5	20	20	25					
45	187.5	20	20	25					

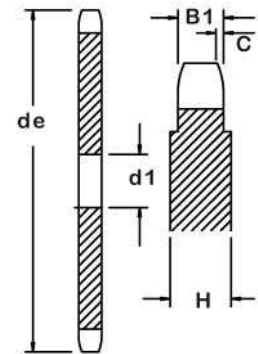

42A

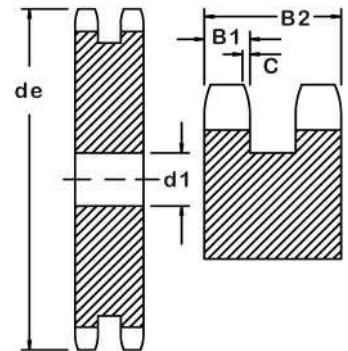

2042A

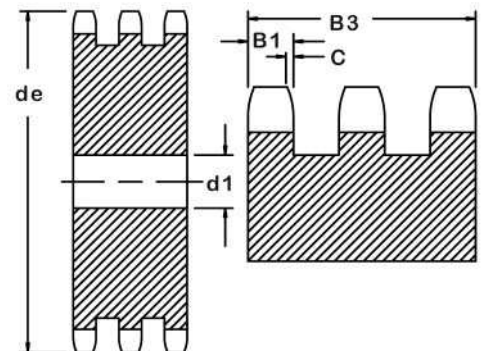

3042A

# All Metric Steel Sprockets

## DIN 8187/ ISO R 606

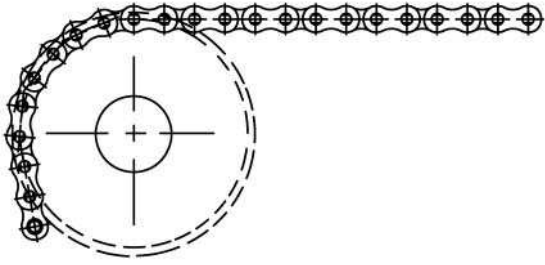

### NO. 42 TYPE B

CHAIN WIDTH:	1/2 x 5/16
PITCH:	12.7 mm
ROLLER WIDTH:	7.75 mm
ROLLER DIA.:	8.51 mm
SPKT. WIDTH:	
SINGLE B1	7 mm
DOUBLE B2	21 mm
TRIPLE B3	35 mm

All dimensions in mm (to international metric norms)

Teeth Z	Out- side Dia.	Pitch Dia. dp	Hub Diameter dn			Min. Bore d1 ±1 mm			Total Width A		
			42	2042	3042	42	2042	3042	42	2042	3042
8	37.0	33.18	20	20	20	10	10	8-10	25	32	46
9	41.0	37.13	24	24	24	10	10	12	25	32	46
10	45.0	41.10	26	28	28	10	10	12	25	32	46
11	49.0	45.07	29	32	32	10	12	14-16	25	35	50
12	53.0	49.07	33	35	35	10	12	14-16	28	35	50
13	58.5	53.06	37	38	38	10	12	14-16	28	35	50
14	62.5	57.07	41	42	42	10	12	14-16	28	35	50
15	66.5	61.09	45	46	46	10	12	14-16	28	35	50
16	70.5	65.10	50	50	50	12	14-16	16	28	35-38	50
17	74.5	69.11	52	54	54	12	14-16	16	28	35-38	50
18	78.5	73.14	56	58	58	12	14-16	16	28	35-38	50
19	82.5	77.16	60	62	62	12	14-16	16	28	35-38	50
20	86.5	81.19	64	66	66	12	14-16	16	28	35-38	50
21	90.5	85.22	68	70	70	14	16	16-20	28	40	55
22	94.5	89.24	70	70	70	14	16	16-20	28	40	55
23	98.5	93.27	70	70	70	14	16	16-20	28	40	55
24	102.5	97.29	70	75	75	14	16	16-20	28	40	55
25	107.0	101.33	70	80	80	14	16	16-20	28	40	55
26	110.0	105.36	70	85	85	16	16-20	20	30	40	55
27	115.0	109.40	70	85	85	16	16-20	20	30	40	55
28	119.0	113.42	70	90	90	16	16-20	20	30	40	55
29	123.0	117.46	80	95	95	16	16-20	20	30	40	55
30	127.0	121.50	80	100	100	16	16-20	20	30	40	55
31	131.0	125.54	90	100	110	16	20	20	30	40	55
32	135.0	129.56	90	100	110	16	20	20	30	40	55
33	139.0	133.60	90	100	110	16	20	20	30	40	55
34	143.0	137.64	90	100	110	16	20	20	30	40	55
35	147.0	141.68	90	100	110	16	20	20	30	40	55
36	151.0	145.72	90	100-110	120	16-20	20	25	35	40	55
37	155.0	149.76	90	100-110	120	16-20	20	25	35	40	55
38	159.0	153.80	90	100-110	120	16-20	20	25	35	40	55
39	163.5	157.83	90	100-110	120	16-20	20	25	35	40	55
40	167.5	161.87	90	100-110	120	16-20	20	25	35	40	55

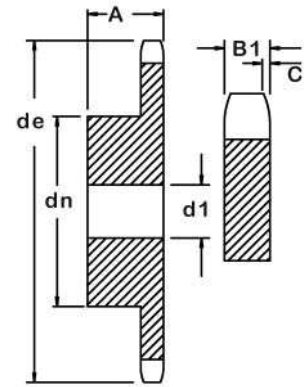

**42B**

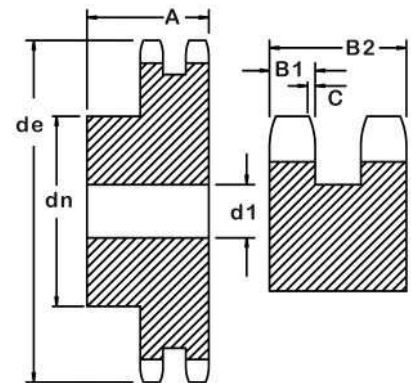

**2042B**

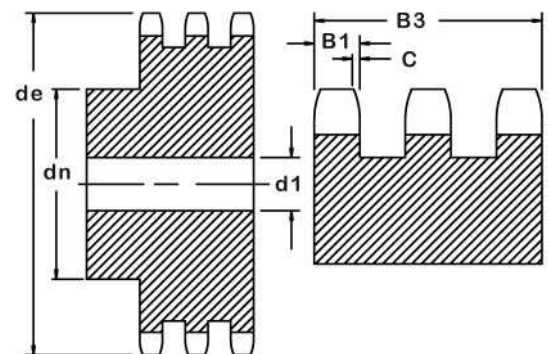

**3042B**

Special Sprockets Quoted Upon Request.



American Metric® Corporation

GROUP: 010

1-010 - 70910



# All Metric Steel Sprockets

## DIN 8187/ ISO R 606

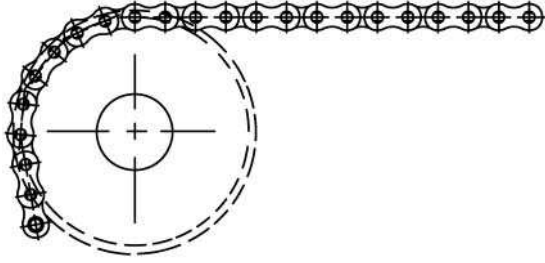

### NO. 43 TYPE A & B

CHAIN WIDTH: 1/2 x 1/8  
 PITCH: 12.7 mm  
 ROLLER WIDTH: 3.3 mm  
 ROLLER DIA.: 7.75 mm  
 SPKT. WIDTH: SINGLE B1 3 mm

All dimensions in mm (to international metric norms)

Teeth Z	Outside Dia. de	Min. Bore d1 ±1 mm	Hub Dia. dn	Total Width A	Teeth Z	Outside Dia. de	Min. Bore d1 ±1 mm
8	39.5	8	21	14	41	172.7	16
9	43.4	8	25	14	42	176.7	16
10	47.4	8	28	14	43	180.8	16
					44	184.8	16
					45	188.9	16
11	51.4	8	31	16	46	192.9	20
12	55.4	8	35	16	47	196.9	20
13	59.4	8	39	16	48	201.0	20
14	63.4	8	43	16	49	205.0	20
15	67.4	8	47	16	50	209.1	20
16	71.4	8-10	50	18	51	213.1	20
17	75.4	8-10	50	18	52	217.1	20
18	79.4	8-10	50	18	53	221.2	20
19	83.5	8-10	50	18	54	225.2	20
20	87.5	8-10	50	18	55	229.3	20
21	91.5	8-12	60	20	56	233.3	20
22	95.5	10-12	60	20	57	237.3	20
23	99.6	10-12	60	20	58	241.4	20
24	103.6	12	60	20	59	245.4	20
25	107.6	12	60	20	60	249.5	20
26	111.7	12-16	70	20	62	257.5	20
27	115.7	12-16	70	20	64	265.6	20
28	119.7	12-16	70	20	65	269.7	20
29	123.8	12-16	70	20	66	273.7	25
30	127.8	12-16	70	20	68	281.8	25
31	131.8	12-16	70	20	70	289.9	25
32	135.9	12-16	70	20	72	298.0	25
33	139.9	12-16	70	20	75	310.1	25
34	143.9	12-16	70	20	76	314.1	25
35	148.0	12-16	70	20	78	322.2	25
36	152.0	16	70	25	80	330.3	25
37	156.1	16	70	25	85	350.5	25
38	160.1	16	70	25	90	370.7	25
39	164.1	16	70	25	95	390.9	25
40	168.2	16	70	25	100	411.1	25
					110	451.5	25
					114	467.7	25
					120	492.0	25
					125	512.2	25

For plate sprockets with 31 to 89 teeth H = 4 mm

For plate sprockets with 90 teeth or more H = 6 mm

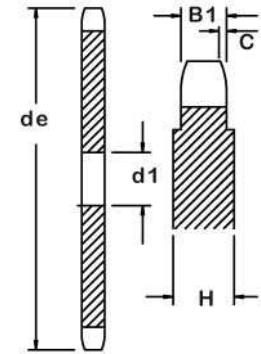

**43A**

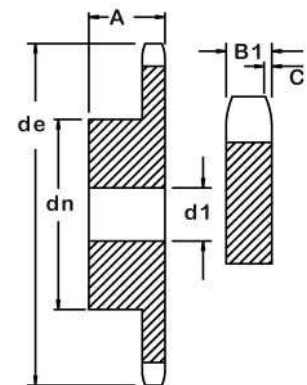

**43B**

Special Sprockets Quoted Upon Request.

# All Metric Steel Sprockets

## DIN 8187/ ISO R 606

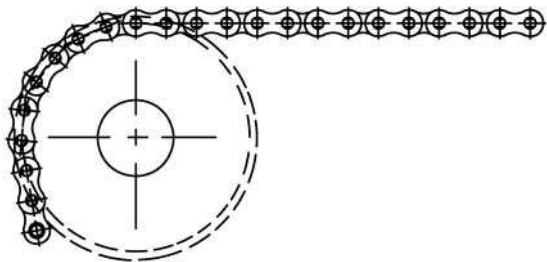

### NO. 46 TYPE A & B

CHAIN WIDTH: 1/2 x 3/16  
 PITCH: 12.7 mm  
 ROLLER WIDTH: 4.88 mm  
 ROLLER DIA.: 7.75 mm  
 SPKT. WIDTH:  
 SINGLE B1 4.5 mm

All dimensions in mm (to international metric norms)

Teeth Z	Outside Dia. de	Min. Bore d1 ±1 mm	Hub Dia. dn	Total Width A	Teeth Z	Outside Dia. de	Min. Bore d1 ±1 mm
8	39.5	8	21	14	41	172.7	16
9	43.4	8	25	14	42	176.7	16
10	47.4	8	28	14	43	180.8	16
					44	184.8	16
					45	188.9	16
11	51.4	8	31	16	46	192.9	20
12	55.4	8	35	16	47	196.9	20
13	59.4	8	39	16	48	201.0	20
14	63.4	8	43	16	49	205.0	20
15	67.4	8	47	16	50	209.1	20
16	71.4	8-10	50	18	51	213.1	20
17	75.4	8-10	50	18	52	217.1	20
18	79.4	8-10	50	18	53	221.2	20
19	83.5	8-10	50	18	54	225.2	20
20	87.5	8-10	50	18	55	229.3	20
21	91.5	8-12	60	20	56	233.3	20
22	95.5	10-12	60	20	57	237.3	20
23	99.6	10-12	60	20	58	241.4	20
24	103.6	12	60	20	59	245.4	20
25	107.6	12	60	20	60	249.5	20
26	111.7	12-16	70	20	62	257.5	20
27	115.7	12-16	70	20	64	265.6	20
28	119.7	12-16	70	20	65	269.7	20
29	123.8	12-16	70	20	66	273.7	25
30	127.8	12-16	70	20	68	281.8	25
31	131.8	12-16	70	20	70	289.9	25
32	135.9	12-16	70	20	72	298.0	25
33	139.9	12-16	70	20	75	310.1	25
34	143.9	12-16	70	20	76	314.1	25
35	148.0	12-16	70	20	78	322.2	25
36	152.0	16	70	25	80	330.3	25
37	156.1	16	70	25	85	350.5	25
38	160.1	16	70	25	90	370.7	25
39	164.1	16	70	25	95	390.9	25
40	168.2	16	70	25	100	411.1	25
					110	451.5	25
					114	467.7	25
					120	492.0	25
					125	512.2	25

For plate sprockets with 90 teeth  
or more H = 6 mm

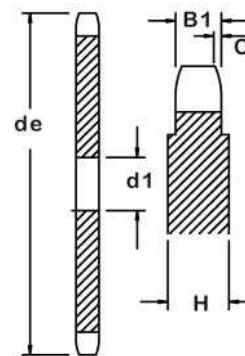

### 46A

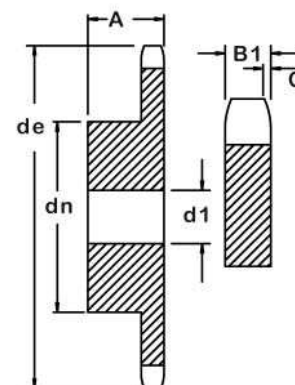

### 46B

Special Sprockets Quoted Upon Request.

# All Metric Steel Sprockets

## DIN 8187/ ISO R 606

### NO. 48 TYPE A & B

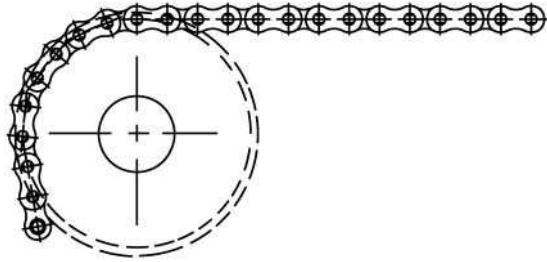

CHAIN WIDTH: 1/2 x 1/4  
 PITCH: 12.7 mm  
 ROLLER WIDTH: 6.4 mm  
 ROLLER DIA.: 7.75 mm  
 SPKT. WIDTH: SINGLE B1  
 SINGLE B1 5.9 mm

All dimensions in mm (to international metric norms)

Teeth Z	Outside Dia. de	Min. Bore d1 ±1 mm	Hub Dia. dn	Total Width A	Teeth Z	Outside Dia. de	Min. Bore d1 ±1 mm
8	39.5	8-10	20	25	41	172.7	16
9	43.4	8-10	24	25	42	176.7	16
10	47.4	8-10	26	25	43	180.8	16
					44	184.8	16
					45	188.9	16
11	51.4	8-10	29	25	46	192.9	20
12	55.4	8-10	33	28	47	196.9	20
13	59.4	8-10	37	28	48	201.0	20
14	63.4	8-10	41	28	49	205.0	20
15	67.4	8-10	45	28	50	209.1	20
16	71.4	8-12	50	28	51	213.1	20
17	75.4	8-12	52	28	52	217.1	20
18	79.4	8-12	56	28	53	221.2	20
19	83.5	8-12	60	28	54	225.2	20
20	87.5	8-12	64	28	55	229.3	20
21	91.5	8-14	68	28	56	233.3	20
22	95.5	10-14	70	28	57	237.3	20
23	99.6	10-14	70	28	58	241.4	20
24	103.6	12-14	70	28	59	245.4	20
25	107.6	12-14	70	28	60	249.5	20
26	111.7	12-16	70	30	62	257.5	20
27	115.7	12-16	70	30	64	265.6	20
28	119.7	12-16	70	30	65	269.7	20
29	123.8	12-16	80	30	66	273.7	25
30	127.8	12-16	80	30	68	281.8	25
31	131.8	12-16	90	30	70	289.9	25
32	135.9	12-16	90	30	72	298.0	25
33	139.9	12-16	90	30	75	310.1	25
34	143.9	12-16	90	30	76	314.1	25
35	148.0	12-16	90	30	78	322.2	25
36	152.0	16	90	35	80	330.3	25
37	156.1	16	90	35	85	350.5	25
38	160.1	16	90	35	90	370.7	25
39	164.1	16	90	35	95	390.9	25
40	168.2	16	90	35	100	411.1	25
					110	451.5	25
					114	467.7	25
					120	492.0	25
					125	512.2	25

71 teeth or more H = 7  
 91 teeth or more H = 8

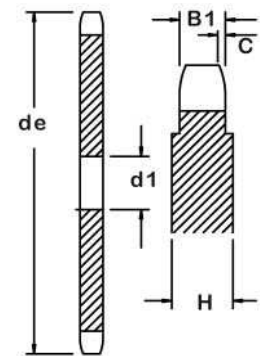

**48A**

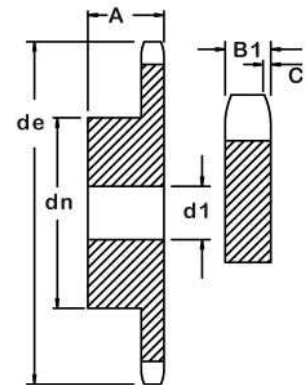

**48B**

Special Sprockets Quoted Upon Request.

# All Metric Steel Sprockets

## DIN 8187/ ISO R 606

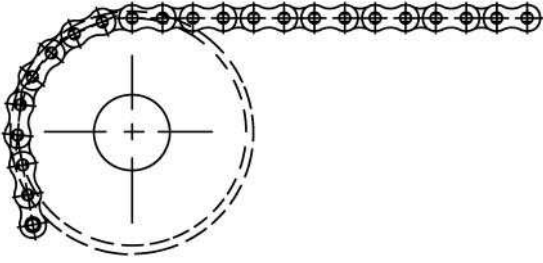

### NO. 52 TYPE A

CHAIN WIDTH:	5/8 x 3/8
PITCH:	15.875 mm
ROLLER WIDTH:	9.65 mm
ROLLER DIA.:	10.16 mm
SPKT. WIDTH:	
SINGLE B1	8.8 mm
DOUBLE B2	25.4 mm
TRIPLE B3	42 mm

For plate sprockets with 114 teeth or more H = 10 mm

All dimensions in mm (to international metric norms)

Teeth Z	Outside Dia. de	Min. Bore d1 ±1 mm			Teeth Z	Outside Dia. de	Min. Bore d1 ±1 mm		
		52	2052	3052			52	2052	3052
8	46.5	10	10	12	46	240.0	20	25	25
9	53.3	10	10	12	47	245.0	20	25	25
10	56.5	10	10	12	48	250.0	20	25	25
					49	255.0	20	25	25
					50	260.0	20	25	25
11	61.5	10	10-12	12	51	265.0	20	25	25
12	68.2	10	10-12	12	52	270.5	20	25	25
13	73.5	10	10-12	12	53	275.5	20	25	25
14	78.5	10-12	12	12	54	280.5	20	25	25
15	83.5	10-12	12	12	55	285.5	20	25	25
16	88.5	12	12	16					
17	93.5	12	12	16	56	290.5	25	25	25
18	99.0	12	12	16	57	295.5	25	25	25
19	104.0	12	12	16	58	300.5	25	25	25
20	109.0	12	12	16	59	305.5	25	25	25
					60	310.5	25	25	25
21	114.0	12	16	16					
22	119.0	12	16	16	61	315.5	25	25	30
23	124.0	12	16	16	62	321.0	25	25	30
24	129.0	12	16	16	63	326.0	25	25	30
25	134.0	12	16	16	64	331.0	25	25	30
					65	336.0	25	25	30
26	139.0	16	16-20	20					
27	144.0	16	16-20	20	70	361.0	25	25	30
28	149.0	16	16-20	20	72	371.5	25	25	30
29	154.0	16	16-20	20	75	386.5	25	25	30
30	159.0	16	16-20	20	76	391.5	25	25	30
					78	401.5	25	25	30
31	164.5	16	20	20					
32	169.5	16	20	20	80	411.5	25	25-30	30
33	174.5	16	20	20	85	437.0	30	30	30
34	179.5	16	20	20	92	462.0	30	30	30
35	185.5	16	20	20	95	487.5	30	30	30
					100	512.5	30	30	30
36	189.5	20	20	25					
37	194.5	20	20	25	110	563.0	30	30	30
38	199.5	20	20	25	114	583.0	30	30	30
39	204.5	20	20	25	120	613.5	30	30	30
40	209.5	20	20	25	125	639.0	30	30	30
41	214.5	20	20-25	25					
42	220.0	20	20-25	25					
43	225.0	20	20-25	25					
44	230.0	20	20-25	25					
45	235.0	20	20-25	25					

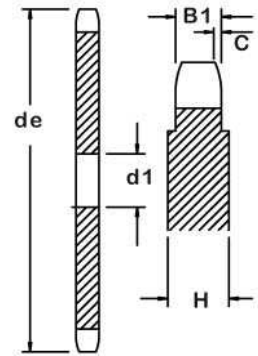

52A

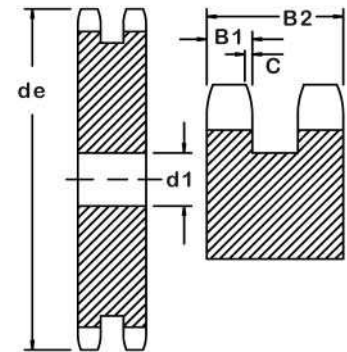

2052A

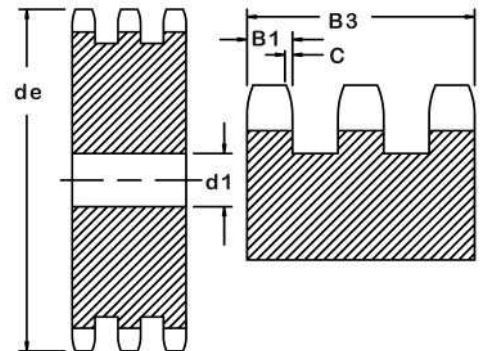

3052A

Special Sprockets Quoted Upon Request.

# All Metric Steel Sprockets

## DIN 8187/ ISO R 606

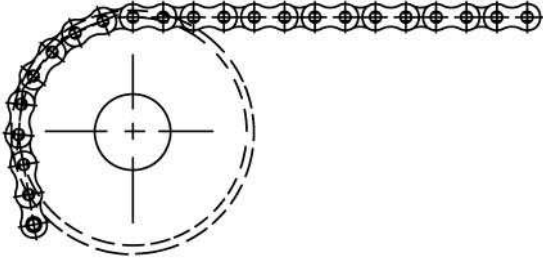

### NO. 52 TYPE B

CHAIN WIDTH:	5/8 x 3/8
PITCH:	15.875 mm
ROLLER WIDTH:	9.65 mm
ROLLER DIA.:	10.16 mm
SPKT. WIDTH:	
SINGLE B1	8.8 mm
DOUBLE B2	25.4 mm
TRIPLE B3	42 mm

All dimensions in mm (to international metric norms)

Teeth Z	Out-side Dia.	Pitch Dia. dp	Hub Diameter dn			Min. Bore d1 ±1 mm			Total Width A		
			52	2052	3052	52	2052	3052	52	2052	3052
8	46.6	41.48	25	25	25	10	12	12	25	40	55
9	51.5	46.42	30	30	30	10	12	12	25	40	55
10	56.5	51.37	35	35	35	10	12	16	25	40	55
11	61.5	56.34	37	39	39	12	14-16	16	30	40	55
12	66.5	61.34	42	44	44	12	14-16	16	30	40	55
13	73.5	66.32	47	49	49	12	14-16	16	30	40	55
14	78.5	71.34	52	54	54	12	14-16	16	30	40	55
15	83.5	76.36	57	59	59	12	14-16	16	30	40	55
16	88.5	81.37	60	64	64	12-14	16	16	30	45	60
17	93.5	86.39	60	69	69	12-14	16	16	30	45	60
18	99.0	91.42	70	74	74	12-14	16	16	30	45	60
19	104.0	96.45	70	79	79	12-14	16	16	30	45	60
20	109.0	101.49	75	84	84	12-14	16	16	30	45	60
21	114.0	106.52	75	85	85	16	16-20	20	30	45	60
22	119.0	111.55	80	90	90	16	16-20	20	30	45	60
23	124.0	116.58	80	95	95	16	16-20	20	30	45	60
24	129.0	121.62	80	100	100	16	16-20	20	30	45	60
25	134.0	126.66	80	105	105	16	16-20	20	30	45	60
26	139.0	131.70	85	110	110	20	20	20	35	45	60
27	144.0	136.75	85	110	110	20	20	20	35	45	60
28	149.0	141.78	90	115	115	20	20	20	35	45	60
29	154.0	146.83	90	115	115	20	20	20	35	45	60
30	159.0	151.87	90	120	120	20	20	20	35	45	60
31	164.5	156.92	95	120	120	20	20	20	35	45	60
32	169.5	161.95	95	120	120	20	20	20	35	45	60
33	174.5	167.00	95	120	120	20	20	20	35	45	60
34	179.5	172.05	95	120	120	20	20	20	35	45	60
35	184.5	177.10	95	120	120	20	20	20	35	45	60
36	189.5	182.15	100	120	120	20	20	25	35	45	60
37	194.5	187.20	100	120	120	20	20	25	35	45	60
38	199.5	192.24	100	120	120	20	20	25	35	45	60
39	204.5	197.29	100	120	120	20	20	25	35	45	60
40	209.5	202.34	100	120	120	20	20	25	35	45	60

Special Sprockets Quoted Upon Request.

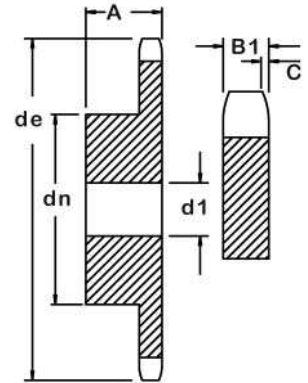

**52B**

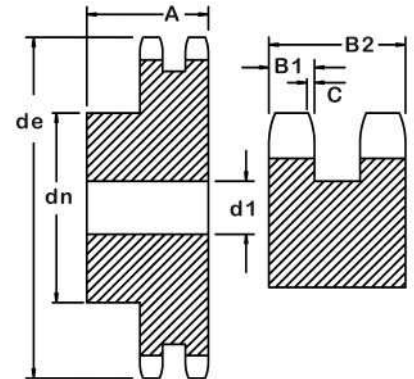

**2052B**

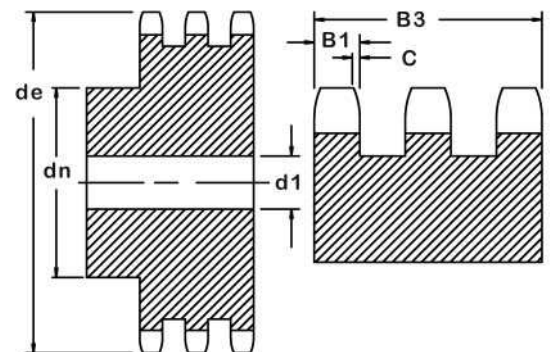

**3052B**

# All Metric Steel Sprockets

## DIN 8187/ ISO R 606

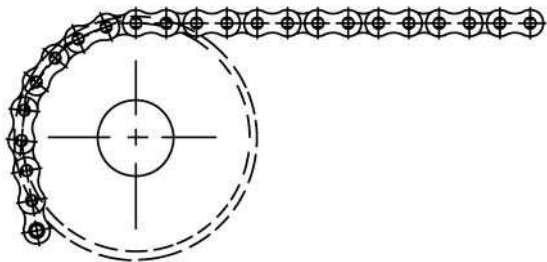

### NO. 62 TYPE A

CHAIN WIDTH:	3/4 x 7/16
PITCH:	19.05 mm
ROLLER WIDTH:	11.68 mm
ROLLER DIA.:	12.07 mm
SPKT. WIDTH:	
SINGLE B1	10.8 mm
DOUBLE B2	30.3 mm
TRIPLE B3	49.8 mm

All dimensions in mm (to international metric norms)

Teeth Z	Outside Dia. de	Min. Bore d1 ±1 mm			Teeth Z	Outside Dia. de	Min. Bore d1 ±1 mm		
		62	2062	3062			62	2062	3062
8	56.0	10-12	12	12	46	288.0	25	25	25
9	62.0	10-12	12	12	47	294.0	25	25	25
10	68.0	10-12	12	12	48	300.0	25	25	25
					49	306.0	25	25	25
					50	312.0	25	25	25
11	74.0	12-14	12-14	16	51	318.0	25	25	25
12	80.0	12-14	12-14	16	52	324.0	25	25	25
13	88.5	12-14	12-14	16	53	330.0	25	25	25
14	94.5	14-16	14-16	16	54	336.5	25	25	25
15	100.5	14-16	14-16	16	55	342.5	25	25	25
16	106.5	14-16	16	16-20	56	348.5	25	25	30
17	112.5	14-16	16	16-20	57	354.5	25	25	30
18	118.5	14-16	16	16-20	58	360.5	25	25	30
19	124.5	14-16	16	16-20	59	366.5	25	25	30
20	130.5	14-16	16	16-20	60	372.5	25	25	30
21	136.5	16	16-20	20	61	378.5	25	30	30
22	142.5	16	16-20	20	62	385.0	25	30	30
23	148.5	16	16-20	20	63	391.0	25	30	30
24	154.5	16	16-20	20	64	397.0	25	30	30
25	160.5	16	16-20	20	65	403.0	25	30	30
26	166.5	16	20	20	66	409.0	30	30	30
27	172.5	16	20	20	67	415.0	30	30	30
28	179.0	16	20	20	68	421.0	30	30	30
29	185.0	16	20	20	69	427.0	30	30	30
30	191.0	16	20	20	70	433.5	30	30	30
31	197.0	20	20	25	72	445.5	30	30	30
32	203.0	20	20	25	75	463.5	30	30	30
33	209.0	20	20	25	76	469.5	30	30	30
34	215.0	20	20	25	80	494.0	30	30	30
35	221.0	20	20	25	95	585.0	30	30	30
36	227.0	20	25	25	114	700.0	30	30	30
37	233.5	20	25	25	125	767.0	30	30	30
38	239.5	20	25	25					
39	245.5	20	25	25					
40	251.5	20	25	25					
41	257.5	25	25	25					
42	263.5	25	25	25					
43	269.5	25	25	25					
44	275.5	25	25	25					
45	282.0	25	25	25					

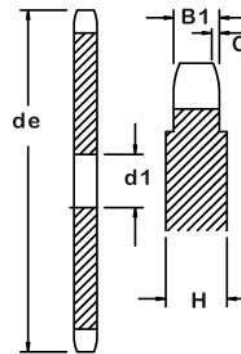

62A

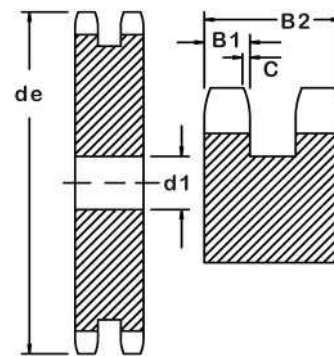

2062A

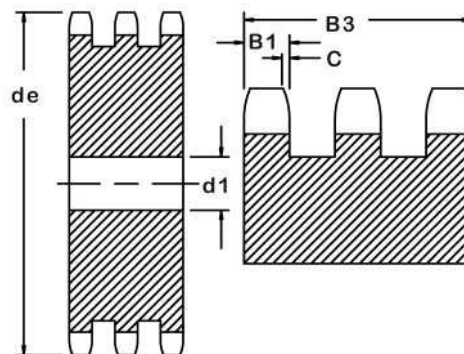

3062A

Special Sprockets Quoted Upon Request.

# All Metric Steel Sprockets

## DIN 8187/ ISO R 606

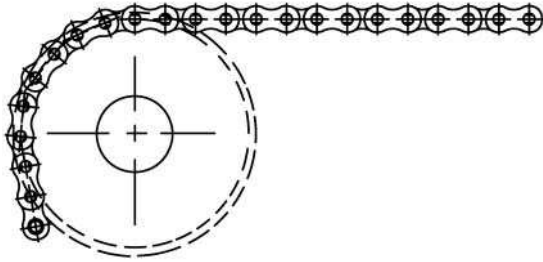

### NO. 62 TYPE B

CHAIN WIDTH:	3/4 x 7/16
PITCH:	19.05 mm
ROLLER WIDTH:	11.68 mm
ROLLER DIA.:	12.07 mm
SPKT. WIDTH:	
SINGLE B1	10.8 mm
DOUBLE B2	30.3 mm
TRIPLE B3	49.8 mm

All dimensions in mm (to international metric norms)

Teeth Z	Out-side Dia.	Pitch Dia. dp	Hub Diameter dn			Min. Bore d1 ±1 mm			Total Width A		
			62	2062	3062	62	2062	3062	62	2062	3062
8	56.0	49.78	31	31	31	12	12-16	16	30	45	65
9	62.0	55.70	37	37	37	12	12-16	16	30	45	65
10	68.0	61.64	42	42	42	12	12-16	16	30	45	65
11	74.0	67.61	46	47	47	14-16	16	20	35	50	70
12	80.0	73.61	52	53	53	14-16	16	20	35	50	70
13	88.5	79.59	58	59	59	14-16	16	20	35	50	70
14	94.5	85.61	64	65	65	14-16	16-20	20	35	50	70
15	100.5	91.63	70	71	71	14-16	16-20	20	35	50	70
16	106.5	97.65	75	77	77	16	20	20	35	50	70
17	112.5	103.67	80	83	83	16	20	20	35	50	70
18	118.5	109.71	80	89	89	16	20	20	35	50	70
19	124.5	115.75	80	95	95	16	20	20	35	50	70
20	130.5	121.78	80	100	100	16	20	20	35	50	70
21	136.5	127.82	90	100	100	20	20	20-25	40	50	70
22	142.5	133.86	90	100	100	20	20	20-25	40	50	70
23	148.5	139.90	90	110	110	20	20	20-25	40	50	70
24	154.5	145.94	90	110	110	20	20	20-25	40	50	70
25	160.5	152.00	90	120	120	20	20	20-25	40	50	70
26	166.5	158.04	95	120	120	20	20	20-25	40	50	70
27	172.5	164.09	95	120	120	20	20	20-25	40	50	70
28	179.0	170.13	95	120	120	20	20	20-25	40	50	70
29	185.0	176.19	95	120	120	20	20	20-25	40	50	70
30	191.0	182.25	95	120	120	20	20	20-25	40	50	70
31	197.0	188.31	95-100	120-130	130	20	20	25	40	50	70
32	203.0	194.35	95-100	120-130	130	20	20	25	40	50	70
33	209.0	200.40	95-100	120-130	130	20	20	25	40	50	70
34	215.0	206.46	95-100	120-130	130	20	20	25	40	50	70
35	221.0	212.52	95-100	120-130	130	20	20	25	40	50	70
36	227.0	218.58	100	120-130	130	20-25	25	25	40	50	70
37	233.5	224.64	100	120-130	130	20-25	25	25	40	50	70
38	239.5	230.64	100	120-130	130	20-25	25	25	40	50	70
39	245.5	236.75	100	120-130	130	20-25	25	25	40	50	70
40	251.5	242.81	100	120-130	130	20-25	25	25	40	50	70

Special Sprockets Quoted Upon Request.

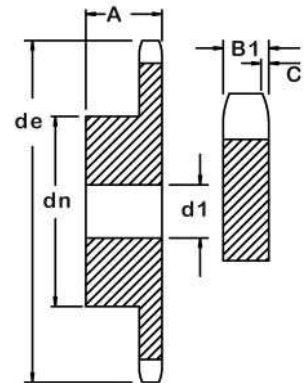

62B

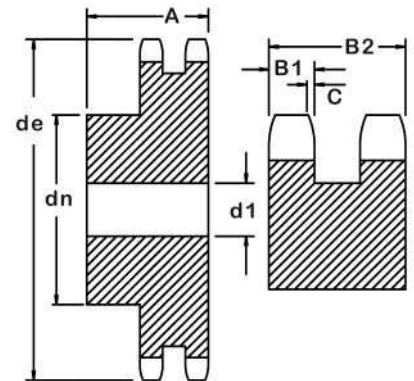

2062B

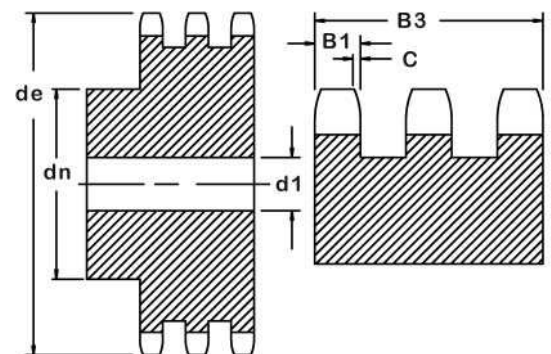

3062B

# All Metric Steel Sprockets

## DIN 8187/ ISO R 606

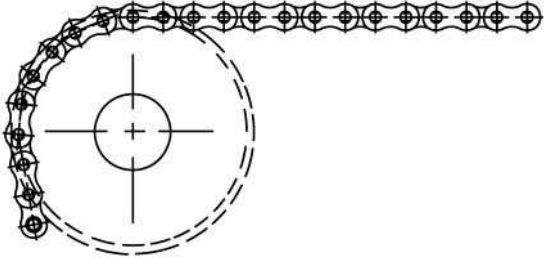

### NO. 82 TYPE A

CHAIN WIDTH:	1 x 17.02
PITCH:	25.4 mm
ROLLER WIDTH:	17.02 mm
ROLLER DIA.:	15.88 mm
SPKT. WIDTH:	
SINGLE B1	15.5 mm
DOUBLE B2	47.7 mm
TRIPLE B3	79.6 mm

All dimensions in mm (to international metric norms)

Teeth Z	Outside Dia. de	Min. Bore d1 ±1 mm			Teeth Z	Outside Dia. de	Min. Bore d1 ±1 mm		
		82	2082	3082			82	2082	3082
8	75.5	12-16	16	16-20	46	383.5	25	25-30	30
9	82.5	12-16	16	16-20	47	391.5	25	25-30	30
10	90.5	12-16	16	16-20	48	399.5	25	25-30	30
					49	408.0	25	25-30	30
					50	416.0	25	25-30	30
11	98.5	15-16	20	20	51	424.0	30	30	40
12	106.5	15-16	20	20	52	432.0	30	30	40
13	117.5	15-16	20	20	53	440.0	30	30	40
14	125.5	15-16	20	20	54	448.0	30	30	40
15	133.5	15-16	20	20	55	456.5	30	30	40
16	141.5	19-20	20	25-30	56	464.5	30	30-40	40
17	149.5	19-20	20	25-30	57	472.5	30	30-40	40
18	157.5	19-20	20	25-30	58	480.5	30	30-40	40
19	165.5	19-20	20	25-30	59	488.5	30	30-40	40
20	173.5	19-20	20	25-30	60	496.5	30	30-40	40
21	182.0	20	25	25-30	61	505.0	30	30-40	40
22	190.0	20	25	25-30	62	513.0	30	30-40	40
23	198.0	20	25	25-30	63	521.0	30	30-40	40
24	206.0	20	25	25-30	64	529.0	30	30-40	40
25	214.0	20	25	25-30	65	537.0	30	30-40	40
26	222.0	20	25	30	66	545.0	30	30-40	40
27	230.0	20	25	30	67	553.5	30	30-40	40
28	238.0	20	25	30	68	561.5	30	30-40	40
29	246.5	20	25	30	69	569.5	30	30-40	40
30	254.5	20	25	30	70	577.5	30	30-40	40
31	262.5	25	25	30	72	593.5	30	30-40	40
32	270.5	25	25	30	75	618.0	30	30-40	40
33	278.5	25	25	30	76	626.0	30	30-40	40
34	286.5	25	25	30	78	642.0	30	30-40	40
35	294.5	25	25	30	80	658.5	30	30-40	40
36	303.0	25	25	30	85	698.5	30	30-40	40
37	311.0	25	25	30	90	739.0	30	30-40	40
38	319.0	25	25	30	95	779.5	30	30-40	40
39	327.0	25	25	30	100	820.0	30	30-40	40
40	335.0	25	25	30	110	900.5	30	30-40	40
41	343.0	25	25	30	114	933.0	30	40	40
42	351.5	25	25	30	120	982.8	30	40	40
43	359.5	25	25	30	125	1023.2	30	40	40
44	367.5	25	25	30					
45	375.5	25	25	30					

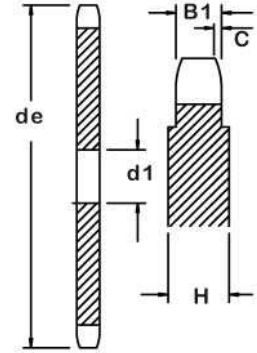

82A

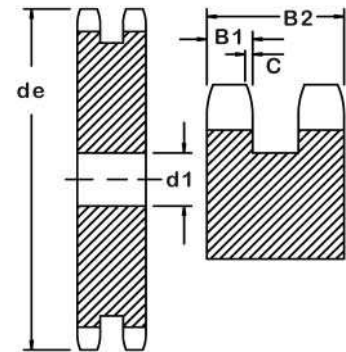

2082A

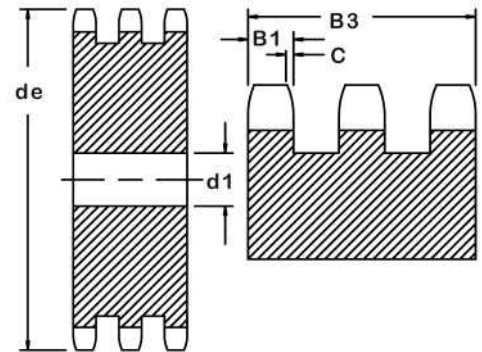

3082A

Special Sprockets Quoted Upon Request.



# All Metric Steel Sprockets

## DIN 8187/ ISO R 606

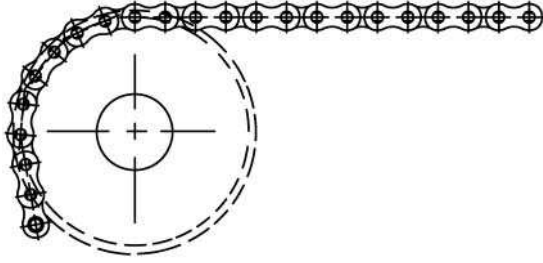

### NO. 82 TYPE B

CHAIN WIDTH:	1 x 17.02
PITCH:	25.4 mm
ROLLER WIDTH:	17.02 mm
ROLLER DIA.:	15.88 mm
SPKT. WIDTH:	
SINGLE B1	15.5 mm
DOUBLE B2	47.7 mm
TRIPLE B3	79.6 mm

All dimensions in mm (to international metric norms)

Teeth Z	Out- side Dia.	Pitch Dia. dp	Hub Diameter dn			Min. Bore d1 ±1 mm			Total Width A		
			82	2082	3082	82	2082	3082	82	2082	3082
8	74.5	66.37	42	42	42	16	16-20	20	35	65	95
9	82.5	74.27	50	50	50	16	16-20	20	35	65	95
10	93.8	82.19	55	56	56	16	16-20	20	35	65	95
11	98.5	90.14	61	64	64	16	20	25	40	70	100
12	106.5	98.14	69	72	72	16	20	25	40	70	100
13	117.5	106.12	78	80	80	16	20	25	40	70	100
14	125.5	114.15	84	88	88	16	20	25	40	70	100
15	133.5	122.17	92	96	96	16	20	25	40	70	100
16	141.5	130.20	100	104	104	20	20-25	25-30	45	70	100
17	149.5	138.22	100	112	112	20	20-25	25-30	45	70	100
18	157.5	146.28	100	120	120	20	20-25	25-30	45	70	100
19	165.5	154.33	100	128	128	20	20-25	25-30	45	70	100
20	173.5	162.38	100	130	130	20	20-25	25-30	45	70	100
21	182.0	170.43	110	130	130	20	25	25-30	50	70	100
22	190.0	178.48	110	130	130	20	25	25-30	50	70	100
23	198.0	186.54	110	130	130	20	25	25-30	50	70	100
24	206.0	194.59	110	130	130	20	25	25-30	50	70	100
25	214.0	202.66	110	130	130	20	25	25-30	50	70	100
26	222.0	210.72	120	130	130	20	25	30	50	70	100
27	230.0	218.79	120	130	130	20	25	30	50	70	100
28	238.0	226.85	120	130	130	20	25	30	50	70	100
29	246.5	234.92	120	130	130	20	25	30	50	70	100
30	254.5	243.00	120	130	130	20	25	30	50	70	100
31	262.5	251.08	120	140	140	25	25	30	50	70	100
32	270.5	259.13	120	140	140	25	25	30	50	70	100
33	278.5	267.21	120	140	140	25	25	30	50	70	100
34	286.5	275.28	120	140	140	25	25	30	50	70	100
35	294.5	283.36	120	140	140	25	25	30	50	70	100
36	303.0	291.44	120	140	140	25	25	30	50	70	100
37	311.0	299.51	120	140	140	25	25	30	50	70	100
38	319.0	307.59	120	140	140	25	25	30	50	70	100
39	327.0	315.67	120	140	140	25	25	30	50	70	100
40	335.0	323.75	120	140	140	25	25	30	50	70	100

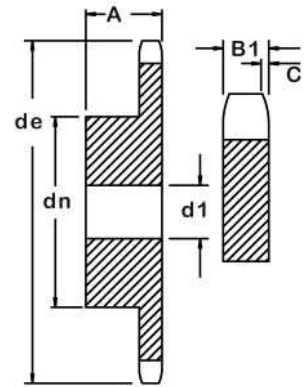

**82B**

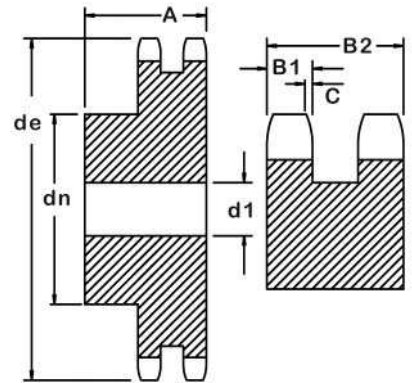

**2082B**

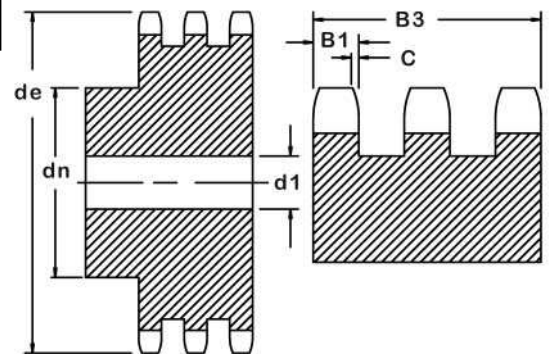

**3082B**

Special Sprockets Quoted Upon Request.

# All Metric Steel Sprockets

## DIN 8187/ ISO R 606

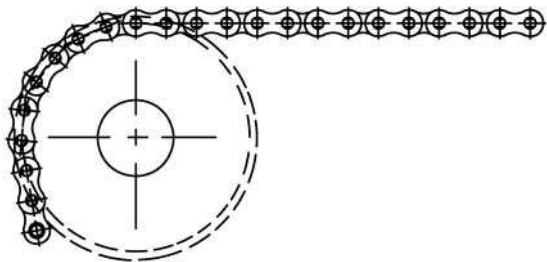

### NO. 102 TYPE A

CHAIN WIDTH:	1-1/4 x 3/4
PITCH:	31.75 mm
ROLLER WIDTH:	19.56 mm
ROLLER DIA.:	19.05 mm
SPKT. WIDTH:	
SINGLE B1	18 mm
DOUBLE B2	54.5 mm
TRIPLE B3	91 mm

All dimensions in mm (to international metric norms)

Teeth Z	Outside Dia. de	Min. Bore d1 ±1 mm			Teeth Z	Outside Dia. de	Min. Bore d1 ±1 mm		
		102	2102	3102			102	2102	3102
8	95.0	16	20	20	46	479.0	30	30	40
9	105.5	16	20	20	47	489.0	30	30	40
10	116.0	16	20	20	48	499.0	30	30	40
					49	509.0	30	30	40
11	126.0	16-20	20	20-25	50	519.5	30	30	40
12	136.0	20	20	20-25					
13	146.5	20	20	20-25	51	529.5	30	30-40	40
14	156.5	20	20	20-25	52	539.5	30	30-40	40
15	166.5	20	20	20-25	53	549.5	30	30-40	40
					54	559.5	30	30-40	40
16	176.5	20-25	25-30	25-30	55	570.0	30	30-40	40
17	186.5	20-25	25-30	25-30					
18	196.5	20-25	25-30	25-30	56	580.0	30	30-40	40
19	206.5	20-25	25-30	25-30	57	590.0	30	30-40	40
20	216.5	20-25	25-30	25-30	58	600.0	30	30-40	40
					59	610.0	30	30-40	40
21	226.5	25	25-30	25-30	60	620.0	30	30-40	40
22	236.5	25	25-30	25-30					
23	247.0	25	25-30	25-30	62	640.5	30	30-40	40
24	257.0	25	25-30	25-30	64	660.5	30	30-40	40
25	267.0	25	25-30	25-30	65	671.0	30	30-40	40
					66	681.0	30	30-40	40
26	277.0	25-30	25-30	25-30	68	701.0	30	30-40	40
27	287.0	25-30	25-30	25-30					
28	297.0	25-30	25-30	25-30	70	721.5	30	30-40	40
29	307.5	25-30	25-30	25-30	72	741.5	30	30-40	40
30	317.5	25-30	25-30	25-30	75	772.0	30	30-40	40
					76	782.0	30	30-40	40
31	327.5	25-30	25-30	30	80	822.5	30	30-40	40
32	337.5	25-30	25-30	30					
33	347.5	25-30	25-30	30	85	873.0	30	30-40	40
34	357.5	25-30	25-30	30	90	923.0	30	30-40	40
35	368.0	25-30	25-30	30	95	974.0	30	30-40	40
					100	1024.0	30-40	40	40
36	378.0	25-30	30	30	114	1166.0	30-40	40	40
37	388.0	25-30	30	30					
38	398.0	25-30	30	30					
39	408.0	25-30	30	30					
40	418.5	25-30	30	30					
41	428.5	30	30	40					
42	438.5	30	30	40					
43	448.5	30	30	40					
44	458.5	30	30	40					
45	469.0	30	30	40					

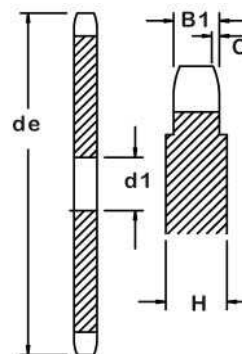

### 102A

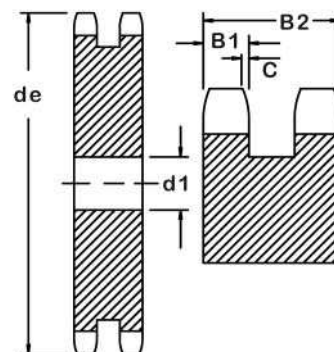

### 2102A

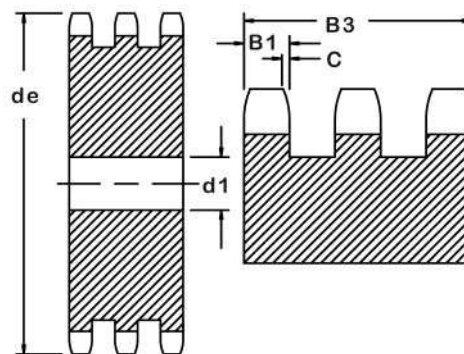

### 3102A

Special Sprockets Quoted Upon Request.

# All Metric Steel Sprockets

## DIN 8187/ ISO R 606

### NO. 102 TYPE B

CHAIN WIDTH: 1-1/4 x 3/4  
 PITCH: 31.75 mm  
 ROLLER WIDTH: 19.56 mm  
 ROLLER DIA.: 19.05 mm  
 SPKT. WIDTH:  
 SINGLE B1 18 mm  
 DOUBLE B2 54.5 mm  
 TRIPLE B3 91 mm

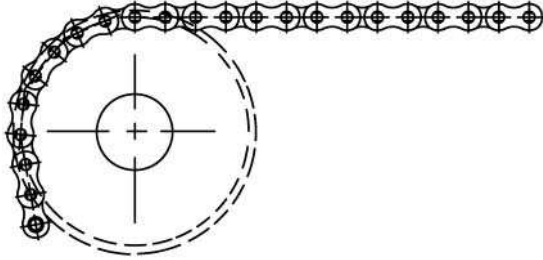

All dimensions in mm (to international metric norms)

Teeth Z	Out- side Dia.	Pitch Dia. dp	Hub Diameter dn			Min. Bore d1 ±1 mm			Total Width A		
			102	2102	3102	102	2102	3102	102	2102	3102
8	95.0	82.96	53	53	53	20	20	20-25	40	75	110
9	105.5	92.84	63	63	63	20	20	20-25	40	75	110
10	116.0	102.74	70	70	70	20	20	20-25	40	75	110
11	126.0	112.68	77	80	80	20	20-25	20-30	45	80	115
12	136.0	122.68	88	90	90	20	20-25	20-30	45	80	115
13	146.5	132.65	98	100	100	20	20-25	20-30	45	80	115
14	156.5	142.68	108	110	110	20	20-25	20-30	45	80	115
15	166.5	152.72	118	120	120	20	20-25	20-30	45	80	115
16	176.5	162.75	120	120	120	25	25-30	25-30	50	80	115
17	186.5	172.78	120	120	120	25	25-30	25-30	50	80	115
18	196.5	182.85	120	120	120	25	25-30	25-30	50	80	115
19	206.5	192.91	120	120	120	25	25-30	25-30	50	80	115
20	216.5	202.98	120	120	120	25	25-30	25-30	50	80	115
21	226.5	213.04	140	140	140	25-30	25-30	25-30	55	80	115
22	236.5	223.11	140	140	140	25-30	25-30	25-30	55	80	115
23	247.0	233.17	140	140	140	25-30	25-30	25-30	55	80	115
24	257.0	243.23	140	140	140	25-30	25-30	25-30	55	80	115
25	267.0	253.33	140	140	140	25-30	25-30	25-30	55	80	115
26	277.0	263.40	150	150	150	25-30	25-30	25-30	55	80	115
27	287.0	273.49	150	150	150	25-30	25-30	25-30	55	80	115
28	297.0	283.56	150	150	150	25-30	25-30	25-30	55	80	115
29	307.5	293.65	150	150	150	25-30	25-30	25-30	55	80	115
30	317.5	303.75	150	150	150	25-30	25-30	25-30	55	80	115
31	327.5	313.85	150-160	150	150	25-30	25-30	30	55	80	115
32	337.5	323.91	150-160	150	150	25-30	25-30	30	55	80	115
33	347.5	334.01	150-160	150	150	25-30	25-30	30	55	80	115
34	357.5	344.10	150-160	150	150	25-30	25-30	30	55	80	115
35	368.0	354.20	150-160	150	150	25-30	25-30	30	55	80	115
36	378.0	364.30	150-160	150	150	25-30	30	30	55	80	115
37	388.0	374.39	150-160	150	150	25-30	30	30	55	80	115
38	398.0	384.49	150-160	150	150	25-30	30	30	55	80	115
39	408.0	394.59	150-160	150	150	25-30	30	30	55	80	115
40	418.5	404.68	150-160	150	150	25-30	30	30	55	80	115

Special Sprockets Quoted Upon Request.

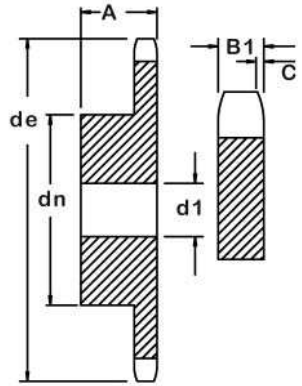

102B

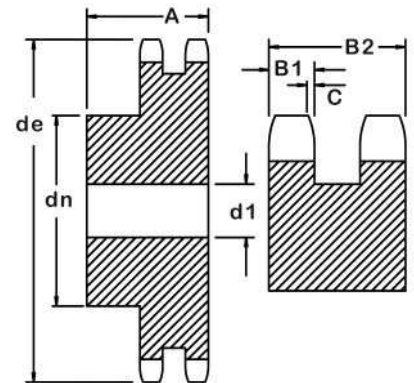

2102B

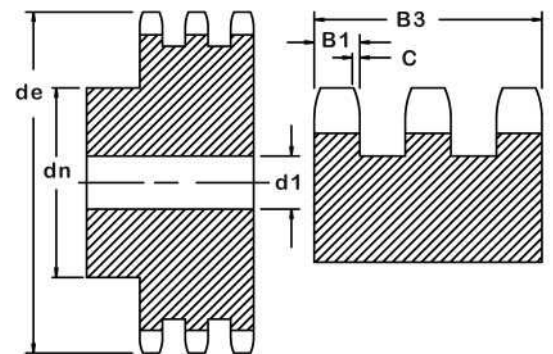

3102B

# All Metric Steel Sprockets

## DIN 8187/ ISO R 606

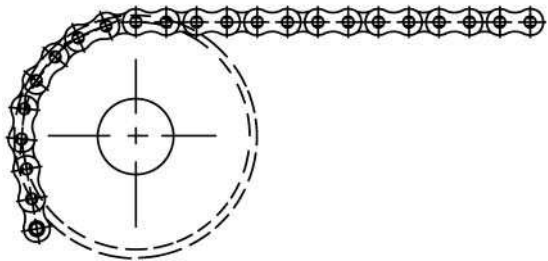

### NO. 122 TYPE A

CHAIN WIDTH:	1-1/2 x 1
PITCH:	38.1 mm
ROLLER WIDTH:	25.4 mm
ROLLER DIA.:	25.4 mm
SPKT. WIDTH:	
SINGLE B1	24.1 mm
DOUBLE B2	72.0 mm
TRIPLE B3	120.3 mm

All dimensions in mm (to international metric norms)

Teeth Z	Outside Dia. de	Min. Bore d1 ±1 mm			Teeth Z	Outside Dia. de	Min. Bore d1 ±1 mm		
		122	2122	3122			122	2122	3122
8	112.5	20	25	25	46	576.5	30	40	40
9	124.5	20	25	25	47	588.5	30	40	40
10	136.0	20	25	25	48	600.5	30	40	40
					49	612.5	30	40	40
11	148.0	20-25	25	25-30	50	624.5	30	40	40
12	160.0	20-25	25	25-30					
13	177.0	20-25	25	25-30	51	637.0	30	40	40
14	189.0	20-25	25	25-30	52	649.0	30	40	40
15	201.0	20-25	25	25-30	53	661.0	30	40	40
					54	673.0	30	40	40
16	213.5	25	25-30	25-30	55	685.5	30	40	40
17	225.5	25	25-30	25-30					
18	237.5	25	25-30	25-30	56	697.5	30	40	40
19	249.5	25	25-30	25-30	57	709.5	30	40	40
20	261.5	25	25-30	25-30	58	721.5	30	40	40
					59	734.0	30	40	40
21	273.5	25-30	25-30	30-40	60	746.0	30	40	40
22	285.5	25-30	25-30	30-40					
23	298.0	25-30	25-30	30-40	62	770.0	40	40	40
24	310.0	25-30	25-30	30-40	64	794.5	40	40	40
25	322.0	25-30	25-30	30-40	65	806.5	40	40	40
					66	818.5	40	40	40
26	334.0	30	30	30-40	68	843.0	40	40	40
27	346.0	30	30	30-40					
28	358.0	30	30	30-40	70	867.0	40	40	40
29	370.5	30	30	30-40	72	891.5	40	40	40
30	382.5	30	30	40	75	928.0	40	40	40
					76	940.0	40	40	40
31	394.5	30	30-40	40	80	988.5	40	40	40
32	406.5	30	30-40	40					
33	419.0	30	30-40	40					
34	431.0	30	30-40	40	85	1048.5	40	40	40
35	443.0	30	30-40	40	95	1170.0	40	40	40
36	455.0	30	30-40	40					
37	467.0	30	30-40	40					
38	479.5	30	30-40	40					
39	491.5	30	30-40	40					
40	503.5	30	30-40	40					
41	515.5	30	40	40					
42	528.0	30	40	40					
43	540.0	30	40	40					
44	552.0	30	40	40					
45	564.0	30	40	40					

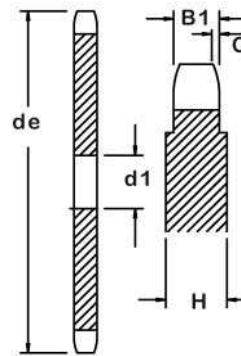

### 122A

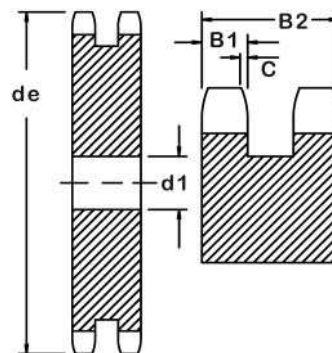

### 2122A

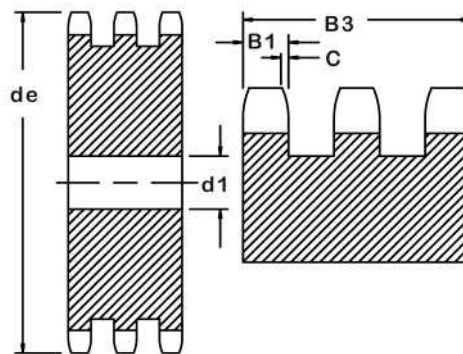

### 3122A

Special Sprockets Quoted Upon Request.

# All Metric Steel Sprockets

## DIN 8187/ ISO R 606

### NO. 122 TYPE A&B

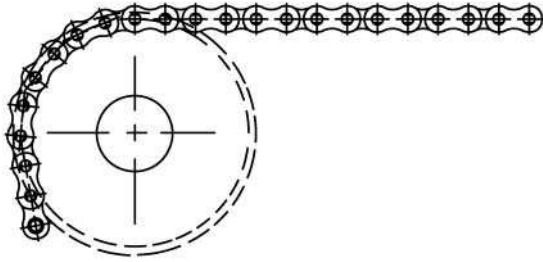

CHAIN WIDTH:	1-1/2 x 1
PITCH:	38.1 mm
ROLLER WIDTH:	25.4 mm
ROLLER DIA.:	25.4 mm
SPKT. WIDTH:	
SINGLE B1	24.1 mm
DOUBLE B2	72.0 mm
TRIPLE B3	120.3 mm

All dimensions in mm (to international metric norms)

Teeth Z	Outside Dia. de	Pitch Dia. dp	Hub Diameter dn			Min. Bore d1 ±1 mm			Total Width A		
			122	2122	3122	122	2122	3122	122	2122	3122
8	112.5	99.55	58	58	58	20	25	25	45	95	140
9	124.5	111.40	70	70	70	20	25	25	45	95	140
10	139.0	123.30	80	80	80	20	25	25	45	95	140
11	152.0	135.23	90	90	90	25	25	25-30	50	100	150
12	164.0	147.21	102	102	102	25	25	25-30	50	100	150
13	177.0	159.21	114	114	114	25	25	25-30	50	100	150
14	189.0	171.22	128	128	128	25	25	25-30	50	100	150
15	201.0	183.25	132-140	132-140	132-140	25	25	25-30	50	100	150
16	213.5	195.29	136-140	136-150	136-150	25	25-30	25-30	55	100	150
17	225.5	207.35	136-140	136-150	136-150	25	25-30	25-30	55	100	150
18	237.5	219.41	136-140	150-160	150-160	25	25-30	25-30	55	100	150
19	249.5	231.48	136-140	160	160	25	25-30	25-30	55	100	150
20	261.5	243.55	136-140	160	160	25	25-30	25-30	55	100	150
21	273.5	255.63	150	160	160	25-30	25-30	30-40	60	100	150
22	285.5	267.72	150	160	160	25-30	25-30	30-40	60	100	150
23	298.0	279.81	150	160	160	25-30	25-30	30-40	60	100	150
24	310.0	291.90	150	160	160	25-30	25-30	30-40	60	100	150
25	322.0	303.99	150	160	160	25-30	25-30	30-40	60	100	150
26	334.0	316.09	150-160	160	160	30	30	30-40	60	100	150
27	346.0	328.19	150-160	160	160	30	30	30-40	60	100	150
28	358.0	340.29	150-160	160	160	30	30	30-40	60	100	150
29	370.5	352.39	150-160	160	160	30	30	30-40	60	100	150
30	382.5	364.50	150-160	160	160	30	30	40	60	100	150
31	394.5	376.62	150-160	160-170	160-170	30	30-40	40	60	100	150
32	406.5	388.69	150-160	160-170	160-170	30	30-40	40	60	100	150
33	419.0	400.81	150-160	160-170	160-170	30	30-40	40	60	100	150
34	431.0	412.93	150-160	160-170	160-170	30	30-40	40	60	100	150
35	443.0	425.04	150-160	160-170	160-170	30	30-40	40	60	100	150
36	455.0	437.16	150-160	160-170	160-170	30	30-40	40	60	100	150
37	467.0	449.27	150-160	160-170	160-170	30	30-40	40	60	100	150
38	479.5	461.39	150-160	160-170	160-170	30	30-40	40	60	100	150
39	491.5	473.50	150-160	160-170	160-170	30	30-40	40	60	100	150
40	503.5	485.62	150-160	160-170	160-170	30	30-40	40	60	100	150

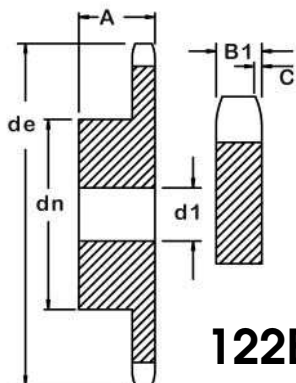

**122B**

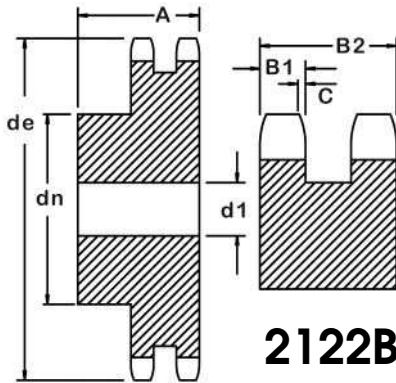

**2122B**

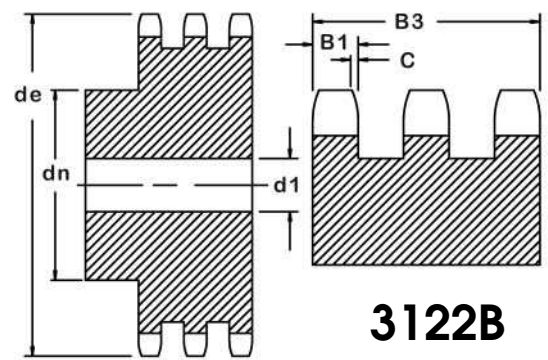

**3122B**

# All Metric Steel Sprockets

## DIN 8187/ ISO R 606

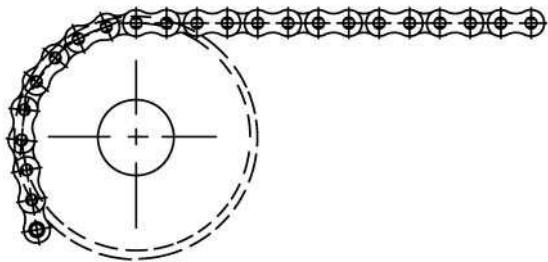

### NO. 142 TYPE A

CHAIN WIDTH:	1-3/4 x 1-1/4
PITCH:	44.45 mm
ROLLER WIDTH:	30.99 mm
ROLLER DIA.:	27.94 mm
SPKT. WIDTH:	
SINGLE B1	28 mm
DOUBLE B2	87.5 mm
TRIPLE B3	147 mm

All dimensions in mm (to international metric norms)

Teeth Z	Outside Dia. de	Pitch Dia. dp	Min. Bore d1 ±1 mm		
			142	2142	3142
8	135.5	116.15	20-25	25	25
9	149.0	129.96	20-25	25	25
10	163.0	143.85	20-25	25	25
11	177.0	157.77	25	25-30	30
12	191.0	171.74	25	25-30	30
13	207.0	185.74	25	25-30	30
14	221.0	199.76	25	25-30	30
15	235.0	213.79	25	25-30	30
16	249.0	227.84	30	30	30
17	263.0	241.91	30	30	30
18	277.0	255.98	30	30	30
19	292.0	270.06	30	30	30
20	306.0	284.15	30	30	30
21	320.0	298.24	30	30	30-40
22	334.0	312.34	30	30	30-40
23	348.0	326.44	30	30	30-40
24	362.0	340.55	30	30	30-40
25	376.0	354.66	30	30	40
26	390.0	368.77	30	30-40	40
27	404.0	382.88	30	30-40	40
28	419.0	397.00	30	30-40	40
29	433.0	411.12	30	30-40	40
30	447.0	425.24	30	30-40	40
31	460.0	439.36	30	30-40	40
32	475.0	453.49	30	30-40	40
33	489.0	467.61	30	30-40	40
34	503.0	481.74	30	30-40	40
35	517.0	495.87	30	30-40	40
36	531.0	510.00	30	30-40	40
37	545.0	524.13	30	30-40	40
38	559.0	538.26	30	30-40	40
39	574.0	552.40	30	30-40	40
40	588.0	566.54	30	30-40	40
45	659.0	637.22	30	30-40	40
50	729.0	707.91	30	30-40	40
57	828.0	806.90	40	40	40
60	871.0	849.32	40	40	40
76	1097.0	1075.62	40	40	40

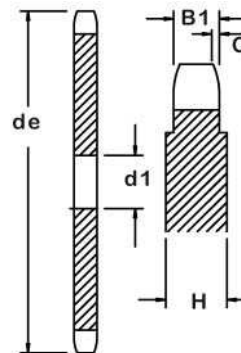

142A

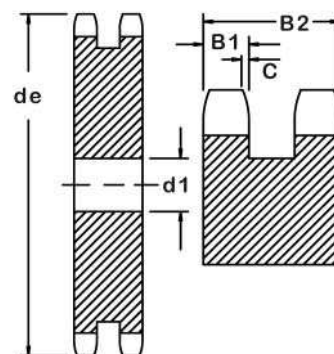

2142A

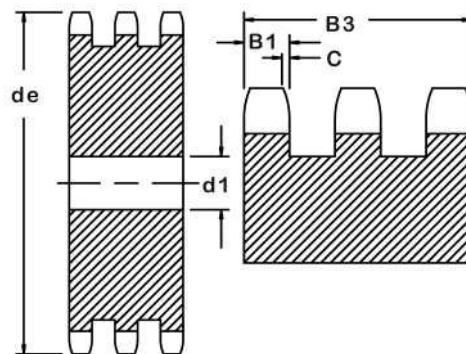

3142A

Special Sprockets Quoted Upon Request.

# All Metric Steel Sprockets

## DIN 8187/ ISO R 606

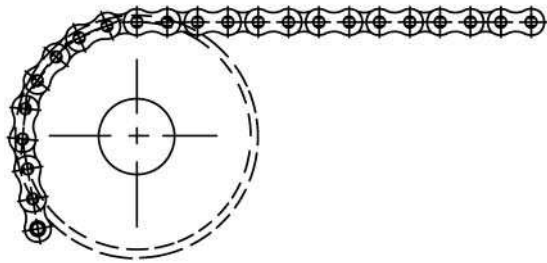

### NO. 142 TYPE B

CHAIN WIDTH:	1-3/4 x 1-1/4
PITCH:	44.45 mm
ROLLER WIDTH:	30.99 mm
ROLLER DIA.:	27.94 mm
SPKT. WIDTH:	
SINGLE B1	28 mm
DOUBLE B2	87.5 mm
TRIPLE B3	147 mm

All dimensions in mm (to international metric norms)

Teeth Z	Outside Dia. de	Pitch Dia. dp	Hub Diameter dn			Min. Bore d1 ±1 mm			Total Width A		
			142	2142	3142	142	2142	3142	142	2142	3142
8	135.5	116.15	74	74	74	25	25-30	30	70	120	180
9	149.0	129.96	88	88	88	25	25-30	30	70	120	180
10	163.0	143.85	100	100	100	25	25-30	30	70	120	180
11	177.0	157.77	112	112	112	25	25-30	30	70	120	180
12	191.0	171.74	125	125	125	25	25-30	30	70	120	180
13	207.0	185.74	125-130	125-130	125-130	25	25-30	30	70	120	180
14	221.0	199.76	125-135	125-135	125-135	25	25-30	30	70	120	180
15	235.0	213.79	125-145	145	145	25	25-30	30	70	120	180
16	249.0	227.84	160	160	160	30	30	30	75	120	180
17	263.0	241.91	160	160	160	30	30	30	75	120	180
18	277.0	255.98	160	160	160	30	30	30	75	120	180
19	292.0	270.06	160	180	180	30	30	30	75	120	180
20	306.0	284.15	160	180	180	30	30	30	75	120	180
21	320.0	298.24	160-170	180	180	30	30	30-40	75	120	180
22	334.0	312.34	160-170	180	180	30	30	30-40	75	120	180
23	348.0	326.44	160-170	180	180	30	30	30-40	75	120	180
24	362.0	340.55	160-170	180	180	30	30	30-40	75	120	180
25	376.0	354.66	160-170	180	180	30	30	40	75	120	180
26	390.0	368.77	160-170	180	180	30	30-40	40	75	120	180
27	404.0	382.88	160-170	180	180	30	30-40	40	75	120	180
28	419.0	397.00	160-170	180	180	30	30-40	40	75	120	180
29	433.0	411.12	160-170	180	180	30	30-40	40	75	120	180
30	447.0	425.24	160-170	180	180	30	30-40	40	75	120	180
31	461.0	439.36	180	200	200	30	30-40	40	75	120	180
32	475.0	453.49	180	200	200	30	30-40	40	75	120	180
33	489.0	467.61	180	200	200	30	30-40	40	75	120	180
34	504.0	481.74	180	200	200	30	30-40	40	75	120	180
35	517.0	495.87	180	200	200	30	30-40	40	75	120	180
36	522.0	510.00	180	200	200	30	30-40	40	75	120	180
37	546.0	524.13	180	200	200	30	30-40	40	75	120	180
38	560.0	538.26	180	200	200	30	30-40	40	75	120	180
39	574.0	552.40	180	200	200	30	30-40	40	75	120	180
40	588.0	566.54	180	200	200	30	30-40	40	75	120	180

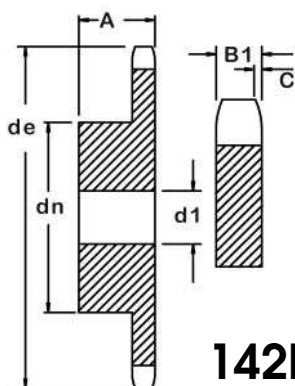

**142B**

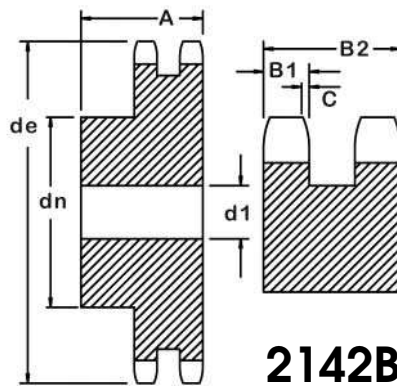

**2142B**

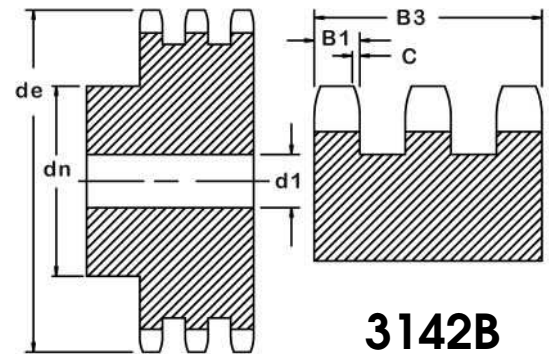

**3142B**

# All Metric Steel Sprockets

## DIN 8187/ ISO R 606

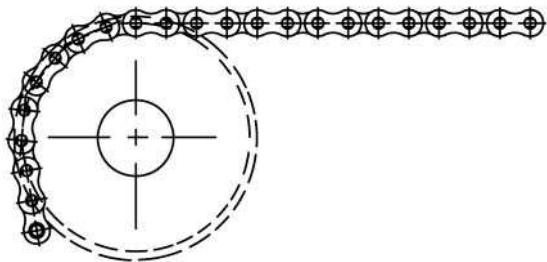

### NO. 162 TYPE A

CHAIN WIDTH:	2 x 1-1/4
PITCH:	50.8 mm
ROLLER WIDTH:	30.99 mm
ROLLER DIA.:	29.21 mm
SPKT. WIDTH:	
SINGLE B1	28 mm
DOUBLE B2	86.5 mm
TRIPLE B3	145 mm

All dimensions in mm (to international metric norms)

Teeth Z	Outside Dia. de	Pitch Dia. dp	Min. Bore d1 ±1 mm		
			162	2162	3162
8	152	132.74	25	25	25
9	168	148.52	25	25	25
10	184	164.39	25	25	25
11	200	180.31	30	30-35	30-35
12	216	196.28	30	30-35	30-35
13	235	212.27	30	30-35	30-35
14	251	228.30	30	30-35	30-35
15	267	244.33	30	30-35	30-35
16	283	260.39	30	30-40	30-40
17	299	276.46	30	30-40	30-40
18	315	292.55	30	30-40	30-40
19	331	308.64	30	30-40	30-40
20	347	324.74	30-40	30-40	30-40
21	363	340.84	30-40	30-40	40
22	379	356.96	30-40	30-40	40
23	396	373.08	30-40	30-40	40
24	412	389.19	30-40	30-40	40
25	428	405.32	30-40	30-40	40
26	444	421.45	30-40	30-40	40
27	460	437.58	30-40	30-40	40
28	476	453.72	30-40	30-40	40
29	492	469.90	30-40	30-40	40
30	508	485.99	30-40	30-40	40
35	589	566.71	30-40	30-40	40
38	638	615.16	30-40	30-40	40
40	670	647.47	40	40	40
45	750	728.24	40	40	40
50	831	809.04	40	40	40
57	944	922.16	40	40	40
60	993	970.65	40	40	40
76	1252	1229.28	40	40	40

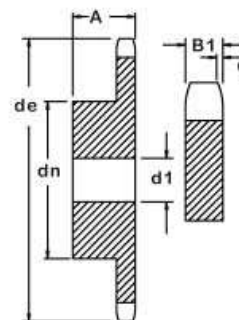

### 162A

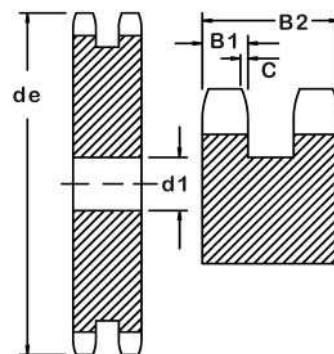

### 2162A

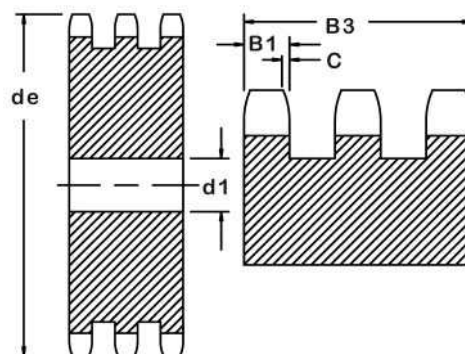

### 3162A

Special Sprockets Quoted Upon Request.



# All Metric Steel Sprockets

## DIN 8187/ ISO R 606

### NO. 162 TYPE B

CHAIN WIDTH:	2 x 1-1/4
PITCH:	50.8 mm
ROLLER WIDTH:	30.99 mm
ROLLER DIA.:	29.21 mm
SPKT. WIDTH:	
SINGLE B1	28 mm
DOUBLE B2	86.5 mm
TRIPLE B3	145 mm

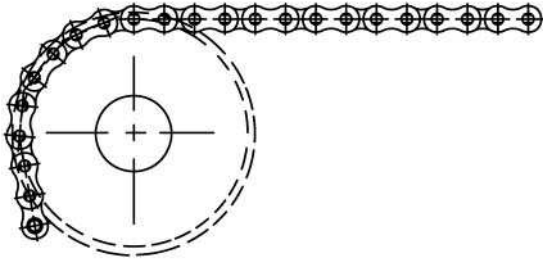

All dimensions in mm (to international metric norms)

Teeth Z	Outside Dia. de	Pitch Dia. dp	Hub Diameter dn			Min. Bore d1 ±1 mm			Total Width A		
			162	2162	3162	162	2162	3162	162	2162	3162
8	152	132.74	82-85	82-85	82-85	25-30	30	30	80	120	180
9	168	148.52	88-100	88-100	88-100	25-30	30	30	80	120	180
10	184	164.39	104-115	104-115	104-115	25-30	30	30	80	120	180
11	200	180.31	120-125	120-125	120-125	30	30-35	30-35	80	120	180
12	216	196.28	133	133	133	30	30-35	30-35	80	120	180
13	235	212.27	145	145	145	30	30-35	30-35	80	120	180
14	251	228.30	145-155	145-155	145-155	30	30-35	30-35	80	120	180
15	267	244.33	145-160	145-160	160	30	30-35	30-35	80	120	180
16	283	260.39	160	160	160	30	30-40	30-40	90	120	180
17	299	276.46	160-170	180	180-200	30	30-40	30-40	90	120	180
18	315	292.55	160-170	180	180-200	30	30-40	30-40	90	120	180
19	331	308.64	160-170	200	200	30	30-40	30-40	90	120	180
20	347	324.74	180	200	200	30-40	30-40	30-40	90	120	180
21	363	340.84	180	200	200	30-40	30-40	40	90	120	180
22	379	356.96	180	200	200	30-40	30-40	40	90	120	180
23	396	373.08	180	200	200	30-40	30-40	40	90	120	180
24	412	389.19	180	200	200	30-40	30-40	40	90	120	180
25	428	405.32	180	200	200	30-40	30-40	40	90	120	180
26	444	421.45	180	200	200	30-40	30-40	40	90	120	180
27	460	437.58	180	200	200	30-40	30-40	40	90	120	180
28	476	453.72	180	200	200	30-40	30-40	40	90	120	180
29	492	469.90	180	200	200	30-40	30-40	40	90	120	180
30	508	485.99	180	200	200	30-40	30-40	40	90	120	180
32	541	518.27	180-200								
35	589	566.71	180-200								
38	638	615.16	180-200								
40	670	647.47	180-200								

Special Sprockets Quoted Upon Request.

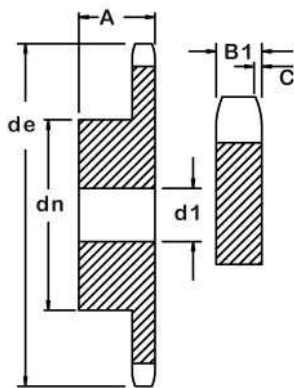

**162B**

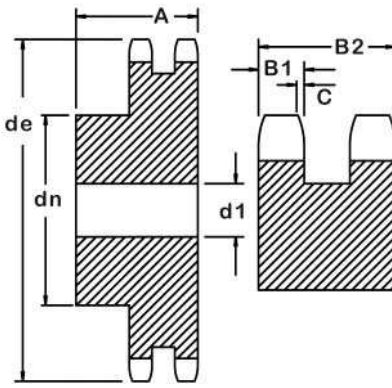

**2162B**

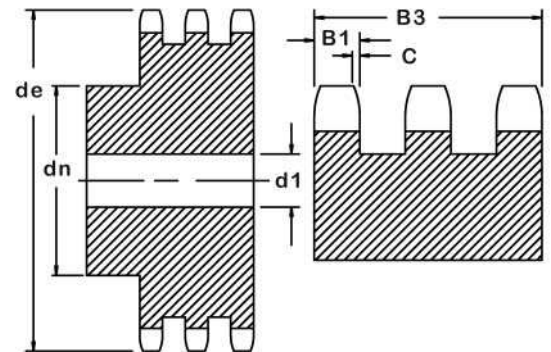

**3162B**