

# ANSI (Inch) Taper-Bushing V-Belt Sheaves A-A/B-C-D Cast Iron Sheaves

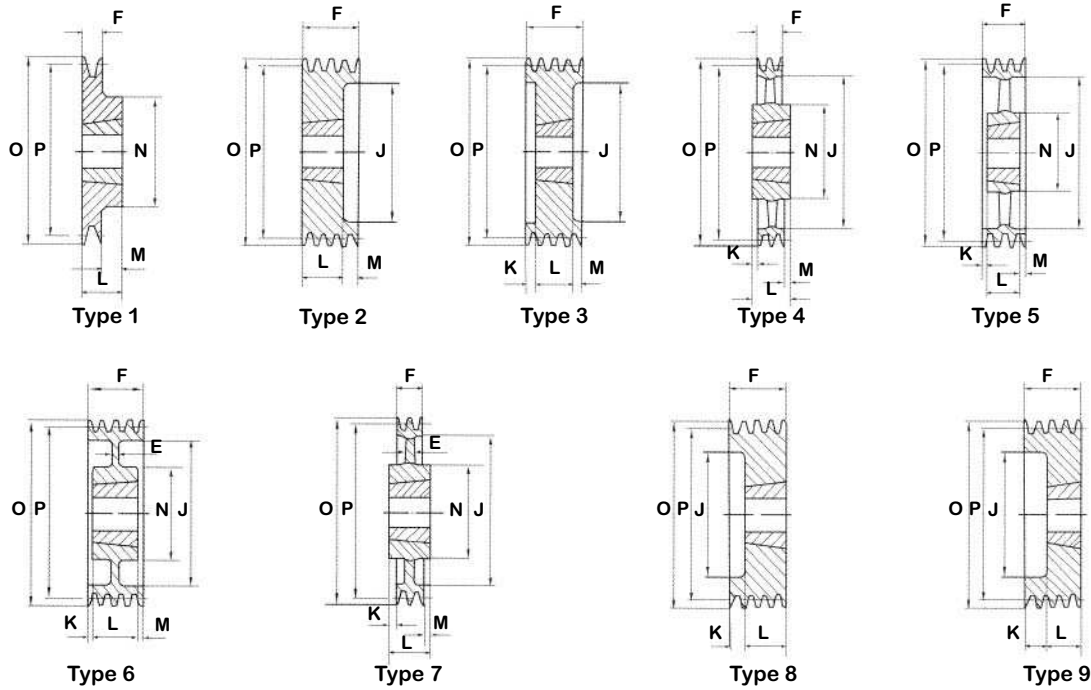

## A-1

Part No.	Grooves	P.D	O.D.	Type	Bush	Max Bore	E	F	J	K	L	M	N
1A32.1108	1	3.00	3.17	1	1108	1 1/8	-	3/4	-	-	7/8	1/16	2 1/2
1A34.1210	1	3.20	3.37	1	1210	1 1/4	-	3/4	-	-	1	3/16	2 15/16
1A35.1210	1	3.30	3.56	1	1210	1 1/4	-	3/4	-	-	1	3/16	2 15/16
1A39.1210	1	3.50	3.76	1	1210	1 1/4	-	3/4	-	-	1	3/16	2 15/16
1A41.1210	1	3.70	3.96	1	1210	1 1/4	-	3/4	-	-	1	3/16	2 15/16
1A44.1610	1	4.00	4.15	1	1610	1 5/8	-	3/4	-	-	1	3/16	3 1/8
1A46.1610	1	4.20	4.39	1	1610	1 5/8	-	3/4	-	-	1	3/16	3 1/8
1A49.1610	1	4.50	4.63	1	1610	1 5/8	-	3/4	-	-	1	3/16	3 1/8
1A51.1610	1	4.70	4.86	1	1610	1 5/8	-	3/4	-	-	1	3/16	3 1/8
1A54.1610	1	4.92	5.14	1	1610	1 5/8	-	3/4	-	-	1	3/16	3 1/8
1A56.1610	1	5.00	5.41	1	1610	1 5/8	-	3/4	-	-	1	3/16	3 1/8
1A59.1610	1	5.20	5.73	1	1610	1 5/8	-	3/4	-	-	1	3/16	3 1/8
1A64.1610	1	5.50	6.12	1	1610	1 5/8	-	3/4	-	-	1	3/16	3 1/8
1A66.1610	1	6.00	6.52	1	1610	1 5/8	-	3/4	-	-	1	3/16	3 1/8
1A71.1610	1	6.20	6.91	1	1610	1 5/8	-	3/4	-	-	1	3/16	3 1/8
1A74.1610	1	7.00	7.30	1	1610	1 5/8	-	3/4	-	-	1	3/16	3 1/8
1A79.1610	1	7.50	7.70	1	1610	1 5/8	-	3/4	-	-	1	3/16	3 1/8
1A84.2012	1	8.00	8.09	7	2012	2	3/8	3/4	6 1/2	-	1 1/4	1/2	3 15/16
1A94.2012	1	9.00	9.04	7	2012	2	3/8	3/4	7 7/16	-	1 1/4	1/2	3 15/16
1A104.2012	1	10.00	10.06	7	2012	2	3/8	3/4	8 7/16	1/4	1 1/4	1/4	3 15/16
1A114.2012	1	11.00	11.24	7	2012	2	3/8	3/4	9 5/8	-	1 1/4	1/2	3 15/16
1A128.2012	1	12.40	12.62	4	2012	2	-	3/4	11	-	1 1/4	1/2	3 15/16
1A144.2012	1	14.00	14.19	4	2012	2	-	3/4	12 5/8	-	1 1/4	1/2	3 15/16
1A160.2012	1	15.80	15.96	4	2012	2	-	3/4	14 3/8	-	1 1/4	1/2	3 15/16
1A184.2012	1	18.00	17.93	4	2012	2	-	3/4	16 5/16	-	1 1/4	1/2	3 15/16
1A201.2012	1	19.70	19.90	4	2517	2 3/8	-	3/4	18 5/16	-	1 3/4	1	4 3/4

Note: Pulleys prepared for bushings type 2517 and 3535 use ANSI Taper-Lock® Bushings with 1/2" x 13tpi UNC threads.

# ANSI (Inch) Taper-Bushing V-Belt Sheaves A-A/B-C-D Cast Iron Sheaves

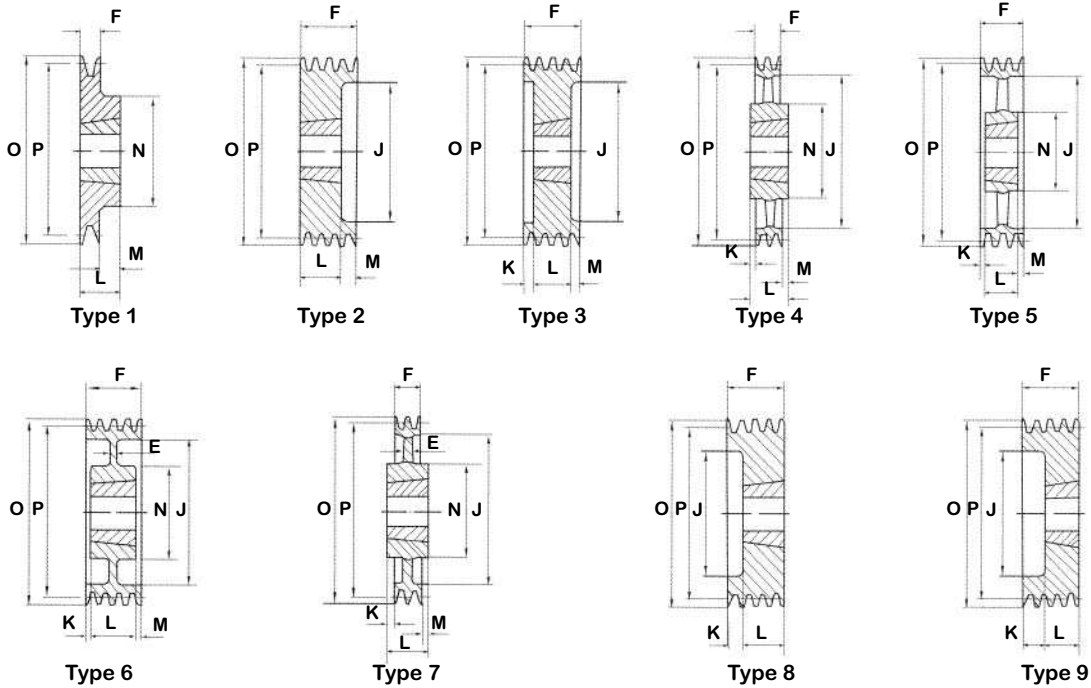

## A-2

Part No.	Grooves	P.D	O.D.	Type	Bush	Max Bore	E	F	J	K	L	M	N
2A27.1108	2	2.50	2.70	9	1108	1 1/8	1 1/8	2 3/16	1 7/16	1 5/16	7/8	-	-
2A28.1108	2	2.60	2.85	8	1108	1 1/8	1 1/8	1 3/8	1 1/2	1/2	7/8	-	-
2A30.1108	2	2.80	3.01	8	1108	1 1/8	1 1/8	1 3/8	1 9/16	1/2	7/8	-	-
2A32.1210	2	3.00	3.17	8	1108	1 1/8	1 1/8	1 3/8	1 3/4	3/8	1	-	-
2A34.1210	2	3.20	3.37	8	1210	1 2/8	1 1/4	1 3/8	1 7/8	3/8	1	-	-
2A35.1210	2	3.30	3.56	8	1210	1 2/8	1 1/4	1 3/8	1 15/16	3/8	1	-	-
2A39.1610	2	3.50	3.76	8	1610	1 5/8	1 5/8	1 3/8	2 3/8	3/8	1	-	-
2A41.1610	2	3.70	3.96	8	1610	1 5/8	1 5/8	1 3/8	2 1/2	3/8	1	-	-
2A44.1610	2	4.00	4.15	8	1610	1 5/8	1 5/8	1 3/8	2 3/4	3/8	1	-	-
2A46.1610	2	4.20	4.55	8	1610	1 5/8	1 5/8	1 3/8	3	3/8	1	-	-
2A49.1610	2	4.50	4.63	8	1610	1 5/8	1 5/8	1 3/8	3 1/8	3/8	1	-	-
2A51.1610	2	4.70	4.86	8	1610	1 5/8	1 5/8	1 3/8	3 3/8	3/8	1	-	-
2A54.1610	2	5.00	5.14	8	1610	1 5/8	1 5/8	1 3/8	3 9/16	3/8	1	-	-
2A56.2012	2	5.20	5.41	8	2012	2	1 15/16	1 3/8	3 7/8	1/8	1 1/4	-	-
2A59.2012	2	5.50	5.73	8	2012	2	1 15/16	1 3/8	4 3/16	1/8	1 1/4	-	-
2A64.2012	2	6.00	6.12	8	2012	2	1 15/16	1 3/8	4 9/16	1/8	1 1/4	-	-
2A66.2012	2	6.20	6.52	8	2012	2	1 15/16	1 3/8	4 15/16	1/8	1 1/4	-	-
2A71.2012	2	6.70	6.91	8	2012	2	1 15/16	1 3/8	5 5/16	1/8	1 1/4	-	-
2A74.2012	2	7.00	7.30	6	2012	2	1 15/16	1 3/8	5 13/16	1/16	1 1/4	1/16	3 15/16
2A79.2012	2	7.50	7.70	6	2012	2	1 15/16	1 3/8	6 1/4	1/16	1 1/4	1/16	3 15/16
2A224.3020	2	22.00	22.26	4	3020	3	2 15/16	1 3/8	20 11/16	-	2	5/8	5 7/8
2A254.3020	2	25.00	25.02	4	3020	3	2 15/16	1 3/8	20 11/16	-	2	5/8	5 7/8

Note: Pulleys prepared for bushings type 2517 and 3535 use ANSI Taper-Lock® Bushings with 1/2" x 13tpi UNC threads.

# ANSI (Inch) Taper-Bushing V-Belt Sheaves

## A-A/B-C-D Cast Iron Sheaves

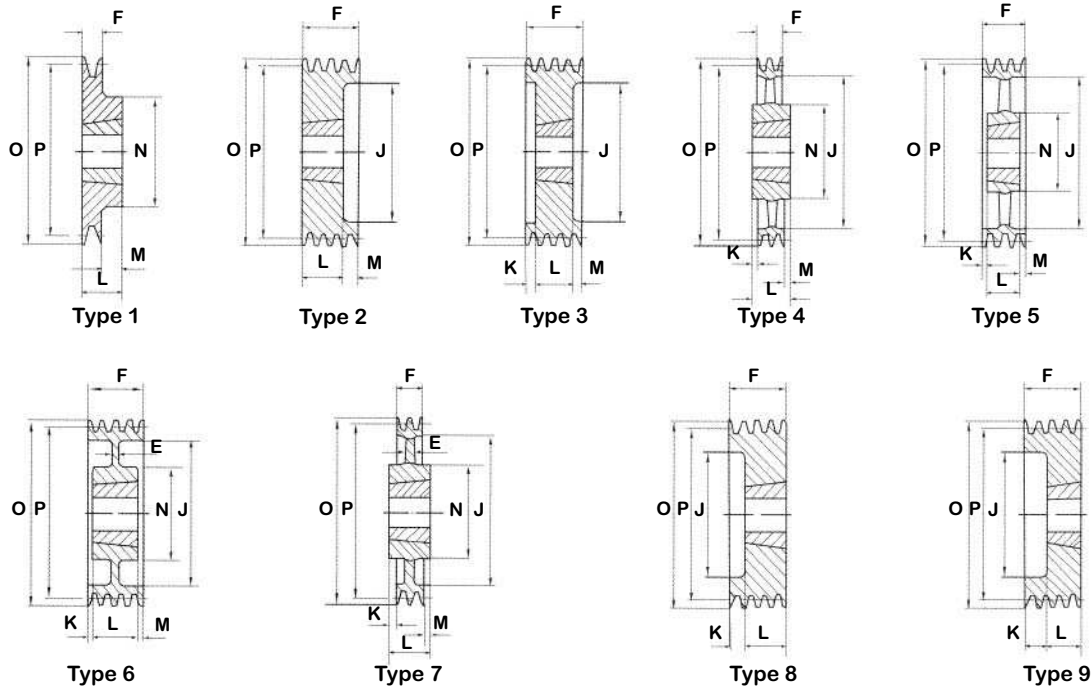

### A-3

Part No.	Grooves	P.D	O.D.	Type	Bush	Max Bore	E	F	J	K	L	M	N
3A30.1108	3	2.80	3.17	8	1108	1 1/4	-	1 15/16	1 9/16	1 1/8	7/8	-	-
3A32.1210	3	3.00	3.37	8	1210	1 1/4	-	1 15/16	1 3/4	1	1	-	-
3A34.1210	3	3.20	3.56	8	1210	1 1/4	-	1 15/16	1 7/8	1	1	-	-
3A35.1210	3	3.30	3.76	8	1210	1 1/4	-	1 15/16	1 15/16	1	1	-	-
3A39.1610	3	3.50	3.96	8	1610	1 5/8	-	1 15/16	2 3/8	1	1	-	-
3A41.1610	3	3.70	4.15	8	1610	1 5/8	-	1 15/16	2 1/2	1	1	-	-
3A44.1610	3	4.00	4.39	2	1610	1 5/8	-	1 15/16	2 3/4	-	1	1	-
3A46.1610	3	4.20	4.63	2	1610	1 15/16	-	1 15/16	3	-	1	1	-
3A49.2012	3	4.50	4.86	8	2012	1 15/16	-	1 15/16	3 1/4	11/16	1 1/4	-	-
3A51.2012	3	4.70	5.14	2	2012	1 15/16	-	1 15/16	3 3/8	-	1 1/4	11/16	-
3A54.2012	3	5.00	5.41	2	2012	1 15/16	-	1 15/16	3 5/8	-	1 1/4	11/16	-
3A56.2012	3	5.20	5.73	2	2012	1 15/16	-	1 15/16	3 7/8	-	1 1/4	11/16	-
3A128.3020	3	12.40	6.12	7	3020	2 15/16	1	1 15/16	11	-	2	-	5 7/8
3A144.3020	3	14.00	6.52	4	3020	2 15/16	-	1 15/16	12 5/8	-	2	-	6 5/16
3A160.3020	3	15.80	6.91	4	3020	2 15/16	-	1 15/16	14 3/8	-	2	-	5 7/8
3A201.3020	3	19.70	7.30	4	3020	2 15/16	-	1 15/16	18 5/16	-	2	-	5 7/8
3A254.3020	3	25.00	7.70	4	3020	2 15/16	-	1 15/16	23 7/16	-	2	-	5 7/8

Note: Pulleys prepared for bushings type 2517 and 3535 use ANSI Taper-Lock® Bushings with 1/2" x 13tpi UNC threads.

# ANSI (Inch) Taper-Bushing V-Belt Sheaves A-A/B-C-D Cast Iron Sheaves

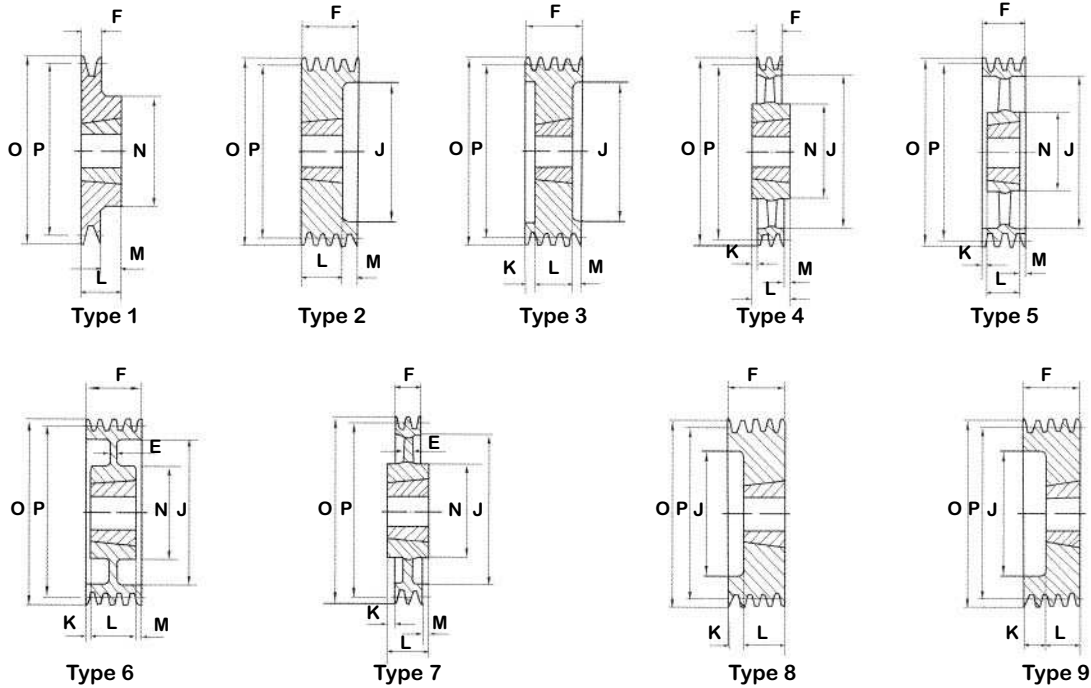

## A-4

Part No.	Grooves	P.D	O.D.	Type	Bush	Max Bore	E	F	J	K	L	M	N
4A39.1610	4	3.50	3.76	3	1615	1 5/8	-	2 9/16	2 1/2	9/16	1 1/2	9/16	-
4A41.1615	4	3.70	3.96	3	1615	1 5/8	-	2 9/16	2 1/2	9/16	1 1/2	9/16	-
4A44.1615	4	4.00	4.15	2	1615	1 5/8	-	2 9/16	2 3/4	-	1 1/2	1 1/16	-
4A46.1615	4	4.20	4.39	8	2012	1 15/16	-	2 9/16	3	1 5/16	1 1/4	-	-
4A49.2012	4	4.50	4.63	8	2012	1 15/16	-	2 9/16	3 1/8	1 5/16	1 1/4	-	-
4A51.2012	4	4.70	4.86	2	2012	1 15/16	-	2 9/16	3 3/8	-	1 1/4	1 5/16	-
4A54.2012	4	5.00	5.14	2	2012	1 15/16	-	2 9/16	3 5/8	-	1 1/4	1 5/16	-
4A79.3020	4	7.50	7.70	2	2517	2 3/8	-	2 9/16	6 1/4	-	1 3/4	13/16	-
4A84.3020	4	8.00	8.09	2	3020	2 15/16	-	2 9/16	6 1/2	-	2	9/16	-
4A104.3020	4	10.00	10.06	6	3020	2 15/16	3/8	2 9/16	8 7/16	1 1/4	2	1/4	5 7/8
4A114.3020	4	11.00	11.24	6	3020	2 15/16	3/8	2 9/16	9 5/8	1 1/4	2	1/4	5 7/8
4A128.3020	4	12.40	12.62	6	3020	2 15/16	3/8	2 9/16	11	1 1/4	2	1/4	5 7/8
4A144.3020	4	14.00	14.19	5	3020	2 15/16	-	2 9/16	12 5/8	1 1/4	2	1/4	5 7/8
4A160.3020	4	15.80	15.96	5	3020	2 15/16	-	2 9/16	14 3/8	1 1/4	2	1/4	5 7/8
4A184.3020	4	18.00	17.93	5	3020	2 15/16	-	2 9/16	16 5/16	1 1/4	2	1/4	5 7/8
4A201.3020	4	19.70	19.90	5	3020	2 15/16	-	2 9/16	18 5/16	1 1/4	2	1/4	5 7/8

Note: Pulleys prepared for bushings type 2517 and 3535 use ANSI Taper-Lock® Bushings with 1/2" x 13tpi UNC threads.

# ANSI (Inch) Taper-Bushing V-Belt Sheaves A-A/B-C-D Cast Iron Sheaves

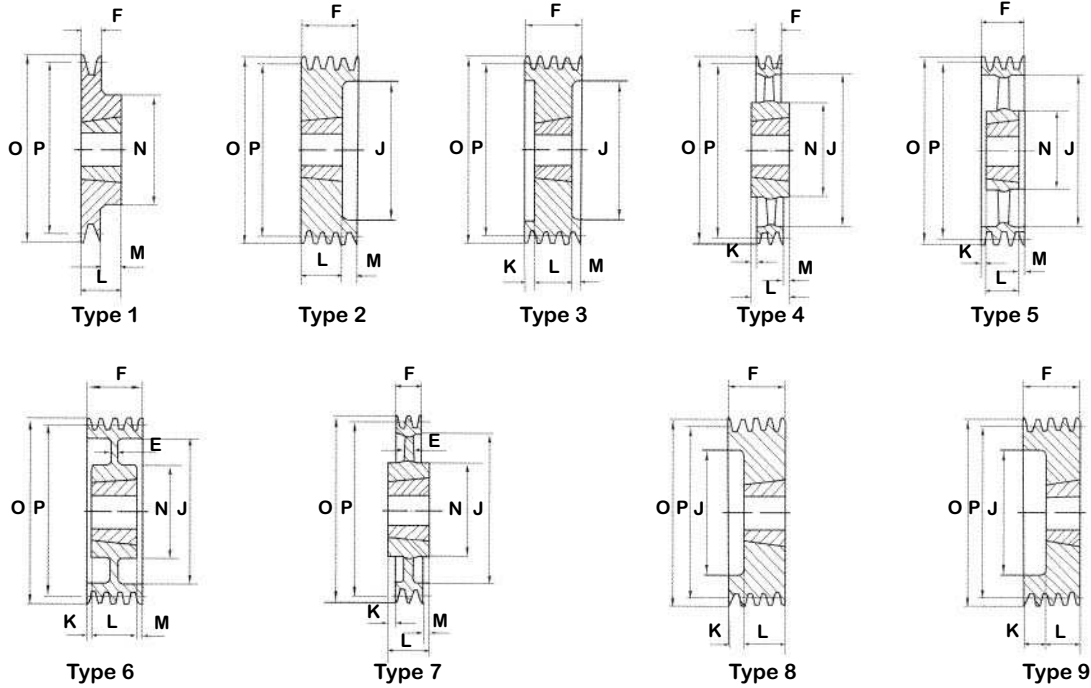

## A-5

Part No.	Grooves	P.D	O.D.	Type	Bush	Max Bore	E	F	J	K	L	M	N
5A44.1610	5	4.00	4.15	2	1615	1 1/8	-	3 1/8	2 3/4	-	1 1/2	-	-
5A46.1610	5	4.20	4.39	8	2012	1 1/8	-	3 1/8	3	1 7/8	1 1/4	-	-
5A49.2012	5	4.50	4.63	8	2012	1 1/8	-	3 1/8	3 1/8	1 7/8	1 1/4	-	-
5A51.2012	5	4.70	4.86	2	2012	1 1/8	-	3 1/8	3 3/8	-	1 1/4	-	-
5A54.2012	5	5.00	5.14	3	2012	1 2/8	-	3 1/8	3 5/8	15/16	1 1/4	-	-
5A74.3020	5	7.00	7.30	3	3020	1 5/8	-	3 1/8	5 3/4	9/16	2	-	-
5A84.3020	5	8.00	8.09	3	3020	1 5/8	-	3 1/8	6 1/2	9/16	2	-	-
5A94.3020	5	9.00	9.04	2	3020	1 5/8	-	3 1/8	7 7/16	-	2	-	-
5A104.3020	5	10.00	10.06	6	3020	1 5/8	3/8	3 1/8	8 7/16	9/16	2	-	5 7/8

Note: Pulleys prepared for bushings type 2517 and 3535 use ANSI Taper-Lock® Bushings with 1/2" x 13tpi UNC threads.

## A-6

Part No.	Grooves	P.D	O.D.	Type	Bush	Max Bore	E	F	J	K	L	M	N
6A44.1615	6	4.00	4.15	3	1615	1 5/8	-	3 3/4	2 3/4	1 1/8	1 1/2	1 1/8	-
6A46.2012	6	4.20	4.39	8	2012	1 15/16	-	3 3/4	3	2 1/2	1 1/4	-	-
6A49.2012	6	4.50	4.63	8	2012	1 15/16	-	3 3/4	3 1/8	2 1/2	1 1/4	-	-
6A51.2012	6	4.70	4.86	8	2012	1 15/16	-	3 3/4	3 3/8	2 1/2	1 3/8	-	-
6A54.2012	6	5.00	5.14	3	2012	1 15/16	-	3 3/4	3 5/8	1 1/4	1 1/4	1 1/4	-
6A74.3020	6	7.00	7.30	3	3020	2 15/16	-	3 3/4	5 3/4	7/8	2	7/8	-
6A84.3020	6	8.00	8.09	3	3020	2 15/16	-	3 3/4	6 1/2	7/8	2	7/8	-
6A94.3020	6	9.00	9.04	3	3020	2 15/16	13/16	3 3/4	7 7/16	7/8	2	7/8	-
6A104.3020	6	10.00	10.06	6	3020	2 15/16	1	3 3/4	8 7/16	7/8	2	7/8	5 7/8
6A254.4040	6	25.00	25.02	4	4040	3 15/16	-	3 3/4	23 7/16	1/8	4	1/8	8 1/2

Note: Pulleys prepared for bushings type 2517 and 3535 use ANSI Taper-Lock® Bushings with 1/2" x 13tpi UNC threads.

# ANSI (Inch) Taper-Bushing V-Belt Sheaves

## A-A/B-C-D Cast Iron Sheaves

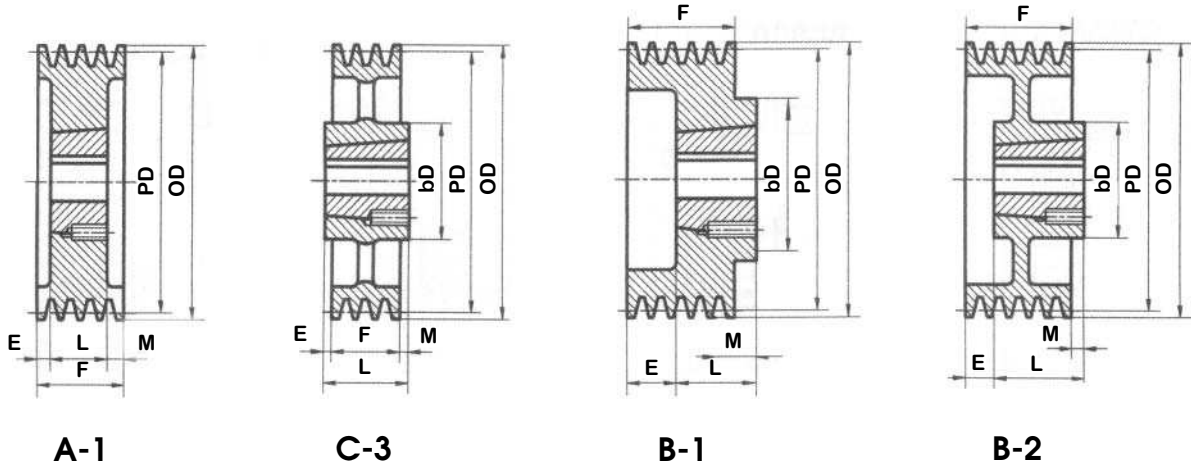

### A/B-1

F = 1"

Part No.	PD		OD	Bush	Type	Bush Max. Bore	E	bD	L	M	Wt Less Bush
	A Belt	B Belt									
1B34TL.1210	3.00	3.40	3.75	1210	A1	1 1/4	-	-	1	-	2.2
1B36TL.1210	3.20	3.60	3.95	1210	A1	1 1/4	-	-	1	-	2.6
1B38TL.1610	3.40	3.80	4.15	1610	A1	1 5/8	-	-	1	-	2.8
1B40TL.1610	3.60	4.00	4.35	1610	A1	1 5/8	-	-	1	-	3.0
1B42TL.1610	3.80	4.20	4.55	1610	A1	1 5/8	-	-	1	-	3.5
1B44TL.1610	4.00	4.40	4.75	1610	A1	1 5/8	-	-	1	-	3.8
1B46TL.1610	4.20	4.60	4.95	1610	A1	1 5/8	-	-	1	-	4.0
1B48TL.1610	4.40	4.80	5.15	1610	A1	1 5/8	-	-	1	-	4.5
1B50TL.1610	4.60	5.00	5.35	1610	A1	1 5/8	-	-	1	-	4.8
1B52TL.1610	4.80	5.20	5.55	1610	A1	1 5/8	-	-	1	-	5.0
1B54TL.1610	5.00	5.40	5.75	1610	A1	1 5/8	-	-	1	-	5.5
1B56TL.1610	5.20	5.60	5.95	1610	A1	1 5/8	-	-	1	-	6.0
1B58TL.1610	5.40	5.80	6.15	1610	A1	1 5/8	-	-	1	-	6.3
1B60TL.1610	5.60	6.00	6.35	1610	A1	1 5/8	-	-	1	-	6.7
1B62TL.1610	5.80	6.20	6.55	1610	A1	1 5/8	-	-	1	-	7.0
1B64TL.1610	6.00	6.40	6.75	1610	A1	1 5/8	-	-	1	-	8.0
1B66TL.1610	6.20	6.60	6.95	1610	A1	1 5/8	-	-	1	-	8.5
1B68TL.1610	6.40	6.80	7.15	1610	A1	1 5/8	-	-	1	-	9.0
1B74TL.2517ANSI	7.00	7.40	7.75	2517	B1	2 1/2	-	4 3/4	1 3/4	3/4	9.4
1B86TL.2517ANSI	8.20	8.60	8.95	2517	B2	2 1/2	-	4 3/4	1 3/4	3/4	12.0
1B94TL.2517ANSI	9.00	9.40	9.75	2517	B2	2 1/2	-	4 3/4	1 3/4	3/4	14.0
1B110TL.2517ANSI	10.60	11.00	11.35	2517	B2	2 1/2	-	4 3/4	1 3/4	3/4	18.0
1B124TL.2517ANSI	12.00	12.40	12.75	2517	C3	2 1/2	1/4	4 3/4	1 3/4	1/2	18.5
1B154TL.2517ANSI	15.00	15.40	15.75	2517	C3	2 1/2	1/4	4 3/4	1 3/4	1/2	19.0
1B184TL.2517ANSI	18.00	18.40	18.75	2517	C3	2 1/2	3/16	4 3/4	1 3/4	7/16	24.0

Note: Pulleys prepared for bushings type 2517 and 3535 use ANSI Taper-Lock® Bushings with 1/2" x 13tpi UNC threads.

### Bushing Standard Bore

Bushing	Bore Range	
	Min	Max
1210	1/2	1 1/4
1610, 1615	1/2	1 5/8
2517	1/2	2 1/2
3020, 3030	7/8	3

### Standard Keyseats

Bore Range	Keyseat	Bore Range	Keyseat
1/2 - 9/16	1/8 x 1/16	1 7/16 - 1 3/4	3/8 x 3/16
5/8 - 7/8	3/16 x 3/32	1 13/16 - 2 1/4	1/2 x 1/4
15/16 - 1 1/4	1/4 x 1/8	2 5/16 - 2 3/4	5/8 x 5/16
15/16 - 1 3/8	5/16 x 5/32	2 13/16 - 3 1/4	3/4 x 3/8

# ANSI (Inch) Taper-Bushing V-Belt Sheaves

## A-A/B-C-D Cast Iron Sheaves

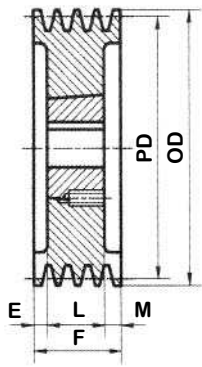

A-1

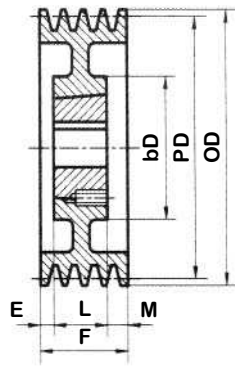

A-2

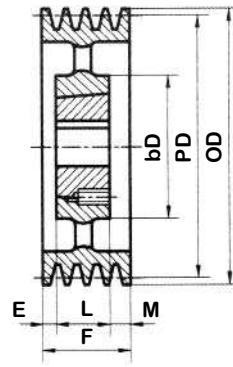

A-3

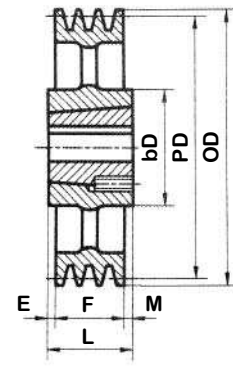

C-3

### A/B-2

F = 1 3/4"

Part No.	PD		OD	Bush	Type	Bush Max. Bore	E	bD	L	M	Wt Less Bush
	A Belt	B Belt									
2B34TL.1210	3.00	3.40	3.75	1210	A1	1 1/4	3/4	-	1	-	2.2
2B36TL.1210	3.20	3.60	3.95	1210	A1	1 1/4	3/4	-	1	-	2.6
2B38TL.1610	3.40	3.80	4.15	1610	A1	1 5/8	3/4	-	1	-	2.8
2B40TL.1610	3.60	4.00	4.35	1610	A1	1 5/8	3/4	-	1	-	3.0
2B42TL.1610	3.80	4.20	4.55	1610	A1	1 5/8	3/4	-	1	-	4.0
2B44TL.1610	4.00	4.40	4.75	1610	A1	1 5/8	3/4	-	1	-	4.5
2B46TL.1610	4.20	4.60	4.95	1610	A1	1 5/8	3/4	-	1	-	5.0
2B48TL.1610	4.40	4.80	5.15	1610	A1	1 5/8	3/4	-	1	-	5.5
2B50TL.1610	4.60	5.00	5.35	1610	A1	1 5/8	3/4	-	1	-	6.0
2B52TL.1610	4.80	5.20	5.55	1610	A1	1 5/8	3/4	-	1	-	6.5
2B54TL.1610	5.00	5.40	5.75	1610	A1	1 5/8	3/4	-	1	-	7.0
2B56TL.1610	5.20	5.60	5.95	1610	A1	1 5/8	3/4	-	1	-	8.2
2B58TL.1610	5.40	5.80	6.15	1610	A1	1 5/8	3/4	-	1	-	8.6
2B60TL.1610	5.60	6.00	6.35	1610	A1	1 5/8	3/4	-	1	-	8.8
2B62TL.1610	5.80	6.20	6.55	1610	A1	1 5/8	3/4	-	1	-	9.0
2B64TL.1610	6.00	6.40	6.75	1610	A1	1 5/8	3/4	-	1	-	10.0
2B66TL.1610	6.20	6.60	6.95	1610	A1	1 5/8	3/4	-	1	-	10.5
2B68TL.1610	6.40	6.80	7.15	1610	A1	1 5/8	3/4	-	1	-	11.0
2B74TL.2517ANSI	7.00	7.40	7.75	2517	A1	2 1/2	-	-	1 3/4	-	16.0
2B86TL.2517ANSI	8.20	8.60	8.95	2517	A2	2 1/2	-	4 3/4	1 3/4	-	18.0
2B94TL.2517ANSI	9.00	9.40	9.75	2517	A2	2 1/2	-	4 3/4	1 3/4	-	20.0
2B110TL.2517ANSI	10.60	11.00	11.35	2517	A2	2 1/2	-	4 3/4	1 3/4	-	25.0
2B124TL.2517ANSI	12.00	12.40	12.75	2517	A3	2 1/2	-	4 3/4	1 3/4	-	27.0
2B154TL.2517ANSI	15.00	15.40	15.75	2517	A3	2 1/2	-	4 3/4	1 3/4	-	31.0
2B184TL.2517ANSI	18.00	18.40	18.75	2517	A3	2 1/2	-	4 3/4	1 3/4	-	33.0
2B200TL.3020	19.60	20.00	20.35	3020	C3	3	-	5 11/16	2	1/4	49.0
2B250TL.3030	24.60	25.00	25.35	3020	C3	3	-	5 11/16	2	1/4	65.0
2B300TL.3020	29.60	30.35	30.35	3020	C3	3	-	5 11/16	2	1/4	75.0
2B380TL.3020	37.60	38.00	38.35	3020	C3	3	-	5 11/16	2	1/4	112

Note: Pulleys prepared for bushings type 2517 and 3535 use ANSI Taper-Lock® Bushings with 1/2" x 13tpi UNC threads.

### Bushing Standard Bore

Bushing	Bore Range	
	Min	Max
1210	1/2	1 1/4
1610, 1615	1/2	1 5/8
2517	1/2	2 1/2
3020, 3030	7/8	3

### Standard Keyseats

Bore Range	Keyseat	Bore Range	Keyseat
1/2 - 9/16	1/8 x 1/16	1 7/16 - 1 3/4	3/8 x 3/16
5/8 - 7/8	3/16 x 3/32	1 13/16 - 2 1/4	1/2 x 1/4
15/16 - 1 1/4	1/4 x 1/8	2 5/16 - 2 3/4	5/8 x 5/16
15/16 - 1 3/8	5/16 x 5/32	2 13/16 - 3 1/4	3/4 x 3/8

# ANSI (Inch) Taper-Bushing V-Belt Sheaves

## A-A/B-C-D Cast Iron Sheaves

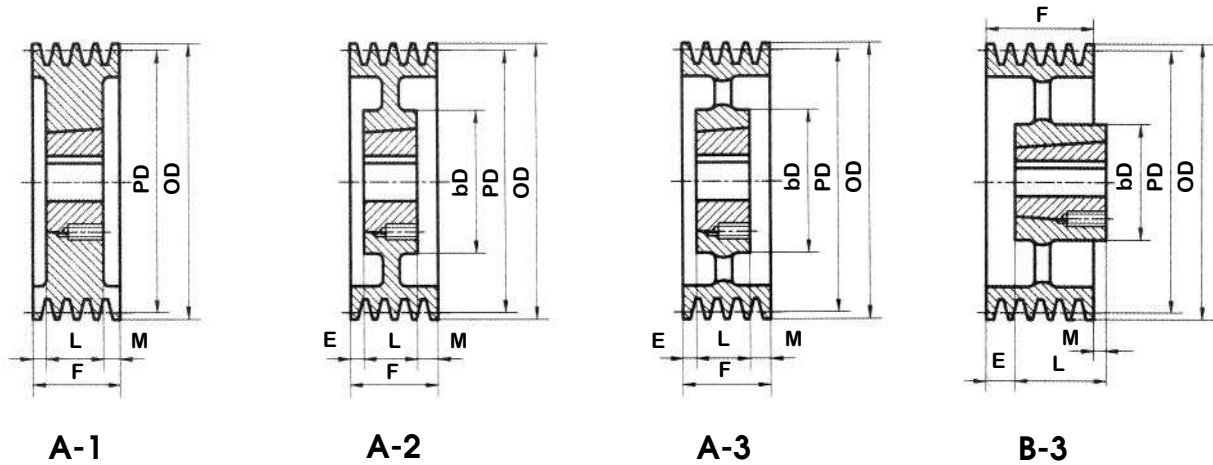

### A/B-3

F = 2 1/2"

Part No.	PD		OD	Bush	Type	Bush Max. Bore	E	bD	L	M	Wt Less Bush
	A Belt	B Belt									
3B34TL.1210	3.00	3.40	3.75	1210	A1	1 1/4	1 1/2	-	1	-	3.0
3B36TL.1210	3.20	3.60	3.95	1210	A1	1 1/4	1 1/2	-	1	-	3.5
3B38TL.1610	3.40	3.80	4.15	1610	A1	1 5/8	1 1/2	-	1	-	4.0
3B40TL.1610	3.60	4.00	4.35	1610	A1	1 5/8	1 1/2	-	1	-	5.0
3B42TL.1610	3.80	4.20	4.55	1610	A1	1 5/8	1 1/2	-	1	-	6.0
3B44TL.1610	4.00	4.40	4.75	1610	A1	1 5/8	1 1/2	-	1	-	6.5
3B46TL.1610	4.20	4.60	4.95	1610	A1	1 5/8	1 1/2	-	1	-	7.0
3B48TL.1610	4.40	4.80	5.15	1610	A1	1 5/8	1 1/2	-	1	-	8.0
3B50TL.1610	4.60	5.00	5.35	1610	A1	1 5/8	1 1/2	-	1	-	8.5
3B52TL.1610	4.80	5.20	5.55	1610	A1	1 5/8	1 1/2	-	1	-	9.0
3B54TL.2517ANSI	5.00	5.40	5.75	2517	A1	2 1/2	3/4	-	1 3/4	-	9.5
3B56TL.2517ANSI	5.20	5.60	5.95	2517	A1	2 1/2	3/4	-	1 3/4	-	10.0
3B58TL.2517ANSI	5.40	5.80	6.15	2517	A1	2 1/2	3/4	-	1 3/4	-	10.5
3B60TL.2517ANSI	5.60	6.00	6.35	2517	A1	2 1/2	3/4	-	1 3/4	-	11.0
3B62TL.2517ANSI	5.80	6.20	6.55	2517	A1	2 1/2	3/4	-	1 3/4	-	11.5
3B64TL.2517ANSI	6.00	6.40	6.75	2517	A1	2 1/2	3/4	-	1 3/4	-	12.0
3B66TL.2517ANSI	6.20	6.60	6.95	2517	A1	2 1/2	3/4	-	1 3/4	-	12.3
3B68TL.2517ANSI	6.40	6.80	7.15	2517	A1	2 1/2	3/4	-	1 3/4	-	12.8
3B74TL.2517ANSI	7.00	7.40	7.75	2517	A1	2 1/2	3/4	-	1 3/4	-	16.0
3B86TL.2517ANSI	8.20	8.60	8.95	2517	A2	2 1/2	3/4	4 3/4	1 3/4	-	19.0
3B94TL.2517ANSI	9.00	9.40	9.75	2517	A2	2 1/2	3/4	4 3/4	1 3/4	-	21.0
3B110TL.2517ANSI	10.60	11.00	11.35	2517	A2	2 1/2	3/4	4 3/4	1 3/4	-	24.0
3B124TL.2517ANSI	12.00	12.40	12.75	2517	A3	2 1/2	-	4 3/4	1 3/4	3/4	28.0
3B154TL.2517ANSI	15.00	15.40	15.75	2517	A3	2 1/2	-	4 3/4	1 3/4	3/4	30.0
3B184TL.2517ANSI	18.00	18.40	18.75	2517	A3	2 1/2	-	4 3/4	1 3/4	3/4	44.0
3B200TL.3535	19.60	20.00	20.35	3020	A3	3	-	5 11/16	2	1/2	58.0
3B250TL.3535	24.60	25.00	25.35	3020	A3	3	-	5 11/16	2	1/2	74.0
3B300TL.3020	29.60	30.00	30.35	3020	A3	3	-	5 11/16	2	1/2	84.0
3B380TL.3030	37.60	38.00	38.35	3030	B3	3	-	5 11/16	3	1/2	135

Note: Pulleys prepared for bushings type 2517 and 3535 use ANSI Taper-Lock® Bushings with 1/2" x 13tpi UNC threads.

### Bushing Standard Bore

Bushing	Bore Range	
	Min	Max
1210	1/2	1 1/4
1610, 1615	1/2	1 5/8
2517	1/2	2 1/2
3020, 3030	7/8	3

### Standard Keyseats

Bore Range	Keyseat	Bore Range	Keyseat
1/2 - 9/16	1/8 x 1/16	1 7/16 - 1 3/4	3/8 x 3/16
5/8 - 7/8	3/16 x 3/32	1 13/16 - 2 1/4	1/2 x 1/4
15/16 - 1 1/4	1/4 x 1/8	2 5/16 - 2 3/4	5/8 x 5/16
15/16 - 1 3/8	5/16 x 5/32	2 13/16 - 3 1/4	3/4 x 3/8



# ANSI (Inch) Taper-Bushing V-Belt Sheaves

## A-A/B-C-D Cast Iron Sheaves

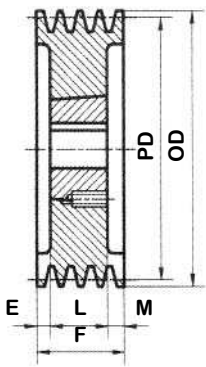

A-1

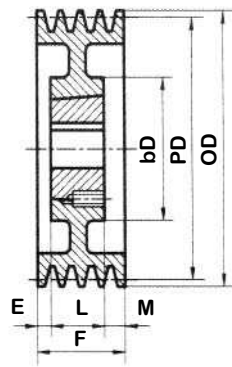

A-2

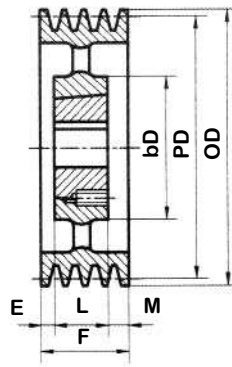

A-3

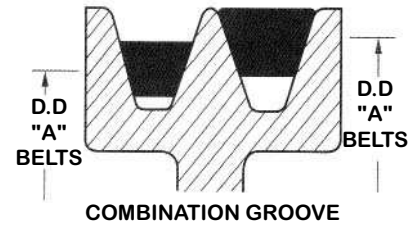

C-3

### A/B-4

F = 3 1/4"

Part No.	PD		OD	Bush	Type	Bush Max. Bore	E	bD	L	M	Wt Less Bush
	A Belt	B Belt									
4B34TL.1210	3.00	3.40	3.75	1210	A1	1 1/4	2 1/4	-	1	-	3.0
4B36TL.1210	3.20	3.60	3.95	1210	A1	1 1/4	2 1/4	-	1	-	3.5
4B38TL.1610	3.40	3.80	4.15	1610	A1	1 5/8	2 1/4	-	1	-	4.0
4B40TL.1610	3.60	4.00	4.35	1610	A1	1 5/8	2 1/4	-	1	-	5.5
4B42TL.1610	3.80	4.20	4.55	1610	A1	1 5/8	2 1/4	-	1	-	6.0
4B44TL.1610	4.00	4.40	4.75	1610	A1	1 5/8	2 1/4	-	1	-	7.0
4B46TL.1610	4.20	4.60	4.95	1610	A1	1 5/8	2 1/4	-	1	-	8.0
4B48TL.1610	4.40	4.80	5.15	1610	A1	1 5/8	2 1/4	-	1	-	8.5
4B50TL.2012	4.60	5.00	5.35	2517	A1	2 1/2	1 1/2	-	1 3/4	-	9.0
4B52TL.2012	4.80	5.20	5.55	2517	A1	2 1/2	1 1/2	-	1 3/4	-	9.5
4B54TL.2517ANSI	5.00	5.40	5.75	2517	A1	2 1/2	1 1/2	-	1 3/4	-	10.0
4B56TL.2517ANSI	5.20	5.60	5.95	2517	A1	2 1/2	1 1/2	-	1 3/4	-	12.0
4B58TL.2517ANSI	5.40	5.80	6.15	2517	A1	2 1/2	1 1/2	-	1 3/4	-	12.5
4B60TL.2517ANSI	5.60	6.00	6.35	2517	A1	2 1/2	1 1/2	-	1 3/4	-	13.0
4B62TL.2517ANSI	5.80	6.20	6.55	2517	A1	2 1/2	1 1/2	-	1 3/4	-	14.0
4B64TL.2517ANSI	6.00	6.40	6.75	2517	A1	2 1/2	1 1/2	-	1 3/4	-	15.0
4B66TL.2517ANSI	6.20	6.60	6.95	2517	A1	2 1/2	1 1/2	-	1 3/4	-	16.0
4B68TL.2517ANSI	6.40	6.80	7.15	2517	A1	2 1/2	1 1/2	-	1 3/4	-	20.0
4B74TL.2517ANSI	7.00	7.40	7.75	2517	A1	2 1/2	1 1/2	-	1 3/4	-	21.0
4B86TL.3020	8.20	8.60	8.95	2517	A2	2 1/2	1 1/2	4 3/4	1 3/4	-	23.0
4B94TL.3020	9.00	9.40	9.75	2517	A2	2 1/2	1 1/2	4 3/4	1 3/4	-	28.0
4B110TL.3020	10.60	11.00	11.35	2517	A2	2 1/2	1 1/2	4 3/4	1 3/4	-	34.0
4B124TL.2517ANSI	12.00	12.40	12.75	2517	A3	2 1/2	3/8	4 3/4	1 3/4	1 1/8	42.0
4B154TL.2517ANSI	15.00	15.40	15.75	2517	A3	2 1/2	3/8	4 3/4	1 3/4	1 1/8	53.0
4B184TL.2517ANSI	18.00	18.40	18.75	2517	A3	2 1/2	1/2	4 3/4	1 3/4	1	66.0
4B200TL.3020	19.60	20.00	20.35	3020	A3	3	1/2	5 11/16	2	3/4	80.0
4B250TL.4040	24.60	25.00	25.35	3030	A3	3	-	5 11/16	3	1/4	100
4B300TL.3020	29.60	30.00	30.35	3030	A3	3	-	5 11/16	3	1/4	142
4B380TL.3020	37.60	38.00	38.35	3030	A3	3	-	5 11/16	3	1/4	

Note: Pulleys prepared for bushings type 2517 and 3535 use ANSI Taper-Lock® Bushings with 1/2" x 13tpi UNC threads.

### Bushing Standard Bore

Bushing	Bore Range	
	Min	Max
1210	1/2	1 1/4
1610, 1615	1/2	1 5/8
2517	1/2	2 1/2
3020, 3030	7/8	3

### Standard Keyseats

Bore Range	Keyseat	Bore Range	Keyseat
1/2 - 9/16	1/8 x 1/16	1 7/16 - 1 3/4	3/8 x 3/16
5/8 - 7/8	3/16 x 3/32	1 13/16 - 2 1/4	1/2 x 1/4
15/16 - 1 1/4	1/4 x 1/8	2 5/16 - 2 3/4	5/8 x 5/16
15/16 - 1 3/8	5/16 x 5/32	2 13/16 - 3 1/4	3/4 x 3/8

# ANSI (Inch) Taper-Bushing V-Belt Sheaves

## A-A/B-C-D Cast Iron Sheaves

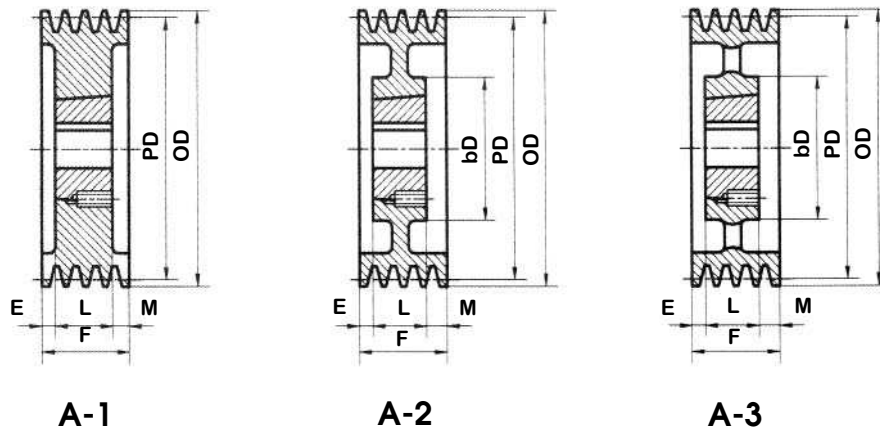

### A/B-5

F = 4"

Part No.	PD		OD	Bush	Type	Bush Max. Bore	E	bD	L	M	Wt Less Bush
	A Belt	B Belt									
5B34TL.1210	3.00	3.40	3.75	1210	A1	1 1/4	2 1/2	-	1 1/2	-	5.0
5B36TL.1210	3.20	3.60	3.95	1210	A1	1 1/4	2 1/2	-	1 1/2	-	5.5
5B38TL.1610	3.40	3.80	4.15	1610	A1	1 5/8	2 1/2	-	1 1/2	-	6.0
5B40TL.1610	3.60	4.00	4.35	1610	A1	1 5/8	2 1/2	-	1 1/2	-	6.5
5B42TL.1610	3.80	4.20	4.55	1610	A1	1 5/8	2 1/2	-	1 1/2	-	7.0
5B44TL.1610	4.00	4.40	4.75	1610	A1	1 5/8	2 1/2	-	1 1/2	-	8.0
5B46TL.1610	4.20	4.60	4.95	1610	A1	1 5/8	2 1/2	-	1 1/2	-	9.0
5B50TL.2012	4.60	5.00	5.35	2517	A1	2 1/2	2 1/4	-	1 3/4	-	10.5
5B52TL.2012	4.80	5.20	5.55	2517	A1	2 1/2	2 1/4	-	1 3/4	-	11.3
5B54TL.2012	5.00	5.40	5.75	2517	A1	2 1/2	2 1/4	-	1 3/4	-	11.5
5B56TL.2517ANSI	5.20	5.60	5.95	2517	A1	2 1/2	2 1/4	-	1 3/4	-	12.0
5B60TL.2517ANSI	5.60	6.00	6.35	2517	A1	2 1/2	2 1/4	-	1 3/4	-	14.0
5B64TL.2517ANSI	6.00	6.40	6.75	2517	A1	2 1/2	2 1/4	-	1 3/4	-	16.0
5B68TL.3020	6.40	6.80	7.15	2517	A1	2 1/2	2 1/4	-	1 3/4	-	18.0
5B74TL.3020	7.00	7.40	7.75	2517	A1	2 1/2	2 1/4	-	1 3/4	-	22.0
5B86TL.3020	8.20	8.60	8.95	2517	A2	2 1/2	2 1/4	4 3/4	1 3/4	-	24.0
5B94TL.2517ANSI	9.00	9.40	9.75	2517	A2	2 1/2	2 1/4	4 3/4	1 3/4	-	26.0
5B110TL.3020	10.60	11.00	11.35	2517	A2	2 1/2	2 1/4	4 3/4	1 3/4	-	35.0
5B124TL.3020	12.00	12.40	12.75	2517	A3	2 1/2	3/4	4 3/4	1 3/4	1 1/2	40.0
5B154TL.3020	15.00	15.40	15.75	2517	A3	2 1/2	3/4	4 3/4	1 3/4	1 1/2	47.0
5B184TL.2517ANSI	18.00	18.40	18.75	2517	A3	2 1/2	3/4	4 3/4	1 3/4	1 1/2	52.0
5B200TL.3030	19.60	20.00	20.35	3030	A3	3	1/4	5 11/16	1 3/4	3/4	75.0
5B250TL.4040	24.60	25.00	25.35	3030	A3	3	1/4	5 11/16	3	3/4	81.0
5B300TL.3030	29.60	30.00	30.35	3030	A3	3	1/4	5 11/16	3	3/4	109
5B380TL.3030	37.60	38.00	38.35	3030	A3	3	1/4	5 11/16	3	3/4	158

Note: Pulleys prepared for bushings type 2517 and 3535 use ANSI Taper-Lock® Bushings with 1/2" x 13tpi UNC threads.

### Bushing Standard Bore

Bushing	Bore Range	
	Min	Max
1210	1/2	1 1/4
1610, 1615	1/2	1 5/8
2517	1/2	2 1/2
3020, 3030	7/8	3

### Standard Keyseats

Bore Range	Keyseat	Bore Range	Keyseat
1/2 - 9/16	1/8 x 1/16	1 7/16 - 1 3/4	3/8 x 3/16
5/8 - 7/8	3/16 x 3/32	1 13/16 - 2 1/4	1/2 x 1/4
15/16 - 1 1/4	1/4 x 1/8	2 5/16 - 2 3/4	5/8 x 5/16
15/16 - 1 3/8	5/16 x 5/32	2 13/16 - 3 1/4	3/4 x 3/8

# ANSI (Inch) Taper-Bushing V-Belt Sheaves

## A-A/B-C-D Cast Iron Sheaves

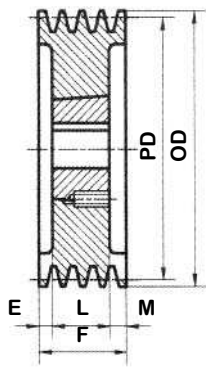

A-1

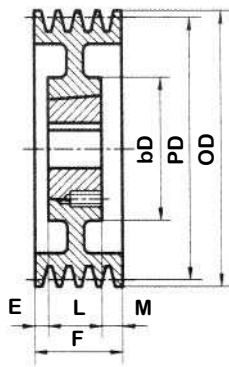

A-2

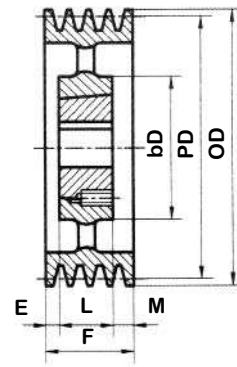

A-3

### A/B-6

F = 4 3/4"

Part No.	PD		OD	Bush	Type	Bush Max. Bore	E	bD	L	M	Wt Less Bush
	A Belt	B Belt									
6B42TL.1615	3.80	4.20	4.55	1615	A1	1 5/8	3 1/4	-	1 1/2	-	8.0
6B44TL.1615	4.00	4.40	4.75	1615	A1	1 5/8	3 1/4	-	1 1/2	-	9.0
6B46TL.1615	4.20	4.60	4.95	1615	A1	1 5/8	3 1/4	-	1 1/2	-	10.0
6B50TL.2517ANSI	4.60	5.00	5.35	2517	A1	2 1/2	3	-	1 3/4	-	11.9
6B52TL.2517ANSI	4.80	5.20	5.55	2517	A1	2 1/2	3	-	1 3/4	-	12.8
6B56TL.2517ANSI	5.20	5.60	5.95	2517	A1	2 1/2	3	-	1 3/4	-	14.6
6B60TL.2517ANSI	5.60	6.00	6.35	2517	A1	2 1/2	3	-	1 3/4	-	16.0
6B64TL.3020	6.00	6.40	6.75	2517	A1	2 1/2	3	-	1 3/4	-	19.5
6B68TL.3020	6.40	6.80	7.15	2517	A1	2 1/2	3	-	1 3/4	-	21.0
6B74TL.3020	7.00	7.40	7.75	2517	A1	2 1/2	3	-	1 3/4	-	25.0
6B86TL.2517ANSI	8.20	8.60	8.95	2517	A2	2 1/2	3	4 3/4	1 3/4	-	27.0
6B94TL.2517ANSI	9.00	9.40	9.75	2517	A2	2 1/2	3	4 3/4	1 3/4	-	28.0
6B110TL.2517ANSI	10.60	11.00	11.35	2517	A2	2 1/2	3	4 3/4	1 3/4	-	34.0
6B124TL.2517ANSI	12.00	12.40	12.75	2517	A3	2 1/2	1 18	4 3/4	1 3/4	1 7/8	43.0
6B154TL.2517ANSI	15.00	15.40	15.75	2517	A3	2 1/2	1 1/2	4 3/4	1 3/4	1 1/2	52.0
6B184TL.2517ANSI	18.00	18.40	18.75	2517	A3	2 1/2	1 1/2	4 3/4	1 3/4	1 1/2	62.0
6B200TL.4040	19.60	20.00	20.35	3020	A3	3	1/2	5 11/16	3	1 1/4	85.0
6B250TL.4040	24.60	25.00	25.35	3030	A3	3	1/2	5 11/16	3	1 1/4	100
6B300TL.3030	29.60	30.30	30.35	3030	A3	3	1/2	5 11/16	3	1 1/4	137
6B380TL.3030	37.60	38.00	38.35	3030	A3	3	1/2	5 11/16	3	1 1/4	168

Note: Pulleys prepared for bushings type 2517 and 3535 use ANSI Taper-Lock® Bushings with 1/2" x 13tpi UNC threads.

### Bushing Standard Bore

Bushing	Bore Range	
	Min	Max
1210	1/2	1 1/4
1610, 1615	1/2	1 5/8
2517	1/2	2 1/2
3020, 3030	7/8	3

### Standard Keyseats

Bore Range	Keyseat	Bore Range	Keyseat
1/2 - 9/16	1/8 x 1/16	1 7/16 - 1 3/4	3/8 x 3/16
5/8 - 7/8	3/16 x 3/32	1 13/16 - 2 1/4	1/2 x 1/4
15/16 - 1 1/4	1/4 x 1/8	2 5/16 - 2 3/4	5/8 x 5/16
15/16 - 1 3/8	5/16 x 5/32	2 13/16 - 3 1/4	3/4 x 3/8

# ANSI (Inch) Taper-Bushing V-Belt Sheaves

## A-A/B-C-D Cast Iron Sheaves

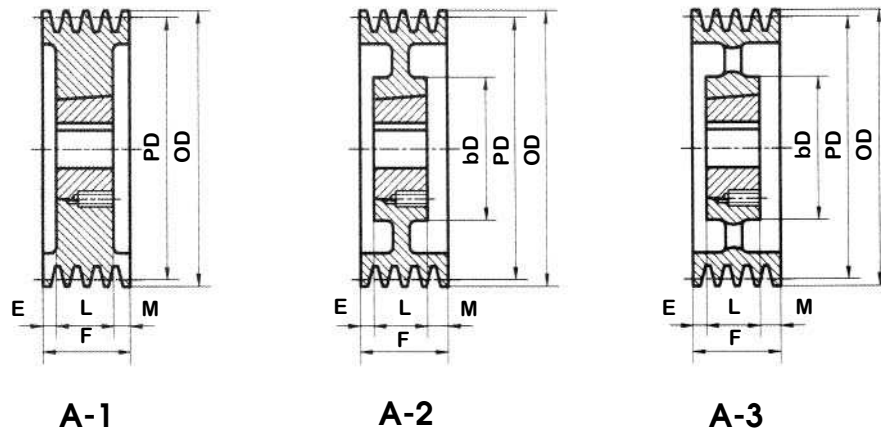

### A/B-8

**F = 6 1/4"**

Part No.	PD		OD	Bush	Type	Bush Max. Bore	E	bD	L	M	Wt Less Bush
	A Belt	B Belt									
8B54TL.2517ANSI	5.00	5.40	5.75	2517	A1	2 1/2	1 7/8	-	1 3/4	2 5/8	16
8B56TL.2517ANSI	5.20	5.60	5.95	2517	A1	2 1/2	1 7/8	-	1 3/4	2 5/8	17
8B60TL.2517ANSI	5.60	6.00	6.35	2517	A1	2 1/2	1 7/8	-	1 3/4	2 5/8	19
8B64TL.3020	6.00	6.40	6.75	2517	A1	2 1/2	1 7/8	-	1 3/4	2 5/8	21
8B68TL.3030	6.40	6.80	7.15	2517	A1	2 1/2	1 7/8	-	1 3/4	2 5/8	25
8B74TL.3030	7.00	7.40	7.75	2517	A1	2 1/2	1 7/8	-	1 3/4	2 5/8	29
8B86TL.3030	8.20	8.60	8.95	3030	A1	3	1	-	3	2 1/4	37
8B94TL.3030	9.00	9.40	9.95	3030	A2	3	1	5 11/16	3	2 1/4	41
8B110TL.3030	10.60	11.00	11.35	3030	A2	3	1	5 11/16	3	2 1/4	51
8B124TL.3030	12.00	12.40	12.75	3030	A3	3	1	5 11/16	3	2 1/4	56
8B154TL.3030	15.00	15.40	15.75	3030	A3	3	1	5 11/16	3	2 1/4	69
8B184TL.3030	18.00	18.40	18.75	3030	A3	3	1	5 11/16	3	2 1/4	99
8B200TL.4040	19.60	20.00	20.35	3030	A3	3	1	5 11/16	3	2 1/4	115
8B250TL.4545	24.60	25.00	25.35	3535	A3	3 1/2	3/4	6 1/2	3 1/2	2	145
8B300TL.3535ANSI	29.60	30.00	30.35	3535	A3	3 1/2	3/4	6 1/2	3 1/2	2	170
8B380TL.4040	37.60	38.00	38.35	4040	A3	4	1 1/8	7 3/16	4	1 1/8	260

Note: Pulleys prepared for bushings type 2517 and 3535 use ANSI Taper-Lock® Bushings with 1/2" x 13tpi UNC threads.

### A/B-10

**F = 7 3/4"**

Part No.	PD		OD	Bush	Type	Bush Max. Bore	E	bD	L	M	Wt Less Bush
	A Belt	B Belt									
10B54TL.2517ANSI	5.00	5.40	5.75	2517	A1	2 1/2	3	-	1 3/4	3	18
10B56TL.2517ANSI	5.20	5.60	5.95	2517	A1	2 1/2	3	-	1 3/4	3	20
10B60TL.2517ANSI	5.60	6.00	6.35	2517	A1	2 1/2	3	-	1 3/4	3	22
10B64TL.2517ANSI	6.00	6.40	6.75	2517	A1	2 1/2	3	-	1 3/4	3	25
10B68TL.2517ANSI	6.40	6.80	7.15	2517	A1	2 1/2	3	-	1 3/4	3	28
10B74TL.2517ANSI	7.00	7.40	7.75	2517	A1	2 1/2	3	-	1 3/4	3	35
10B86TL.3030	8.20	8.60	8.95	3030	A1	3	2	-	3	2 3/4	43
10B94TL.3030	9.00	9.40	9.95	3030	A2	3	2	5 11/16	3	2 3/4	46
10B110TL.3030	10.60	11.00	11.35	3030	A2	3	2	5 11/16	3	2 3/4	52

Note: Pulleys prepared for bushings type 2517 and 3535 use ANSI Taper-Lock® Bushings with 1/2" x 13tpi UNC threads.

# ANSI (Inch) Taper-Bushing V-Belt Sheaves

## A-A/B-C-D Cast Iron Sheaves

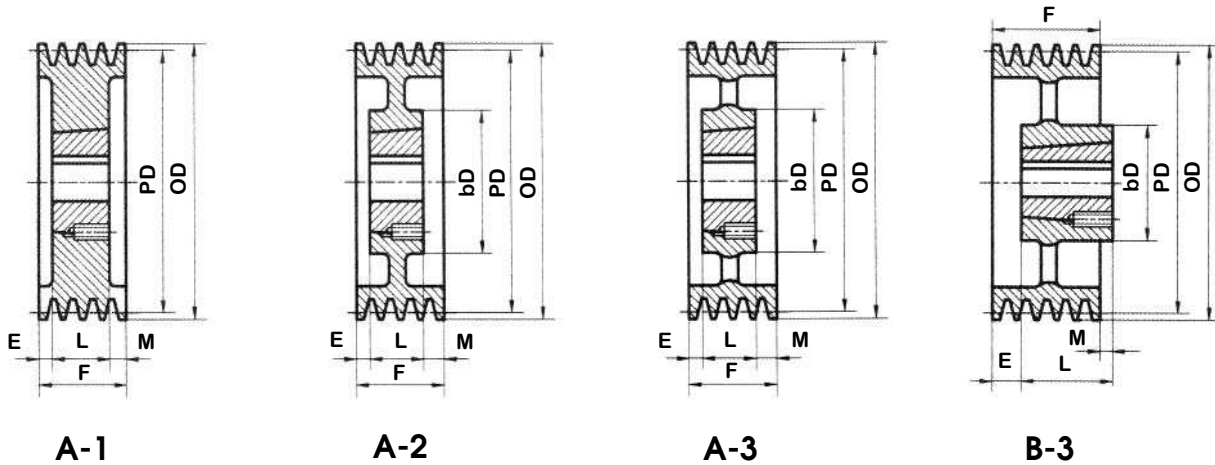

### C-2

F = 2 3/8"

Part No.	P.D	O.D	Bush Max. Bore	Bush	Type	dD	E	L	M	Wt Less Bush
2C70TL.2517ANSI	7.00	7.40	2 1/2	2517	A1	-	5/8	1 3/4	-	15
2C75TL.2517ANSI	7.50	7.90	2 1/2	2517	A1	-	5/8	1 3/4	-	17
2C80TL.2517ANSI	8.00	8.40	2 1/2	2517	A1	-	5/8	1 3/4	-	20
2C85TL.2517ANSI	8.50	8.90	2 1/2	2517	A2	4 3/4	5/8	1 3/4	-	22
2C90TL.3020	9.00	9.40	2 1/2	2517	A2	4 3/4	5/8	1 3/4	-	23
2C95TL.2517ANSI	9.50	9.90	2 1/2	2517	A2	4 3/4	5/8	1 3/4	-	24
2C100TL.3020	10.00	10.40	2 1/2	2517	A2	4 3/4	5/8	1 3/4	-	25
	10.50	10.90	2 1/2	2517	A2	4 3/4	5/8	1 3/4	-	26
	11.00	11.40	2 1/2	2517	A2	4 3/4	5/8	1 3/4	-	27
	12.00	12.40	2 1/2	2517	A2	4 3/4	5/8	1 3/4	-	33
	13.00	13.40	2 1/2	2517	A3	4 3/4	5/8	1 3/4	-	35
	14.00	14.40	2 1/2	2517	A3	4 3/4	5/8	1 3/4	-	36
	16.00	16.40	2 1/2	2517	A3	4 3/4	5/8	1 3/4	-	42
	18.00	18.40	3	3030	A3	5 11/16	-	2	3/8	43
	20.00	20.40	3	3030	A3	5 11/16	-	2	3/8	45
	24.00	24.40	3	3030	A3	5 11/16	-	2	3/8	72

Note: Pulleys prepared for bushings type 2517 and 3535 use ANSI Taper-Lock® Bushings with 1/2" x 13tpi UNC threads.

### C-3

F = 3 3/8"

Part No.	P.D	O.D	Bush Max. Bore	Bush	Type	dD	E	L	M	Wt Less Bush
3C70TL.2517ANSI	7.00	7.40	2 1/2	2517	A1	-	1/4	1 3/4	1 3/8	18
3C75TL.2517ANSI	7.50	7.90	2 1/2	2517	A1	-	1/4	1 3/4	1 3/8	20
3C80TL.2517ANSI	8.00	8.40	2 1/2	2517	A1	-	1/4	1 3/4	1 3/8	22
3C85TL.3020	8.50	8.90	2 1/2	2517	A2	4 3/4	1/4	1 3/4	1 3/8	23
3C90TL.3020	9.00	9.40	2 1/2	2517	A2	4 3/4	1/4	1 3/4	1 3/8	24
3C95TL.3020	9.50	9.90	2 1/2	2517	A2	4 3/4	1/4	1 3/4	1 3/8	27
3C100TL.3020	10.00	10.40	2 1/2	2517	A2	4 3/4	1/4	1 3/4	1 3/8	29
	10.50	10.90	2 1/2	2517	A2	4 3/4	1/4	1 3/4	1 3/8	32
	11.00	11.40	2 1/2	2517	A2	4 3/4	1/4	1 3/4	1 3/8	35
	12.00	12.40	3	3020	A2	5 11/16	-	2	1 3/8	44
	13.00	13.40	3	3020	A3	5 11/16	-	2	1 3/8	49
	14.00	14.40	3	3020	A3	5 11/16	-	2	1 3/8	50
	16.00	16.40	3	3020	A3	5 11/16	-	2	1 3/8	64
	18.00	18.40	3	3030	A3	5 11/16	-	3	3/8	70
	20.00	20.40	3	3030	A3	5 11/16	-	3	3/8	78
	24.00	24.40	3	3030	A3	5 11/16	-	3	3/8	96
	30.00	30.40	3 1/2	3535	B3	6 1/2	-	3 1/2	1/8	125
	36.00	36.40	3 1/2	3535	B3	6 1/2	-	3 1/2	1/8	175

Note: Pulleys prepared for bushings type 2517 and 3535 use ANSI Taper-Lock® Bushings with 1/2" x 13tpi UNC threads.

# ANSI (Inch) Taper-Bushing V-Belt Sheaves

## A-A/B-C-D Cast Iron Sheaves

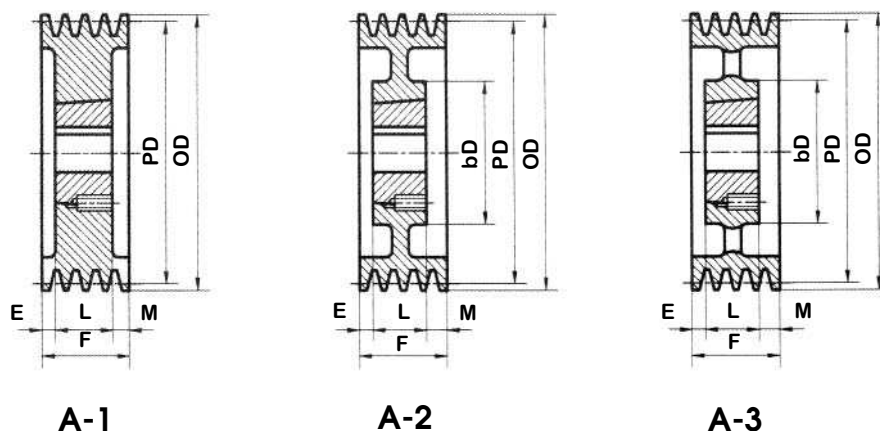

### C-4

**F = 4 3/8"**

Part No.	P.D	O.D	Bush Max. Bore	Bush	Type	dD	E	L	M	Wt Less Bush
4C70TL.2517ANSI	7.00	7.40	2 1/2	2517	A1	-	1/2	1 3/4	2 1/8	20
4C75TL.2517ANSI	7.50	7.90	2 1/2	2517	A1	-	1/2	1 3/4	2 1/8	23
4C80TL.3020	8.00	8.40	2 1/2	3020	A1	-	1/2	1 3/4	2 1/8	25
4C85TL.3020	8.50	8.90	2 1/2	3020	A2	4 3/4	1/2	1 3/4	2 1/8	26
4C90TL.2517ANSI	9.00	9.40	2 1/2	2517	A2	4 3/4	1/2	1 3/4	2 1/8	27
4C95TL.2517ANSI	9.50	9.90	2 1/2	2517	A2	4 3/4	1/2	1 3/4	2 1/8	36
	10.00	10.40	2 1/2	2517	A2	4 3/4	1/2	1 3/4	2 1/8	39
	10.50	10.90	2 1/2	2517	A2	4 3/4	1/2	1 3/4	2 1/8	42
	11.00	11.40	2 1/2	2517	A2	4 3/4	1/2	1 3/4	2 1/8	45
	12.00	12.40	2 1/2	2517	A2	4 3/4	1/2	1 3/4	2 1/8	47
	13.00	13.40	3	3030	A3	5 11/16	-	3	1 3/8	51
	14.00	14.40	3	3030	A3	5 11/16	-	3	1 3/8	54
	16.00	16.40	3	3030	A3	5 11/16	-	3	1 3/8	71
	18.00	18.40	3	3030	A3	5 11/16	-	3	1 3/8	81
	20.00	20.40	3	3030	A3	5 11/16	-	3	1 3/8	94
	24.00	24.40	3	3030	A3	5 11/16	-	3	1 3/8	116
	30.00	30.40	3	3535	A3	6 1/2	-	3 1/2	7/8	164
	36.00	36.40	3	3535	A3	6 1/2	-	3 1/2	7/8	192
	44.00	44.40	3	4040	A3	6 1/2	-	4	3/8	282

### C-5

**F = 5 3/8"**

Part No.	P.D	O.D	Bush Max. Bore	Bush	Type	dD	E	L	M	Wt Less Bush
5C70TL.2517ANSI	7.00	7.40	2 1/2	2517	A1	-	1 1/2	1 3/4	2 1/8	23
5C75TL.2517ANSI	7.50	7.90	2 1/2	2517	A1	-	1 1/2	1 3/4	2 1/8	26
5C80TL.2517ANSI	8.00	8.40	2 1/2	2517	A1	-	1 1/2	1 3/4	2 1/8	30
5C85TL.2517ANSI	8.50	8.90	2 1/2	2517	A1	-	1 1/2	1 3/4	2 1/8	34
5C90TL.2517ANSI	9.00	9.40	2 1/2	2517	A2	4 3/4	1 1/2	1 3/4	2 1/8	35
5C95TL.2517ANSI	9.50	9.90	2 1/2	2517	A2	4 3/4	1 1/2	1 3/4	2 1/8	36
	10.00	10.40	2 1/2	2517	A2	4 3/4	1 1/2	1 3/4	2 1/8	39
	10.50	10.90	2 1/2	2517	A2	4 3/4	1 1/2	1 3/4	2 1/8	42
	11.00	11.40	2 1/2	2517	A2	4 3/4	1 1/2	1 3/4	2 1/8	43
	12.00	12.40	3	3030	A2	5 11/16	1/2	3	1 7/8	58
	13.00	13.40	3	3030	A3	5 11/16	1/2	3	1 7/8	63
	14.00	14.40	3	3030	A3	5 11/16	1/2	3	1 7/8	65
	16.00	16.40	3	3030	A3	5 11/16	1/2	3	1 7/8	70
	18.00	18.40	3	3030	A3	5 11/16	1/2	3	1 7/8	83
	20.00	20.40	3 1/2	3535	A3	6 1/2	-	3 1/2	1 7/8	110
	24.00	24.40	3 1/2	3535	A3	6 1/2	-	3 1/2	1 7/8	138
	30.00	30.40	3 1/2	3535	A3	6 1/2	-	3 1/2	1 7/8	176
	36.00	36.40	4	4040	A3	7 3/16	1/4	4	1 7/8	244
	44.00	44.40	4	4040	A3	7 3/16	1/4	4	1 7/8	288

Note: Pulleys prepared for bushings type 2517 and 3535 use ANSI Taper-Lock® Bushings with 1/2" x 13tpi UNC threads.

# ANSI (Inch) Taper-Bushing V-Belt Sheaves

## A-A/B-C-D Cast Iron Sheaves

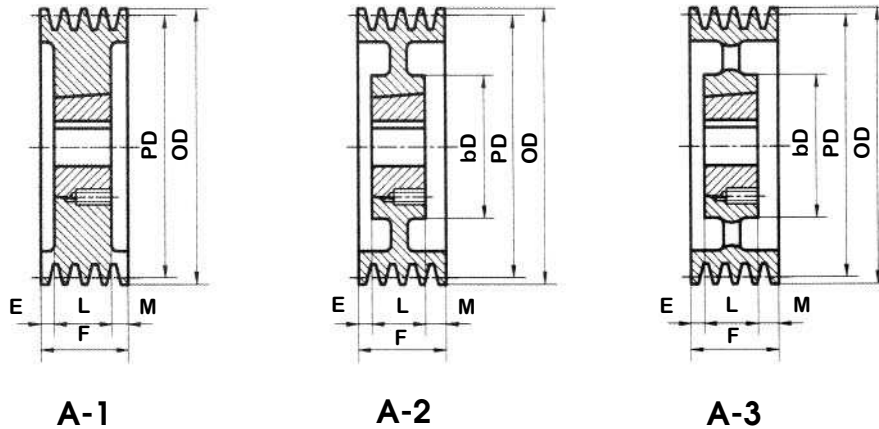

### C-6

F = 6 3/8"

Part No.	P.D	O.D	Bush Max. Bore	Bush	Type	dD	E	L	M	Wt Less Bush
6C70TL.3030	7.00	7.40	3	3030	A1	-	1	3	2 3/8	30
6C75TL.3030	7.50	7.90	3	3030	A1	-	1	3	2 3/8	31
6C80TL.3030	8.00	8.40	3	3030	A1	-	1	3	2 3/8	35
6C85TL.3030	8.50	8.90	3	3030	A1	-	1	3	2 3/8	40
6C90TL.3030	9.00	9.40	3	3030	A1	-	1	3	2 3/8	47
6C95TL.3030	9.50	9.90	3	3030	A1	-	1	3	2 3/8	53
6C100TL.3030	10.00	10.40	3	3030	A1	-	1	3	2 3/8	57
6C105TL.3030	10.50	10.90	3	3030	A2	5 11/16	1	3	2 3/8	58
6C110TL.3030	11.00	11.40	3	3030	A2	5 11/16	1	3	2 3/8	66
6C120TL.3030	12.00	12.40	3	3030	A2	5 11/16	1	3	2 3/8	70
6C130TL.3030	13.00	13.40	3	3030	A3	5 11/16	1	3	2 3/8	75
	14.00	14.40	3 1/2	3535	A3	5 11/16	1/2	3 1/2	2 3/8	80
	16.00	16.40	3 1/2	3535	A3	6 1/2	1/2	3 1/2	2 3/8	87
	18.00	18.40	3 1/2	3535	A3	6 1/2	1/2	3 1/2	2 3/8	102
	20.00	20.40	3 1/2	3535	A3	6 1/2	1/2	3 1/2	2 3/8	126
	24.00	24.40	3 1/2	3535	A3	6 1/2	1/2	3 1/2	2 3/8	150
	30.00	30.40	4	4040	A3	7 3/16	1	4	1 3/8	226
	36.00	36.40	4	4040	A3	7 3/16	1	4	1 3/8	270
	44.00	44.40	4	4040	A3	7 3/16	1	4	1 3/8	320

### C-8

F = 8 3/8"

Part No.	P.D	O.D	Bush Max. Bore	Bush	Type	dD	E	L	M	Wt Less Bush
8C80TL.3030	8.00	8.40	3	3030	A1	-	2	3	3 3/8	45
8C85TL.3030	8.50	8.90	3	3030	A1	-	2	3	3 3/8	47
8C90TL.3535ANSI	9.00	9.40	3 1/2	3535	A1	-	1 1/2	3 1/2	3 3/8	64
8C95TL.3535ANSI	9.50	9.90	3 1/2	3535	A1	-	1 1/2	3 1/2	3 3/8	67
	10.00	10.40	3 1/2	3535	A1	-	1 1/2	3 1/2	3 3/8	70
	10.50	10.90	3 1/2	3535	A1	-	1 1/2	3 1/2	3 3/8	84
	11.00	11.40	3 1/2	3535	A1	-	1 1/2	3 1/2	3 3/8	87
	12.00	12.40	3 1/2	3335	A2	6 1/2	1 1/2	3 1/2	3 3/8	90
	13.00	13.40	3 1/2	3535	A2	6 1/2	1 1/2	3 1/2	3 3/8	97
	14.00	14.40	3 1/2	3535	A2	6 1/2	1 1/2	3 1/2	3 3/8	105
	16.00	16.40	3 1/2	3535	A3	6 1/2	1 1/2	3 1/2	3 3/8	115
	18.00	18.40	4	4040	A3	7 3/16	1 1/2	4	2 7/8	137
	20.00	20.40	4	4040	A3	7 3/16	1 1/2	4	2 7/8	180
	24.00	24.40	4	4040	A3	7 3/16	1 1/2	4	2 7/8	205
	30.00	30.40	4	4040	A3	7 3/16	1 1/2	4	2 7/8	263
	36.00	36.40	4 1/2	4545	A3	8 7/16	1 1/4	4 1/2	2 5/8	343
	44.00	44.40	4 1/2	4545	A3	8 7/16	1 1/4	4 1/2	2 5/8	432

Note: Pulleys prepared for bushings type 2517 and 3535 use ANSI Taper-Lock® Bushings with 1/2" x 13tpi UNC threads.

# ANSI (Inch) Taper-Bushing V-Belt Sheaves

## A-A/B-C-D Cast Iron Sheaves

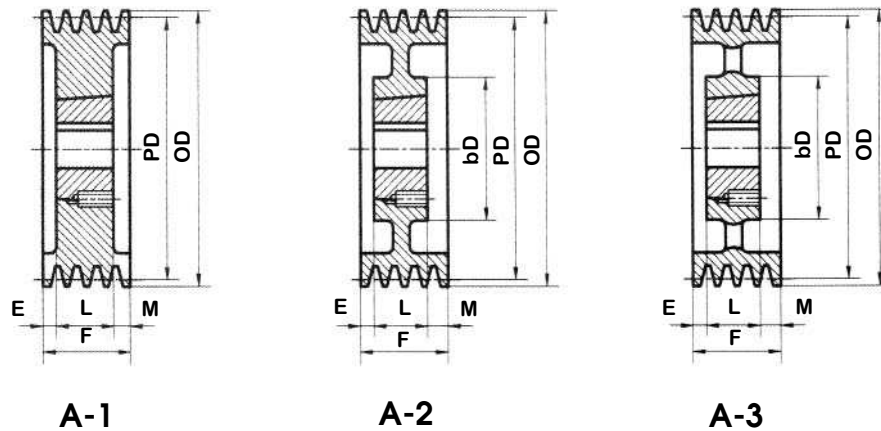

### C-10

**F = 10 3/8"**

Part No.	P.D	O.D	Bush Max. Bore	Bush	Type	dD	E	L	M	Wt Less Bush
10C90TL.4040	9.00	9.40	4	4040	A1	-	2	4	4 3/8	57
10C95TL.4040	9.50	9.90	4	4040	A1	-	2	4	4 3/8	66
10C100TL.4040	10.00	10.40	4	4040	A1	-	2	4	4 3/8	77
10C105TL.4040	10.50	10.90	4	4040	A2	-	2	4	4 3/8	87
10C110TL.4040	11.00	11.40	4	4040	A1	-	2	4	4 3/8	98
10C120TL.4040	12.00	12.40	4	4040	A1	-	2	4	4 3/8	121
10C130TL.4040	13.00	13.40	4	4040	A1	-	2 1/2	4	3 7/8	146
10C140TL.4040	14.00	14.40	4	4040	A2	-	2 1/2	4	3 7/8	173
10C160TL.4040	16.00	16.40	4	4040	A2	8 7/16	2 1/2	4	3 7/8	233
10C180TL.4040	18.00	18.40	4	4040	A2	8 7/16	2 1/2	4	3 7/8	276
10C200TL.4040	20.00	20.40	4	4040	A3	8 7/16	2 1/2	4	3 7/8	201
10C240TL.4040	24.00	24.40	4	4040	A3	8 7/16	2 1/2	4	3 7/8	243
10C300TL.4545	30.00	30.40	4 1/2	4545	A3	8 7/16	2	4 1/2	3 7/8	320
10C360TL.4545	36.00	36.40	4 1/2	4545	A3	8 7/16	2	4 1/2	3 7/8	464
10C440TL.4545	44.00	44.40	4 1/2	4545	A3	8 7/16	2	4 1/2	3 7/8	508

Note: Pulleys prepared for bushings type 2517 and 3535 use ANSI Taper-Lock® Bushings with 1/2" x 13tpi UNC threads.

### C-12

**F = 12 3/8"**

Part No.	P.D	O.D	Bush Max. Bore	Bush	Type	dD	E	L	M	Wt Less Bush
12C90TL.4040	9.00	9.40	4	4040	A1	-	3 1/2	4	4 7/8	65
12C95TL.4040	9.50	9.90	4	4040	A1	-	3 1/2	4	4 7/8	75
12C100TL.4040	10.00	10.40	4	4040	A1	-	3 1/2	4	4 7/8	85
12C105TL.4040	10.50	10.90	4	4040	A1	-	3 1/2	4	4 7/8	95
12C110TL.4040	11.00	11.40	4	4040	A1	-	3 1/2	4	4 7/8	104
12C120TL.4040	12.00	12.40	4	4040	A1	-	3 1/2	4	4 7/8	126
	13.00	13.40	4 1/2	4545	A1	-	3	4 1/2	4 7/8	156
	14.00	14.40	4 1/2	4545	A1	-	3	4 1/2	4 7/8	184

Note: Pulleys prepared for bushings type 2517 and 3535 use ANSI Taper-Lock® Bushings with 1/2" x 13tpi UNC threads.



# ANSI (Inch) Taper-Bushing V-Belt Sheaves

## A-A/B-C-D Cast Iron Sheaves

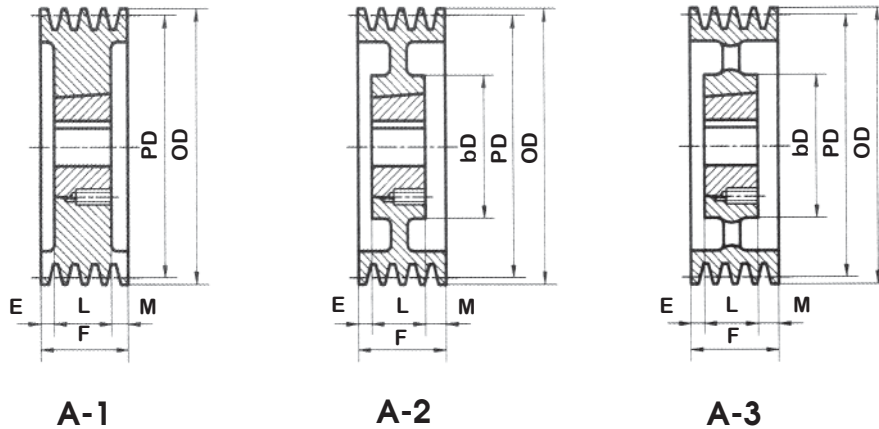

### D-4

F = 6 1/16"

Part No.	P.D	O.D	Bush Max. Bore	Bush	Type	dD	E	L	M	Wt Less Bush
4D120TL.3535	12.00	12.60	3 1/2	3535	A2	6 1/2	3/4	3 1/2	1 13/16	63
4D130TL.3535	13.00	13.60	3 1/2	3535	A2	6 1/2	3/4	3 1/2	1 13/16	73
4D135TL.3535	13.50	14.10	3 1/2	3535	A2	6 1/2	3/4	3 1/2	1 13/16	78
4D140TL.3535	14.00	14.60	3 1/2	3535	A3	6 1/2	3/4	3 1/2	1 13/16	83
4D145TL.3535	14.50	15.10	3 1/2	3535	A3	6 1/2	3/4	3 1/2	1 13/16	94
4D150TL.3535	15.00	15.60	3 1/2	3535	A3	6 1/2	3/4	3 1/2	1 13/16	97
4D155TL.3535	15.50	16.10	3 1/2	3535	A3	6 1/2	3/4	3 1/2	1 13/16	99
4D160TL.3535	16.00	16.60	3 1/2	3535	A3	6 1/2	3/4	3 1/2	1 13/16	104
4D180TL.3535	18.00	18.60	3 1/2	3535	A3	6 1/2	3/4	3 1/2	1 13/16	109
4D220TL.4040	22.00	22.60	4	4040	A3	7 3/16	3/4	4	1 5/16	142
4D270TL.4040	27.00	27.60	4	4040	A3	7 3/16	3/4	4	1 5/16	182

Note: Pulleys prepared for bushings type 2517 and 3535 use ANSI Taper-Lock® Bushings with 1/2" x 13tpi UNC threads.

### D-5

F = 7 1/2"

Part No.	P.D	O.D	Bush Max. Bore	Bush	Type	dD	E	L	M	Wt Less Bush
5D120TL.4040	12.00	12.60	4	4040	A1	-	1/4	4	2 3/4	82
5D130TL.4040	13.00	13.60	4	4040	A2	7 3/16	3/4	4	2 3/4	87
5D135TL.4040	13.50	14.10	4	4040	A2	7 3/16	3/4	4	2 3/4	92
5D140TL.4040	14.00	14.60	4	4040	A2	7 3/16	3/4	4	2 3/4	97
5D145TL.4040	14.50	15.10	4	4040	A2	7 3/16	3/4	4	2 3/4	102
5D150TL.4040	15.00	15.60	4	4040	A2	7 3/16	3/4	4	2 3/4	107
5D155TL.4040	15.50	16.10	4	4040	A2	7 3/16	3/4	4	2 3/4	112
5D160TL.4040	16.00	16.60	4	4040	A2	7 3/16	3/4	4	2 3/4	122
5D180TL.4040	18.00	18.60	4	4040	A3	7 3/16	1	4	2 1/2	132
5D220TL.4040	22.00	22.60	4	4040	A3	7 3/16	1	4	2 1/2	162
5D270TL.4040	27.00	27.60	4	4040	A3	7 3/16	1	4	2 1/2	207

Note: Pulleys prepared for bushings type 2517 and 3535 use ANSI Taper-Lock® Bushings with 1/2" x 13tpi UNC threads.

# ANSI (Inch) Taper-Bushing V-Belt Sheaves A-A/B-C-D Cast Iron Sheaves

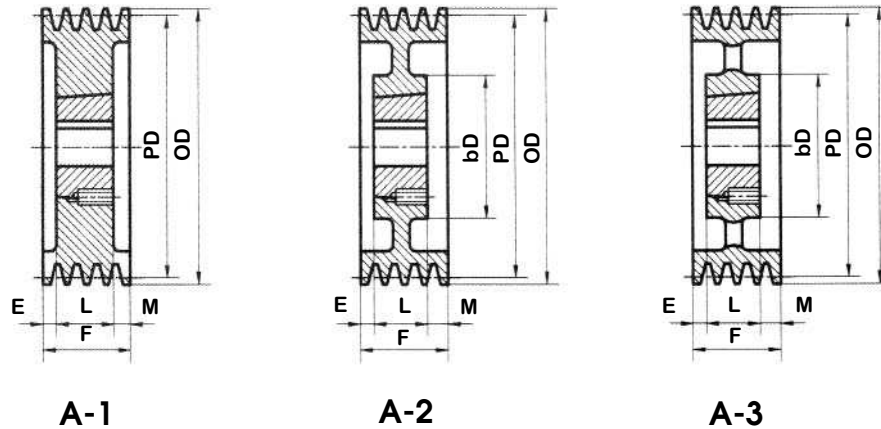

## D-6

F = 8 15/16"

Part No.	P.D	O.D	Bush Max. Bore	Bush	Type	dD	E	L	M	Wt Less Bush
6D120TL.4040	12.00	12.60	4	4040	A1	-	1	4	3 15/16	100
6D130TL.4040	13.00	13.60	4	4040	A2	7 3/16	1 1/2	4	3 7/16	105
6D135TL.4040	13.50	14.10	4	4040	A2	7 3/16	1 1/2	4	3 7/16	107
6D140TL.4040	14.00	14.60	4	4040	A2	7 3/16	1 1/2	4	3 7/16	112
6D145TL.4040	14.50	15.10	4	4040	A2	7 3/16	1 1/2	4	3 7/16	117
6D150TL.4040	15.00	15.60	4	4040	A2	7 3/16	1 1/2	4	3 7/16	122
6D155TL.4040	15.50	16.10	4	4040	A2	7 3/16	1 1/2	4	3 7/16	127
6D160TL.4040	16.00	16.60	4	4040	A2	7 3/16	1 1/2	4	3 7/16	175
6D180TL.4040	18.00	18.60	4	4040	A2	7 3/16	1 1/2	4	3 7/16	185
6D220TL.4040	22.00	22.60	4	4040	A3	8 7/16	1 1/2	4	3 7/16	210
6D270TL.4545	27.00	27.60	4 1/2	4545	A3	8 7/16	1 3/4	4 1/2	2 11/16	260
6D330TL.4545	33.00	33.60	4 1/2	4545	A3	8 7/16	1 3/4	4 1/2	2 11/16	340

Note: Pulleys prepared for bushings type 2517 and 3535 use ANSI Taper-Lock® Bushings with 1/2" x 13tpi UNC threads.

## D-8

F = 11 13/16"

Part No.	P.D	O.D	Bush Max. Bore	Bush	Type	dD	E	L	M	Wt Less Bush
8D120TL.4545	12.00	12.60	4 1/2	4545	A1	-	1/2	4 1/2	6 13/16	125
8D130TL.4545	13.00	13.60	4 1/2	4545	A1	8 7/16	1/2	4 1/2	6 13/16	155
8D135TL.4545	13.50	14.10	4 1/2	4545	A2	8 7/16	1	4 1/2	6 5/16	150
8D140TL.4545	14.00	14.60	4 1/2	4545	A2	8 7/16	1	4 1/2	6 5/16	155
8D145TL.4545	14.50	15.10	4 1/2	4545	A2	8 7/16	2	4 1/2	5 5/16	162
8D150TL.4545	15.00	15.60	4 1/2	4545	A2	8 7/16	2	4 1/2	5 5/16	170
8D155TL.4545	15.50	16.10	4 1/2	4545	A2	8 7/16	2	4 1/2	5 5/16	182
8D160TL.4545	16.00	16.60	4 1/2	4545	A2	8 7/16	2	4 1/2	5 5/16	195
8D180TL.4545	18.00	18.60	4 1/2	4545	A2	8 7/16	2	4 1/2	4 9/16	220
8D220TL.4545	22.00	22.60	4 1/2	4545	A3	8 7/16	2 3/4	4 1/2	4 9/16	275
8D270TL.4545	27.00	27.60	4 1/2	4545	A3	8 7/16	2 3/4	4 1/2	4 9/16	345
8D330TL.4545	33.00	33.60	4 1/2	4545	A3	8 7/16	2 3/4	4 1/2	4 9/16	455

Note: Pulleys prepared for bushings type 2517 and 3535 use ANSI Taper-Lock® Bushings with 1/2" x 13tpi UNC threads.

# ANSI (Inch) Taper-Bushing V-Belt Sheaves A-A/B-C-D Cast Iron Sheaves

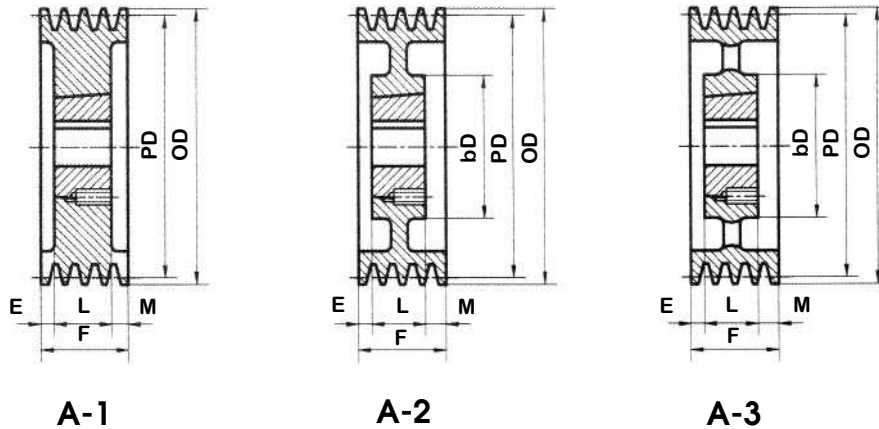

D-10

F = 14 11/16"

Part No.	P.D	O.D	Bush Max. Bore	Bush	Type	dD	E	L	M	Wt Less Bush
10D120TL.4545	12.00	12.60	4 1/2	4545	A1	-	2 3/8	4 1/2	7 13/16	140
10D130TL.4545	13.00	13.60	4 1/2	4545	A1	8 7/16	2 3/8	4 1/2	7 13/16	170
10D135TL.4545	13.50	14.10	4 1/2	4545	A2	8 7/16	2 3/8	4 1/2	7 13/16	172
10D140TL.4545	14.00	14.60	4 1/2	4545	A2	8 7/16	2 3/8	4 1/2	7 13/16	175
10D145TL.4545	14.50	15.10	4 1/2	4545	A2	8 7/16	2 3/8	4 1/2	7 13/16	180
10D150TL.4545	15.00	15.60	4 1/2	4545	A2	8 7/16	2 3/8	4 1/2	7 13/16	185
10D155TL.4545	15.50	16.10	4 1/2	4545	A2	8 7/16	2 3/8	4 1/2	7 13/16	195
10D160TL.4545	16.00	16.60	4 1/2	4545	A2	8 7/16	2 3/8	4 1/2	7 13/16	260
10D180TL.4545	18.00	18.60	4 1/2	4545	A2	8 7/16	4	4 1/2	6 3/16	295
10D220TL.4545	22.00	22.60	4 1/2	4545	A3	8 7/16	4	4 1/2	6 3/16	340
10D270TL.4545	27.00	27.60	4 1/2	4545	A3	8 7/16	4	4 1/2	6 3/16	415
10D330TL.4545	33.00	33.60	4 1/2	4545	A3	8 7/16	4 1/4	4 1/2	5 15/16	485

Note: Pulleys prepared for bushings type 2517 and 3535 use ANSI Taper-Lock® Bushings with 1/2" x 13tpi UNC threads.

## Bushing Standard Bore

Bushing	Bore Range	
	Min	Max
2517	1/2	2 1/2
3030	15/16	3
3535	1 3/16	3 1/2
4040	1 7/16	4
4545	1 15/16	4 1/2

## Standard Keyseats

Bore Range	Keyseat	Bore Range	Keyseat
1/2 - 9/16	1/8 x 1/16	1 7/16 - 1 3/4	3/8 x 3/16
5/8 - 7/8	3/16 x 3/32	1 13/16 - 2 1/4	1/2 x 1/4
15/16 - 1 1/4	1/4 x 1/8	2 5/16 - 2 3/4	5/8 x 5/16
15/16 - 1 3/8	5/16 x 5/32	2 13/16 - 3 1/4	3/4 x 3/8
1 7/16 - 1 3/4	3/8 - 3/16	3 7/8 - 4 1/2	1 x 1/2

# ANSI (Inch) Taper-Bushing V-Belt Sheaves

## 3V-5V-8V Cast Iron Sheaves

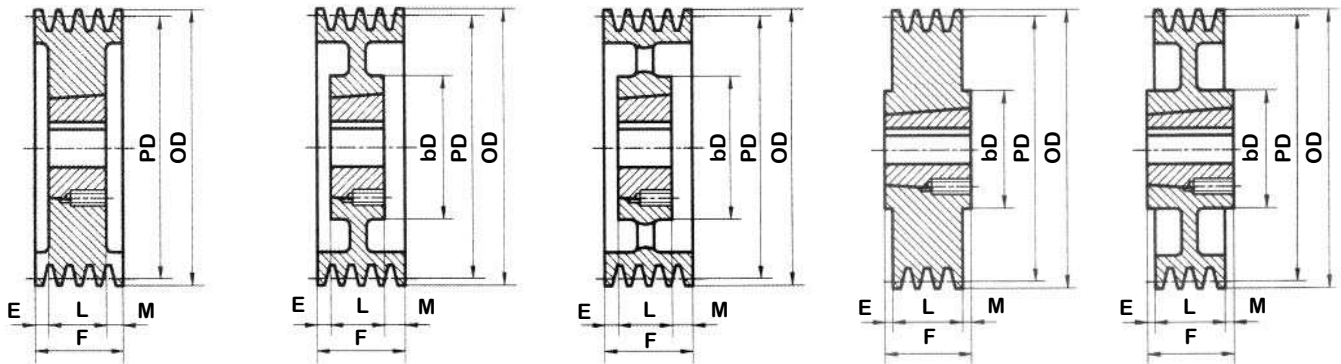

A-1

A-2

A-3

C-1

C-2

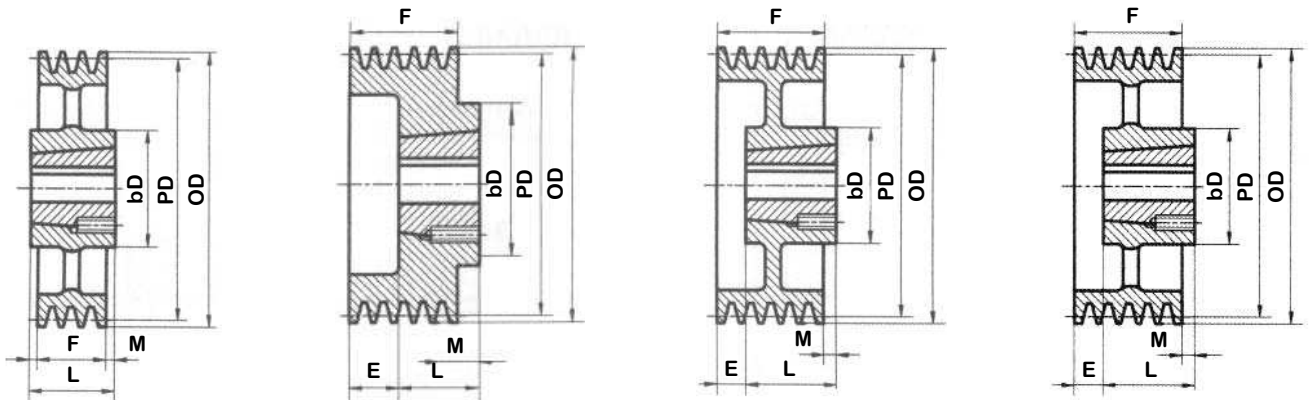

C-3

B-1

B-2

B-3

### Part Number Examples For Standard V-Belt

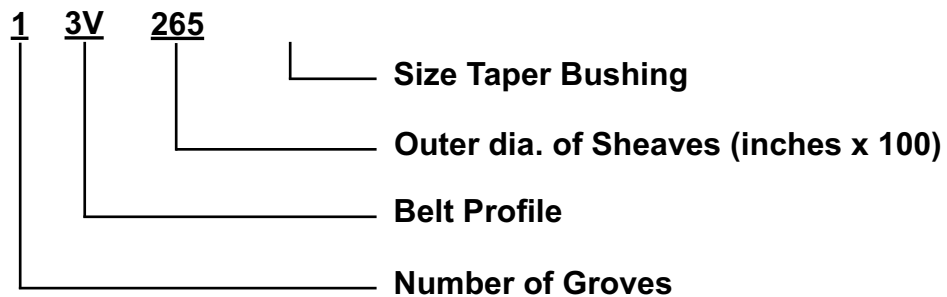

# ANSI (Inch) Taper-Bushing V-Belt Sheaves

## 3V-5V-8V Cast Iron Sheaves

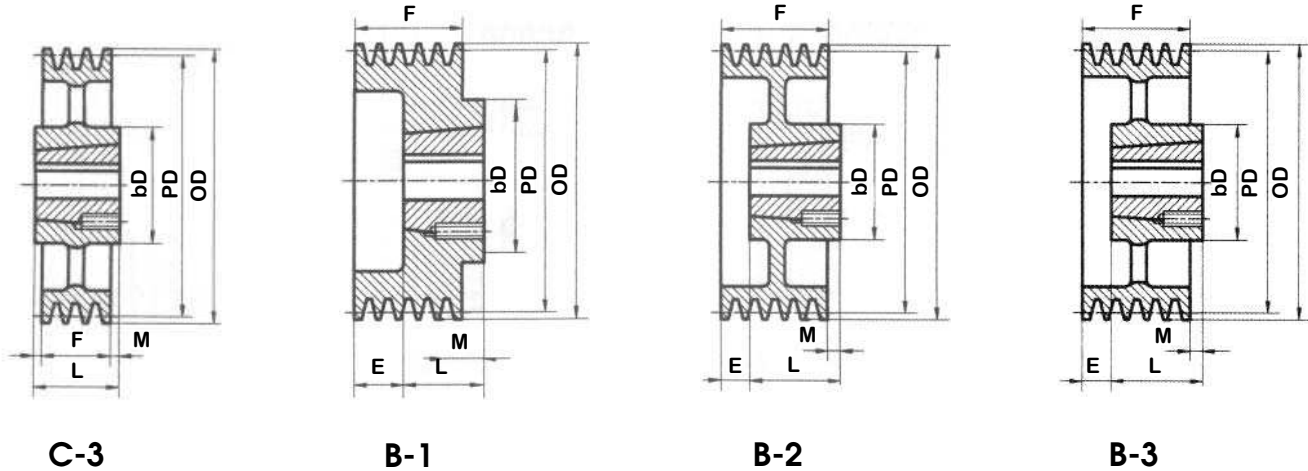

3V-1

F = 11/16"

Part No.	OD	PD	Bush Max Bore	Bush	Type	bD	E	L	M	Wt Less Bush
1-3V265TL.1108	2.65	2.60	1 1/8	1108	C1	-	3/16	7/8	-	0.75
1-3V280TL.1108	2.80	2.75	1 1/8	1108	C1	-	3/16	7/8	-	0.85
1-3V300TL.1108	3.00	2.95	1 1/8	1108	C1	-	3/16	7/8	-	1.00
1-3V315TL.1108	3.15	3.10	1 1/8	1108	C1	-	3/16	7/8	-	1.00
1-3V335TL.1610	3.35	3.30	1 5/8	1610	C1	3 5/16	-	1	5/16	1.10
1-3V365TL.1610	3.65	3.60	1 5/8	1610	B1	3 5/16	-	1	5/16	1.30
1-3V412TL.1610	4.12	4.07	1 5/8	1610	B1	3 5/16	-	1	5/16	2.00
1-3V450TL.1610	4.50	4.45	1 5/8	1610	B1	3 5/16	-	1	5/16	2.30
1-3V475TL.1610	4.75	4.70	1 5/8	1610	B1	3 5/16	-	1	5/16	2.60
1-3V500TL.1610	5.00	4.95	1 5/8	1610	B1	3 5/16	-	1	5/16	2.90
1-3V530TL.1610	5.30	5.25	1 5/8	1610	B1	3 5/16	-	1	5/16	3.30
1-3V560TL.1610	5.60	5.55	1 5/8	1610	B1	3 5/16	-	1	5/16	3.70
1-3V600TL.1610	6.00	5.95	1 5/8	1610	B1	3 5/16	-	1	5/16	4.20
1-3V650TL.1610	6.50	6.45	1 5/8	1610	B1	3 5/16	-	1	5/16	5.00
1-3V690TL.1610	6.90	6.85	1 5/8	1610	B2	3 5/16	-	1	5/16	5.60
1-3V800TL.2517ANSI	8.00	7.95	2 1/2	2517	B2	4 3/4	-	1 3/4	1 1/16	8.50
1-3V1060TL.2517ANSI	10.60	10.55	2 1/2	2517	B2	4 3/4	-	1 3/4	1 1/16	14.00
1-3V1400TL.2517ANSI	14.00	13.95	2 1/2	2517	B3	4 3/4	-	1 3/4	1 1/16	20.00
1-3V1900TL.3020	19.00	18.95	3	3020	B3	5 11/16	-	2	1 3/16	26.00

Note: Pulleys prepared for bushings type 2517 and 3535 use ANSI Taper-Lock® Bushings with 1/2" x 13tpi UNC threads.

# ANSI (Inch) Taper-Bushing V-Belt Sheaves

## 3V-5V-8V Cast Iron Sheaves

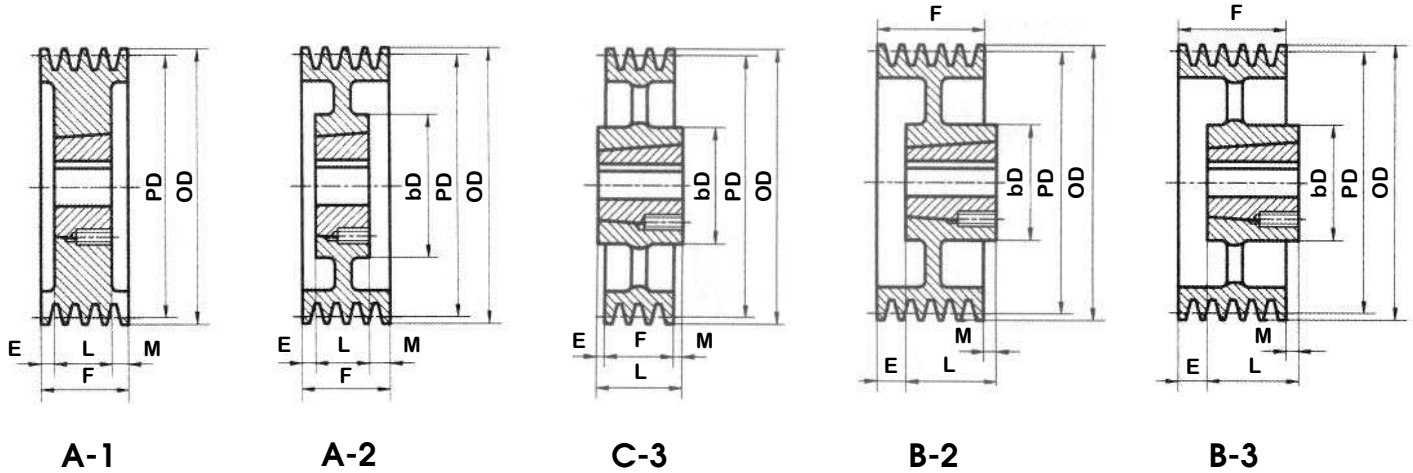

### 3V-2

F = 1 3/32"

Part No.	OD	PD	Bush Max Bore	Bush	Type	bD	E	L	M	Wt Less Bush
2-3V265TL.1108	2.65	2.60	1 1/8	1108	A1	-	7/32	7/8	-	0.75
2-3V280TL.1108	2.80	2.75	1 1/8	1108	A1	-	7/32	7/8	-	0.90
2-3V300TL.1210	3.00	2.95	1 1/4	1210	A1	-	3/32	1	-	1.40
2-3V315TL.1210	3.15	3.10	1 1/4	1210	A1	-	3/32	1	-	1.40
2-3V335TL.1610	3.35	3.30	1 5/8	1610	A1	-	3/32	1	-	1.50
2-3V365TL.1610	3.65	3.60	1 5/8	1610	A1	-	3/32	1	-	1.60
2-3V412TL.1610	4.12	4.07	1 5/8	1610	A1	-	3/32	1	-	2.10
2-3V450TL.1610	4.50	4.45	1 5/8	1610	A1	-	3/32	1	-	2.70
2-3V475TL.1610	4.75	4.70	1 5/8	1610	A1	-	3/32	1	-	3.10
2-3V500TL.1610	5.00	4.95	1 5/8	1610	A1	-	3/32	1	-	3.60
2-3V530TL.1610	5.30	5.25	1 5/8	1610	A1	-	3/32	1	-	4.20
2-3V560TL.1610	5.60	5.55	1 5/8	1610	A1	-	3/32	1	-	4.80
2-3V600TL.1610	6.00	5.95	1 5/8	1610	A1	-	3/32	1	-	5.80
2-3V650TL.1610	6.50	6.45	1 5/8	1610	A1	-	3/32	1	-	7.00
2-3V690TL.1610	6.90	6.85	1 5/8	1610	A2	3 5/16	3/32	1	-	8.00
2-3V800TL.2517ANSI	8.00	7.95	2 1/2	2517	B2	4 3/4	-	1 3/4	21/32	11.00
2-3V1060TL.2517ANSI	10.60	10.55	2 1/2	2517	B2	4 3/4	-	1 3/4	21/32	15.00
2-3V1400TL.2517ANSI	14.00	13.95	2 1/2	2517	B3	4 3/4	-	1 3/4	21/32	22.00
2-3V1900TL.3020	19.00	18.45	3	3020	B3	5 11/16	-	2	29/32	32.00
2-3V2500TL.3020	25.00	24.95	3	3020	C3	5 11/16	1/8	2	25/32	45.00

Note: Pulleys prepared for bushings type 2517 and 3535 use ANSI Taper-Lock® Bushings with 1/2" x 13tpi UNC threads.

# ANSI (Inch) Taper-Bushing V-Belt Sheaves

## 3V-5V-8V Cast Iron Sheaves

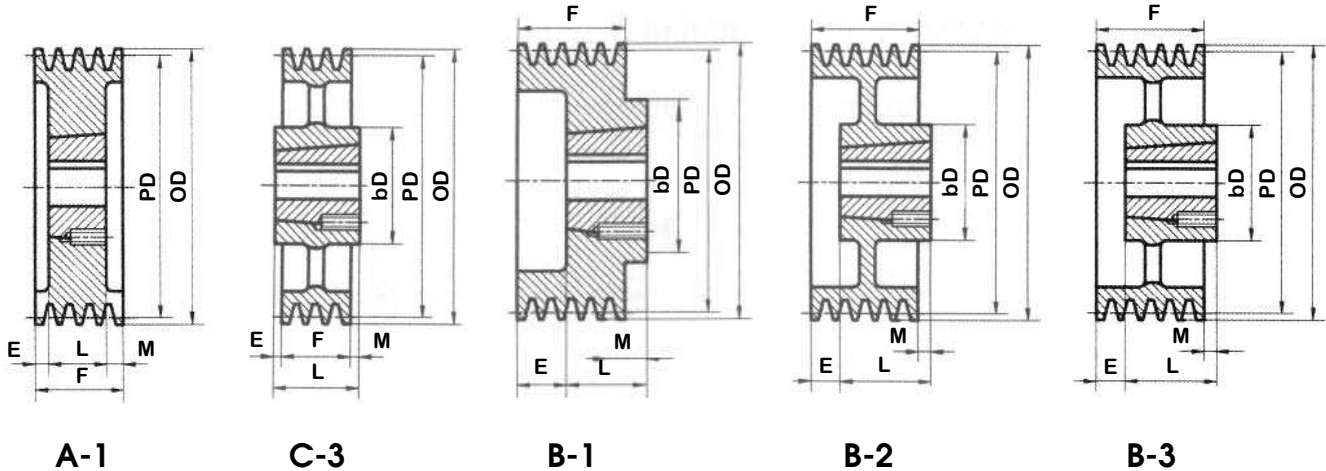

### 3V-3

F = 1 1/2"

Part No.	OD	PD	Bush Max Bore	Bush	Type	bD	E	L	M	Wt Less Bush
3-3V265TL.1108	2.65	2.60	1 1/8	1108	A1	-	5/8	7/8	-	1.00
3-3V280TL.1108	2.80	2.75	1 1/8	1108	A1	-	5/8	7/8	-	1.10
3-3V300TL.1210	3.00	2.95	1 1/4	1210	A1	-	1/2	1	-	1.80
3-3V315TL.1210	3.15	3.10	1 1/4	1210	A1	-	1/2	1	-	1.80
3-3V335TL.1610	3.35	3.30	1 5/8	1610	A1	-	1/2	1	-	1.90
3-3V365TL.1610	3.65	3.60	1 5/8	1610	A1	-	1/2	1	-	2.00
3-3V412TL.1610	4.12	4.07	1 5/8	1610	A1	-	1/2	1	-	2.60
3-3V450TL.1610	4.50	4.45	1 5/8	1610	A1	-	1/2	1	-	3.20
3-3V475TL.1610	4.75	4.70	1 5/8	1610	A1	-	1/2	1	-	3.70
3-3V500TL.1610	5.00	4.95	1 5/8	1610	A1	-	1/2	1	-	4.20
3-3V530TL.1610	5.30	5.25	1 5/8	1610	A1	-	1/2	1	-	4.80
3-3V560TL.1610	5.60	5.55	1 5/8	1610	A1	-	1/2	1	-	5.50
3-3V600TL.2517ANSI	6.00	5.95	2 1/2	2517	B1	4 3/4	-	1 3/4	1/4	7.40
3-3V650TL.2517ANSI	6.50	6.45	2 1/2	2517	B1	4 3/4	-	1 3/4	1/4	9.10
3-3V690TL.2517ANSI	6.90	6.85	2 1/2	2517	B1	4 3/4	-	1 3/4	1/4	10.00
3-3V800TL.2517ANSI	8.00	7.95	2 1/2	2517	B2	4 3/4	-	1 3/4	1/4	15.00
3-3V1060TL.2517ANSI	10.60	10.55	2 1/2	2517	B2	4 3/4	-	1 3/4	1/4	18.00
3-3V1400TL.2517ANSI	14.00	13.95	2 1/2	2517	B3	4 3/4	-	1 3/4	1/4	25.00
3-3V1900TL.3020	19.00	18.45	3	3020	B3	5 11/16	-	2	1/2	34.00
3-3V2500TL.3020	25.00	24.95	3	3020	B3	5 11/16	-	2	1/2	49.00
3-3V3350TL.3020	33.50	33.45	3	3020	C3	5 11/16	1/4	2	1/4	67.00

Note: Pulleys prepared for bushings type 2517 and 3535 use ANSI Taper-Lock® Bushings with 1/2" x 13tpi UNC threads.

# ANSI (Inch) Taper-Bushing V-Belt Sheaves

## 3V-5V-8V Cast Iron Sheaves

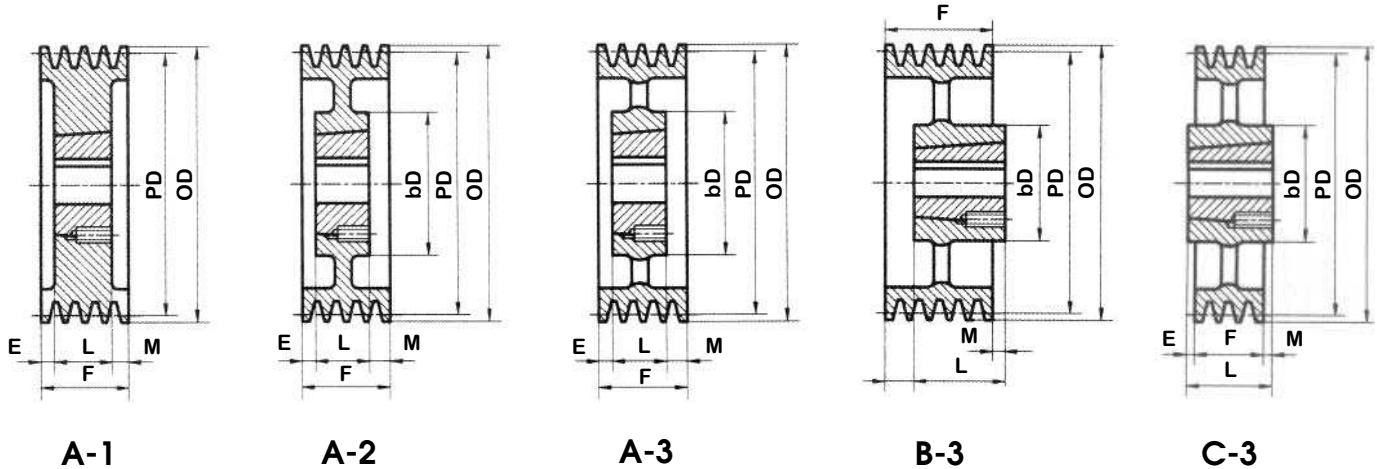

### 3V-5

F = 2 5/16"

Part No.	OD	PD	Bush Max Bore	Bush	Type	bD	E	L	M	Wt Less Bush
5-3V475TL.2517ANSI	4.75	4.70	2 1/2	2517	A1	-	9/16	1 3/4	-	3.80
5-3V500TL.2517ANSI	5.00	4.95	2 1/2	2517	A1	-	9/16	1 3/4	-	4.80
5-3V530TL.2517ANSI	5.30	5.25	2 1/2	2517	A1	-	9/16	1 3/4	-	5.90
5-3V560TL.2517ANSI	5.60	5.55	2 1/2	2517	A1	-	9/16	1 3/4	-	7.00
5-3V600TL.2517ANSI	6.00	5.95	2 1/2	2517	A1	-	9/16	1 3/4	-	8.70
5-3V650TL.2517ANSI	6.50	6.45	2 1/2	2517	A1	-	9/16	1 3/4	-	11.00
5-3V690TL.2517ANSI	6.90	6.85	2 1/2	2517	A1	-	9/16	1 3/4	-	13.00
5-3V800TL.2517ANSI	8.00	7.95	2 1/2	2517	A2	4 3/4	9/16	1 3/4	-	19.00
5-3V1060TL.2517ANSI	10.60	10.55	2 1/2	2517	A2	4 3/4	9/16	1 3/4	-	26.00
5-3V1400TL.2517ANSI	14.00	13.95	2 1/2	2517	A3	4 3/4	-	1 3/4	9/16	34.00
5-3V1900TL.3030	19.00	18.95	3	3030	B3	5 11/16	-	3	11/16	47.00
5-3V2500TL.3030	25.00	24.95	3	3030	B3	5 11/16	-	3	11/16	66.00
5-3V3350TL.3030	33.50	33.45	3	3030	C3	5 11/16	11/32	3	11/32	86.00

Note: Pulleys prepared for bushings type 2517 and 3535 use ANSI Taper-Lock® Bushings with 1/2" x 13tpi UNC threads.

### 3V-6

F = 2 23/32"

Part No.	OD	PD	Bush Max Bore	Bush	Type	bD	E	L	M	Wt Less Bush
6-3V475TL.2517ANSI	4.75	4.70	2 1/2	2517	A1	-	31/32	1 3/4	-	4.40
6-3V500TL.2517ANSI	5.00	4.95	2 1/2	2517	A1	-	31/32	1 3/4	-	5.40
6-3V530TL.2517ANSI	5.30	5.25	2 1/2	2517	A1	-	31/32	1 3/4	-	6.50
6-3V560TL.2517ANSI	5.60	5.55	2 1/2	2517	A1	-	31/32	1 3/4	-	7.50
6-3V600TL.2517ANSI	6.00	5.95	2 1/2	2517	A1	-	31/32	1 3/4	-	9.50
6-3V650TL.2517ANSI	6.50	6.45	2 1/2	2517	A1	-	31/32	1 3/4	-	12.00
6-3V690TL.2517ANSI	6.90	6.85	2 1/2	2517	A1	31/32	-	1 3/4	-	13.00
6-3V800TL.2517ANSI	8.00	7.95	2 1/2	2517	A1	4 3/4	31/32	1 3/4	-	20.00
6-3V1060TL.2517ANSI	10.60	10.55	2 1/2	2517	A2	4 3/4	31/32	1 3/4	-	29.00
6-3V1400TL.2517ANSI	14.00	13.95	2 1/2	2517	A3	4 3/4	-	1 3/4	31/32	41.00
6-3V1900TL.3030	19.00	18.95	3	3030	B3	5 11/16	-	3	9/32	51.00
6-3V2500TL.3030	25.00	24.95	3	3030	B3	5 11/16	-	3	9/32	72.00
6-3V3350TL.3030	33.50	33.45	3	3030	C3	5 11/16	9/64	3	9/54	92.00

Note: Pulleys prepared for bushings type 2517 and 3535 use ANSI Taper-Lock® Bushings with 1/2" x 13tpi UNC threads.



# ANSI (Inch) Taper-Bushing V-Belt Sheaves

## 3V-5V-8V Cast Iron Sheaves

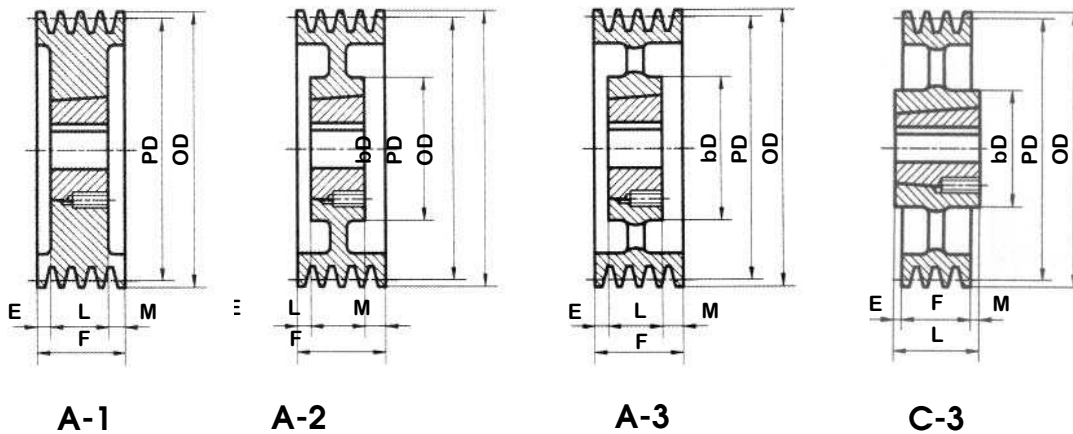

### 3V-8

F = 3 17/32"

Part No.	OD	PD	Bush Max Bore	Bush	Type	bD	E	L	M	Wt Less Bush
8-3V475TL.2517ANSI	4.75	4.70	2 1/2	2517	A1	-	1 25/32	1 3/4	-	5.80
8-3V500TL.2517ANSI	5.00	4.95	2 1/2	2517	A1	-	1 25/32	1 3/4	-	6.40
8-3V530TL.2517ANSI	5.30	5.25	2 1/2	2517	A1	-	1 1/32	1 3/4	3/4	7.80
8-3V560TL.2517ANSI	5.60	5.55	2 1/2	2517	A1	-	1/4	1 3/4	1 17/32	9.20
8-3V600TL.2517ANSI	6.00	5.95	2 1/2	2517	A1	-	1/4	1 3/4	1 17/32	11.00
8-3V650TL.2517ANSI	6.50	6.45	2 1/2	2517	A1	-	1/4	1 3/4	1 17/32	14.00
8-3V690TL.2517ANSI	6.90	6.85	2 1/2	2517	A1	-	1/4	1 3/4	1 17/32	16.00
8-3V800TL.3020	8.00	7.95	3	3020	A1	-	1/2	2	1 1/32	22.00
8-3V1060TL.3020	10.60	10.55	3	3020	A2	5 11/16	1/2	2	1 1/32	28.00
8-3V1400TL.3020	14.00	13.95	3	3020	A3	5 11/16	21/32	2	7/8	52.00
8-3V1900TL.3535ANSI	19.00	18.95	3 15/16	3535	A3	6 1/2	-	3 1/2	1/32	67.00
8-3V2500TL.3535ANSI	25.00	24.95	3 15/16	3535	A3	6 1/2	-	3 1/2	1/32	93.00
8-3V3350TL.4040	33.50	33.45	4 7/16	4040	C3	7 3/16	15/64	4	15/64	157.00

Note: Pulleys prepared for bushings type 2517 and 3535 use ANSI Taper-Lock® Bushings with 1/2" x 13tpi UNC threads.

### 3V-10

F = 4 11/32"

Part No.	OD	PD	Bush Max Bore	Bush	Type	bD	E	L	M	Wt Less Bush
10-3V475TL.2517ANSI	4.75	4.70	2 1/2	2517	A1	-	2 19/32	1 3/4	-	7.00
10-3V500TL.2517ANSI	5.00	4.95	2 1/2	2517	A1	-	2 19/32	1 3/4	-	8.00
10-3V530TL.2517ANSI	5.30	5.25	2 1/2	2517	A1	-	1 27/32	1 3/4	3/4	9.00
10-3V560TL.2517ANSI	5.60	5.55	2 1/2	2517	A1	-	1/2	1 3/4	2 3/32	11.00
10-3V600TL.2517ANSI	6.00	5.95	2 1/2	2517	A1	-	1/2	1 3/4	2 3/32	13.00
10-3V650TL.2517ANSI	6.50	6.45	2 1/2	2517	A1	-	1/2	1 3/4	2 3/32	15.00
10-3V690TL.2517ANSI	6.90	6.85	2 1/2	2517	A1	-	1/2	1 3/4	2 3/32	18.00
10-3V800TL.3020	8.00	7.95	3	3020	A1	-	27/32	2	1 1/2	23.00
10-3V1060TL.3020	10.60	10.55	3	3020	A2	5 11/16	27/32	2	1 1/2	31.00
10-3V1400TL.3535ANSI	14.00	13.95	3 15/16	3535	A2	6 1/2	-	3 1/2	27/32	50.00
10-3V1900TL.3535ANSI	19.00	18.95	3 15/16	3535	A3	6 1/2	-	3 1/2	27/32	75.00
10-3V2250TL.4040	25.00	24.95	4 7/16	4040	A3	7 3/16	-	4	11/32	122.00
10-3V3350TL.4040	33.50	33.45	4 7/16	4040	C3	7 3/16	11/64	4	11/64	172.00

Note: Pulleys prepared for bushings type 2517 and 3535 use ANSI Taper-Lock® Bushings with 1/2" x 13tpi UNC threads.

# ANSI (Inch) Taper-Bushing V-Belt Sheaves 3V-5V-8V Cast Iron Sheaves

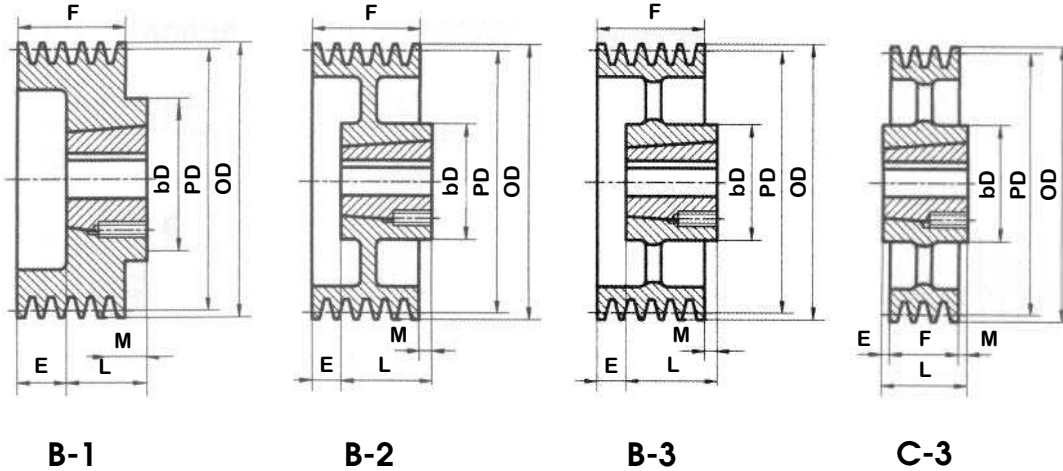

5V-2

F = 1 11/16"

Part No.	OD	PD	Bush Max Bore	Bush	Type	bD	E	L	M	Wt Less Bush
2-5V710TL.2517ANSI	7.10	7.00	2 1/2	2517	B1	-	1/16	1 3/4	-	10.00
2-5V750TL.2517ANSI	7.50	7.40	2 1/2	2517	B1	-	1/16	1 3/4	-	12.00
2-5V800TL.2517ANSI	8.00	7.90	2 1/2	2517	B1	-	1/16	1 3/4	-	14.00
2-5V850TL.2517ANSI	8.50	8.40	2 1/2	2517	B2	4 3/4	1/16	1 3/4	-	15.00
2-5V900TL.2517ANSI	9.00	8.90	2 1/2	2517	B2	4 3/4	1/16	1 3/4	-	16.00
2-5V975TL.3020	9.75	9.65	3	3020	B1	-	-	2	5/16	19.00
2-5V1030TL.3020	9.75	10.20	3	3020	B2	5 11/16	-	2	5/16	22.00
2-5V1090TL.3020	10.30	10.80	3	3020	B2	5 11/16	-	2	5/16	24.00
2-5V1180TL.3020	10.90	11.70	3	3020	B2	5 11/16	-	2	5/16	26.00
2-5V1250TL.3020	11.80	12.40	3	3020	B2	5 11/16	-	2	5/16	28.00
2-5V1320TL.3020	12.50	13.10	3	3020	B3	5 11/16	-	2	5/16	29.00
2-5V1400TL.3020	13.20	13.90	3	3020	B3	5 11/16	-	2	5/16	33.00
2-5V1500TL.3020	14.00	14.90	3	3020	B3	5 11/16	-	2	5/16	35.00
2-5V1600TL.3020	15.00	15.90	3	3020	B3	5 11/16	-	2	5/16	45.00
2-5V2120TL.3535ANSI	16.00	21.10	3 1/2	3535	C3	6 1/2	3/8	3 1/2	1 7/16	68.00
2-5V2800TL.3535ANSI	28.00	27.90	3 1/2	3535	C3	6 1/2	3/8	3 1/2	1 7/16	96.00

Note: Pulleys prepared for bushings type 2517 and 3535 use ANSI Taper-Lock® Bushings with 1/2" x 13tpi UNC threads.

# ANSI (Inch) Taper-Bushing V-Belt Sheaves

## 3V-5V-8V Cast Iron Sheaves

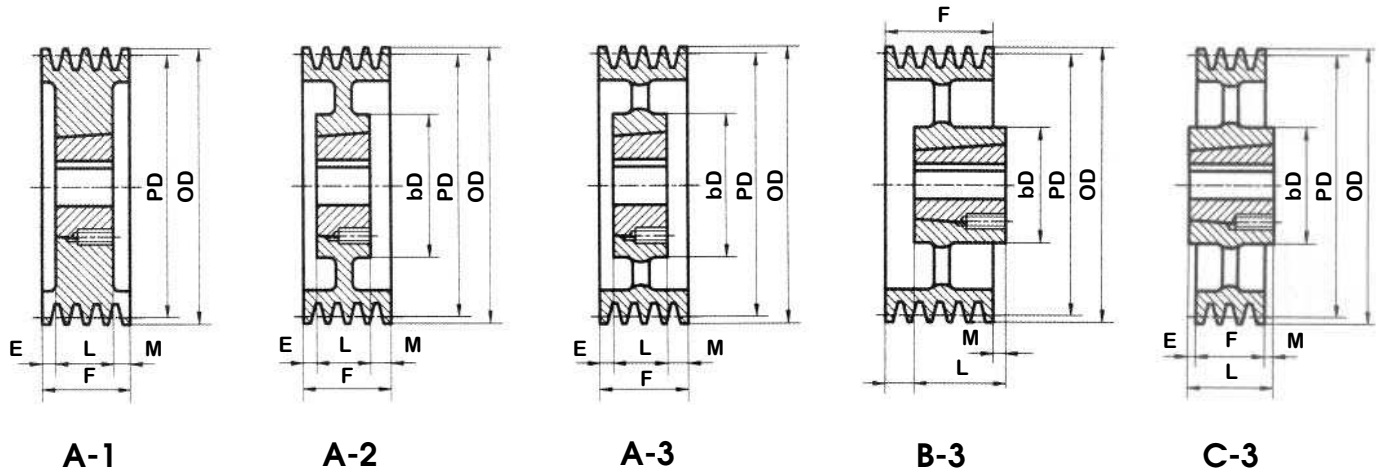

### 5V-3

F = 2 3/8"

Part No.	OD	PD	Bush Max Bore	Bush	Type	bD	E	L	M	Wt Less Bush
3-5V710TL.2517ANSI	7.10	7.00	2 1/2	2517	A1	-	5/8	1 3/4	-	11.00
3-5V750TL.2517ANSI	7.50	7.40	2 1/2	2517	A1	-	5/8	1 3/4	-	14.00
3-5V800TL.2517ANSI	8.00	7.90	2 1/2	2517	A1	-	5/8	1 3/4	-	16.00
3-5V850TL.2517ANSI	8.50	8.40	2 1/2	2517	A2	4 3/4	5/8	1 3/4	-	17.00
3-5V900TL.2517ANSI	9.00	8.90	2 1/2	2517	A2	4 3/4	5/8	1 3/4	-	19.00
3-5V975TL.3020	9.75	9.65	3	3020	A1	-	-	2	3/8	24.00
3-5V1030TL.3020	10.30	10.20	3	3020	A2	5 11/16	-	2	3/8	27.00
3-5V1090TL.3020	10.90	10.80	3	3020	A2	5 11/16	-	2	3/8	28.00
3-5V1180TL.3020	11.80	11.70	3	3020	A2	5 11/16	-	2	3/8	30.00
3-5V1250TL.3020	12.50	12.40	3	3020	A2	5 11/16	-	2	3/8	32.00
3-5V1320TL.3020	13.20	13.10	3	3020	A2	5 11/16	-	2	3/8	34.00
3-5V1400TL.3020	14.00	13.90	3	3020	A3	5 11/16	-	2	3/8	36.00
3-5V1500TL.3020	15.00	14.90	3	3020	A3	5 11/16	-	2	3/8	41.00
3-5V1600TL.3020	16.00	15.90	3	3020	A3	5 11/16	-	2	3/8	50.00
3-5V2120TL.3535ANSI	21.20	21.10	3 15/16	3535	B3	6 1/2	-	3 1/2	1 1/8	65.00
3-5V2800TL.3535ANSI	28.00	27.90	3 15/16	3535	B3	6 1/2	-	3 1/2	1 1/8	99.00
3-5V3750TL.4040	37.50	37.40	4 7/16	4040	C3	7 3/16	1/2	4	1 1/8	172.00
3-5V5000TL.4040	40.00	49.40	4 7/16	4040	C3	7 3/16	1/2	4	1 1/8	201.00

Note: Pulleys prepared for bushings type 2517 and 3535 use ANSI Taper-Lock® Bushings with 1/2" x 13tpi UNC threads.

# ANSI (Inch) Taper-Bushing V-Belt Sheaves

## 3V-5V-8V Cast Iron Sheaves

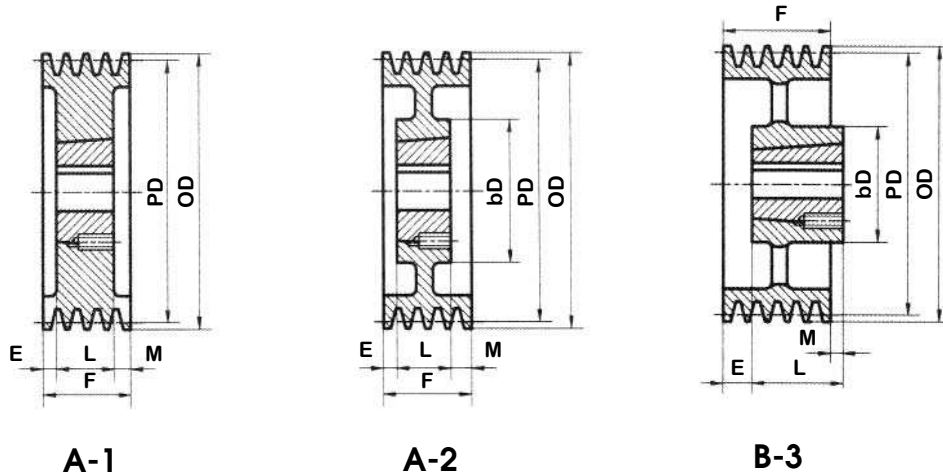

### 5V-4

F = 3 1/16"

Part No.	OD	PD	Bush Max Bore	Bush	Type	bD	E	L	M	Wt Less Bush
4-5V710TL.2517ANSI	7.10	7.00	2 1/2	2517	A1	-	1 5/16	1 3/4	-	14.00
4-5V750TL.2517ANSI	7.50	7.40	2 1/2	2517	A1	-	1 5/16	1 3/4	-	16.00
4-5V800TL.2517ANSI	8.00	7.90	2 1/2	2517	A1	-	1 5/16	1 3/4	-	17.00
4-5V850TL.2517ANSI	8.50	8.40	2 1/2	2517	A2	4 3/4	1 5/16	1 3/4	-	18.00
4-5V900TL.2517ANSI	9.00	8.90	2 1/2	2517	A2	4 3/4	1 5/16	1 3/4	-	19.00
4-5V975TL.3020	9.75	9.65	3	3020	A1	-	1/2	2	9/16	27.00
4-5V1030TL.3020	10.30	10.20	3	3020	A2	5 11/16	1/2	2	9/16	28.00
4-5V1090TL.3020	10.90	10.80	3	3020	A2	5 11/16	1/2	2	9/16	31.00
4-5V1180TL.3020	11.80	11.70	3	3020	A2	5 11/16	1/2	2	9/16	35.00
4-5V1250TL.3030	12.50	12.40	3	3030	A2	5 11/16	-	23	1/16	44.00
4-5V1320TL.3030	13.20	13.10	3 15/16	3030	A2	5 11/16	-	3	1/16	48.00
4-5V1400TL.3535ANSI	14.00	13.90	3 15/16	3535	B3	6 1/2	-	3 1/2	7/16	52.00
4-5V1500TL.3535ANSI	15.00	14.90	3 15/16	3535	B3	6 1/2	-	3 1/2	7/16	54.00
4-5V1600TL.3535ANSI	16.00	15.90	3 15/16	3535	B3	6 1/2	-	3 1/2	7/16	60.00
4-5V2120TL.3535ANSI	21.20	21.10	3 15/16	3535	B3	6 1/2	-	3 1/2	7/16	72.00
4-5V2800TL.3535ANSI	28.00	27.90	3 15/16	3535	B3	6 1/2	-	3 1/2	7/16	125.00
4-5V3750TL.4040	37.50	37.40	4 7/16	4040	B3	7 3/16	-	4	15/16	189.00
4-5V5000TL.4040	50.00	49.90	4 7/16	4040	B3	7 3/16	-	4	15/16	371.00

Note: Pulleys prepared for bushings type 2517 and 3535 use ANSI Taper-Lock® Bushings with 1/2" x 13tpi UNC threads.

# ANSI (Inch) Taper-Bushing V-Belt Sheaves

## 3V-5V-8V Cast Iron Sheaves

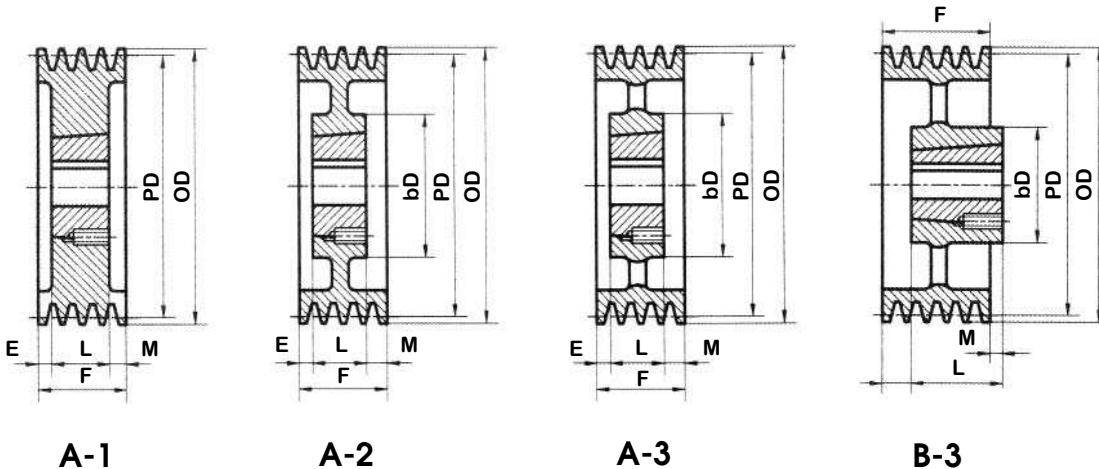

### 5V-5

F = 3 3/4"

Part No.	OD	PD	Bush Max Bore	Bush	Type	bD	E	L	M	Wt Less Bush
5-5V710TL.3020	7.10	7.00	3	3020	A1	-	1/2	2	1 1/4	15.00
5-5V750TL.3020	7.50	7.40	3	3020	A1	-	1/2	2	1 1/4	17.00
5-5V800TL.3020	8.00	7.90	3	3020	A1	-	1/2	2	1 1/4	20.00
5-5V850TL.3020	8.50	8.40	3	3020	A1	-	1/2	2	1 1/4	22.00
5-5V900TL.3020	9.00	8.90	3	3020	A1	-	1/2	2	1 1/4	30.00
5-5V975TL.3020	9.75	9.65	3	3020	A1	-	-	2	1 1/4	37.00
5-5V1030TL.3020	10.30	10.20	3	3020	A2	5 3/4	-	2	1 1/4	38.00
5-5V1090TL.3020	10.90	10.80	3	3020	A2	5 3/4	-	2	1 1/4	39.00
5-5V1180TL.3020	11.80	11.70	3	3020	A2	5 3/4	-	2	1 1/4	40.00
5-5V1250TL.3535ANSI	12.50	12.40	3 1/2	3535	A2	6 1/2	-	3 1/2	1/4	50.00
5-5V1320TL.3535ANSI	13.20	13.10	3 1/2	3535	A2	6 1/2	-	3 1/2	1/4	56.00
5-5V1400TL.3535ANSI	14.00	13.90	3 1/2	3535	A3	6 1/2	-	3 1/2	1/4	58.00
5-5V1500TL.3535ANSI	15.00	14.90	3 1/2	3535	A3	6 1/2	-	3 1/2	1/4	60.00
5-5V1600TL.3535ANSI	16.00	15.90	3 1/2	3535	A3	6 1/2	-	3 1/2	1/4	70.00
5-5V2120TL.4040	21.20	21.10	4 7/16	4040	B3	7 3/16	-	4	1/4	115.00
5-5V2800TL.4040	28.00	27.90	4 7/16	4040	B3	7 3/16	-	4	1/4	160.00
5-5V3750TL.4040	37.50	37.40	4 7/16	4040	B3	7 3/16	-	4	1/4	182.00
5-5V5000TL.4545	40.00	49.40	4 1/2	4545	B3	8 7/16	-	4 1/2	3/4	288.00

Note: Pulleys prepared for bushings type 2517 and 3535 use ANSI Taper-Lock® Bushings with 1/2" x 13tpi UNC threads.

# ANSI (Inch) Taper-Bushing V-Belt Sheaves

## 3V-5V-8V Cast Iron Sheaves

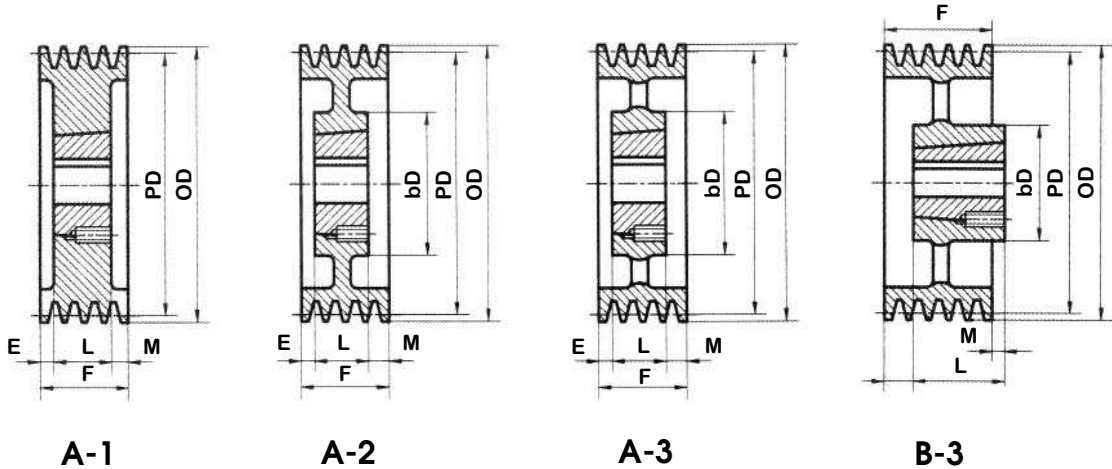

### 5V-6

F = 4 7/16"

Part No.	OD	PD	Bush Max Bore	Bush	Type	bD	E	L	M	Wt Less Bush
6-5V710TL.3020	7.10	7.00	3	3020	A1	-	3/4	2	1 11/16	17.00
6-5V750TL.3020	7.50	7.40	3	3020	A1	-	3/4	2	1 11/16	20.00
6-5V800TL.3020	8.00	7.90	3	3020	A1	-	3/4	2	1 11/16	24.00
6-5V850TL.3020	8.50	8.40	3	3020	A1	-	3/4	2	1 11/16	28.00
6-5V900TL.3020	9.00	8.90	3	3020	A1	-	3/4	2	1 11/16	32.00
6-5V975TL.3535ANSI	9.75	9.65	3 1/2	3535	A1	-	-	3 1/2	15/16	50.00
6-5V1030TL.3535ANSI	10.30	10.20	3 1/2	3535	A2	-	-	3 1/2	15/16	58.00
6-5V1090TL.3535ANSI	10.90	10.80	3 1/2	3535	A2	-	-	3 1/2	15/16	60.00
6-5V1180TL.3535ANSI	11.80	11.70	3 1/2	3535	A2	6 1/2	-	3 1/2	15/16	62.00
6-5V1250TL.3535ANSI	12.50	12.40	3 1/2	3535	A2	6 1/2	-	3 1/2	15/16	65.00
6-5V1320TL.3535ANSI	13.20	13.10	3 1/2	3535	A2	6 1/2	-	3 1/2	15/16	68.00
6-5V1400TL.3535ANSI	14.00	13.90	3 1/2	3535	B3	6 1/2	-	3 1/2	15/16	72.00
6-5V1500TL.4040	15.00	14.90	4	4040	B3	7 3/16	-	4	7/16	91.00
6-5V1600TL.4040	16.00	15.90	4	4040	A3	7 3/16	-	4	7/16	97.00
6-5V2120TL.4040	21.20	21.10	4	4040	A3	7 3/16	-	4	7/16	123.00
6-5V2800TL.4040	28.00	27.90	4	4040	A3	7 3/16	-	4	7/16	176.00
6-5V3750TL.4545	37.50	37.40	4 1/2	4545	B3	8 7/16	-	4 1/2	1/16	254.00
6-5V5000TL.4545	50.00	49.90	4 1/2	4545	B3	8 7/16	-	4 1/2	1/16	286.00

Note: Pulleys prepared for bushings type 2517 and 3535 use ANSI Taper-Lock® Bushings with 1/2" x 13tpi UNC threads.

# ANSI (Inch) Taper-Bushing V-Belt Sheaves

## 3V-5V-8V Cast Iron Sheaves

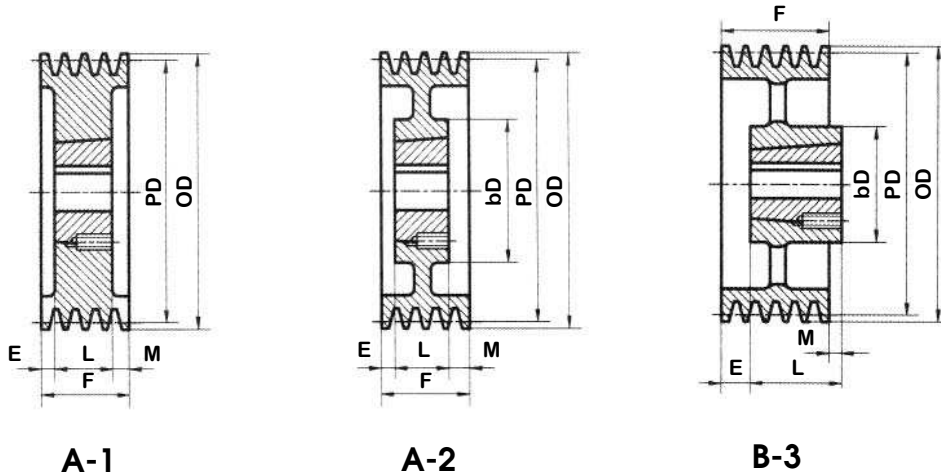

### 5V-8

**F = 5 13/16"**

Part No.	OD	PD	Bush Max Bore	Bush	Type	bD	E	L	M	Wt Less Bush
8-5V710TL.3030	7.10	7.00	3	3030	A1	-	1	3	1 13/16	24.00
8-5V750TL.3030	7.50	7.40	3	3030	A1	-	1	3	1 13/16	27.00
8-5V800TL.3030	8.00	7.90	3	3030	A1	-	1	3	1 13/16	33.00
8-5V850TL.3030	8.50	8.40	3	3030	A1	-	1	3	1 13/16	39.00
8-5V900TL.3535ANSI	9.00	8.90	3 1/2	3535	A1	-	1	3 1/2	1 5/16	44.00
8-5V975TL.3535ANSI	9.75	9.65	3 1/2	3535	A1	-	1	3 1/2	1 5/16	55.00
8-5V1030TL.3535ANSI	10.30	10.20	3 1/2	3535	A1	-	1	3 1/2	1 5/16	64.00
8-5V1090TL.3535ANSI	10.90	10.80	3 1/2	3535	A1	-	1	3 1/2	1 5/16	68.00
8-5V1180TL.3535ANSI	11.80	11.70	3 1/2	3535	A1	-	1	3 1/2	1 5/16	74.00
8-5V1250TL.4040	12.50	12.40	4	4040	A1	-	1/4	4	1 9/16	82.00
8-5V1320TL.4040	13.20	13.10	4	4040	A1	-	1/4	4	1 9/16	87.00
8-5V1400TL.4040	14.00	13.90	4	4040	A2	7 3/16	1/4	4	1 9/16	90.00
8-5V1500TL.4040	15.00	14.90	4	4040	A2	7 3/16	1/4	4	1 9/16	97.00
8-5V1600TL.4040	16.00	15.90	4	4040	A3	7 3/16	1/4	4	1 9/16	106.00
8-5V2120TL.4040	21.20	21.10	4	4040	A3	7 3/16	1/4	4	1 9/16	144.00
8-5V2800TL.4545	28.00	27.90	4 1/2	4545	A3	8 7/16	1/4	4 1/2	1 1/16	206.00
8-5V3750TL.4545	37.50	37.40	4 1/2	4545	A3	8 7/16	1/4	4 1/2	1 1/16	271.00
8-5V5000TL.4545	50.00	49.90	4 1/2	4545	A3	8 7/16	1/4	4 1/2	1 1/16	458.00

### 5V-10

**F = 7 3/16"**

Part No.	OD	PD	Bush Max Bore	Bush	Type	bD	E	L	M	Wt Less Bush
10-5V800TL.3030	8.00	7.90	3	3030	A1	-	1	3	3 3/16	36.00
10-5V850TL.3030	8.50	8.40	3	3030	A1	-	1	3	3 3/16	42.00
10-5V900TL.3535ANSI	9.00	8.90	3 1/2	3535	A1	-	1	3 1/2	2 11/16	48.00
10-5V975TL.4040	9.75	9.65	4	4040	A1	-	1	4	2 3/16	58.00
10-5V1030TL.4040	10.30	10.20	4	4040	A1	-	1	4	2 3/16	69.00
10-5V1090TL.4040	10.90	10.80	4	4040	A1	-	1	4	2 3/16	76.00
10-5V1180TL.4040	11.80	11.70	4	4040	A1	-	1	4	2 3/16	96.00
10-5V1250TL.4040	12.50	12.40	4	4040	A2	7 3/16	3/4	4	2 7/16	116.00
10-5V1320TL.4040	13.20	13.10	4	4040	A2	7 3/16	3/4	4	2 7/16	130.00
10-5V1400TL.4545	14.00	13.90	4 1/2	4545	A2	8 7/16	3/4	4 1/2	1 15/16	150.00
10-5V1500TL.4545	15.00	14.90	4 1/2	4545	A2	8 7/16	3/4	4 1/2	1 15/16	155.00
10-5V1600TL.4545	16.00	15.90	4 1/2	4545	A2	8 7/16	3/4	4 1/2	1 15/16	160.00
10-5V2120TL.4545	21.20	21.10	4 1/2	4545	A3	8 7/16	3/4	4 1/2	1 15/16	210.00
10-5V2800TL.4545	28.00	27.90	4 1/2	4545	A3	8 7/16	3/4	4 1/2	1 15/16	248.00
10-5V3750TL.4545	37.50	37.40	4 1/2	4545	A3	8 7/16	3/4	4 1/2	1 15/16	375.00
10-5V5000TL.5050	50.00	49.90	5	5050	A3	10	3/4	5	1 7/16	502.00

Note: Pulleys prepared for bushings type 2517 and 3535 use ANSI Taper-Lock® Bushings with 1/2" x 13tpi UNC threads.

# ANSI (Inch) Taper-Bushing V-Belt Sheaves 3V-5V-8V Cast Iron Sheaves

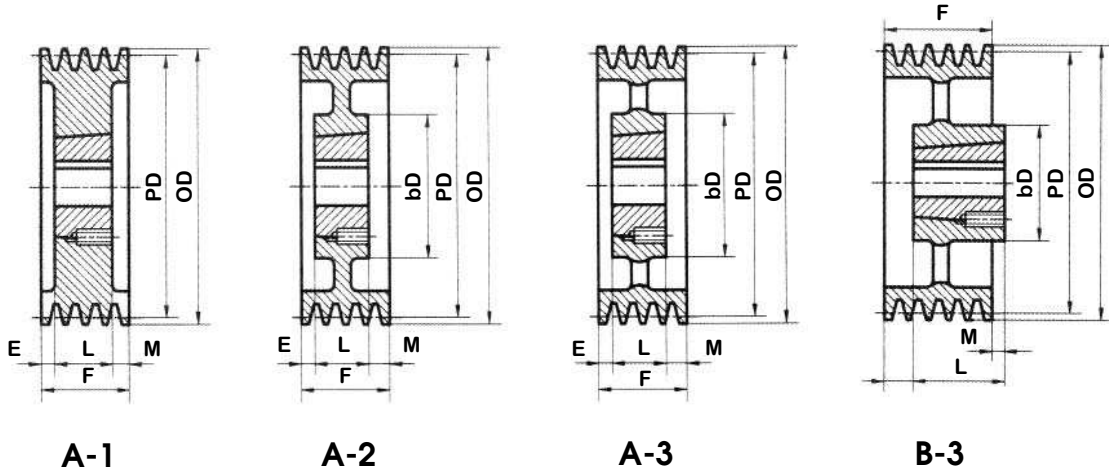

## 8V-4

F = 4 7/8"

Part No.	OD	PD	Bush Max Bore	Bush	Type	bD	E	L	M	Wt Less Bush
4-8V1250TL.4040	12.50	12.30	4	4040	A1	-	-	4	7/8	88.00
4-8V1320TL.4040	13.20	13.00	4	4040	A1	-	-	4	7/8	102.00
4-8V1400TL.4040	14.00	13.80	4	4040	A1	-	-	4	7/8	123.00
4-8V1500TL.4040	15.00	14.80	4	4040	A1	-	-	4	7/8	145.00
4-8V1600TL.4040	16.00	15.80	4	4040	A2	8 7/16	-	4	7/8	111.00
4-8V1700TL.4040	17.00	16.80	4	4040	A2	8 7/16	-	4	7/8	120.00
4-8V1800TL.4040	18.00	17.80	4	4040	A2	8 7/16	-	4	7/8	130.00
4-8V1900TL.4040	19.00	18.80	4	4040	A2	8 7/16	-	4	7/8	140.00
4-8V2000TL.4545	20.00	19.80	4 1/2	4545	A2	8 7/16	-	4 1/2	3/8	151.00
4-8V2120TL.4545	21.20	21.00	4 1/2	4545	A3	8 7/16	-	4 1/2	3/8	154.00
4-8V2240TL.4545	22.40	22.20	4 1/2	4545	A3	8 7/16	-	4 1/2	3/8	185.00
4-8V3000TL.5050	30.00	29.80	5	5050	B3	10	-	5	1/8	246.00
4-8V4000TL.5050	40.00	39.80	5	5050	B3	10	-	5	1/8	292.00
4-8V5300TL.5050	53.00	52.80	5	5050	B3	10	-	5	1/8	573.00

Note: Pulleys prepared for bushings type 2517 and 3535 use ANSI Taper-Lock® Bushings with 1/2" x 13tpi UNC threads.

## 8V-5

F = 6"

Part No.	OD	PD	Bush Max Bore	Bush	Type	bD	E	L	M	Wt Less Bush
5-8V1250TL.4040	12.50	12.30	4	4040	A1	-	3/16	4	1 13/16	100.00
5-8V1320TL.4040	13.20	13.00	4	4040	A1	-	3/16	4	1 13/16	115.00
5-8V1400TL.4040	14.00	13.80	4	4040	A1	-	3/16	4	1 13/16	133.00
5-8V1500TL.4040	15.00	14.80	4	4040	A1	-	3/16	4	1 13/16	156.00
5-8V1600TL.4040	16.00	15.80	4	4040	A1	-	1/2	4	1 1/2	181.00
5-8V1700TL.4545	17.00	16.80	4	4545	A2	8 7/16	-	4 1/2	1 1/2	146.00
5-8V1800TL.4545	18.00	17.80	4	4545	A2	8 7/16	-	4 1/2	1 1/2	156.00
5-8V1900TL.4545	19.00	18.80	4	4545	A2	8 7/16	-	4 1/2	1 1/2	176.00
5-8V2000TL.4545	20.00	19.80	4 1/2	4545	A2	8 7/16	-	4 1/2	1 1/2	196.00
5-8V2120TL.4545	21.20	21.00	4 1/2	4545	A3	8 7/16	-	4 1/2	1 1/2	195.00
5-8V2240TL.4545	22.40	22.20	4 1/2	4545	A3	8 7/16	-	4 1/2	1 1/2	200.00
5-8V3000TL.5050	30.00	29.80	5	5050	A3	10	-	5	1	278.00
5-8V4000TL.5050	40.00	39.80	5	5050	A3	10	-	5	1	350.00
5-8V5300TL.5050	53.00	52.80	5	5050	A3	10	-	5	1	565.00

Note: Pulleys prepared for bushings type 2517 and 3535 use ANSI Taper-Lock® Bushings with 1/2" x 13tpi UNC threads.



# ANSI (Inch) Taper-Bushing V-Belt Sheaves

## 3V-5V-8V Cast Iron Sheaves

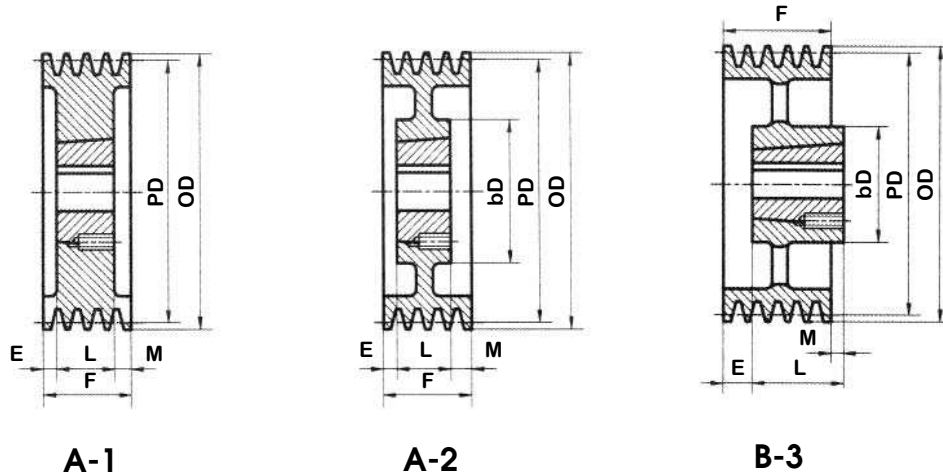

### 8V-6 F = 7 1/8"

Part No.	OD	PD	Bush Max Bore	Bush	Type	bD	E	L	M	Wt Less Bush
6-8V1250TL.4040	12.50	12.30	4 1/2	4040	A1	-	1	4	2 1/8	100.00
6-8V1320TL.4040	13.20	13.00	4 1/2	4040	A1	-	1	4	2 1/8	124.00
6-8V1400TL.4040	14.00	13.80	4 1/2	4040	A1	-	1	4	2 1/8	142.00
6-8V1500TL.4545	15.00	14.80	4 1/2	4545	A1	-	1/2	4 1/2	2 1/8	153.00
6-8V1600TL.4545	16.00	15.80	4 1/2	4545	A2	8 7/16	1/2	4 1/2	2 1/8	170.00
6-8V1700TL.4545	17.00	16.80	4 1/2	4545	A2	8 7/16	1/2	4 1/2	2 1/2	175.00
6-8V1800TL.4545	18.00	17.80	4 1/2	4545	A2	8 7/16	1/2	4 1/2	2 1/8	180.00
6-8V1900TL.4545	19.00	18.80	4 1/2	4545	A2	8 7/16	1/2	4 1/2	2 1/8	192.00
6-8V2000TL.5050	20.00	19.80	5	4545	A2	10	1/2	5	1 5/8	226.00
6-8V2120TL.5050	21.20	21.00	5	5050	A3	10	1/2	5	1 5/8	246.00
6-8V2240TL.5050	22.40	22.20	5	5050	A3	10	1/2	5	1 5/8	267.00
6-8V3000TL.5050	30.00	29.80	5	5050	A3	10	1/2	5	1 5/8	398.00
6-8V4000TL.5050	40.00	39.80	5	5050	A3	10	1/2	5	1 5/8	468.00
6-8V5300TL.5050	53.00	52.80	5	5050	A3	10	1/2	5	1 5/8	658.00

Note: Pulleys prepared for bushings type 2517 and 3535 use ANSI Taper-Lock® Bushings with 1/2" x 13tpi UNC threads.

### 8V-8 F = 9 3/8"

Part No.	OD	PD	Bush Max Bore	Bush	Type	bD	E	L	M	Wt Less Bush
8-8V1250TL.4545	12.50	12.30	4 1/2	4545	A1	-	1 1/2	4 1/2	3 3/8	125.00
8-8V1320TL.4545	13.20	13.00	4 1/2	4545	A1	-	1 1/2	4 1/2	3 3/8	135.00
8-8V1400TL.4545	14.00	13.80	4 1/2	4545	A1	-	1 1/2	4 1/2	3 3/8	156.00
8-8V1500TL.4545	15.00	14.80	4 1/2	4545	A1	-	1 1/2	4 1/2	3 3/8	160.00
8-8V1600TL.4545	16.00	15.80	4 1/2	4545	A2	8 7/16	1 1/2	4 1/2	3 3/8	166.00
8-8V1700TL.5050	17.00	16.80	5	5050	A2	10	1	5	3 3/8	265.00
8-8V1800TL.5050	18.00	17.80	5	5050	A2	10	1	5	3 3/8	204.00
8-8V1900TL.5050	19.00	18.80	5	5050	A2	10	1	5	3 3/8	228.00
8-8V2000TL.5050	20.00	19.80	5	5050	A2	10	1	5	3 3/8	236.00
8-8V2120TL.5050	21.20	21.00	5	5050	A3	10	1	5	3 3/8	246.00
8-8V2240TL.5050	22.40	22.20	5	5050	A3	10	1	5	3 3/8	300.00
8-8V3000TL.5050	30.00	29.80	5	5050	A3	10	1	5	3 3/8	384.00
8-8V4000TL.5050	40.00	39.80	5	5050	A3	10	1	5	3 3/8	556.00
8-8V5300TL.6050	53.00	52.80	5	6050	A3	10	1	5	3 3/8	1040.00

Note: Pulleys prepared for bushings type 2517 and 3535 use ANSI Taper-Lock® Bushings with 1/2" x 13tpi UNC threads.

# ANSI (Inch) Taper-Bushing V-Belt Sheaves

## 3V-5V-8V Cast Iron Sheaves

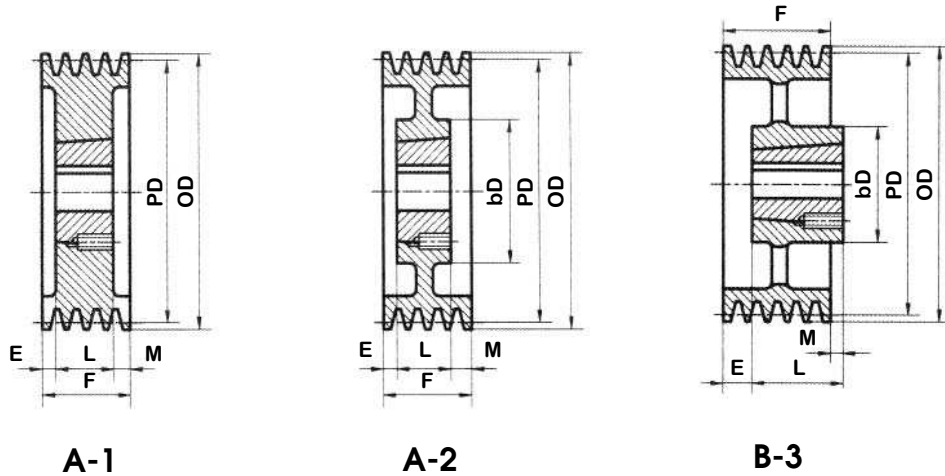

### 8V-10

F = 7 1/8"

Part No.	OD	PD	Bush Max Bore	Bush	Type	bD	E	L	M	Wt Less Bush
10-8V1320TL.4040	13.20	13.00	4 15/16	4545	A1	-	1	4 1/2	6 1/8	150.00
10-8V1400TL.4040	14.00	13.80	4 15/16	4545	A1	-	1	4 1/2	6 1/8	180.00
10-8V1500TL.4545	15.00	14.80	5	5050	A1	-	1	5	5 5/8	211.00
10-8V1600TL.4545	16.00	15.80	5	5050	A1	-	1	5	5 5/8	220.00
10-8V1700TL.4545	17.00	16.80	5	5050	A2	10	2 1/4	5	4 3/8	228.00
10-8V1800TL.4545	18.00	17.80	5	5050	A2	10	2 1/4	5	4 3/8	244.00
10-8V1900TL.4545	19.00	18.80	5	5050	A2	10	2 1/4	5	4 3/8	250.00
10-8V2000TL.5050	20.00	19.80	5	5050	A2	10	2 1/4	5	4 3/8	270.00
10-8V2120TL.5050	21.20	21.00	5	5050	A2	10	2 1/4	5	4 3/8	282.00
10-8V2240TL.5050	22.40	22.20	5	5050	A3	10	2 1/4	5	4 3/8	312.00
10-8V3000TL.5050	30.00	29.80	5	5050	A3	10	2 1/4	5	4 3/8	448.00
10-8V4000TL.6050	40.00	39.80	6	6050	A3	10	2 1/4	5	4 3/8	550.00
10-8V5300TL.6050	53.00	52.80	6	6050	A3	10	2 1/4	5	4 3/8	870.00

Note: Pulleys prepared for bushings type 2517 and 3535 use ANSI Taper-Lock® Bushings with 1/2" x 13tpi UNC threads.