

# Metric Pitch Synchronous Belt Pulleys

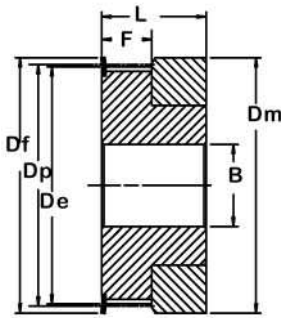

Type 1F

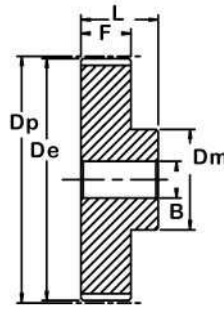

Type 6

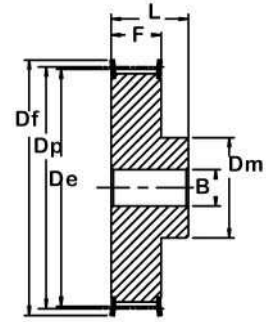

Type 6F

## T2.5 (2.5 mm Pitch x 6 mm Belt Width)

Part No.	Type/ Mat.	Teeth	Dp	De	Approx. Df	Dm	F	L	Bore* <sup>2</sup> ±1 mm	Weight kg	Flange Size* <sup>1</sup>
16T2.5/12 2	1F/A	12	9.60	9.00	13.0	12	9	16		0.003	6x13x0.5
16T2.5/14 2	1F/A	14	11.20	10.60	15.0	14	9	16		0.004	8x15x0.5
16T2.5/15 2	1F/A	15	12.00	11.40	15.0	15	9	16		0.005	8x15x0.5
16T2.5/16 2	1F/A	16	12.80	12.20	16.0	16	9	16		0.005	9.5x16x0.5
16T2.5/18 2	6F/A	18	14.40	13.80	17.5	10	10	16	3	0.006	11.6x17.5x0.5
16T2.5/19 2	6F/A	19	15.20	14.60	18.0	10	10	16	3	0.007	12.2x20x0.5
16T2.5/20 2	6F/A	20	16.00	15.40	19.5	11	10	16	3	0.008	12.2x20x0.5
16T2.5/22 2	6F/A	22	17.60	17.00	23.0	11	10	16	3	0.009	14.5x22x0.5
16T2.5/24 2	6F/A	24	19.15	18.55	23.0	12	10	16	3	0.012	14.5x25x0.5
16T2.5/25 2	6F/A	25	19.95	19.35	23.0	13	10	16	3	0.013	14.5x25x0.5
16T2.5/26 2	6F/A	26	20.75	20.15	25.0	14	10	16	4	0.014	17.8x26x0.5
16T2.5/28 2	6F/A	28	22.35	21.75	25.0	14	10	16	4	0.016	17.8x26x0.5
16T2.5/30 2	6F/A	30	23.95	23.35	28.0	16	10	16	6	0.018	20x28x0.5
16T2.5/32 2	6F/A	32	25.55	24.95	32.0	16	10	16	6	0.020	23x32x0.5
16T2.5/36 2	6F/A	36	28.70	28.10	36.0	20	10	16	6	0.026	25x36x0.5
16T2.5/40 2	6F/A	40	31.90	31.30	38.0	22	10	16	6	0.032	26.5x38x0.5
16T2.5/44 0	6/A	44	35.10	34.50	42.0	24	10	16	6	0.040	
16T2.5/48 0	6/A	48	38.30	37.70		26	10	16	6	0.048	
16T2.5/60 0	6/A	60	47.85	47.25		34	10	16	8	0.073	

## T5 (5 mm Pitch x 10 mm Belt Width)

Part No.	Type/ Mat.	Teeth	Dp	De	Approx. Df	Dm	F	L	Bore* <sup>2</sup> ±1 mm	Weight kg	Flange Size* <sup>1</sup>
21T5/10 2	6F/A	10	16.05	15.05	19.5	8	15	21		0.012	12x19.5x1
21T5/12 2	6F/A	12	19.25	18.25	23.0	11	15	21		0.016	12.5x23x1
21T5/14 2	6F/A	14	22.45	21.45	25.0	14	15	21		0.019	15x25x1
21T5/15 2	6F/A	15	24.05	23.05	28.0	16	15	21		0.021	17.8x28x1
21T5/16 2	6F/A	16	25.60	24.60	32.0	18	15	21		0.025	20x32x1
21T5/18 2	6F/A	18	28.80	27.80	32.0	20	15	21		0.031	23x32x1
21T5/19 2	6F/A	19	30.40	29.40	36.0	22	15	21		0.036	25x36x1
21T5/20 2	6F/A	20	32.00	31.00	36.0	23	15	21		0.038	25x36x1
21T5/22 2	6F/A	22	35.25	34.25	38.0	24	15	21		0.046	26.5x38x1
21T5/24 2	6F/A	24	38.40	37.40	42.0	26	15	21		0.054	30.5x42x1
21T5/25 2	6F/A	25	40.00	39.00	44.0	26	15	21		0.058	32.5x44x1
21T5/26 2	6F/A	26	41.60	40.60	44.0	26	15	21		0.062	32.5x44x1
21T5/27 2	6F/A	27	43.20	42.20	48.0	30	15	21	8	0.064	37x48x1
21T5/28 2	6F/A	28	44.75	43.75	48.0	32	15	21	8	0.071	37x48x1
21T5/30 2	6F/A	30	47.95	46.95	51.0	34	15	21	8	0.075	40x48x1
21T5/32 2	6F/A	32	51.10	50.10	54.0	38	15	21	8	0.088	43x51x1
21T5/36 2	6F/A	36	57.45	56.45	63.0	38	15	21	8	0.114	47x64x1
21T5/40 2	6F/A	40	63.85	62.85	66.0	40	15	21	8	0.138	52x66.5x1
21T5/42 2	6F/A	42	67.00	66.00	71.0	40	15	21	8	0.180	53x70x1
21T5/44 0	6/A	44	70.20	69.20		45	15	21	8	0.185	
21T5/48 0	6/A	48	76.55	75.55		50	15	21	8	0.200	
21T5/60 0	6/A	60	95.65	94.65		65	15	21	8	0.307	

\*1 Recommended flange size (I.D. x O.D. x Thickness); steel.  
 Material: /A = Aluminum • /C = Cast Iron • /S = Steel  
 Metric tolerances correspond to ISO standard H9 for bores and keyways. Inch tolerances correspond to ANSI B17.1 for bores and keyways.

\*2 Center holes provided if no bore size listed



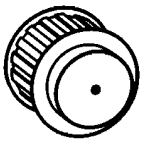

# Metric Pitch Synchronous Belt Pulleys

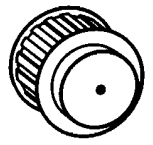

## T5 (5 mm Pitch x 16 mm Belt Width)

Part No.	Type/ Mat.	Teeth	Dp	De	Approx. Df	Dm	F	L	Bore* <sup>2</sup> ±1 mm	Weight kg	Flange Size* <sup>1</sup>
27T5/10 2	6F/A	10	16.05	15.05	19.5	8	21	27		0.016	12x19.5x1
27T5/12 2	6F/A	12	19.25	18.25	23.0	11	21	27		0.022	12.5x23x1
27T5/14 2	6F/A	14	22.45	21.45	25.0	14	21	27		0.026	15x25x1
27T5/15 2	6F/A	15	24.05	23.05	28.0	16	21	27		0.029	17.8x28x1
27T5/16 2	6F/A	16	25.60	24.60	32.0	18	21	27		0.035	20x32x1
27T5/18 2	6F/A	18	28.80	27.80	32.0	20	21	27		0.043	23x32x1
27T5/19 2	6F/A	19	30.40	29.40	36.0	22	21	27		0.049	25x36x1
27T5/20 2	6F/A	20	32.00	31.00	36.0	23	21	27		0.053	25x36x1
27T5/22 2	6F/A	22	35.25	34.25	38.0	24	21	27		0.054	26.5x38x1
27T5/24 2	6F/A	24	38.40	37.40	42.0	26	21	27		0.076	30.5x42x1
27T5/25 2	6F/A	25	40.00	39.00	44.0	26	21	27		0.081	32.5x44x1
27T5/26 2	6F/A	26	41.60	40.60	44.0	26	21	27		0.085	32.5x44x1
27T5/27 2	6F/A	27	43.20	42.20	48.0	30	21	27	8	0.090	37x48x1
27T5/28 2	6F/A	28	44.75	43.75	48.0	32	21	27	8	0.092	37x48x1
27T5/30 2	6F/A	30	47.95	46.95	51.0	34	21	27	8	0.105	40x51x1
27T5/32 2	6F/A	32	51.10	50.10	54.0	38	21	27	8	0.123	43x54x1
27T5/36 2	6F/A	36	57.45	56.45	63.0	38	21	27	8	0.160	47x64x1
27T5/40 2	6F/A	40	63.85	62.85	66.0	40	21	27	8	0.193	52x66.5x1
27T5/42 2	6F/A	42	67.00	66.00	71.0	40	21	27	8	0.205	53x70x1
27T5/44 0	6/A	44	70.20	69.20		45	21	27	8	0.228	
27T5/48 0	6/A	48	76.55	75.55		50	21	27	8	0.280	
27T5/60 0	6/A	60	95.65	94.65		65	21	27	8	0.430	

## T5 (5mm Pitch x 25 mm Belt Width)

Part No.	Type/ Mat.	Teeth	Dp	De	Approx. Df	Dm	F	L	Bore* <sup>2</sup> ±1 mm	Weight kg	Flange Size* <sup>1</sup>
36T5/10 2	6F/A	10	16.05	15.05	19.5	8	30	36		0.023	12x19.5x1
36T5/12 2	6F/A	12	19.25	18.25	23.0	11	30	36		0.031	12.5x23x1
36T5/14 2	6F/A	14	22.45	21.45	25.0	14	30	36		0.037	15x25x1
36T5/15 2	6F/A	15	24.05	23.05	28.0	16	30	36		0.041	17.8x28x1
36T5/16 2	6F/A	16	25.60	24.60	32.0	18	30	36		0.050	20x32x1
36T5/18 2	6F/A	18	28.80	27.80	32.0	20	30	36		0.061	23x32x1
36T5/19 2	6F/A	19	30.40	29.40	36.0	22	30	36		0.070	25x36x1
36T5/20 2	6F/A	20	32.00	31.00	36.0	23	30	36		0.076	25x36x1
36T5/22 2	6F/A	22	35.25	34.25	38.0	24	30	36		0.080	26.5x38x1
36T5/24 2	6F/A	24	38.40	37.40	42.0	26	30	36		0.109	30.5x42x1
36T5/25 2	6F/A	25	40.00	39.00	44.0	26	30	36		0.116	32.5x44x1
36T5/26 2	6F/A	26	41.60	40.60	44.0	26	30	36		0.120	32.5x44x1
36T5/27 2	6F/A	27	43.20	42.20	48.0	30	30	36	8	0.128	37x48x1
36T5/28 2	6F/A	28	44.75	43.75	48.0	32	30	36	8	0.126	37x48x1
36T5/30 2	6F/A	30	47.95	46.95	51.0	34	30	36	8	0.150	40x51x1
36T5/32 2	6F/A	32	51.10	50.10	54.0	38	30	36	8	0.176	43x54x1
36T5/36 2	6F/A	36	57.45	56.45	63.0	38	30	36	8	0.230	47x64x1
36T5/40 2	6F/A	40	63.85	62.85	66.0	40	30	36	8	0.276	52x66.5x1
36T5/42 2	6F/A	42	67.00	66.00	71.0	40	30	36	8	0.284	53x70x1
36T5/44 0	6/A	44	70.20	69.20		45	30	36	8	0.315	
36T5/48 0	6/A	48	76.55	75.55		50	30	36	8	0.400	
36T5/60 0	6/A	60	95.65	94.65		65	30	36	8	0.614	

\*<sup>1</sup>Recommended flange size (I.D. x O.D. x Thickness); steel.

Material: /A = Aluminum • /C = Cast Iron • /S = Steel

Metric tolerances correspond to ISO standard H9 for bores and keyways. Inch tolerances correspond to ANSI B17.1 for bores and keyways.

\*<sup>2</sup> Center holes provided if no bore size listed

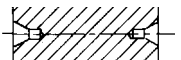

**American Metric<sup>®</sup> Corporation**

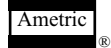

GROUP: 017

1-017 - 70417

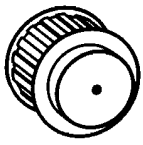

# Metric Pitch Synchronous Belt Pulleys

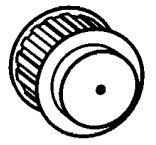

## T10 (10mm Pitch x 16 mm Belt Width)

Part No.	Type/Mat.	Teeth	Dp	De	Approx. Df	Dm	F	L	Bore* <sup>2</sup> ±1 mm	Weight kg	Flange Size* <sup>1</sup>
31T10/12 2	6F/A	12	38.35	36.35	42	28	21	31	6	0.076	30.5x42x1
31T10/14 2	6F/A	14	44.72	42.70	48	32	21	31	8	0.104	37x48x1
31T10/15 2	6F/A	15	47.90	45.90	51	32	21	31	8	0.116	40x51x1
31T10/16 2	6F/A	16	51.05	49.05	54	35	21	31	8	0.134	43x54x1
31T10/18 2	6F/A	18	57.45	55.45	60	40	21	31	8	0.167	47x60x1
31T10/19 2	6F/A	19	60.60	58.60	66	44	21	31	8	0.184	52.66.5x1
31T10/20 2	6F/A	20	63.80	61.80	66	46	21	31	8	0.208	52x66.5x1
31T10/22 2	6F/A	22	70.15	68.15	75	52	21	31	8	0.253	60x75x1
31T10/24 2	6F/A	24	76.55	74.55	83	58	21	31	8	0.288	68x83x1
31T10/25 2	6F/A	25	79.70	77.70	83	60	21	31	8	0.310	68x83x1
31T10/26 2	6F/A	26	82.90	80.90	87	60	21	31	8	0.357	72x87x1
31T10/27 2	6F/A	27	86.10	84.10	91	60	21	31	8	0.364	76x91x1
31T10/28 2	6F/A	28	89.25	87.25	93	60	21	31	8	0.401	80x93x1
31T10/30 2	6F/A	30	95.65	93.65	97	60	21	31	8	0.441	83x97x1
31T10/32 2	6F/A	32	102.00	100.00	106	65	21	31	10	0.493	90x106x1
31T10/36 2	6F/A	36	114.75	112.75	119	70	21	31	10	0.623	103x119x1
31T10/40 2	6F/A	40	127.45	125.45	131	80	21	31	10	0.767	115x131x1
31T10/44 0	6/A	44	140.20	138.20		88	21	31	10	0.993	
31T10/48 0	6/A	48	152.95	150.95		95	21	31	16	1.090	
31T10/60 0	6/A	60	191.10	189.10		110	21	31	16	1.701	

## T10 (10mm Pitch x 25mm Belt Width)

Part No.	Type/Mat.	Teeth	Dp	De	Approx. Df	Dm	F	L	Bore* <sup>2</sup> ±1 mm	Weight kg	Flange Size* <sup>1</sup>
40T10/12 2	6F/A	12	38.35	36.35	42	28	30	40	6	0.099	30.5x42x1
40T10/14 2	6F/A	14	44.70	42.70	48	32	30	40	8	0.134	37x48x1
40T10/15 2	6F/A	15	47.90	45.90	51	32	30	40	8	0.152	40x51x1
40T10/16 2	6F/A	16	51.05	49.05	54	35	30	40	8	0.176	43x54x1
40T10/18 2	6F/A	18	57.45	55.45	60	40	30	40	8	0.224	47x60x1
40T10/19 2	6F/A	19	60.60	58.60	66	44	30	40	8	0.247	52.66.5x1
40T10/20 2	6F/A	20	63.80	61.80	66	46	30	40	8	0.276	52x66.5x1
40T10/22 2	6F/A	22	70.15	68.15	75	52	30	40	8	0.337	60x75x1
40T10/24 2	6F/A	24	76.55	74.55	83	58	30	40	8	0.392	68x83x1
40T10/25 2	6F/A	25	79.70	77.70	83	60	30	40	8	0.422	68x83x1
40T10/26 2	6F/A	26	82.90	80.90	87	60	30	40	8	0.477	72x87x1
40T10/27 2	6F/A	27	86.10	84.10	91	60	30	40	8	0.536	76x91x1
40T10/28 2	6F/A	28	89.25	87.25	93	60	30	40	8	0.540	80x93x1
40T10/30 2	6F/A	30	95.65	93.65	97	60	30	40	8	0.640	83x97x1
40T10/32 2	6F/A	32	102.00	100.00	106	65	30	40	10	0.693	90x106x1
40T10/36 2	6F/A	36	114.75	112.75	119	70	30	40	10	0.873	103x119x1
40T10/40 2	6F/A	40	127.45	125.45	131	80	30	40	10	1.067	115x131x1
40T10/44 0	6/A	44	140.20	138.20		88	30	40	10	1.350	
40T10/48 0	6/A	48	152.95	150.95		95	30	40	16	1.516	
40T10/60 0	6/A	60	191.10	189.10		110	30	40	16	2.339	

\*1 Recommended flange size (I.D. x O.D. x Thickness); steel.

Material: /A = Aluminum • /C = Cast Iron • /S = Steel

Metric tolerances correspond to ISO standard H9 for bores and keyways. Inch tolerances correspond to ANSI B17.1 for bores and keyways.

\*2 Center holes provided if no bore size listed

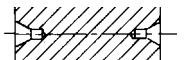

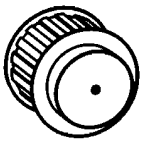

# Metric Pitch Synchronous Belt Pulleys

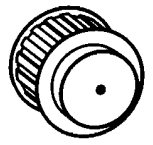

## T10 (10mm Pitch x 32 mm Belt Width)

Part No.	Type/Mat.	Teeth	Dp	De	Approx. Df	Dm	F	L	Bore* <sup>2</sup> ±1 mm	Weight kg	Flange Size* <sup>1</sup>
47T10/18 2	6F/A	18	57.45	55.45	60	40	37	47	10	0.253	47x60x1
47T10/19 2	6F/A	19	60.60	58.60	66	44	37	47	10	0.286	52x66.5x1
47T10/20 2	6F/A	20	63.80	61.80	66	46	37	47	12	0.322	52.66.5x1
47T10/22 2	6F/A	22	70.15	68.15	75	52	37	47	12	0.393	60x75x1
47T10/24 2	6F/A	24	76.55	74.55	83	58	37	47	12	0.475	68x83x1
47T10/25 2	6F/A	25	79.70	77.70	83	60	37	47	12	0.527	68x83x1
47T10/26 2	6F/A	26	82.90	80.90	87	60	37	47	12	0.564	72x87x1
47T10/27 2	6F/A	27	86.10	84.10	91	60	37	47	12	0.602	76x91x1
47T10/28 2	6F/A	28	89.25	87.25	93	60	37	47	12	0.642	80x93x1
47T10/30 2	6F/A	30	95.65	93.65	97	60	37	47	12	0.740	83x97x1
47T10/32 2	6F/A	32	102.00	100.00	106	65	37	47	12	0.844	90x106x1
47T10/36 2	6F/A	36	114.75	112.75	119	70	37	47	16	1.063	103x119x1
47T10/40 2	6F/A	40	127.45	125.45	131	80	37	47	16	1.317	115x131x1
47T10/44 0	6/A	44	140.20	138.20		88	37	47	16	1.611	
47T10/48 0	6/A	48	152.95	150.95		95	37	47	16	1.931	
47T10/60 0	6/A	60	191.10	189.10		110	37	47	16	3.004	

## T10 (10mm Pitch x 50 mm Belt Width)

Part No.	Type/Mat.	Teeth	Dp	De	Approx. Df	Dm	F	L	Bore* <sup>2</sup> ±1 mm	Weight kg	Flange Size* <sup>1</sup>
66T10/18 2	6F/A	18	57.45	55.45	60	40	56	66	10	0.422	47x60x1
66T10/19 2	6F/A	19	60.60	58.60	66	44	56	66	10	0.466	52x66.5x1
66T10/20 2	6F/A	20	63.80	61.80	66	46	56	66	12	0.520	52.66.5x1
66T10/22 2	6F/A	22	70.15	68.15	75	52	56	66	12	0.570	60x75x1
66T10/24 2	6F/A	24	76.55	74.55	83	58	56	66	12	0.736	68x83x1
66T10/25 2	6F/A	25	79.70	77.70	83	60	56	66	12	0.766	68x83x1
66T10/26 2	6F/A	26	82.90	80.90	87	60	56	66	12	0.816	72x87x1
66T10/27 2	6F/A	27	86.10	84.10	91	60	56	66	12	0.946	76x91x1
66T10/28 2	6F/A	28	89.25	87.25	93	60	56	66	12	0.960	80x93x1
66T10/30 2	6F/A	30	95.65	93.65	97	60	56	66	12	1.169	83x97x1
66T10/32 2	6F/A	32	102.00	100.00	106	65	56	66	12	1.300	90x106x1
66T10/36 2	6F/A	36	114.75	112.75	119	70	56	66	16	1.637	103x119x1
66T10/40 2	6F/A	40	127.45	125.45	131	80	56	66	16	1.999	115x131x1
66T10/44 0	6/A	44	140.20	138.20		88	56	66	16	2.357	
66T10/48 0	6/A	48	152.95	150.95		95	56	66	16	2.830	
66T10/60 0	6/A	60	191.10	189.10		110	56	66	16	4.366	

\*<sup>1</sup>Recommended flange size (I.D. x O.D. x Thickness); steel.  
 Material: /A = Aluminum • /C = Cast Iron • /S = Steel  
 Metric tolerances correspond to ISO standard H9 for bores and keyways. Inch tolerances correspond to ANSI B17.1 for bores and keyways.

\*<sup>2</sup> Center holes provided if no bore size listed

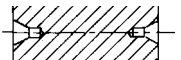

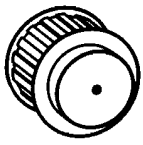

# Metric Pitch Synchronous Belt Pulleys "AT" Type

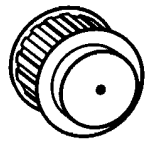

## AT5 (AT 5 mm Pitch x 10 mm Belt Width)

Part No.	Type/Mat.	Teeth	Dp	De	Approx. Df	Dm	F	L	Bore* <sup>2</sup> ±1 mm	Weight kg	Flange Size* <sup>1</sup>
21AT5/12 2	6F/A	12	19.25	17.85	23.0	11	15	21		0.016	12.5x23x1
21AT5/14 2	6F/A	14	22.45	21.05	25.0	14	15	21		0.019	15x25x1
21AT5/15 2	6F/A	15	24.05	22.65	28.0	16	15	21		0.021	17.8x28x1
21AT5/16 2	6F/A	16	25.60	24.20	32.0	18	15	21		0.025	20x32x1
21AT5/18 2	6F/A	18	28.80	27.40	32.0	20	15	21		0.031	23x32x1
21AT5/19 2	6F/A	19	30.40	29.00	36.0	22	15	21		0.036	25x36x1
21AT5/20 2	6F/A	20	32.00	30.60	36.0	23	15	21		0.038	25x36x1
21AT5/22 2	6F/A	22	35.25	33.85	38.0	24	15	21		0.046	26.5x38x1
21AT5/24 2	6F/A	24	38.40	37.00	42.0	26	15	21		0.054	30.5x42x1
21AT5/25 2	6F/A	25	40.00	38.60	44.0	26	15	21		0.058	32.5x44x1
21AT5/26 2	6F/A	26	41.60	40.20	44.0	26	15	21		0.062	32.5x44x1
21AT5/27 2	6F/A	27	43.20	41.80	48.0	30	15	21	8	0.064	37x48x1
21AT5/28 2	6F/A	28	44.75	43.35	48.0	32	15	21	8	0.071	37x48x1
21AT5/30 2	6F/A	30	47.95	46.55	51.0	34	15	21	8	0.075	40x51x1
21AT5/32 2	6F/A	32	51.10	49.70	54.0	38	15	21	8	0.088	43x54x1
21AT5/36 2	6F/A	36	57.45	56.05	64.0	38	15	21	8	0.114	47x64x1
21AT5/40 2	6F/A	40	63.85	62.45	66.5	40	15	21	8	0.138	52x66.5x1
21AT5/42 2	6F/A	42	67.00	65.60	70.0	40	15	21	8	0.180	53x70x1
21AT5/44 0	6/A	44	70.20	68.80		45	15	21	8	0.185	
21AT5/48 0	6/A	48	76.55	75.15		50	15	21	8	0.200	
21AT5/60 0	6/A	60	95.65	94.25		65	15	21	8	0.307	

## AT5 (AT 5 mm Pitch x 16 mm Belt Width)

Part No.	Type/Mat.	Teeth	Dp	De	Approx. Df	Dm	F	L	Bore* <sup>2</sup> ±1 mm	Weight kg	Flange Size* <sup>1</sup>
27AT5/12 2	6F/A	12	19.25	17.85	23.0	11	21	27		0.022	12.5x23x1
27AT5/14 2	6F/A	14	22.45	21.05	25.0	14	21	27		0.026	15x25x1
27AT5/15 2	6F/A	15	24.05	22.65	28.0	16	21	27		0.029	17.8x28x1
27AT5/16 2	6F/A	16	25.60	24.20	32.0	18	21	27		0.035	20x32x1
27AT5/18 2	6F/A	18	28.80	27.40	32.0	20	21	27		0.043	23x32x1
27AT5/19 2	6F/A	19	30.40	29.00	36.0	22	21	27		0.049	25x36x1
27AT5/20 2	6F/A	20	32.00	30.60	36.0	23	21	27		0.053	25x36x1
27AT5/22 2	6F/A	22	35.25	33.85	38.0	24	21	27		0.054	26.5x38x1
27AT5/24 2	6F/A	24	38.40	37.00	42.0	26	21	27		0.076	30.5x42x1
27AT5/25 2	6F/A	25	40.00	38.60	44.0	26	21	27		0.081	32.5x44x1
27AT5/26 2	6F/A	26	41.60	40.20	44.0	26	21	27		0.085	32.5x44x1
27AT5/27 2	6F/A	27	43.20	41.80	48.0	30	21	27	8	0.090	37x48x1
27AT5/28 2	6F/A	28	44.75	43.35	48.0	32	21	27	8	0.092	37x48x1
27AT5/30 2	6F/A	30	47.95	46.55	51.0	34	21	27	8	0.105	40x51x1
27AT5/32 2	6F/A	32	51.10	49.70	54.0	38	21	27	8	0.123	43x54x1
27AT5/36 2	6F/A	36	57.45	56.05	64.0	38	21	27	8	0.160	47x64x1
27AT5/40 2	6F/A	40	63.85	62.45	66.5	40	21	27	8	0.193	52x66.5x1
27AT5/42 2	6F/A	42	67.00	65.60	70.0	40	21	27	8	0.205	53x70x1
27AT5/44 0	6/A	44	70.20	68.80		45	21	27	8	0.228	
27AT5/48 0	6/A	48	76.55	75.15		50	21	27	8	0.280	
27AT5/60 0	6/A	60	95.65	94.25		65	21	27	8	0.430	

\*1 Recommended flange size (I.D. x O.D. x Thickness); steel.  
 Material: /A = Aluminum • /C = Cast Iron • /S = Steel  
 Metric tolerances correspond to ISO standard H9 for bores and keyways. Inch tolerances correspond to ANSI B17.1 for bores and keyways.

\*2 Center holes provided if no bore size listed

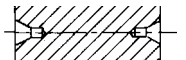

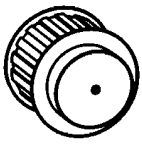

# Metric Pitch Synchronous Belt Pulleys

## "AT" Type

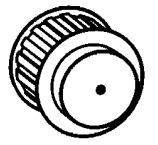

### AT5 (AT 5 mm Pitch x 25 mm Belt Width)

Part No.	Type/ Mat.	Teeth	Dp	De	Approx. Df	Dm	F	L	Bore* <sup>2</sup> ±1 mm	Weight kg	Flange Size* <sup>1</sup>
36AT5/12 2	6F/A	12	19.25	17.85	23.0	11	30	36		0.031	12.5x23x1
36AT5/14 2	6F/A	14	22.45	21.05	25.0	14	30	36		0.037	15x25x1
36AT5/15 2	6F/A	15	24.05	22.65	28.0	16	30	36		0.041	17.8x28x1
36AT5/16 2	6F/A	16	25.60	24.20	32.0	18	30	36		0.050	20x32x1
36AT5/18 2	6F/A	18	28.80	27.40	32.0	20	30	36		0.061	23x32x1
36AT5/19 2	6F/A	19	30.40	29.00	36.0	22	30	36		0.070	25x36x1
36AT5/20 2	6F/A	20	32.00	30.60	36.0	23	30	36		0.076	25x36x1
36AT5/22 2	6F/A	22	35.25	33.85	38.0	24	30	36		0.080	26.5x38x1
36AT5/24 2	6F/A	24	38.40	37.00	42.0	26	30	36	8	0.109	30.5x42x1
36AT5/25 2	6F/A	25	40.00	38.60	44.0	26	30	36	8	0.116	32.5x44x1
36AT5/26 2	6F/A	26	41.60	40.20	44.0	26	30	36	8	0.120	32.5x44x1
36AT5/27 2	6F/A	27	43.20	41.80	48.0	30	30	36	8	0.128	37x48x1
36AT5/28 2	6F/A	28	44.75	43.35	48.0	32	30	36	8	0.126	37x48x1
36AT5/30 2	6F/A	30	47.95	46.55	51.0	34	30	36	8	0.150	40x51x1
36AT5/32 2	6F/A	32	51.10	49.70	54.0	38	30	36	8	0.176	43x54x1
36AT5/36 2	6F/A	36	57.45	56.05	64.0	38	30	36	8	0.230	47x64x1
36AT5/40 2	6F/A	40	63.85	62.45	66.5	40	30	36	8	0.276	52x66.5x1
36AT5/42 2	6F/A	42	67.00	65.60	70.0	40	30	36	8	0.284	53x70x1
36AT5/44 0	6/A	44	70.20	68.80		45	30	36	8	0.315	
36AT5/48 0	6/A	48	76.55	75.15		50	30	36	8	0.400	
36AT5/60 0	6/A	60	95.65	94.25		65	30	36	8	0.614	

### AT10 (AT 10 mm Pitch x 16 mm Belt Width)

Part No.	Type/ Mat.	Teeth	Dp	De	Approx. Df	Dm	F	L	Bore* <sup>2</sup> ±1 mm	Weight kg	Flange Size* <sup>1</sup>
31AT10/15 2	6F/A	15	47.90	45.90	51	32	21	31	8	0.116	40x51x1
31AT10/16 2	6F/A	16	51.05	49.05	54	35	21	31	8	0.134	43x54x1
31AT10/18 2	6F/A	18	57.45	55.45	60	40	21	31	8	0.167	47x60x1
31AT10/19 2	6F/A	19	60.60	58.60	66.5	44	21	31	8	0.184	52x66.5x1
31AT10/20 2	6F/A	20	63.80	61.80	66.5	46	21	31	8	0.208	52x66.5x1
31AT10/22 2	6F/A	22	70.15	68.15	75	52	21	31	8	0.253	60x75x1
31AT10/24 2	6F/A	24	76.55	74.55	83	58	21	31	8	0.288	68x83x1
31AT10/25 2	6F/A	25	79.70	77.70	83	60	21	31	8	0.310	68x83x1
31AT10/26 2	6F/A	26	82.90	80.90	87	60	21	31	8	0.357	72x87x1
31AT10/27 2	6F/A	27	86.10	84.10	91	60	21	31	8	0.364	76x91x1
31AT10/28 2	6F/A	28	89.25	87.25	93	60	21	31	8	0.401	80x93x1
31AT10/30 2	6F/A	30	95.65	93.65	97	60	21	31	8	0.441	83x97x1
31AT10/32 2	6F/A	32	102.00	100.00	106	65	21	31	10	0.493	90x106x1
31AT10/36 2	6F/A	36	114.75	112.75	119	70	21	31	10	0.623	103x119x1
31AT10/40 2	6F/A	40	127.45	125.45	131	80	21	31	10	0.767	115x131x1
31AT10/44 0	6/A	44	140.20	138.20		88	21	31	10	0.993	
31AT10/48 0	6/A	48	152.95	150.95		95	21	31	16	1.090	
31AT10/60 0	6/A	60	191.10	189.10		110	21	31	16	1.701	

\*<sup>1</sup>Recommended flange size (I.D. x O.D. x Thickness); steel.  
 Material: /A = Aluminum • /C = Cast Iron • /S = Steel  
 Metric tolerances correspond to ISO standard H9 for bores and  
 keyways. Inch tolerances correspond to ANSI B17.1 for bores  
 and keyways.

\*<sup>2</sup> Center holes provided  
 if no bore size listed

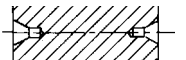

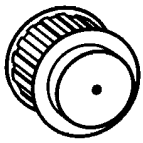

# Metric Pitch Synchronous Belt Pulleys

## "AT" Type

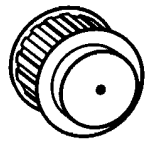

### AT10 (AT 10 mm Pitch x 25 mm Belt Width)

Part No.	Type/Mat.	Teeth	Dp	De	Approx. Df	Dm	F	L	Bore* <sup>2</sup> ±1 mm	Weight kg	Flange Size* <sup>1</sup>
40AT10/15 2	6F/A	15	47.90	45.90	51	32	30	40	8	0.152	40x51x1
40AT10/16 2	6F/A	16	51.05	49.05	54	35	30	40	8	0.176	43x54x1
40AT10/18 2	6F/A	18	57.45	55.45	60	40	30	40	8	0.224	47x60x1
40AT10/19 2	6F/A	19	60.60	58.60	66.5	44	30	40	8	0.247	52x66.5x1
40AT10/20 2	6F/A	20	63.80	61.80	66.5	46	30	40	8	0.276	52x66.5x1
40AT10/22 2	6F/A	22	70.15	68.15	75	52	30	40	8	0.337	60x75x1
40AT10/24 2	6F/A	24	76.55	74.55	83	58	30	40	8	0.392	68x83x1
40AT10/25 2	6F/A	25	79.70	77.70	83	60	30	40	8	0.422	68x83x1
40AT10/26 2	6F/A	26	82.90	80.90	87	60	30	40	8	0.477	72x87x1
40AT10/27 2	6F/A	27	86.10	84.10	91	60	30	40	8	0.536	76x91x1
40AT10/28 2	6F/A	28	89.25	87.25	93	60	30	40	8	0.540	80x93x1
40AT10/30 2	6F/A	30	95.65	93.65	97	60	30	40	8	0.640	83x97x1
40AT10/32 2	6F/A	32	102.00	100.00	106	65	30	40	10	0.693	90x106x1
40AT10/36 2	6F/A	36	114.75	112.75	119	70	30	40	10	0.873	103x119x1
40AT10/40 2	6F/A	40	127.45	125.45	131	80	30	40	10	1.067	115x131x1
40AT10/44 0	6/A	44	140.20	138.20		88	30	40	10	1.350	
40AT10/48 0	6/A	48	152.95	150.95		95	30	40	16	1.516	
40AT10/60 0	6/A	60	191.10	189.10		110	30	40	16	2.339	

### AT10 (AT 10 mm Pitch x 32 mm Belt Width)

Part No.	Type/Mat.	Teeth	Dp	De	Approx. Df	Dm	F	L	Bore* <sup>2</sup> ±1 mm	Weight kg	Flange Size* <sup>1</sup>
47AT10/18 2	6F/A	18	57.45	55.45	60	40	37	47	10	0.253	47x60x1
47AT10/19 2	6F/A	19	60.60	58.60	66.5	44	37	47	10	0.286	52x66.5x1
47AT10/20 2	6F/A	20	63.80	61.80	66.5	46	37	47	12	0.322	52x66.5x1
47AT10/22 2	6F/A	22	70.15	68.15	75	52	37	47	12	0.393	60x75x1
47AT10/24 2	6F/A	24	76.55	74.55	83	58	37	47	12	0.475	68x83x1
47AT10/25 2	6F/A	25	79.70	77.70	83	60	37	47	12	0.527	68x83x1
47AT10/26 2	6F/A	26	82.90	80.90	87	60	37	47	12	0.564	72x87x1
47AT10/27 2	6F/A	27	86.10	84.10	91	60	37	47	12	0.602	76x91x1
47AT10/28 2	6F/A	28	89.25	87.25	93	60	37	47	12	0.642	80x93x1
47AT10/30 2	6F/A	30	95.65	93.65	97	60	37	47	12	0.740	83x97x1
47AT10/32 2	6F/A	32	102.00	100.00	106	65	37	47	12	0.844	90x106x1
47AT10/36 2	6F/A	36	114.75	112.75	119	70	37	47	16	1.063	103x119x1
47AT10/40 2	6F/A	40	127.45	125.45	131	80	37	47	16	1.317	115x131x1
47AT10/44 0	6/A	44	140.20	138.20		88	37	47	16	1.611	
47AT10/48 0	6/A	48	152.95	150.95		95	37	47	16	1.931	
47AT10/60 0	6/A	60	191.10	189.10		110	37	47	16	3.004	

\*<sup>1</sup>Recommended flange size (I.D. x O.D. x Thickness); steel.  
 Material: /A = Aluminum • /C = Cast Iron • /S = Steel  
 Metric tolerances correspond to ISO standard H9 for bores and keyways. Inch tolerances correspond to ANSI B17.1 for bores and keyways.

\*<sup>2</sup> Center holes provided if no bore size listed

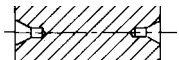

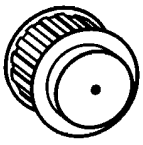

# Metric Pitch Synchronous Belt Pulleys

## "AT" Type

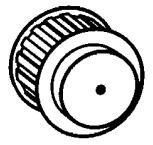

### AT10 (AT 10 mm Pitch x 50 mm Belt Width)

Part No.	Type/ Mat.	Teeth	Dp	De	Approx. Df	Dm	F	L	Bore* <sup>2</sup> ±1 mm	Weight kg	Flange Size* <sup>1</sup>
66AT10/18 2	6F/A	18	57.45	55.45	60	40	56	66	10	0.422	47x60x1
66AT10/19 2	6F/A	19	60.60	58.60	66.5	44	56	66	10	0.466	52x66.5x1
66AT10/20 2	6F/A	20	63.80	61.80	66.5	46	56	66	12	0.520	52x66.5x1
66AT10/22 2	6F/A	22	70.15	68.15	75	52	56	66	12	0.570	60x75x1
66AT10/24 2	6F/A	24	76.55	74.55	83	58	56	66	12	0.736	68x83x1
66AT10/25 2	6F/A	25	79.70	77.70	83	60	56	66	12	0.766	68x83x1
66AT10/26 2	6F/A	26	82.90	80.90	87	60	56	66	12	0.816	72x87x1
66AT10/27 2	6F/A	27	86.10	84.10	91	60	56	66	12	0.946	76x91x1
66AT10/28 2	6F/A	28	89.25	87.25	93	60	56	66	12	0.960	80x93x1
66AT10/30 2	6F/A	30	95.65	93.65	97	60	56	66	12	1.169	83x97x1
66AT10/32 2	6F/A	32	102.00	100.00	106	65	56	66	12	1.300	90x106x1
66AT10/36 2	6F/A	36	114.75	112.75	119	70	56	66	16	1.637	103x119x1
66AT10/40 2	6F/A	40	127.45	125.45	131	80	56	66	16	1.999	115x131x1
66AT10/44 0	6/A	44	140.20	138.20		88	56	66	16	2.357	
66AT10/48 0	6/A	48	152.95	150.95		95	56	66	16	2.830	
66AT10/60 0	6/A	60	191.10	189.10		110	56	66	16	4.366	

\*<sup>1</sup>Recommended flange size (I.D. x O.D. x Thickness); steel.

Material: /A = Aluminum

Metric tolerances correspond to ISO standard H9 for bores and keyways. Inch tolerances correspond to ANSI B17.1 for bores and keyways.

\*<sup>2</sup> Center holes provided if no bore size listed

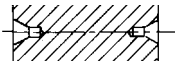



# High Power Timing Belt Pulleys

## "ATP 10"

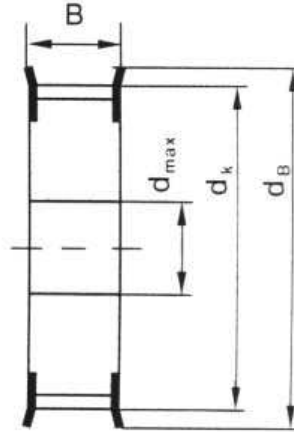

Part No.	Teeth	d <sub>k</sub>	d <sub>max</sub>	d <sub>B</sub>
10ATP/15	15	46.15	34	51
10ATP/16	16	49.33	36	55
10ATP/17	17	52.51	40	58
10ATP/18	18	55.70	44	61
10ATP/19	19	58.88	46	64
10ATP/20	20	62.06	50	67
10ATP/21	21	65.25	52	70
10ATP/22	22	68.43	56	74
10ATP/23	23	71.61	60	76
10ATP/24	24	74.79	62	80
10ATP/25	25	77.98	66	82
10ATP/26	26	81.16	68	86
10ATP/27	27	84.34	72	90
10ATP/28	28	87.53	76	93
10ATP/29	29	90.71	78	96
10ATP/30	30	93.89	82	99
10ATP/31	31	97.08	84	102
10ATP/32	32	100.26	88	105
10ATP/33	33	103.44	88	109
10ATP/34	34	106.63	92	112
10ATP/35	35	109.81	96	115
10ATP/36	36	112.99	98	118
10ATP/37	37	116.17	101	121
10ATP/38	38	119.36	104	125
10ATP/39	39	122.54	106	128
10ATP/40	40	125.72	110	131
10ATP/41	41	128.91	110	134
10ATP/42	42	132.09	112	137
10ATP/43	43	135.27	114	140
10ATP/44	44	138.46	118	144
10ATP/45	45	141.64	120	147
10ATP/46	46	144.82	122	150
10ATP/47	47	148.01	122	153
10ATP/48	48	151.19	124	156
10ATP/49	49	154.37	126	160
10ATP/50	50	157.56	130	162
10ATP/51	51	160.74	134	166
10ATP/52	52	163.92	136	169
10ATP/53	53	167.10	140	172

Part No.	Teeth	d <sub>k</sub>	d <sub>max</sub>	d <sub>B</sub>
10ATP/54	54	170.29	144	176
10ATP/55	55	173.47	146	178
10ATP/56	56	176.65	150	182
10ATP/57	57	179.84	152	185
10ATP/58	58	183.02	156	188
10ATP/59	59	186.20	160	191
10ATP/60	60	189.39	162	195
10ATP/61	61	192.57	164	198
10ATP/62	62	195.75	166	201
10ATP/63	63	198.94	170	204
10ATP/64	64	202.12	171	207
10ATP/65	65	205.30	174	210
10ATP/66	66	208.48	175	214
10ATP/67	67	211.67	177	217
10ATP/68	68	214.85	181	220
10ATP/69	69	218.03	185	223
10ATP/70	70	221.22	187	226
10ATP/71	71	224.40	191	230
10ATP/72	72	227.58	193	232
10ATP/73	73	230.77	197	236
10ATP/74	74	233.95	201	239
10ATP/75	75	237.13	203	242
10ATP/76	76	240.32	207	245
10ATP/77	77	243.50	209	248
10ATP/78	78	246.68	213	252
10ATP/79	79	249.87	215	255
10ATP/80	80	253.05	219	258
10ATP/81	81	256.23	223	261
10ATP/82	82	259.41	225	265
10ATP/83	83	262.60	229	268
10ATP/84	84	265.78	231	271
10ATP/85	85	268.96	235	274
10ATP/86	86	272.15	239	277
10ATP/87	87	275.33	241	280
10ATP/88	88	278.51	245	284
10ATP/89	89	281.70	247	287
10ATP/90	90	284.88	251	290
10ATP/91	91	288.06	255	293

Part No.	Teeth	d <sub>k</sub>	d <sub>max</sub>	d <sub>B</sub>
10ATP/92	92	291.25	257	296
10ATP/93	93	294.43	261	300
10ATP/94	94	297.61	263	302
10ATP/95	95	300.79	267	306
10ATP/96	96	303.98	269	309
10ATP/97	97	307.16	273	312
10ATP/98	98	310.34	279	315
10ATP/99	99	313.53	283	318
10ATP/100	100	316.71	285	322
10ATP/101	101	319.89	289	325
10ATP/102	102	323.08	293	328
10ATP/103	103	326.26	295	332
10ATP/104	104	329.44	299	335
10ATP/105	105	332.63	301	338
10ATP/106	106	335.81	305	341
10ATP/107	107	338.99	309	344
10ATP/108	108	342.17	311	347
10ATP/109	109	345.36	315	351
10ATP/110	110	348.54	317	354
10ATP/111	111	351.72	321	357
10ATP/112	112	354.91	323	360
10ATP/113	113	358.09	327	363
10ATP/114	114	361.27	330	367

Standard material: Al Zn MG Cu 0.5 (F 48)

Standard Belt Width	b(mm)	10	16	25	32	50	75	100
Timing Pulley Width	B(mm)	16	23	32	40	60	85	100