

# American Standard (ANSI) MPB Steel Miter Gears

## Pressure Angle 20°

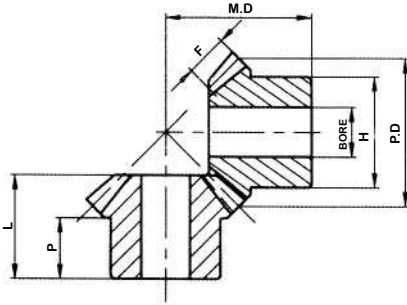

Bored to Size Gears  
Available in Standard ANSI  
or Metric (ISO) Bores,  
Keyways and (2) Setscrews



### 1:1 Steel - Plain Bore - Unhardened Teeth

Part No.	PD	OD	MD	Bore		Dimensions				Weight
				Stock	Max	F	L	P	H	
4DP24/24	6.00	6.36	5 1/2	1 1/2	2 3/8	1.330	3 9/16	1 15/16	4	14.50
4DP24/24A	6.00	6.36	5 1/2	1 3/4	2 3/8	1.330	3 9/16	1 15/16	4	14.00
4DP28/28	7.00	7.36	6	2	3	1.430	3 5/8	1 15/16	5	21.50
5DP25/25	5.00	5.29	4 5/8	1 3/8	2 1/4	1.100	3	1 3/4	3 1/2	8.80
5DP25/25A	5.00	5.29	4 5/8	1 1/2	2 1/4	1.100	3	1 3/4	3 1/2	8.40
5DP25/25B	5.00	5.29	4 5/8	1 3/4	2 1/4	1.100	3	1 3/4	3 1/2	7.80
6DP24/24	4.00	4.24	3 5/8	1 1/4	2	0.860	2 5/16	1 5/16	3	4.40
6DP24/24A	4.00	4.24	3 5/8	1 1/2	2	0.860	2 5/16	1 5/16	3	4.30
6DP27/27	4.50	4.74	4 1/8	1 1/4	2 3/16	0.960	2 5/8	1 1/2	3 1/4	6.30
6DP27/27A	4.50	4.74	4 1/8	1 1/2	2 3/16	0.960	2 5/8	1 1/2	3 1/4	5.90
8DP24/24	3.00	3.18	2 9/16	3/4	1	0.640	1 37/64	13/16	1 3/4	1.50
8DP24/24A	3.00	3.18	2 3/4	1	1 3/8	0.640	1 49/64	1	2 1/2	2.10
8DP24/24B	3.00	3.18	2 3/4	1 1/4	1 5/8	0.640	1 49/64	1	2 1/2	1.90
8DP28/28	3.50	3.68	3 1/4	1	1 5/8	0.750	2 3/32	1 1/4	2 1/2	2.90
8DP28/28A	3.50	3.68	3 1/4	1 3/16	1 5/8	0.750	2 3/32	1 1/4	2 1/2	2.80
8DP28/28B	3.50	3.68	3 1/4	1 1/4	1 5/8	0.750	2 3/32	1 1/4	2 1/2	2.60
8DP32/32	4.00	4.18	3 5/8	1	2	0.840	2 9/32	1 1/8	3	4.80
10DP20/20A	2.00	2.14	2	1/2	7/8	0.440	1 23/64	13/16	1 5/8	0.75
10DP20/20B	2.00	2.14	2	5/8	7/8	0.440	1 23/64	13/16	1 5/8	0.72
10DP20/20	2.00	2.14	2	3/4	7/8	0.440	1 23/64	13/16	1 5/8	0.67
10DP20/20C	2.00	2.14	2	7/8	7/8	0.440	1 23/64	13/16	1 5/8	0.58
10DP25/25	2.50	2.64	2 7/16	3/4	1 1/4	0.550	1 5/8	15/16	2	1.20
10DP25/25A	2.50	2.64	2 7/16	7/8	1 1/4	0.550	1 5/8	15/16	2	1.20
10DP25/25B	2.50	2.64	2 7/16	1	1 1/4	0.550	1 5/8	15/16	2	1.20
10DP30/30	3.00	3.14	2 3/4	3/4	1 5/8	0.640	1 3/4	1	2	1.80
12DP15/15	1.25	1.37	1 1/4	3/8	3/4	0.270	55/64	1/2	1	0.17
12DP15/15A	1.25	1.37	1 1/4	7/16	3/4	0.270	55/64	1/2	1	0.16
12DP15/15B	1.25	1.37	1 1/4	1/2	3/4	0.270	55/64	1/2	1	0.15
12DP18/18	1.50	1.62	1 1/2	1/2	7/8	0.320	1 1/64	5/8	1 1/4	0.30
12DP18/18A	1.50	1.62	1 1/2	5/8	7/8	0.320	1 1/64	5/8	1 1/4	0.25
12DP18/18	1.50	1.62	1 1/2	3/4	7/8	0.320	1 1/64	5/8	1 1/4	0.22
12DP21/21	1.75	1.87	1 3/4	1/2	1	0.390	1 3/16	11/16	1 3/8	0.45
12DP21/21A	1.75	1.87	1 3/4	9/16	1	0.390	1 3/16	11/16	1 3/8	0.45
12DP21/21B	1.75	1.87	1 3/4	5/8	1	0.390	1 3/16	11/16	1 3/8	0.43
12DP21/21C	1.75	1.87	1 3/4	3/4	1	0.390	1 3/16	11/16	1 3/8	0.38
12DP24/24	2.00	2.12	1 7/8	1/2	1	0.430	1 7/32	11/16	1 1/2	0.62
12DP30/30	2.50	2.62	2 5/16	5/8	1 1/4	0.540	1 31/64	27/32	1 3/4	1.10
14DP14/14A	1.00	1.11	1 1/16	3/8	5/8	0.190	47/64	1/2	7/8	0.10
14DP14/14	1.00	1.11	1 1/16	7/16	5/8	0.190	47/64	1/2	7/8	0.10
16DP12/12	0.75	0.84	13/16	5/16	7/16	0.160	37/64	3/8	5/8	0.10
16DP16/16	1.00	1.09	1 1/16	3/8	1/2	0.220	3/4	7/16	3/4	0.10
16DP20/20	1.25	1.34	1 1/4	7/16	5/8	0.270	27/32	1/2	1	0.20
16DP24/24	1.50	1.59	1 3/8	1/2	7/8	0.310	7/8	1/2	1	0.20
20DP20/20	1.00	1.07	1 1/8	3/8	5/8	0.230	13/16	1/2	3/4	0.10
20DP25/25	1.25	1.32	1 3/16	3/8	3/4	0.250	3/4	7/16	1	0.10
24DP24/24	1.00	1.06	29/32	1/4	1/2	0.200	9/16	9/32	5/8	0.10

# American Standard (ANSI) MPB Steel Miter Gears

## Pressure Angle 20°

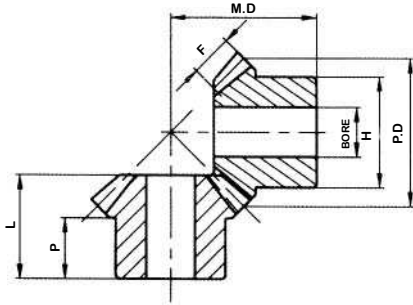

Bored to Size Gears  
Available in Standard ANSI  
or Metric (ISO) Bores,  
Keyways and (2) Setscrews



1:1

Steel - Plain Bore - Hardened Teeth

Part No.	PD	OD	MD	Bore		Dimensions				Weight
				Stock	Max	F	L	P	H	
4DPH24/24	6.00	6.36	5 1/2	1 1/2	2 3/8	1.330	3 9/16	1 15/16	4	14.50
4DPH24/24A	6.00	6.36	5 1/2	1 3/4	2 3/8	1.330	3 9/16	1 15/16	4	14.00
4DPH28/28	7.00	7.36	6	2	3	1.430	3 5/8	1 15/16	5	21.50
5DPH25/25	5.00	5.29	4 5/8	1 3/8	2 1/4	1.100	3	1 3/4	3 1/2	8.80
5DPH25/25A	5.00	5.29	4 5/8	1 1/2	2 1/4	1.100	3	1 3/4	3 1/2	8.40
5DPH25/25B	5.00	5.29	4 5/8	1 3/4	2 1/4	1.100	3	1 3/4	3 1/2	7.80
6DPH24/24	4.00	4.24	3 5/8	1 1/4	2	0.860	2 5/16	1 5/16	3	4.40
6DPH24/24A	4.00	4.24	3 5/8	1 1/2	2	0.860	2 5/16	1 5/16	3	4.30
6DPH27/27	4.50	4.74	4 1/8	1 1/4	2 3/16	0.960	2 5/8	1 1/2	3 1/4	6.30
6DPH27/27A	4.50	4.74	4 1/8	1 1/2	3/16	0.960	2 5/8	1 1/2	3 1/4	5.90
8DPH24/24	3.00	3.18	2 9/16	3/4	1	0.640	1 37/64	13/16	1 3/4	1.50
8DPH24/24A	3.00	3.18	2 3/4	1	1 3/8	0.640	1 49/64	1	2 1/2	2.10
8DPH24/24B	3.00	3.18	2 3/4	1 1/4	1 5/8	0.640	1 49/64	1	2 1/2	1.90
8DPH28/28	3.50	3.68	3 1/4	1	1 5/8	0.750	2 3/32	1 1/4	2 1/2	2.90
8DPH28/28A	3.50	3.68	3 1/4	1 3/16	1 5/8	0.750	2 3/32	1 1/4	2 1/2	2.80
8DPH28/28B	3.50	3.68	3 1/4	1 1/4	1 5/8	0.750	2 3/32	1 1/4	2 1/2	2.60
8DPH32/32	4.00	4.18	3 5/8	1	2	0.840	2 9/32	1 1/8	3	4.80
10DPH20/20A	2.00	2.14	2	1/2	7/8	0.440	1 23/64	13/16	1 5/8	0.75
10DPH20/20B	2.00	2.14	2	5/8	7/8	0.440	1 23/64	13/16	1 5/8	0.72
10DPH20/20	2.00	2.14	2	3/4	7/8	0.440	1 23/64	1 3/16	1 5/8	0.67
10DPH20/20C	2.00	2.14	2	7/8	7/8	0.440	1 23/64	1 3/16	1 5/8	0.58
10DPH25/25	2.50	2.64	2 7/16	3/4	1 1/4	0.550	1 5/8	15/16	2	1.20
10DPH25/25A	2.50	2.64	2 7/16	7/8	1 1/4	0.550	1 5/8	15/16	2	1.20
10DPH25/25B	2.50	2.64	2 7/16	1	1 1/4	0.550	1 5/8	15/16	2	1.20
10DPH30/30	3.00	3.14	2 3/4	3/4	1 5/8	0.640	1 3/4	1	2	1.80
12DPH15/15	1.25	1.37	1 1/4	3/8	3/4	0.270	55/64	1/2	1	0.17
12DPH15/15A	1.25	1.37	1 1/4	7/16	3/4	0.270	55/64	1/2	1	0.16
12DPH15/15B	1.25	1.37	1 1/4	1/2	3/4	0.270	55/64	1/2	1	0.15
12DPH18/18	1.50	1.62	1 1/2	1/2	7/8	0.320	1 1/64	5/8	1 1/4	0.30
12DPH18/18A	1.50	1.62	1 1/2	5/8	7/8	0.320	1 1/64	5/8	1 1/4	0.25
12DPH18/18B	1.50	1.62	1 1/2	3/4	7/8	0.320	1 1/64	5/8	1 1/4	0.22
12DPH21/21	1.75	1.87	1 3/4	1/2	1	0.390	1 3/16	11/16	1 3/8	0.45
12DPH21/21A	1.75	1.87	1 3/4	5/8	1	0.390	1 3/16	11/16	1 3/8	0.45
12DPH24/24	2.00	2.12	1 7/8	1/2	1	0.430	1 7/32	11/16	1 1/2	0.62
12DPH30/30	2.50	2.62	2 5/16	5/8	1 1/4	0.540	1 31/64	27/32	1 1/2	1.1
14DPH14/14	1.00	1.11	1 1/16	3/8	5/8	0.190	47/64	1/2	7/8	0.10
14DPH14/14A	1.00	1.1	1 1/16	7/16	5/8	0.190	47/64	1/2	7/8	0.10
16DPH15/15										
16DPH16/16	1.00	1.09	1 1/16	3/8	1/2	0.220	3/4	7/16	3/4	0.10
16DPH24/24	1.50	1.50	1 3/8	1/2	7/8	0.310	7/8	1/2	1	0.20
24DPH24/24	1.00	1.06	29/32	1/4	1/2	0.200	9/16	9/32	5/8	0.10

Ordering Example:

4DPH24/24A

4DP= 4 Diametrical Pitch

H= Hardened Teeth

24 = 1st Gear Number of Teeth

/24 = 2nd Gear Number of Teeth

A = Version

**American Metric® Corporation**

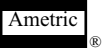

GROUP: 127

1-127-050103

# American Standard (ANSI) MPB Steel Bevel Gears

## Pressure Angle 20°

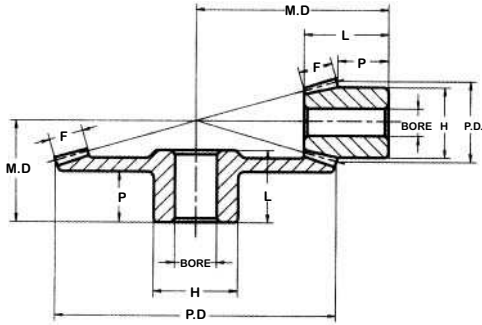

Bored to Size Gears  
Available in Standard ANSI  
or Metric (ISO) Bores,  
Keyways and (2) Setscrews



1:3

### Unhardened Steel Bevel Gears

Part No.	PD	OD	MD	Bore		Dimensions				Weight
				Stock	Max	F	L	P	H	
4DP14/42	10.50	10.59	4	1 1/8	2 1/4	1.420	2 11/16	1 1/2	3 3/4	26.4
	3.50	4.17	7 1/4	1 1/8	1 13/16	1.420	3 27/64	1 15/16	3 1/4	7.0
5DP15/45	9.00	9.07	3 3/4	1 1/4	2 1/4	1.310	2 1/2	1 11/16	3 3/4	17.1
	3.00	3.54	5 7/8	1	1 1/2	1.310	2 11/16	1 5/16	2 5/8	3.6
6DP15/45	7.50	7.56	3	1 1/8	2 1/4	1.070	2 1/8	1 1/4	3 1/4	10.6
	2.50	2.94	5 1/4	5 1/4	1 1/4	1.070	2 9/16	1 7/16	2 1/8	2.3
8DP16/48	6.05	6.20	2 3/8	2 3/8	1 13/16	0.840	1 5/8	1	2 3/4	5.3
	2.00	2.33	4 1/4	4 1/4	1	0.840	2 5/64	1 3/16	1 3/4	1.2
10DP20/60	6.00	6.04	2 3/4	2 3/4	2	0.780	1 29/32	1 3/8	3	6.3
	2.00	2.27	4 3/8	4 3/8	1	0.780	2 5/32	1 5/16	1 3/4	1.2
12DP18/54	4.50	4.53	1 3/4	1 3/4	1	0.600	1 1/16	3/4	1 3/4	1.7
	1.50	1.72	3	3	9/16	0.600	1 11/32	11/16	1 1/4	0.4
16DP16/48	3.00	3.02	1 5/16	1 5/16	13/16	0.420	7/8	9/16	1 1/2	0.8
	1.00	1.17	2	2	7/16	0.420	59/64	15/32	7/8	0.1

1:4

### Unhardened Steel Bevel Gears

Part No.	PD	OD	MD	Bore		Dimensions				Weight
				Stock	Max	F	L	P	H	
4DP14/56	14.00	14.07	4 1/4	1 1/4	2 5/8	1.690	2 7/8	1 5/8	4 1/4	48.7
	3.50	4.2	9	1 1/8	1 7/8	1.690	3 35/64	1 15/16	3 1/4	7.6
5DP15/60	12.00	12.05	3 3/4	1 1/4	2 3/8	1.700	2 5/8	1 9/16	4	31.2
	3.00	3.56	7 1/2	1	1 4/7	1.700	3 13/64	1 7/16	3	5.0
6DP15/60	10.00	10.04	3 1/4	1 1/8	2 1/4	1.210	2 1/4	1 3/8	3 1/4	17.6
	2.50	2.97	6 3/4	1	1 3/8	1.210	2 31/32	1 3/4	2 1/2	3.3
8DP16/64	8.00	8.03	2 3/4	1	1 13/16	0.840	1 7/8	1 1/4	2 3/4	9.7
	2.00	2.35	5 1/4	7/8	1 1/8	0.840	2 3/32	1 7/32	1 7/8	1.3
8DP18/72	9.00	9.03	3 1/4	1 1/8	2	1.220	2 5/16	1 11/16	3	12.3
	2.25	2.6	5 3/4	7/8	1 1/4	1.220	2 15/32	1 7/32	2 1/8	1.9
10DP15/60	6.00	6.03	2 1/4	7/8	1 5/8	0.720	1 5/8	1 1/8	2 1/2	4.6
	1.50	1.78	3 7/8	5/8	3/4	0.720	1 33/64	27/32	1 7/16	0.6
12DP18/72	6.00	6.02	2	3/4	1 1/4	0.600	1 5/16	61/64	2	3.1
	1.50	1.73	3 3/4	1/2	4/7	0.600	1 23/64	23/32	1 1/4	0.4
16DP16/64	4.00	4.02	1 3/8	5/8	1 3/8	0.480	57/64	9/16	2 1/4	1.6
	1.00	1.17	2 1/2	1/2	5/8	0.480	63/64	15/32	13/16	0.1

# American Standard (ANSI) MPB Steel Bevel Gears

## Pressure Angle 20°

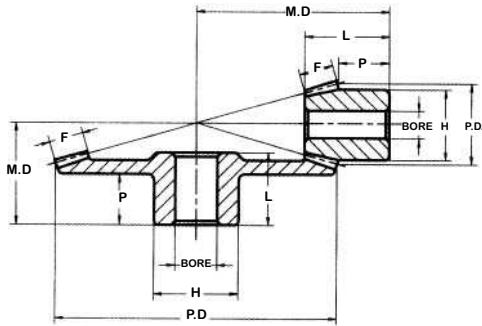

Bored to Size Gears  
Available in Standard ANSI  
or Metric (ISO) Bores,  
Keyways and (2) Setscrews



### 1:1.5 Unhardened Steel Bevel Gears

Part No.	PD	OD	MD	Bore		Dimensions				Weight
				Stock	Max	F	L	P	H	
10DP20/30	3.00	3.08	2 1/4	3/4	1 1/2	0.570	1 7/16	1	2 1/2	1.7
	2.00	2.21	2 1/2	3/4	1 5/16	0.570	1 33/64	29/32	1 3/4	0.8
12DP18/27	2.25	2.32	1 3/4	1/2	13/16	0.410	1 1/8	25/32	1 1/2	0.6
	1.50	1.67	1 7/8	1/2	9/16	0.410	1 1/8	21/32	1 1/4	0.2
16DP16/24	1.50	1.55	1 1/5	1/2	9/16	0.250	3/4	9/16	1 1/8	0.2
	1.00	1.13	1 1/4	3/8	7/16	0.250	47/64	7/16	13/16	0.1

### 1:2 Unhardened Steel Bevel Gears

Part No.	PD	OD	MD	Bore		Dimensions				Weight
				Stock	Max	F	L	P	H	
3DP15/30	10.00	10.19	5 1/2	1 1/4	3	1.870	3 19/32	2	5	39.9
	5.00	5.80	7 1/4	1 1/8	2	1.870	4 1/32	1 15/16	3 3/4	13.7
4DP16/32	8.00	8.10	4 1/4	1 1/8	2 1/4	1.400	2 11/16	1 9/16	3 3/4	17.6
	4.00	4.60	6	1 1/8	1 7/8	1.400	3 11/32	1 13/16	3 1/4	7.5
5DP15/30	6.00	6.12	3 1/2	1 1/8	2 1/4	1.040	2 1/4	1 3/8	3 1/4	8.9
	3.00	3.48	4 3/8	1	1 3/8	1.040	2 25/64	1 9/32	2 5/8	3.1
6DP18/36	6.00	6.10	3 1/2	1 1/8	2 1/4	1.060	2 1/4	1 1/2	3 1/4	8.4
	3.00	3.42	4 3/4	1	1 7/16	1.060	2 49/64	1 9/32	2 1/2	3.4
6DP21/42	7.00	7.10	3 3/4	1 1/8	2 1/4	1.050	2 19/64	1 1/2	3 1/2	11.4
	3.50	3.90	5	1	1 5/8	1.050	2 33/64	1 1/4	2 1/2	3.8
6DP24/48	8.00	8.10	3 7/16	1 1/8	2 1/4	1.170	1 57/64	1	3 1/4	11.8
	4.00	4.40	5 7/16	1	1 3/4	1.170	2 35/64	1 1/4	2 5/8	4.9
8DP20/40	5.00	5.07	2 7/8	1	2	0.820	1 27/32	1 1/4	3	5.0
	2.50	2.80	4	7/8	1 1/4	0.820	2 9/32	1 13/32	2 1/8	3.0
10DP20/40	4.00	4.06	2 1/2	7/8	2	0.710	1 11/16	1 3/16	3	3.7
	2.00	2.24	3 1/8	3/4	15/16	0.710	1 51/64	1 1/16	1 3/4	0.9
10DP25/50	5.00	5.06	2 5/8	3/4	1 1/4	0.700	1 19/32	1	2	3.6
	2.50	2.74	3 3/8	3/4	1 1/4	0.700	1 35/64	3/4	2	1.2
12DP18/36	3.00	3.05	1 1/2	5/8	1 5/16	0.460	7/8	1/2	1 7/16	1.4
	1.50	1.70	2 1/4	1/2	5/8	0.460	1 13/64	11/16	1 1/4	0.4
12DP24/48	4.00	4.05	2	5/8	7/8	0.590	1 11/64	3/4	1 5/8	1.5
	2.00	2.20	2 7/8	1/2	13/16	0.590	1 7/16	3/4	1 1/2	0.8
12DP14/28	2.00	2.04	1 3/8	1/2	7/8	0.350	15/16	21/32	1 5/8	0.5
	1.00	1.17	1 5/8	1/2	1/2	0.350	31/32	9/16	1	0.1
16DP12/24	1.50	1.54	1	1/2	5/8	0.190	5/8	7/16	1	0.2
	0.75	0.91	1 1/8	3/8	1/2	0.190	37/64	11/32	21/32	0.1
16DP16/32	2.00	2.04	1 3/16	1/2	3/8	0.350	49/64	1/2	1 1/8	0.2
	1.00	1.15	1 1/2	3/8	7/16	0.350	37/32	7/16	13/16	0.1