

Ball Joints

Hardened or Stainless Steel
DIN 71802

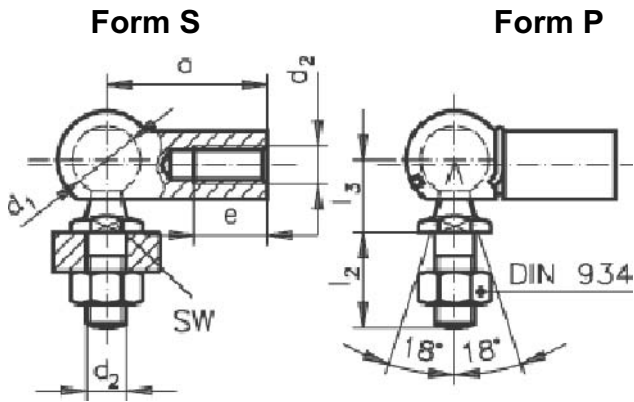

Part Number	d ₁ H9/h9	d ₂	SW h14	a +0.3	e	l ₃ ±0.3	l ₂ ±0.3	Tilt Angle		Weight g
								Form S	Form P	
BJ5....	8	M 5	7	22	10.2	9	10.2	18 °	18 x 10 °	15.2
BJ6....	10	M 6	8	25	11.5	11	12.5	18 °	18 x 15 °	25.2
BJ8....	13	M 8	11	30	14.0	13	16.5	18 °	18 x 15 °	53.1
BJ10....	16	M 10	13	35	15.5	16	20.0	18 °	18 x 15 °	103.8
BJ14....	19	M14x1.5	16	45	21.5	20	28.0	18 °	18 x 15 °	220.9

Form S: Threaded shank and stem with hex nut, and hardened ball
Ordering example: BJ5RS = Ball Joint, M 5, Right Hand thread, Form S

Form P: Turned shank with circlip, threaded stem with hex nut, and hardened ball
Ordering example: BJ6LP = Ball Joint, M 6, Left Hand thread, Form P

Stainless Steel: In form P without hardened ball
Ordering example: BJ8RP SS = Ball Joint, M 8, Right Hand thread, Form P, Stainless Steel

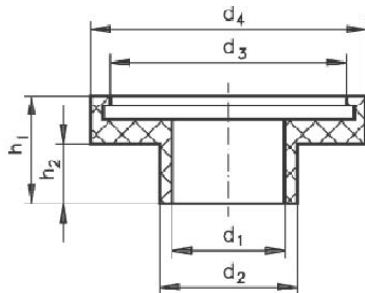

Sealing Cap
For DIN 71802 Ball Joints
Material: Neoprene



Part Number	Rodend		d ₂	d ₃	h ₁	h ₂	Weight g
	d ₁	d ₁					
BJ5SC	8	4	5.4	9.0	4.5	1.5	32
BJ6SC	10	5.5	6.9	10.5	6.5	3.5	44
BJ8SC	13	7	8.6	14.0	7.5	3.5	86
BJ10SC	16	9	10.5	17.5	8.5	4.5	116
BJ14SC	19	11	12.6	21.0	12.0	7.0	215

Ordering example: BJ5SC = Ball Joint, for M 5, Seal Cap